

NOTE BOOK
 NO. _____
 PLOTTED, CHECKED
 DRAWN, NOTED
 STRUCTURE NOTATIONS CHFD

F.A.T. RTE. 90/94	SECTION	COUNTY	TOTAL SHEETS	SHEET NO.
		COOK	907	831
STA. 1200+00.00 TO STA. 1365+00		ILLINOIS FED. AID PROJECT		
		• (1516.1, 1717 & 1818) R-9		
				62695

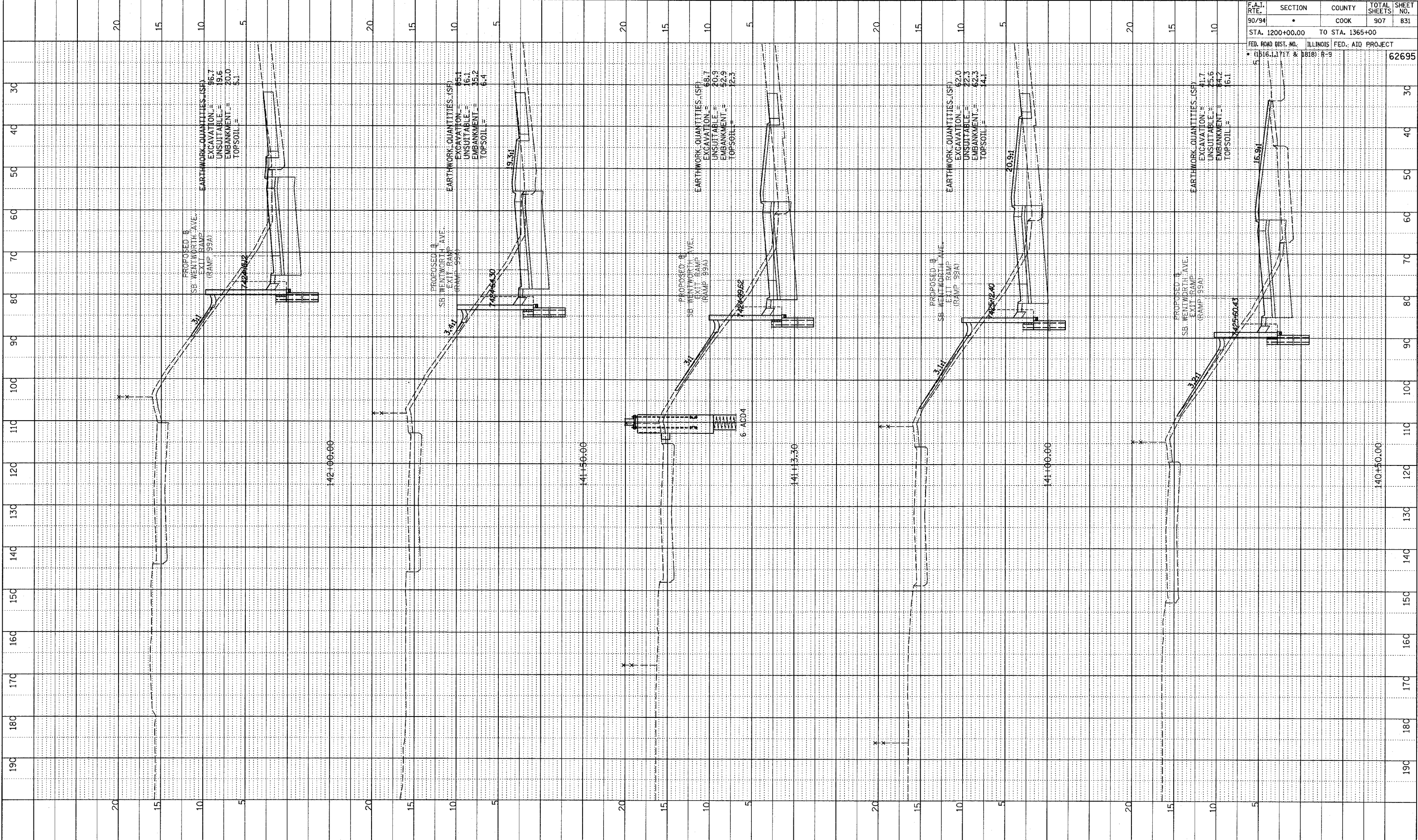

TYLIN INTERNATIONAL

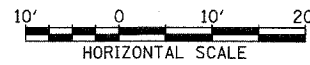

SB WENTWORTH AVENUE EXIT RAMP
 STA. 140+50 TO STA. 142+00

D:\0231\road\cl\bigak\bxst99a.f.dgn