

PROF-11L SERVED
 GRADES CHECKED
 ELEM. NOTED
 NO. STRUCTURE NOTATIONS DRWG

F.A.I. RTE.	SECTION	COUNTY	TOTAL SHEETS	SHEET NO.
90/94	•	COOK	907	850
STA. 1200+00.00 TO STA. 1365+00				
FED. ROAD DIST. NO. ILLINOIS FED. AID PROJECT				
• (1516.1, 1717 & 1818) R-9				
				62695

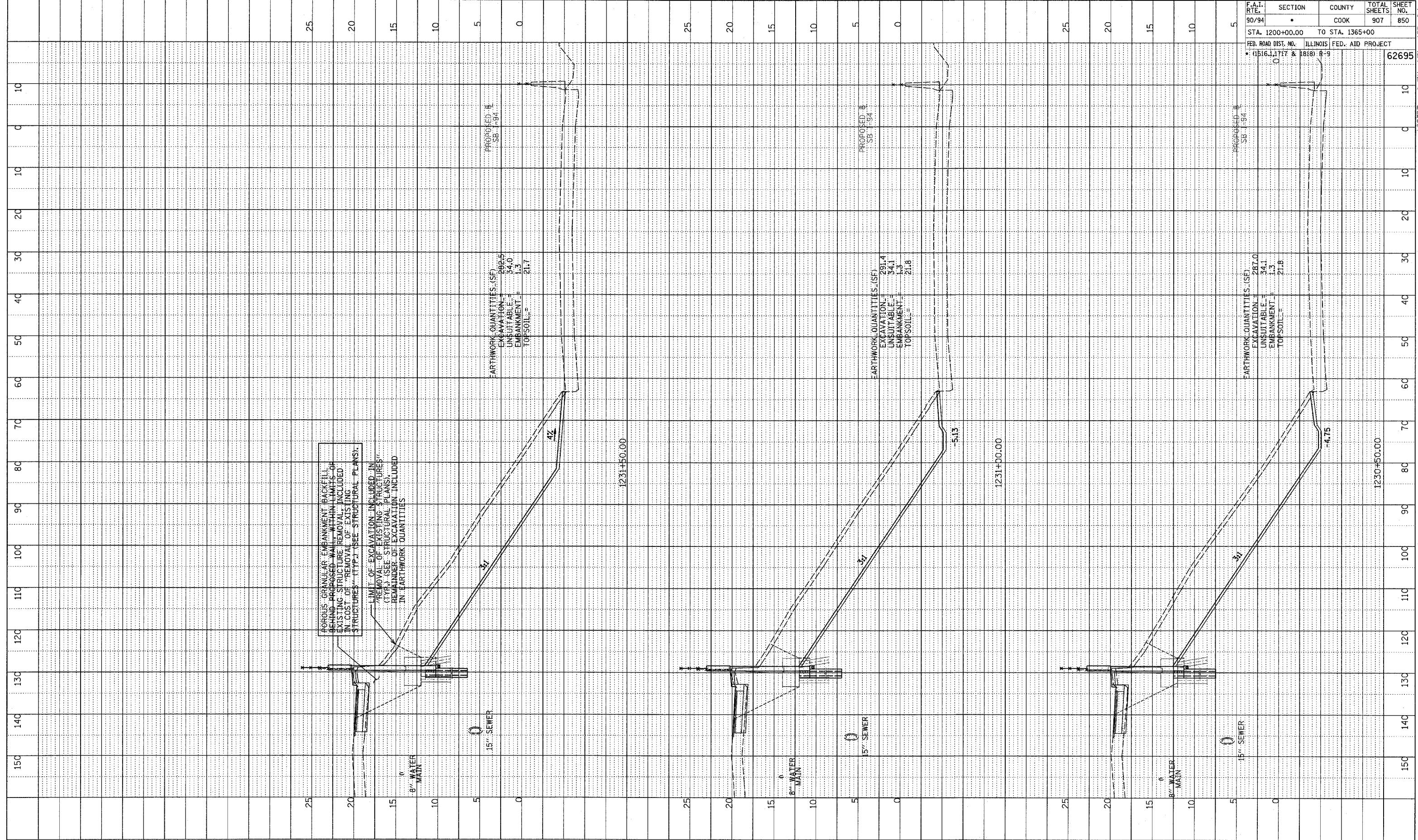

POROUS GRANULAR EMBANKMENT BACKFILL BEHIND PROPOSED WALL, WITHIN LIMITS OF EXISTING STRUCTURE REMOVAL, INCLUDED IN COST OF "REMOVAL OF EXISTING STRUCTURES" (TYP.) (SEE STRUCTURAL PLANS).

LIMIT OF EXCAVATION INCLUDED IN "REMOVAL OF EXISTING STRUCTURES" (TYP.) (SEE STRUCTURAL PLANS). REMAINDER OF EXCAVATION INCLUDED IN EARTHWORK QUANTITIES.

TYLIN INTERNATIONAL

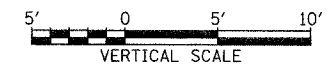
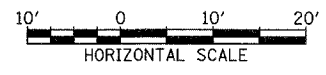

SB 95th ST. EXIT RAMP
 STA. 1230+50 TO STA. 1231+50

P:\0231\3\road\17\big\17\bas\1954_1.dgn