

PROFILE SURVEYED
 PLOTTED & CHECKED
 NOTE BOOK NO. _____
 NO. _____
 STRUCTURE NOTATIONS CHECKED

F.A.I. RTE.	SECTION	COUNTY	TOTAL SHEETS	SHEET NO.
90/94		COOK	907	858
STA. 1200+00.00 TO STA. 1365+00		ILLINOIS FED. AID PROJECT		
FEB. ROAD DIST. NO. 1516.1, 1717 & 1818 R-9		62695		

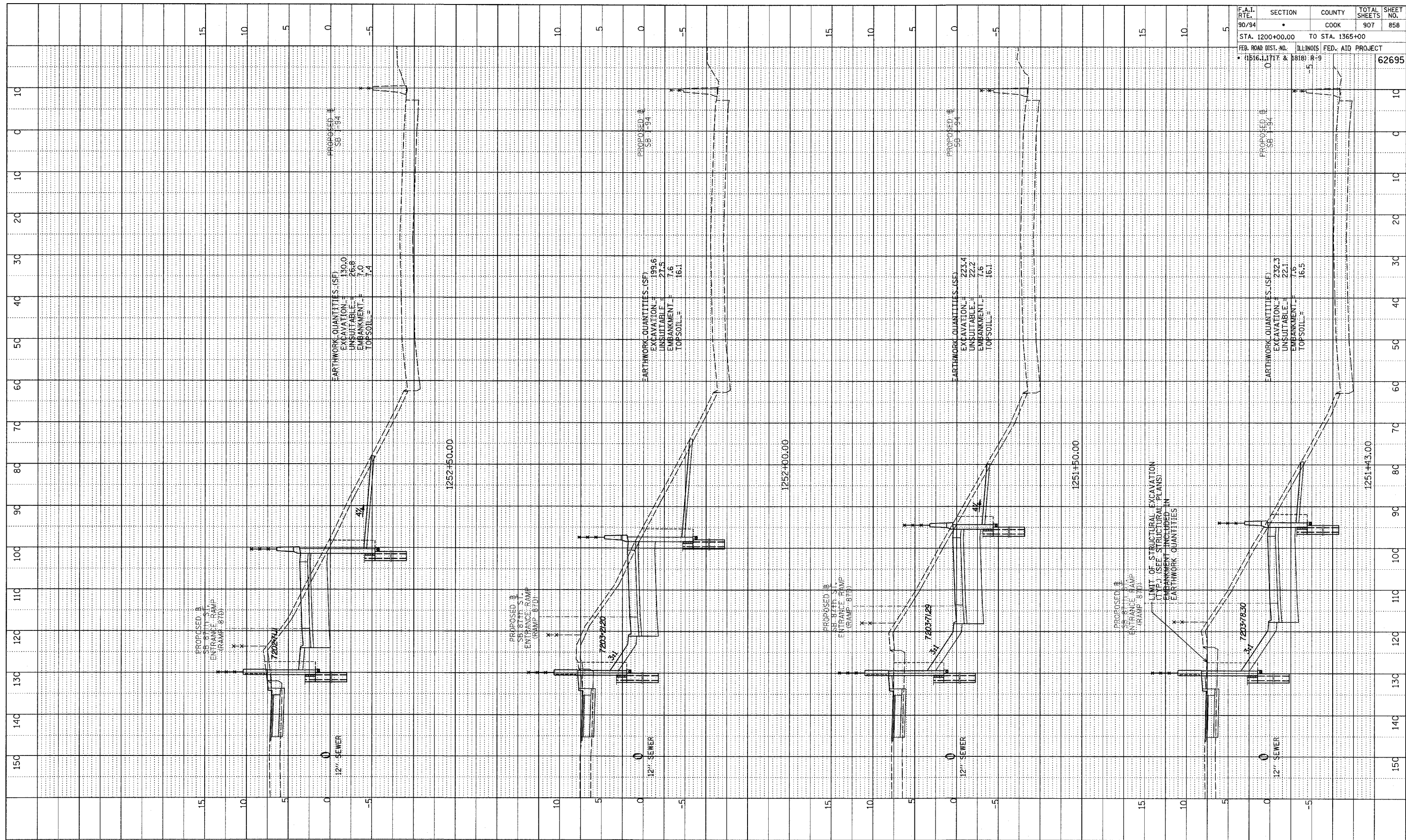

TYLIN INTERNATIONAL

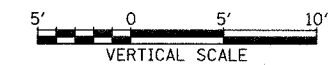
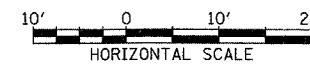

SB 87th ST. ENTRANCE RAMP
STA. 1251+43 TO STA. 1252+50

DWG: 231100001/00001/00001/00001.dwg