

PROF. ILL. SUBMITTED
 GRADES CHECKED
 ELEM. NOTED
 NO. STRUCTURE NOTATIONS CHKS

F.A.I. RTE.	SECTION	COUNTY	TOTAL SHEETS	SHEET NO.
90/94		COOK	907	877
STA. 1200+00.00		TO STA. 1365+00		
FED. ROAD DIST. NO.		ILLINOIS FED. AID PROJECT		
• (1516, 13717 & 1818) R-9				62695

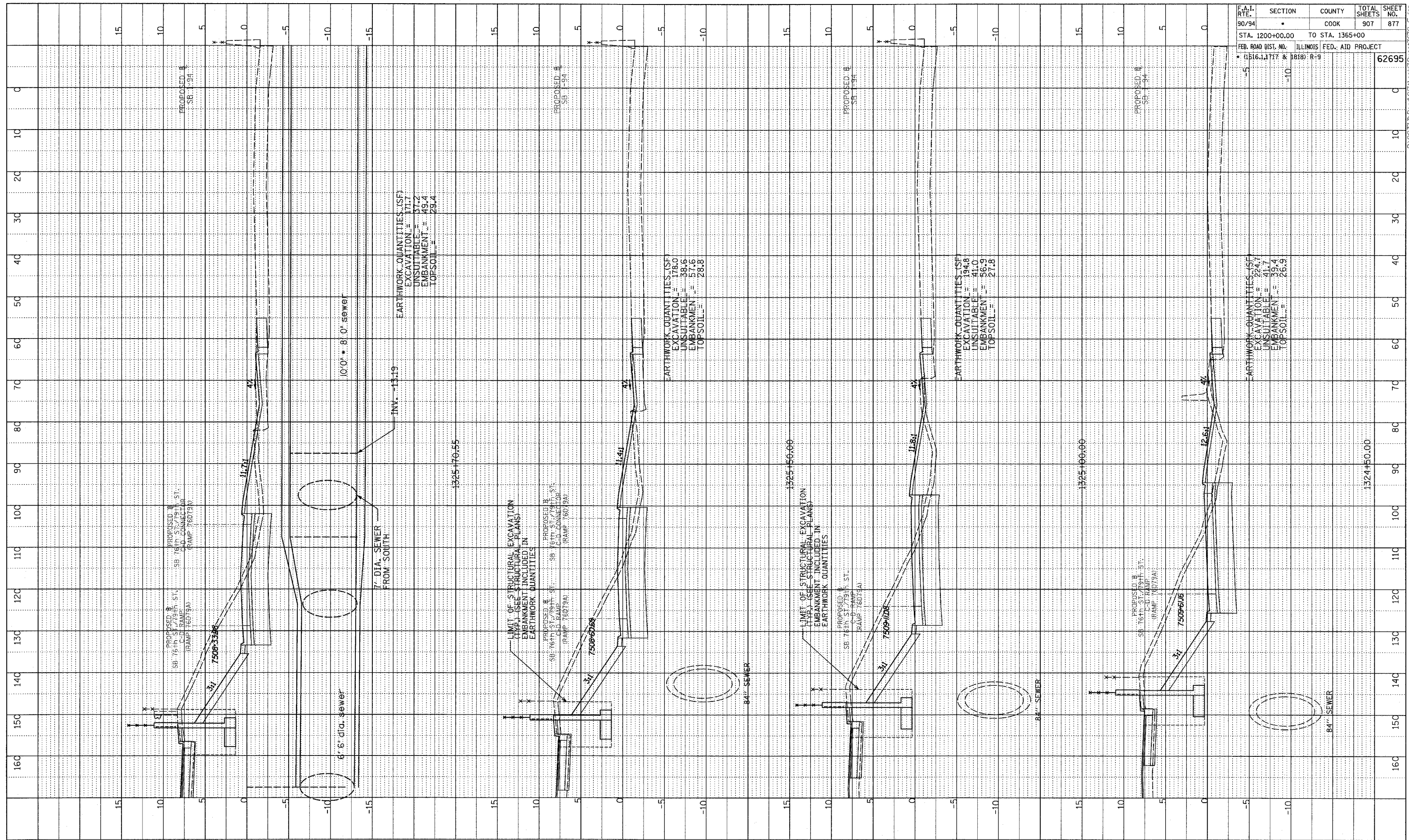

EARTHWORK QUANTITIES (SF)
 EXCAVATION = 171.7
 UNSUITABLE = 37.2
 EMBANKMENT = 29.4
 TOPSOIL = 29.4

EARTHWORK QUANTITIES (SF)
 EXCAVATION = 178.0
 UNSUITABLE = 38.6
 EMBANKMENT = 57.6
 TOPSOIL = 28.8

EARTHWORK QUANTITIES (SF)
 EXCAVATION = 194.8
 UNSUITABLE = 41.0
 EMBANKMENT = 56.9
 TOPSOIL = 27.8

EARTHWORK QUANTITIES (SF)
 EXCAVATION = 224.7
 UNSUITABLE = 39.4
 EMBANKMENT = 26.9
 TOPSOIL = 26.9

LIMIT OF STRUCTURAL EXCAVATION
 (SEE STRUCTURAL PLANS)
 EMBANKMENT INCLUDED IN
 EARTHWORK QUANTITIES

LIMIT OF STRUCTURAL EXCAVATION
 (SEE STRUCTURAL PLANS)
 EMBANKMENT INCLUDED IN
 EARTHWORK QUANTITIES

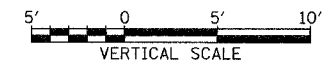
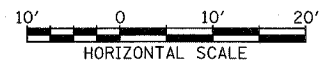

TYLIN INTERNATIONAL

SB 76th TO 79th ST. CD RAMP
 STA. 1324+50 TO STA. 1325+70

P:\0231\3\Road\CD RAMP\Bussell\1619_F.dgn