

PLOTTED
 CHECKED
 DRAWN
 STRUCTURE NOTATIONS OK'D
 NO. _____
 NO. _____
 NO. _____

F.A.I. RTE.	SECTION	COUNTY	TOTAL SHEETS	SHEET NO.
90/94		COOK	907	883
STA. 1200+00.00 TO STA. 1365+00				
FED. ROAD DIST. NO. ILLINOIS FED. AID PROJECT				
(1516.1, 1717 & 1818) R-9				
				62695

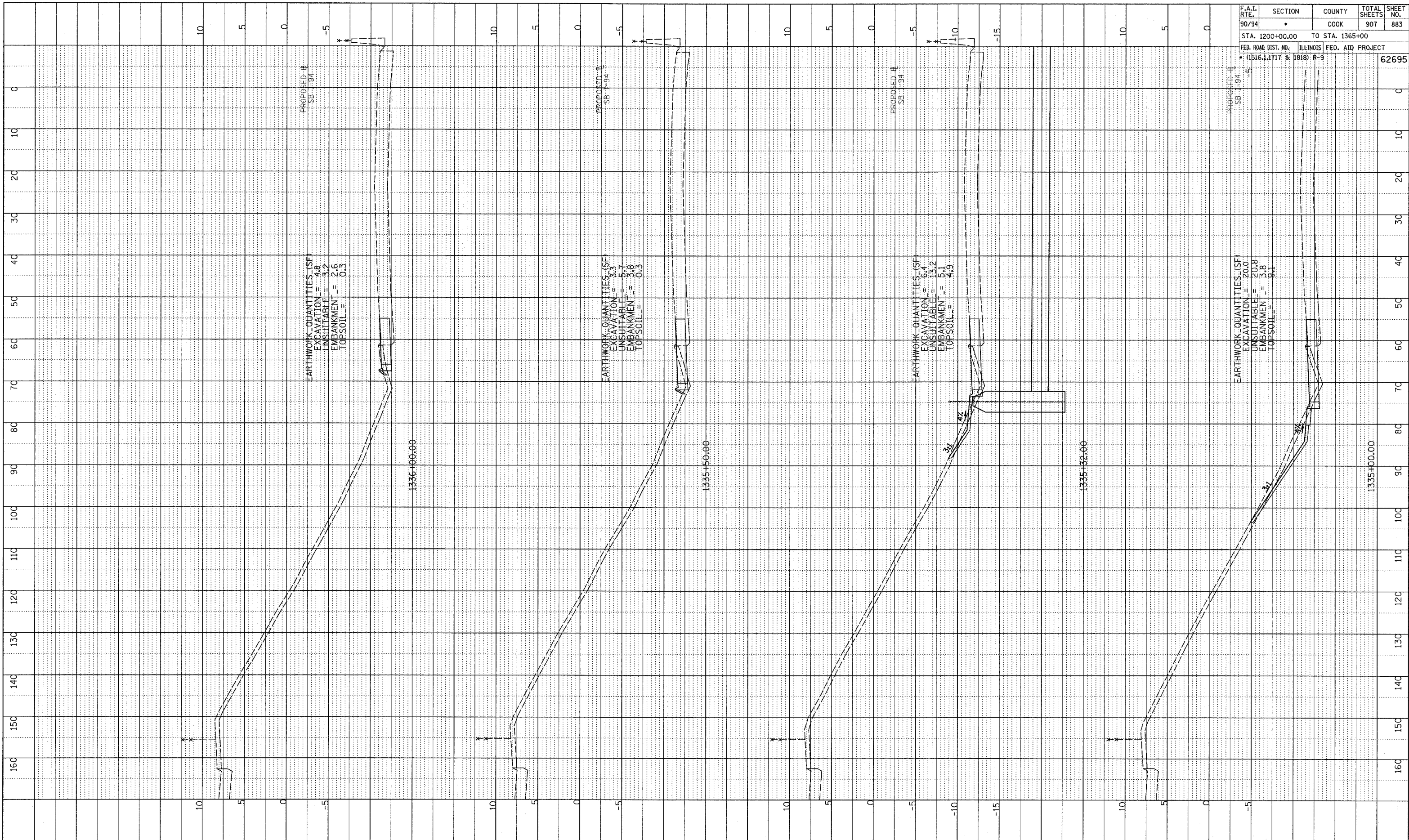

TYLIN INTERNATIONAL

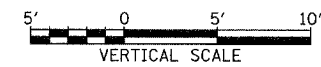
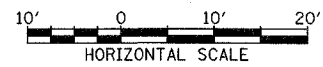

SB 76th TO 79th ST. CD RAMP
 STA. 1335+00 TO STA. 1336+00

P:\02333\Road\CD Ramp\T.Bass\1619.F.dgn