

F.A. RTE.	SECTION	COUNTY	TOTAL SHEETS	SHEET NO.
649	67(T)RS-2&I	MARSHALL	74	27
STA. 581+00		TO STA. 587+00		
FED. ROAD DIST. NO. ILLINOIS FED. AID PROJECT				
D-93-053-03 CONTRACT NUMBER 66403				

PLAN	DATE
SURVEYED	
GRADES CHECKED	
ALIGNMENT CHECKED	
RT. OF WAY CHECKED	
NOTE BOOK NO.	
FILE NAME	

PROFILE	DATE
SURVEYED	
GRADES CHECKED	
STRUCTURE NOTATIONS OK'D	
NOTE BOOK NO.	
FILE NAME	

FILE: 9:\3846\6-16-04\38460004.dgn
DATE: 30-SEP-04 12:27

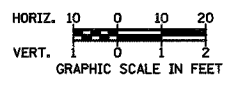
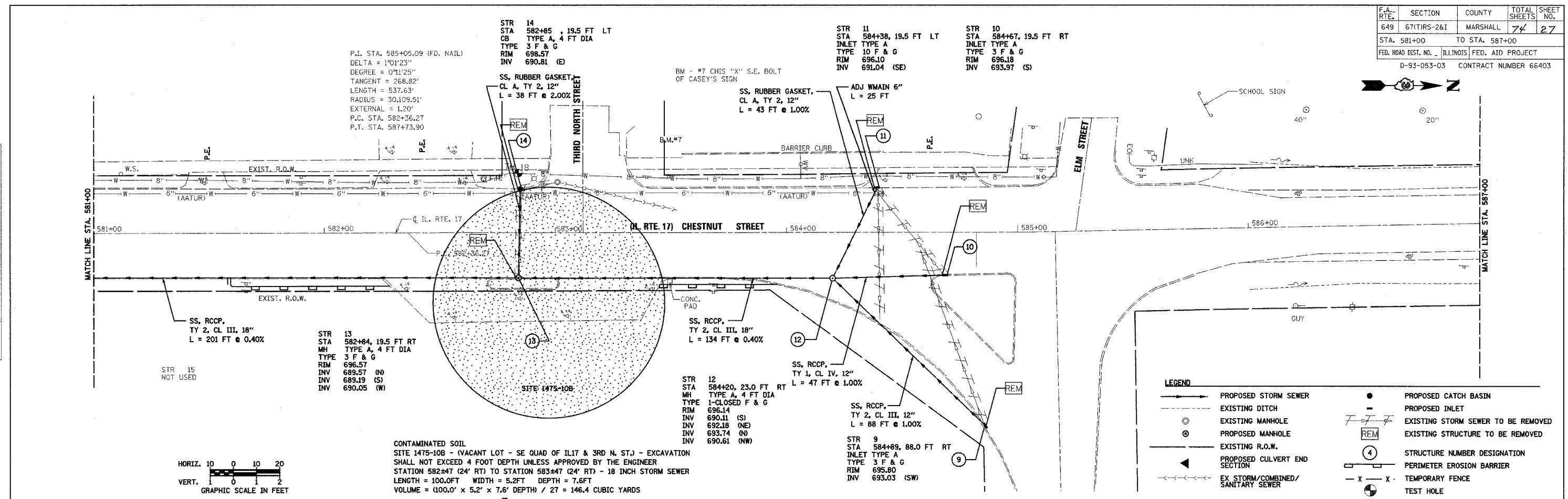

LEGEND

	PROPOSED STORM SEWER		PROPOSED CATCH BASIN
	EXISTING DITCH		PROPOSED INLET
	EXISTING MANHOLE		EXISTING STORM SEWER TO BE REMOVED
	PROPOSED MANHOLE		EXISTING STRUCTURE TO BE REMOVED
	EXISTING R.O.W.		STRUCTURE NUMBER DESIGNATION
	PROPOSED CULVERT END SECTION		PERIMETER EROSION BARRIER
	EX STORM/COMBINED/SANITARY SEWER		TEMPORARY FENCE
			TEST HOLE

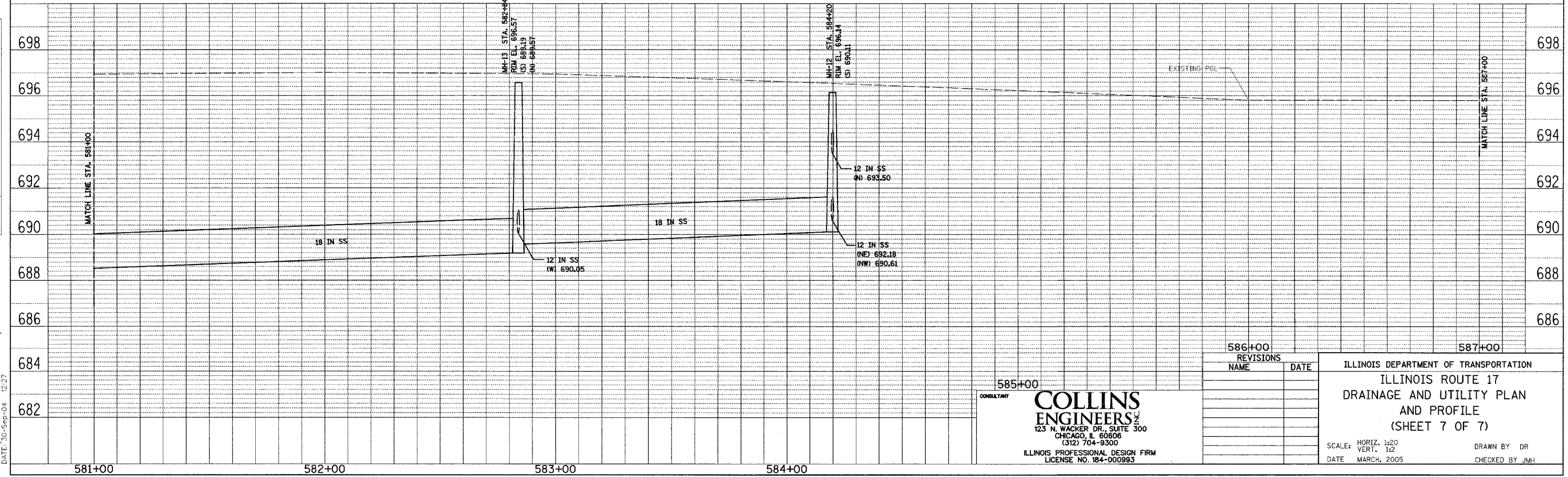

CONSULTANT

COLLINS ENGINEERS
123 N. WACKER DR., SUITE 300
CHICAGO, IL 60606
(312) 704-9300
ILLINOIS PROFESSIONAL DESIGN FIRM
LICENSE NO. 184-000993

REVISIONS NAME	DATE
586+00	
585+00	

ILLINOIS DEPARTMENT OF TRANSPORTATION
ILLINOIS ROUTE 17
DRAINAGE AND UTILITY PLAN
AND PROFILE
(SHEET 7 OF 7)

SCALE: HORIZ. 1:20
VERT. 1:2
DATE: MARCH, 2005

DRAWN BY: DR
CHECKED BY: JMH