

F.A.U. RTE.	SECTION	COUNTY	TOTAL SHEETS	SHEET NO.
8012		SANGAMON	13	10
STA.		TO STA.		
FED. ROAD DIST. NO.	ILLINOIS	FED. AID PROJECT		

• D-6 MISC TRAFFIC CONTROL 2006

TRAFFIC SIGNAL QUANTITIES

QUANTITY	UNIT	ITEM
285.0	FOOT	CONDUIT IN TRENCH, 1 1/2" DIA., PVC
16.0	FOOT	CONDUIT IN TRENCH, 4" DIA., PVC
110.0	FOOT	CONDUIT, AUGERED, 1 1/2" DIA., PVC
1	EACH	JUNCTION BOX (SPECIAL)
1	EACH	DOUBLE HANDHOLE
301.0	FOOT	TRENCH AND BACKFILL FOR ELECTRICAL WORK
645.5	FOOT	FIBER OPTIC CABLE IN CONDUIT, NO. 62.5/125, 6F

CONTRACTOR SHOULD VERIFY EXISTING CONDUIT LENGTHS AND PULL POINTS PRIOR TO ORDERING CABLE. CONDUIT SHOWN IS BASED UPON HISTORICAL DATA.

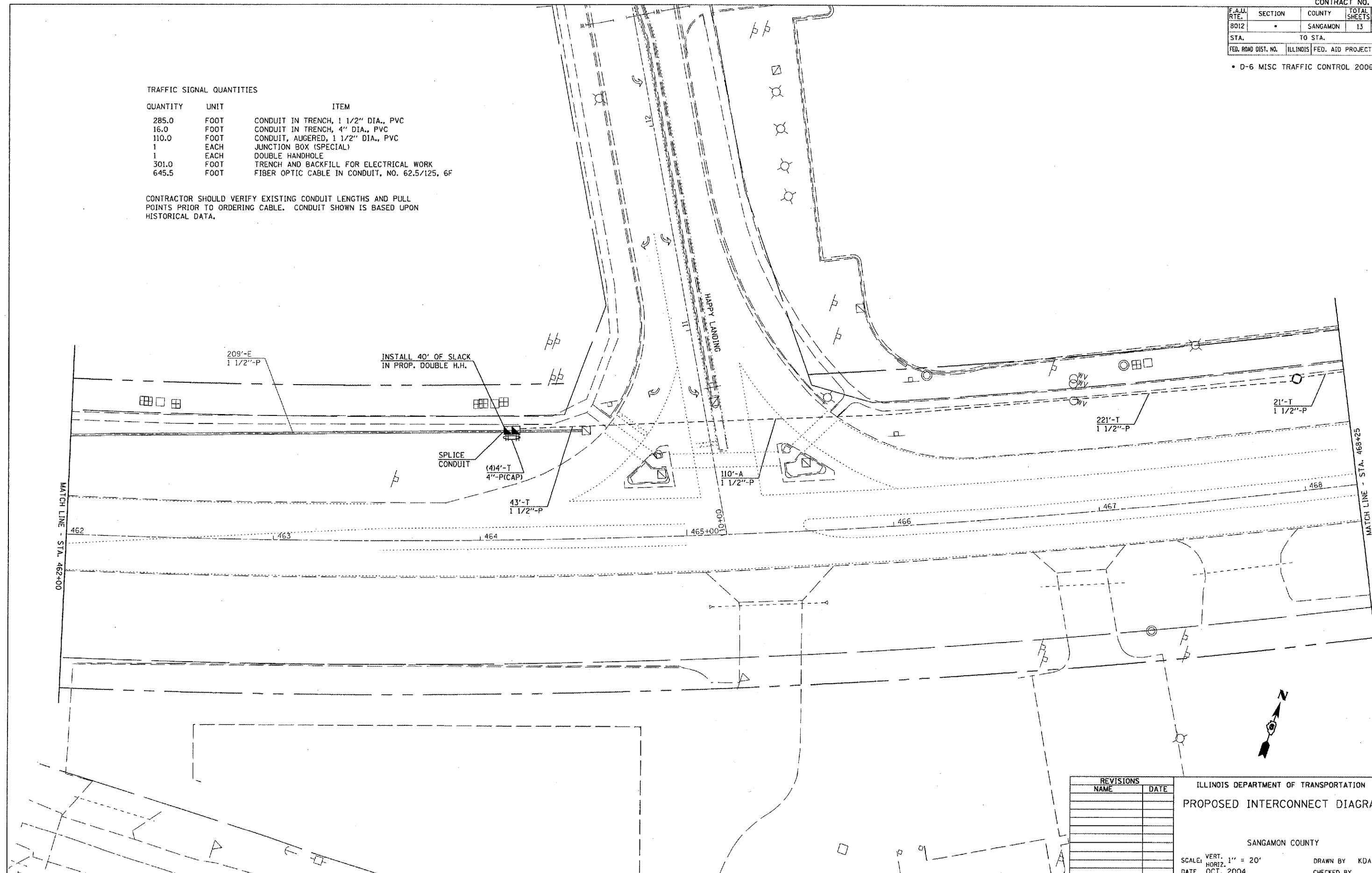

MATCH LINE - STA. 462+00

MATCH LINE - STA. 468+25



REVISIONS	
NAME	DATE

ILLINOIS DEPARTMENT OF TRANSPORTATION
PROPOSED INTERCONNECT DIAGRAM
 SANGAMON COUNTY
 SCALE: VERT. 1" = 20'
 HORIZ. 1" = 20'
 DATE OCT, 2004
 DRAWN BY KDA
 CHECKED BY

PLOT DATE = 2/18/2005
 FILE NAME = C:\Projects\468048\10_sheets.dgn
 PLOT SCALE = 43.795 : 1 IN.
 REFERENCE = #REF#