

F.A.I. RTE.	SECTION	COUNTY	TOTAL SHEETS	SHEET NO.
64	82-7RS-1, 82-7HB, 2I	ST. CLAIR	89	70
STA.		TO STA.		
FED. ROAD DIST. NO.	ILLINOIS	FED. AID PROJECT		

**PRE-STAGE 1**

SHOULDERS SHALL BE REPLACED WHERE SHOWN PRIOR TO STAGE 1. THE MATERIAL PLACED SHALL BE BITUMINOUS CONCRETE BINDER COURSE, SUPERPAVE, IL-19.0, N70.

ANY EXCAVATION OR DROP-OFF MORE THAN 3" AT THE EDGE OF PAVEMENT SHALL BE PROTECTED WITH EXTENDED LEG BARRICADES AND APPROPRIATE LIGHTING.

NO OVERNIGHT LANE CLOSURES WILL BE ALLOWED IN THIS STAGE.

TRAFFIC CONTROL FOR THIS WORK SHALL CONFORM TO STANDARD 701201.

THE COST OF ALL TRAFFIC CONTROL DEVICES AS HEREIN SPECIFIED SHALL BE INCLUDED IN THE CONTRACT LUMP SUM PRICE FOR TRAFFIC CONTROL AND PROTECTION, STANDARD 701201.

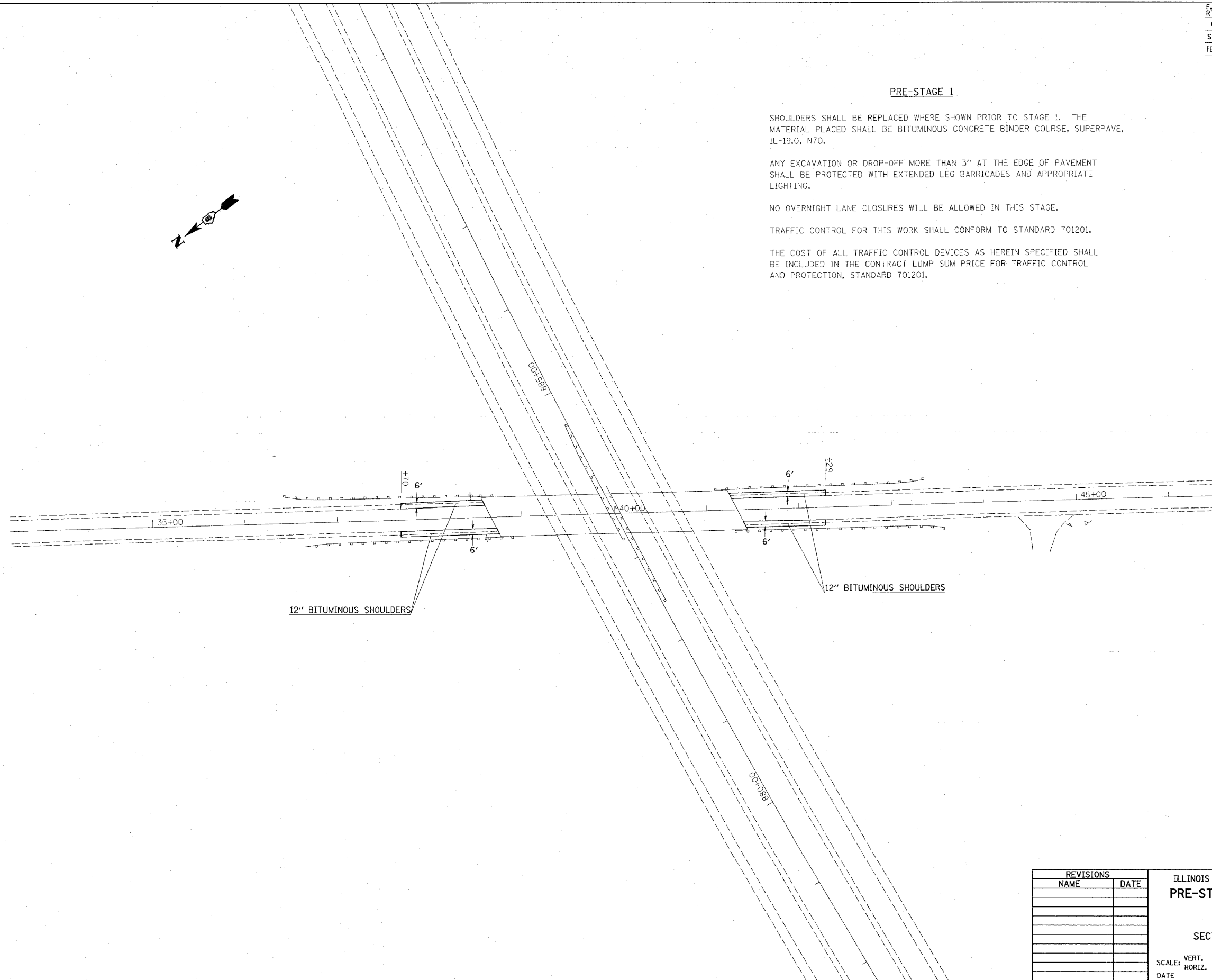
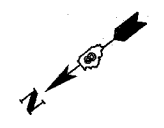

PLOT DATE \* DATE \*  
 FILE NAME \* SCALE \*  
 REFERENCE \* REF \*

REVISIONS	
NAME	DATE

ILLINOIS DEPARTMENT OF TRANSPORTATION  
**PRE-STAGE 1 TRAFFIC CONTROL**  
**SN 082-0182**  
 FAI ROUTE 64  
 SECTION 82-7RS-1, 82-7HB, 2I  
 ST. CLAIR COUNTY

SCALE: VERT.  
 HORIZ.  
 DATE

DRAWN BY  
 CHECKED BY