

F.A.P. RTE.	SECTION	COUNTY	TOTAL SHEETS	SHEET NO.
310	C38-D RS	MCDONOUGH	83	30
STA. 143+00		TO STA. 158+00		
FED. ROAD DIST. NO.		ILLINOIS FED. AID PROJECT		

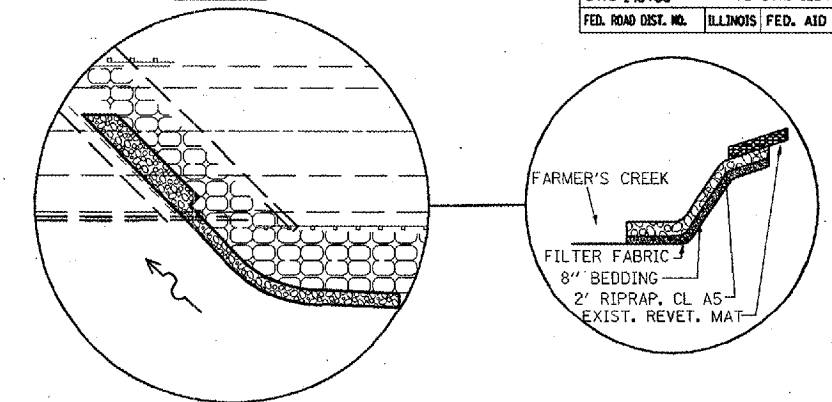

T6N R2W 4th P.M. (MACOMB TWP.)
SECTION 6

PLAN VIEW



FARMER'S CREEK
FILTER FABRIC
8" BEDDING
2' RIPRAP, CL A5
EXIST. REVET. MAT

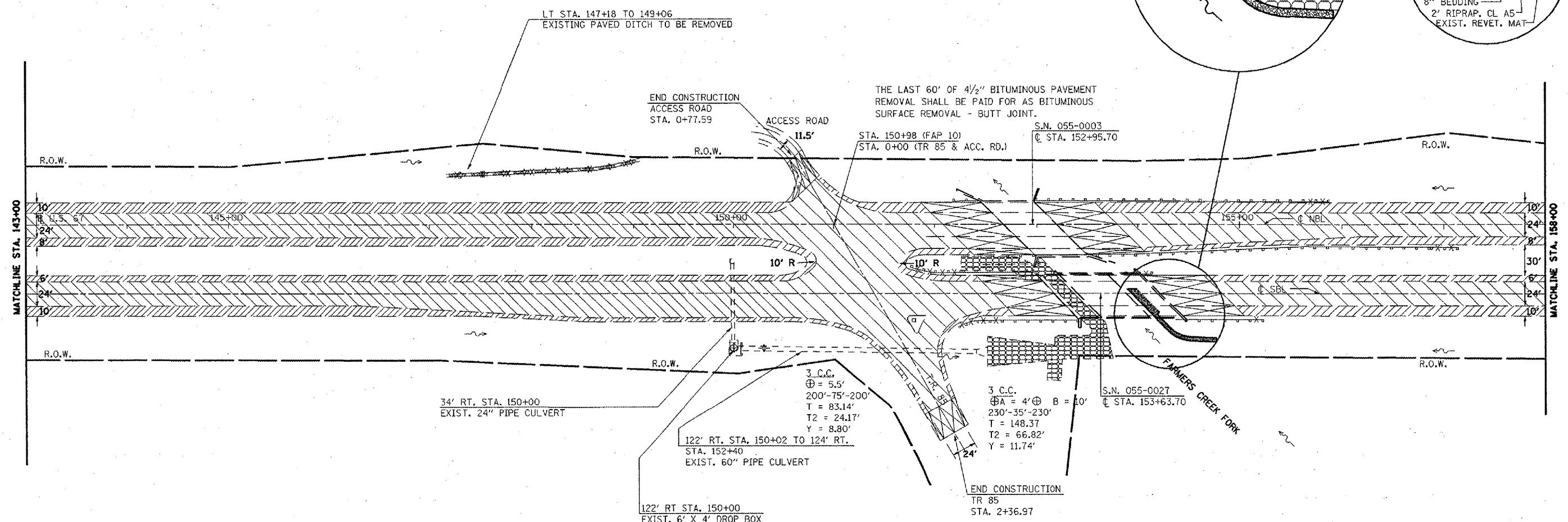

T6N R3W 4th P.M. (EMMET TWP.)
SECTION 1

EXISTING LEGEND

- CONCRETE REVETMENT MAT
- R.O.W. MARKER
- SUMMIT
- EXIST. DITCH CHECK
- PAVED DITCH
- EXIST. GUARDRAIL

REMOVAL LEGEND

- GUARDRAIL REMOVAL
- CULVERT REMOVAL
- BUTT JOINT
- SHOULDER MILLING
- MEDIAN MILLING
- PAVEMENT MILLING
- END SECTION REMOVAL
- PAVED DITCH REMOVAL

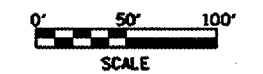

REVISIONS	
NAME	DATE

ILLINOIS DEPARTMENT OF TRANSPORTATION
EXISTING & REMOVAL
PLAN SHEET
STA. 143+00 TO 158+00

SCALE: VERT. 1" = 50'
HORIZ. 1" = 50'

DATE **DATE**

DRAWN BY CADD
CHECKED BY