

F.A.P. RTE.	SECTION	COUNTY	TOTAL SHEETS	SHEET NO.
310	(38-D) RS	MCDONOUGH	83	39
STA. 278+00		TO STA. 291+00		
FED. ROAD DIST. NO.		ILLINOIS	FED. AID PROJECT	

T6N R2W 4th P.M. (MACOMB TWP.)
SECTION 18

T6N R2W 4th P.M. (MACOMB TWP.)
SECTION 19

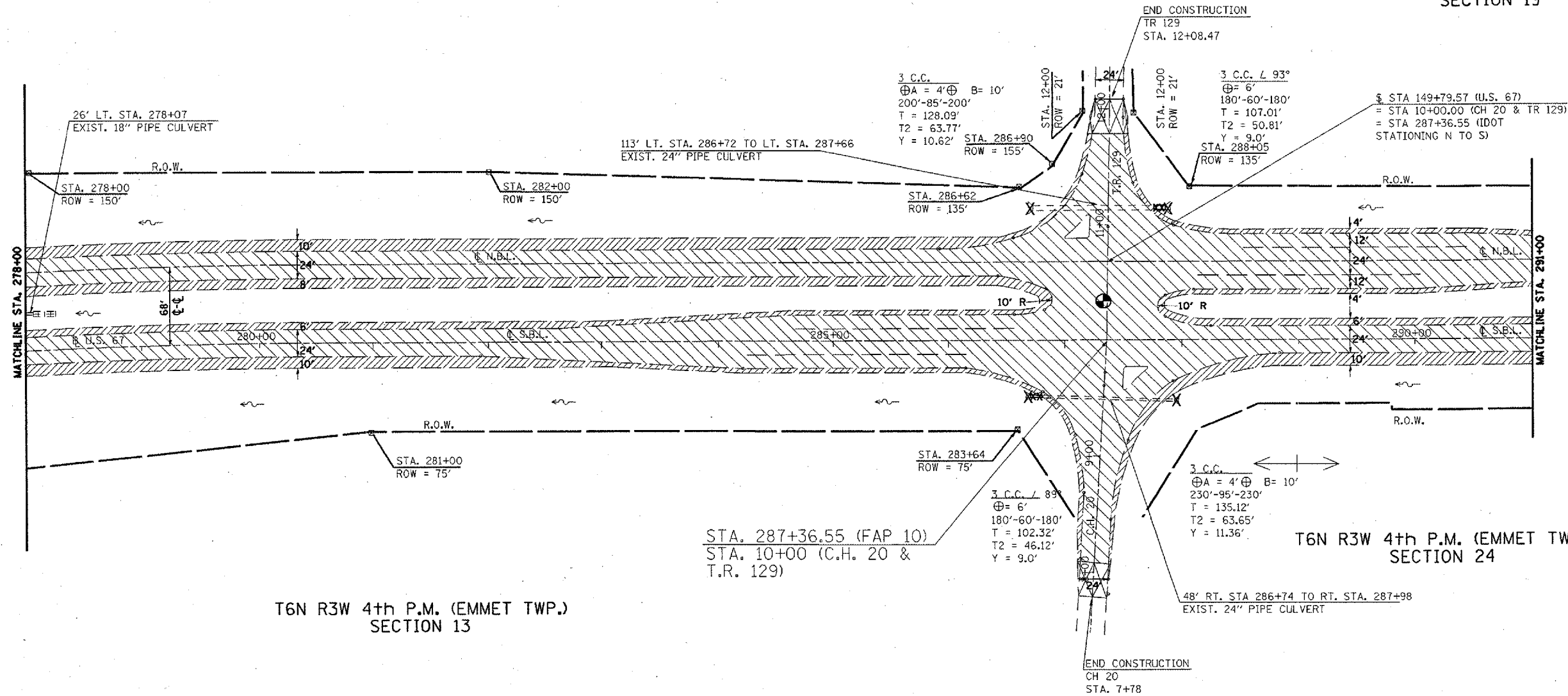

T6N R3W 4th P.M. (EMMET TWP.)
SECTION 13

T6N R3W 4th P.M. (EMMET TWP.)
SECTION 24

EXISTING LEGEND

- CONCRETE REVETMENT MAT
- R.O.W. MARKER
- SUMMIT
- EXIST. DITCH CHECK
- PAVED DITCH
- EXIST. GUARDRAIL

REMOVAL LEGEND

- GUARDRAIL REMOVAL
- CULVERT REMOVAL
- BUTT JOINT
- SHOULDER MILLING
- MEDIAN MILLING
- PAVEMENT MILLING
- END SECTION REMOVAL
- PAVED DITCH REMOVAL

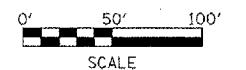

REVISIONS	
NAME	DATE

ILLINOIS DEPARTMENT OF TRANSPORTATION
EXISTING & REMOVAL
PLAN SHEET
STA. 278+00 TO 291+00

SCALE: VERT. 1" = 50'
HORIZ. 1" = 50'
DATE: ##DATE##
DRAWN BY: CADD
CHECKED BY: