

F.A.P. RTE.	SECTION	COUNTY	TOTAL SHEETS	SHEET NO.
310	(38-1) RS	MCDONOUGH	83	51
STA. 248+00		TO STA. 263+00		
FED. ROAD DIST. NO.		ILLINOIS FED. AID PROJECT		

T6N R2W 4th P.M. (MACOMB TWP.)
SECTION 18

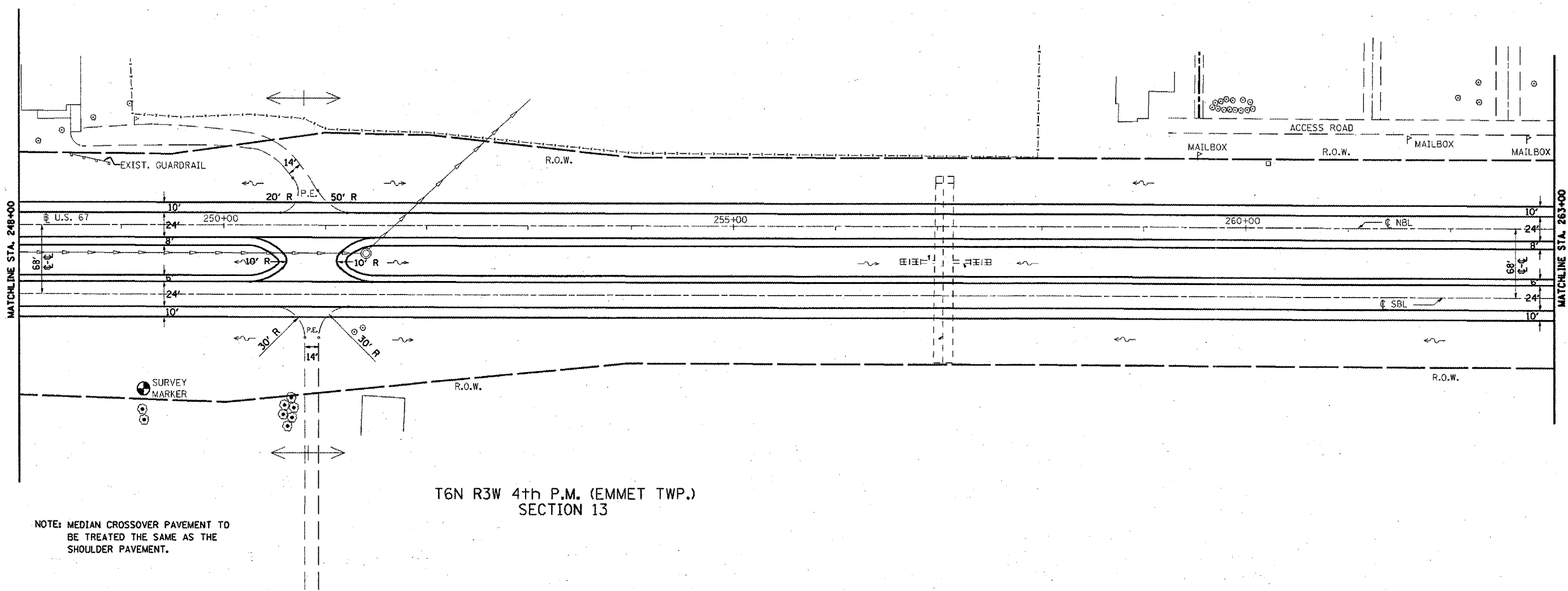

NOTE: MEDIAN CROSSOVER PAVEMENT TO BE TREATED THE SAME AS THE SHOULDER PAVEMENT.

- | EXISTING LEGEND | | PROPOSED LEGEND | |
|-----------------|------------------------|-----------------|--------------------------|
| | CONCRETE REVETMENT MAT | | GUARDRAIL |
| | R.O.W. MARKER | | DITCH CHECK |
| | SUMMIT | | END SECTION REPLACEMENT |
| | EXIST. DITCH CHECK | | PIPE CULVERT REPLACEMENT |
| | PAVED DITCH | | DITCH GRADING |
| | EXIST. GUARDRAIL | | INLET PROTECTION |
| | | | RIPRAP A-5 |
| | | | AGGREGATE DITCH |

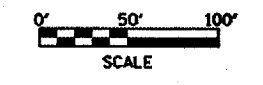

REVISIONS	
NAME	DATE

ILLINOIS DEPARTMENT OF TRANSPORTATION
PROPOSED PLAN SHEET
 STA. 248+00 TO 263+00
 SCALE: VERT. 1" = 50'
 HORIZ. 1" = 100'
 DATE **DATE**
 DRAWN BY CADD
 CHECKED BY