

STATE OF ILLINOIS
DEPARTMENT OF TRANSPORTATION

F.A.I. RTE.	SECTION	COUNTY	TOTAL SHEETS	SHEET NO.
80	D3 PATCHING 2017-2	GRUNDY	14	1
		ILLINOIS	CONTRACT NO. 66F40	

- INDEX OF SHEETS**
- COVER SHEET
 - GENERAL NOTES
 - SUMMARY OF QUANTITIES
 - TYPICAL SECTIONS
 - SCHEDULES
 - TRAFFIC CONTROL AND PROTECTION, STANDARD 701400 (SPECIAL)
 - TYPICAL PAVEMENT MARKINGS
 - CLASS A PATCHING DETAILS
 - CLASS B PATCHING DETAILS

- STANDARDS**
- 000001-06 STANDARD SYMBOLS, ABBREVIATIONS AND PATTERNS
 - 001001-02 AREAS OF REINFORCEMENT BARS
 - 001006 DECIMAL OF AN INCH AND OF A FOOT
 - 420001-08 PAVEMENT JOINTS
 - 420701-03 PAVEMENT WELDED WIRE REINFORCEMENT
 - 421001-03 BAR REINFORCEMENT FOR CRC PAVEMENT
 - 701101-05 OFF-ROAD OPERATIONS, MULTILANE, 15' (4.5 m) TO 24' (600 mm) FROM PAVEMENT EDGE
 - 701401-09 LANE CLOSURE, FREEWAY/EXPRESSWAY
 - 701411-09 LANE CLOSURE, MULTILANE, AT ENTRANCE OR EXIT RAMP FOR SPEEDS ≥ 45 MPH
 - 701426-08 LANE CLOSURE, MULTILANE INTERMITTENT OR MOVING OPERATION, FOR SPEEDS ≥ 45 MPH
 - 701428-01 TRAFFIC CONTROL, SETUP AND REMOVAL, FREEWAY/EXPRESSWAY
 - 701901-05 TRAFFIC CONTROL DEVICES

PROPOSED HIGHWAY PLANS

F.A.I. 80 (I-80) SECTION D3 PATCHING 2017-2 PAVEMENT PATCHING GRUNDY COUNTY

C-93-074-16

IMPROVEMENT ENDS
0.30 MILES EAST
OF BRISBIN ROAD
(M.M. 116)

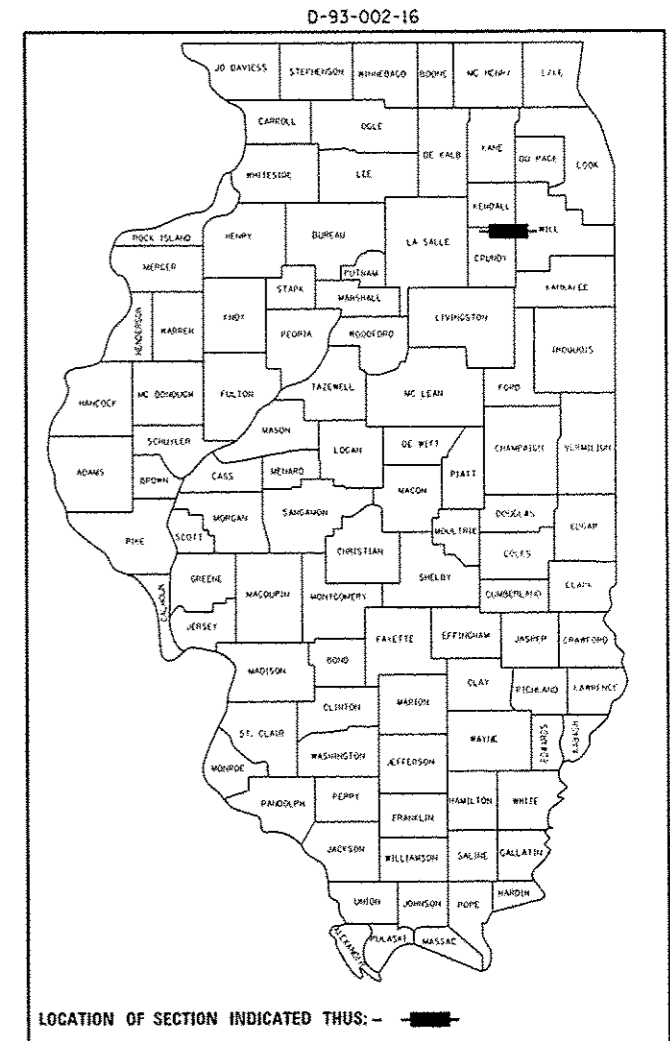

RURAL INTERSTATE
FAI 80 (I-80)
2015

ADT	37000
P.V.	81.60%
S.U.	6.40%
M.U.	12.00%

IMPROVEMENT BEGINS
LASALLE/GRUNDY COUNTY LINE
M.M. 102.99

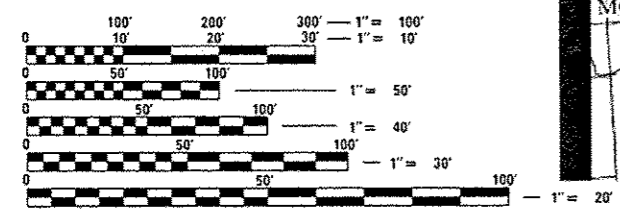
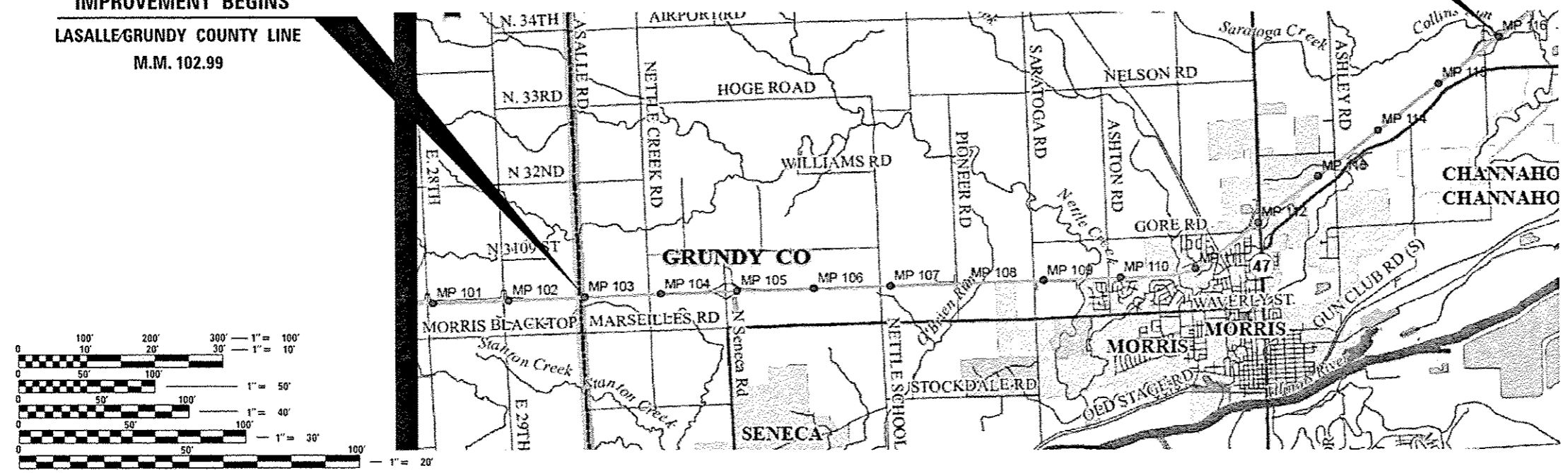

FULL SIZE PLANS HAVE BEEN PREPARED USING STANDARD ENGINEERING SCALES. REDUCED SIZED PLANS WILL NOT CONFORM TO STANDARD SCALES. IN MAKING MEASUREMENTS ON REDUCED PLANS, THE ABOVE SCALES MAY BE USED.

J.U.L.I.E.
JOINT UTILITY LOCATION INFORMATION FOR EXCAVATION
1-800-892-0123
OR 811

PROJECT ENGINEER: JOE KANNEL P.E.
UNIT CHIEF: RON WOODSHANK
TOWNSHIP: VARIOUS
CONTRACT NO. 66F40

GROSS LENGTH = 89760 FT. = 17.00 MILE
NET LENGTH = 678 FT. = 0.130 MILE

STATE OF ILLINOIS
DEPARTMENT OF TRANSPORTATION

SUBMITTED May 19 2016
Paul Coste
REGIONAL ENGINEER

July 1 2016
Maureen M. Addis, P.E.
ENGINEER OF DESIGN AND ENVIRONMENT

July 1 2016
Andrew
DIRECTOR OF PROGRAM DEVELOPMENT

PRINTED BY THE AUTHORITY
OF THE STATE OF ILLINOIS

GENERAL NOTES

PLAN DIMENSIONS AND DETAILS RELATIVE TO EXISTING PLANS ARE SUBJECT TO NOMINAL CONSTRUCTION VARIATIONS. THE CONTRACTOR SHALL FIELD VERIFY EXISTING DIMENSIONS AND DETAILS AFFECTING NEW CONSTRUCTION AND MAKE NECESSARY APPROVED ADJUSTMENTS PRIOR TO CONSTRUCTION OR ORDERING OF MATERIALS. SUCH VARIATIONS SHALL NOT BE CAUSE FOR ADDITIONAL COMPENSATION FOR A CHANGE IN SCOPE OF WORK; HOWEVER, THE CONTRACTOR WILL BE PAID FOR THE QUANTITY ACTUALLY FURNISHED AT THE UNIT PRICE BID FOR THE WORK.

ALL EXCAVATED MATERIAL, WHICH INCLUDES DIGGING OR GRADING OF ANY SOIL OR FILL MATERIAL, WITH THE EXCEPTION OF AGGREGATE FILLS, MUST BE INCORPORATED WITHIN THE IDOT RIGHT OF WAY DUE TO ENVIRONMENTAL DOCUMENTATION REQUIREMENTS.

ANY REFERENCE TO A STANDARD IN THESE PLANS SHALL BE INTERPRETED TO MEAN THE EDITION AS INDICATED BY THE SUBNUMBER SHOWN IN THE LIST OF STANDARDS OR THE COPY INCLUDED IN THESE PLANS.

THE FOLLOWING RATES OF APPLICATION HAVE BEEN USED IN CALCULATING PLAN QUANTITIES:

THE CONTRACTOR SHALL CONTACT JULIE AT LEAST 48 HOURS PRIOR TO EXCAVATION TO DETERMINE WHICH UTILITIES ARE IN THE AREA.

COMMITMENTS

STATE OF ILLINOIS
DEPARTMENT OF TRANSPORTATION
DISTRICT THREE
AS BUILT INFORMATION

SUPERVISING CONSTRUCTION FIELD ENGINEER

RESIDENT ENGINEER / TECHNICIAN

START & END DATES
OF CONSTRUCTION:

INSPECTORS:

DATE: May 19, 2016

PREPARED BY: *Don Beavis*
DISTRICT STUDIES & PLANS ENGINEER

EXAMINED BY: *Sheld K. Jones*
DISTRICT CONSTRUCTION ENGINEER

Wye Phillips
DISTRICT MATERIALS ENGINEER

Tom H. Hagen
DISTRICT OPERATIONS ENGINEER

STATE OF ILLINOIS
DEPARTMENT OF TRANSPORTATION

GENERAL NOTES

FILE NAME : p:\11\084C81D1FEG\11\1011\gpa\IDOT\00	USER NAME : rootshock-1	DESIGNED - RW	REVISED -	STATE OF ILLINOIS DEPARTMENT OF TRANSPORTATION	GENERAL NOTES	F.A.I. RTE. 80	SECTION D3 PATCHING 2017-2	COUNTY GRUNDY	TOTAL SHEETS 14	SHEET NO. 2	
DRAWN Date: 03/06/16 RW-shd-detailed.dgn	CHECKED - EP	REVISED -	SCALE:			SHEET 1 OF 1 SHEETS	STA. TO STA.	CONTRACT NO. 66F40		ILLINOIS FED. AID PROJECT	
PLOT SCALE : 100,0000 1/16"	DATE - 4/1/2016	REVISED -									
PLOT DATE : 5/19/2016	REVISED -										

CODE NO.	ITEM	UNIT	TOTAL QUANTITY	CONSTR. CODE
				CONT. MAINT.
				100% STATE
				ROADWAY
				0005
				RURAL
44200050	WELDED WIRE REINFORCEMENT	SO YD	126	126
44200620	CLASS A PATCHES, TYPE II, 14 INCH	SO YD	32	32
44200624	CLASS A PATCHES, TYPE III, 14 INCH	SO YD	16	16
44200628	CLASS A PATCHES, TYPE IV, 14 INCH	SO YD	80	80
44200645	CLASS A PATCHES, TYPE II, 16 INCH	SO YD	193	193
44200646	CLASS A PATCHES, TYPE III, 16 INCH	SO YD	37	37
44200647	CLASS A PATCHES, TYPE IV, 16 INCH	SO YD	345	345
44201043	CLASS B PATCHES, TYPE II, 16 INCH	SO YD	64	64
44201048	CLASS B PATCHES, TYPE IV, 16 INCH	SO YD	126	126
44201299	DOWEL BARS 1 1/2"	EACH	200	200
44213000	PATCHING REINFORCEMENT	SO YD	703	703
44213200	SAW CUTS	FOOT	3559	3559
44213204	TIE BARS 3/4"	EACH	363	363
67100100	MOBILIZATION	LSUM	1	1

14

CODE NO.	ITEM	UNIT	TOTAL QUANTITY	CONSTR. CODE	
				CONT. MAINT. 100% STATE	
				ROADWAY	
				0005	RURAL
70100420	TRAFFIC CONTROL AND PROTECTION, STANDARD 701411	EACH	12		12
70103815	TRAFFIC CONTROL SURVEILLANCE	CAL DA	10		10
70106800	CHANGEABLE MESSAGE SIGN	CAL MO	2		2
70200100	NIGHTTIME WORK ZONE LIGHTING	LSUM	1		1
78008210	POLYUREA PAVEMENT MARKING TYPE I - LINE 4"	FOOT	670		670
78008230	POLYUREA PAVEMENT MARKING TYPE I - LINE 6"	FOOT	560		560
X0326880	MESSAGE BOARD VEHICLE DRIVER	HOUR	300		300
X0326907	PORTABLE, VEHICLE MOUNTED, CHANGEABLE MESSAGE SIGN	CAL MO	1		1
X7010410	SPEED DISPLAY TRAILER	CAL MO	1		1
X7010805	TRAFFIC CONTROL AND PROTECTION, STANDARD 701401 (SPECIAL)	LSUM	1		1

10 •SPECIALITY ITEMS

FILE NAME :	USER NAME :	DESIGNED -	REVISED -	STATE OF ILLINOIS DEPARTMENT OF TRANSPORTATION	SUMMARY OF QUANTITIES	F.A.I. RTE.	SECTION	COUNTY	TOTAL SHEETS	SHEET NO.	
\\B:\0848\01\HTEG\Illinois.gov\PW\DOT\Dot	uranta\DOT Offices\District 3\Projects\036	DRAWN	REVISED			80	03 PATCHING 2017-2	GRUNDY	14	4	
		CHECKED -	REVISED -			CONTRACT NO. 66F40					
Default	PLOT SCALE = 100.0000 / in.	DATE -	REVISED -			SCALE:	SHEET 2 OF 2 SHEETS	STA.	TO STA.	ILLINOIS FED. AID PROJECT	
	PLOT DATE = 5/18/2016										

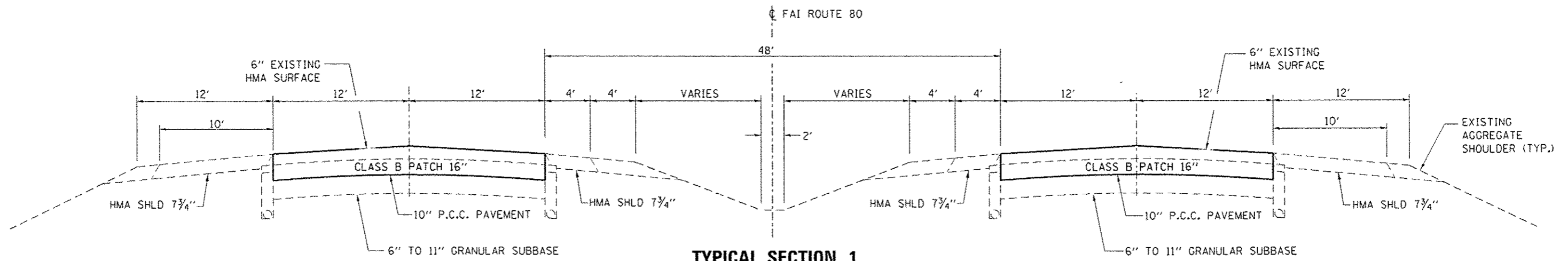

TYPICAL SECTION 1
M.M. 102.99 – M.M. 105.40

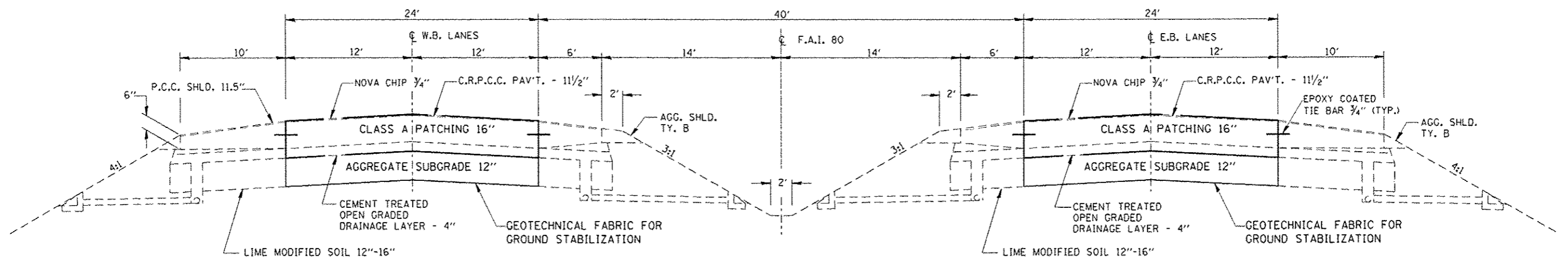

TYPICAL SECTION 2
M.M. 105.40 – M.M. 111.71

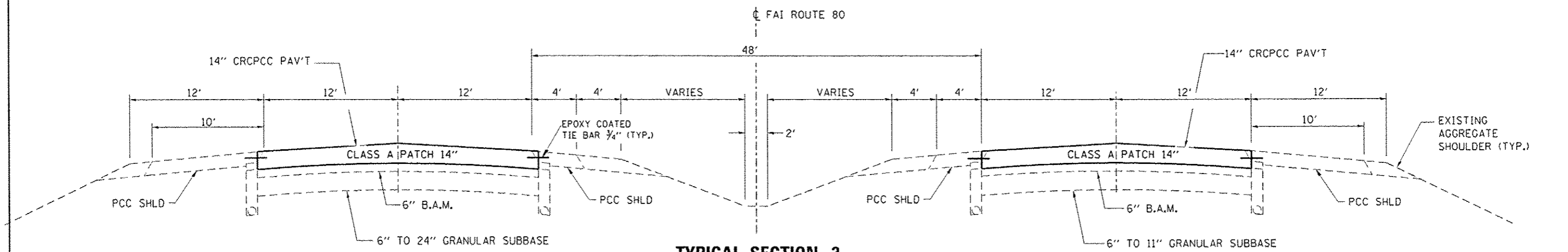

TYPICAL SECTION 3
M.M. 111.71 – M.M. 116.00

FILE NAME: p:\11084EBID\INTEG\Illinois.gov\PM\DOT\Documents\1001\Offices\District 3\Projects\0366\Drawings\0366F\RW\ht-details.dgn	USER NAME: woodshank	DESIGNED - RW	REVISED -	STATE OF ILLINOIS DEPARTMENT OF TRANSPORTATION	TYPICAL SECTIONS	F.A.I. RTE. 80	SECTION D3 PATCHING 2017-2	COUNTY GRUNDY	TOTAL SHEETS 14	SHEET NO. 5	
PLOT SCALE: 100,000 / 1"	CHECKED - EP	DATE - 4/1/2016	REVISED -			SCALE: SHEET 1 OF 1 SHEETS	STA. TO STA.	ILLINOIS FED. AID PROJECT CONTRACT NO. 66F40			
PLOT DATE: 5/18/2016	DATE - 4/1/2016	REVISED -	REVISED -								

SCHEDULE - CLASS A PATCHING 14" FOR WESTBOUND LANES

LOCATION	PASSING LANE				DRIVING LANE						
	PASSING LANE	CLASS A TYPE II 14"	PATCH REINF.	SAW CUTS	DRIVING LANE	TYPE II 14"	CLASS A TYPE III 14"	TYPE IV 14"	PATCH REINF.	SAW CUTS	TIE BARS 3/4"
MILE MARKER	FEET	SQ YD	SQ YD	FOOT	FEET	SQ YD	SQ YD	SQ YD	SQ YD	FOOT	EACH
116.00					6	8			8	54	
115.90					40			53	53	156	40
115.30					6	8			8	54	
114.80					12		16		16	72	
114.80	6	8	8	54							
114.70					20			27	27	96	20
114.50					6	8			8	54	
TOTALS	6	8	8	54	90	24	16	80	120	486	60

SCHEDULE - CLASS A PATCHING 16" FOR WESTBOUND LANES

LOCATION	PASSING LANE					DRIVING LANE					
	PASSING LANE	CLASS A TYPE IV 16"	PATCH REINF.	SAW CUTS	TIE BARS 3/4"	DRIVING LANE	CLASS A TYPE II 16"	TYPE IV 16"	PATCH REINF.	SAW CUTS	TIE BARS 3/4"
MILE MARKER	FEET	SQ YD	SQ YD	FOOT	EACH	FEET	SQ YD	SQ YD	SQ YD	FOOT	EACH
111.70						10	13		13	66	
111.70						25		33	33	111	24
111.70	20	27	27	96	20						
110.50						6	8		8	54	
110.50						6	8		8	54	
107.00						6	8		8	54	
105.80						6	8		8	54	
105.80						6	8		8	54	
105.60						6	8		8	54	
TOTALS	20	27	27	96	20	71	61	33	94	501	24

SCHEDULE - CLASS B 16" PATCHING FOR WESTBOUND LANES

LOCATION	PASSING LANES				DRIVE LANES			
	PATCH LENGTH	CLASS B TYPE II 16"	DOWEL BARS 1 1/2"	SAW CUTS	PATCH LENGTH	CLASS B TYPE II 16"	DOWEL BARS 1 1/2"	SAW CUTS
MILE MARKER	(FT)	SQ YD	EACH	FOOT	(FT)	SQ YD	EACH	FOOT
105.40	6	8	20	48				
105.40					6	8	20	48
104.60	6	8	20	48				
104.40	6	8	20	48				
104.30	6	8	20	48				
103.10	6	8	20	48				
SUBTOTALS	30	40	100	240	6	8	20	48

PAVEMENT MARKING SCHEDULE
EASTBOUND

LOCATION	POLYUREA PAVEMENT MARKING LINE 4"		POLYUREA PAVEMENT MARKING LINE 6"
	FEET		FEET
	YELLOW	WHITE	WHITE
MILE POST			
104.00	6		10
104.80		25	20
104.80		6	10
105.40		70	30
105.50		23	20
105.50		6	10
105.70		7	10
105.70		6	10
105.70		15	10
105.70		11	10
105.80		6	10
105.80		8	10
105.80		20	10
105.80	80		30
105.90	90		40
105.90	13		10
105.90	6		10
106.20		6	10
106.40		6	10
107.70	6		10
107.70		7	10
108.80		6	10
109.40		6	10
109.70	6		10
111.20	6		10
SUBTOTAL	213	234	
TOTALS		447	340

PAVEMENT MARKING SCHEDULE
WESTBOUND

LOCATION	POLYUREA PAVEMENT MARKING LINE 4"		POLYUREA PAVEMENT MARKING LINE 6"
	FEET		FEET
	YELLOW	WHITE	WHITE
MILE POST			
116.00		6	10
115.90		40	10
115.30		6	10
114.80		12	10
114.80	6		10
114.70		20	10
114.50		6	10
111.70		10	10
111.70		25	10
111.70	20		10
110.50		6	10
110.50		6	10
107.00		6	10
105.80		6	10
105.80		6	10
105.60		6	10
105.40	6		10
105.40		6	10
104.60	6		10
104.40	6		10
104.30	6		10
103.10	6		10
SUBTOTAL	56	167	
TOTALS		223	220

STATE OF ILLINOIS
DEPARTMENT OF TRANSPORTATION

SCHEDULES

F.A.I. RTE.	SECTION	COUNTY	TOTAL SHEETS	SHEET NO.
80	D3 PATCHING 2017-2	GRUNDY	14	8
CONTRACT NO. 66F40			ILLINOIS FED. AID PROJECT	

SCALE: SHEET 3 OF 3 SHEETS STA. TO STA.

FILE NAME :	USER NAME :	DESIGNED -	REVISED -
p:\110846BID\ITC\Illinois\p\110846BID\Documents\DOT Offices\District 3\Projects\0366\DRAWN\Date\0366F RW\shd-detailed.dgn	woodshankel	RW	
PLOT SCALE = 1/8"=1'-0"	CHECKED -	EP	REVISED -
PLOT DATE = 5-18-2016	DATE -	4/1/2016	REVISED -

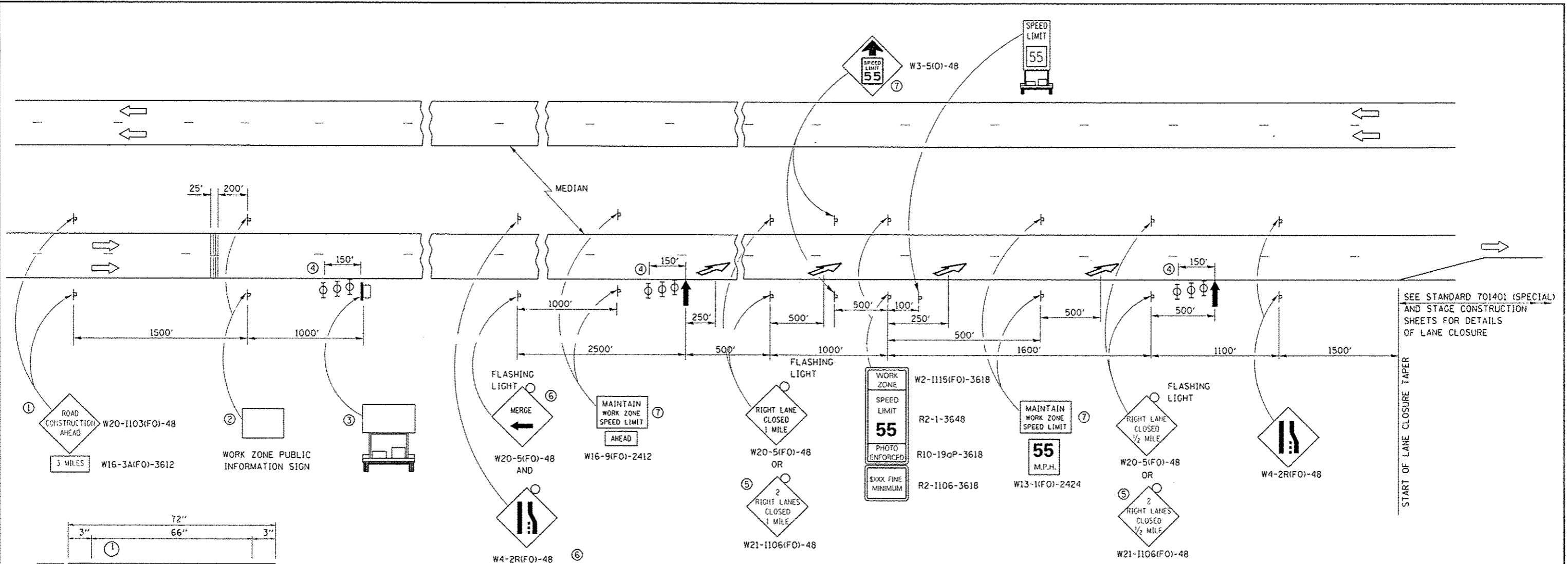

SEE STANDARD 701401 (SPECIAL) AND STAGE CONSTRUCTION SHEETS FOR DETAILS OF LANE CLOSURE

START OF LANE CLOSURE TAPER

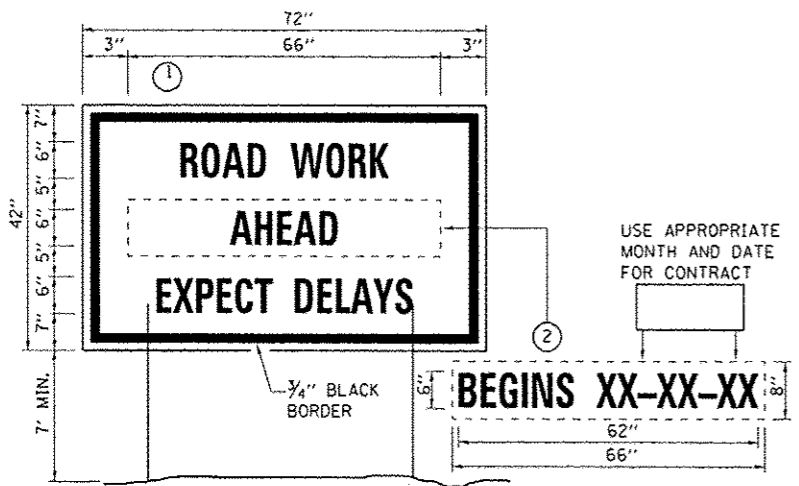

TEMPORARY INFORMATION SIGNING

- NOTES:**
- USE 6" D BLACK LETTERING ON FLOURESENT ORANGE BACKGROUND.
 - ERECT SIGNS AT LOCATIONS IN ADVANCE OF THE "ROAD CONSTRUCTION AHEAD" SIGNS AS DIRECTED BY THE ENGINEER.
 - ERECT SIGN ① WITH INSTALLED PANEL ② A MINIMUM OF ONE WEEK PRIOR TO THE START OF THE LANE CLOSURE.
 - REMOVE PANEL ② ON THAT DATE.
 - SEE SPECIAL PROVISION "TEMPORARY INFORMATION SIGNING" FOR ADDITIONAL INFORMATION.
 - WILL BE PAID FOR PER 50 FT AS "TEMPORARY INFORMATION SIGNING". EACH SIGN = 21 50 FT AND THE DATE PANEL ② WILL NOT BE MEASURED SEPARATELY FOR PAYMENT.

- THE ROAD CONSTRUCTION AHEAD SIGN SHALL BE LOCATED 3 MILES IN ADVANCE OF THE PROJECT LIMITS.
- THE MESSAGE AND SIZE OF THE WORK ZONE PUBLIC INFORMATION SIGN SHALL BE AS SPECIFIED BY THE DEPARTMENT.
- TO BE PLACED IN THE MEDIAN WHEN FEASIBLE, THE MESSAGE BOARD SHALL BE USED TO DISPLAY STATUS OF LANES WITHIN THE PROJECT. THE PRIMARY MESSAGES SHALL BE:
"RIGHT LANE CLOSED" / " x MILES AHEAD"
"LEFT LANE CLOSED" / " x MILES AHEAD"
"ALL LANES OPEN"
- THREE, TYPE II BARRICADES, DRUMS, OR VERTICAL BARRICADES AT 50' CENTERS.
- THIS SIGN SHALL BE USED WHEN 2 LANES ARE CLOSED.
- WHEN THE LEFT LANE IS CLOSED, SWITCH THESE TWO SIGNS AND THE DIRECTION OF THE MERGE ARROW.
- THIS SIGN SHALL ONLY BE USED IF THE EXISTING SPEED LIMIT IS GREATER THAN 65 MPH.

⑦ 48"x36" FLUORESCENT ORANGE SIGN WITH BLACK LETTERS.

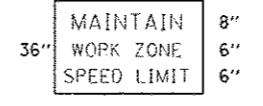

- ↑ ARROW BOARD
- PORTABLE CHANGEABLE MESSAGE SIGN
- ⊥ SIGN
- ⊙ TYPE II BARRICADE, DRUM, OR VERTICAL BARRICADE WITH MONODIRECTIONAL FLASHING LIGHT
- ↘ LANE DROP ARROW - SEE STANDARD 780001
- ▨ TEMPORARY RUMBLE STRIPS
- 🚚 SPEED DISPLAY TRAILER

GENERAL NOTE:

THIS STANDARD IS USED WHERE AT ANY TIME A LANE IS CLOSED ON A FREEWAY/EXPRESSWAY.

WHEN THE LEFT LANE IS CLOSED, LEFT LANE CLOSED SIGNS SHALL BE SUBSTITUTED FOR THE RIGHT LANE CLOSED SIGNS.

THE FIRST TWO SIGNS AND THE MESSAGE BOARD ARE STATIONARY. THE OTHER SIGNS AND ARROWBOARDS SHALL BE MOVED AS NECESSARY TO MAINTAIN THE REQUIRED DISTANCE FROM THE START OF THE LANE CLOSURE TAPER(S).

SEE SPECIAL PROVISIONS.

FILE NAME : p:\V\0848\BID\BID\TEC\Illinois.gov\FW\DOT\Documents\DOT Offices\District 3\Projects\0308\DRAWN\0308\0308\RW\shd-detailed.dgn	USER NAME : woodshankr1	DESIGNED - RW	REVISED -	STATE OF ILLINOIS DEPARTMENT OF TRANSPORTATION	TRAFFIC CONTROL AND PROTECTION, STANDARD 701400 (SPECIAL)	F.A.I. RTE.:	SECTION	COUNTY	TOTAL SHEETS	SHEET NO.
PLLOT SCALE : 100.0000 / 10.	CHECKED - EP	REVISED -	80			D3 PATCHING 2017-2	GRUNDY	14	9	
PLLOT DATE : 5/18/2016	DATE - 4/1/2016	REVISED -	CONTRACT NO. 66F40							
Default			ILLINOIS FED. AID PROJECT							

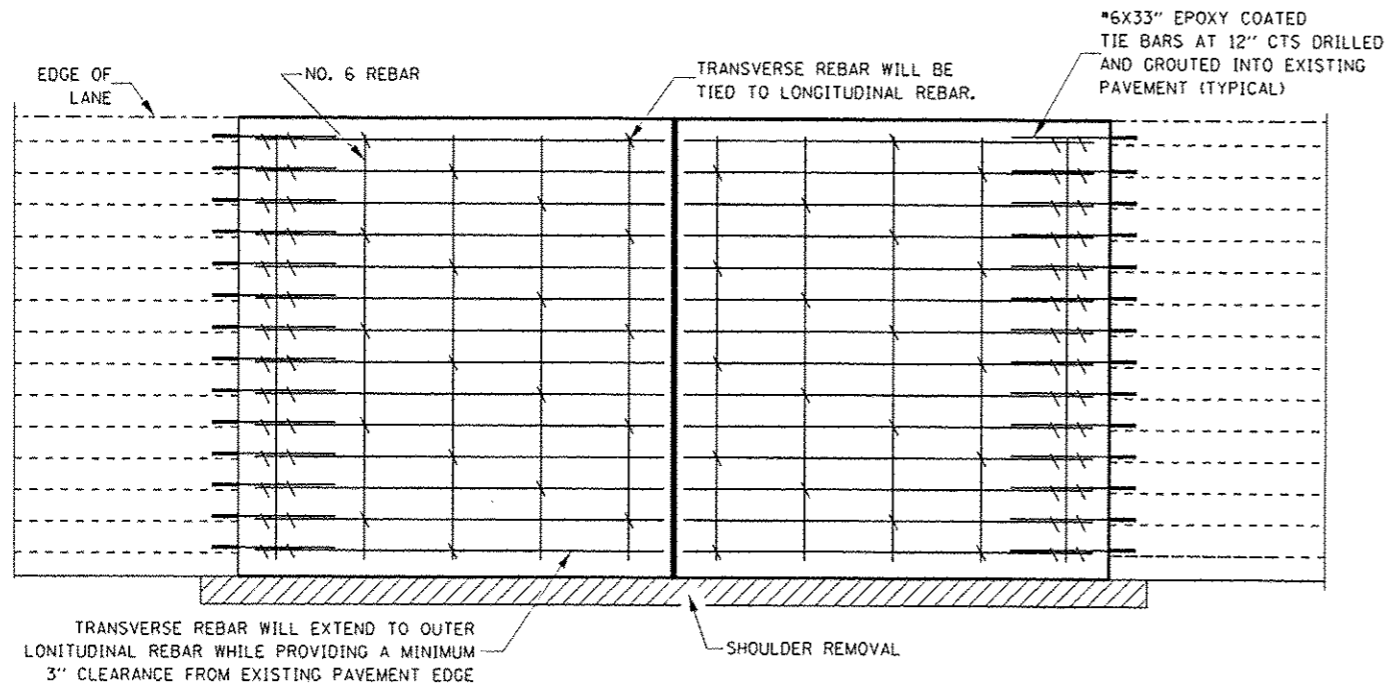

PAVEMENT REINFORCEMENT DETAIL

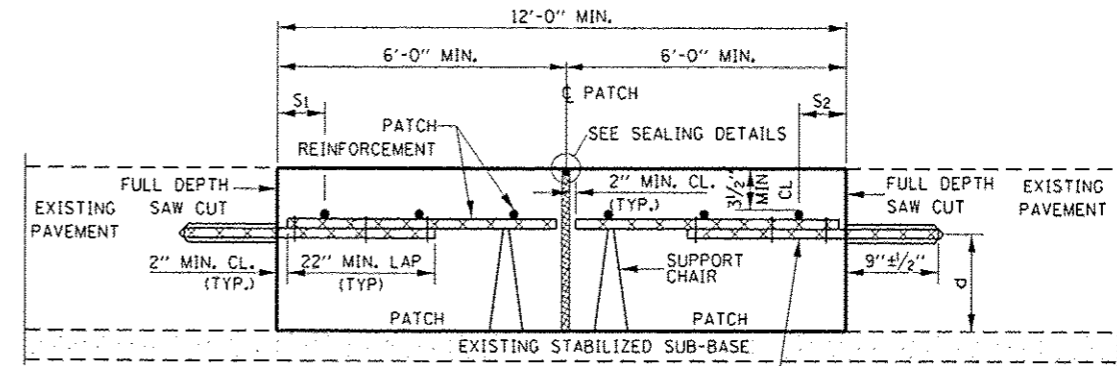

WITHOUT HMA OVERLAY

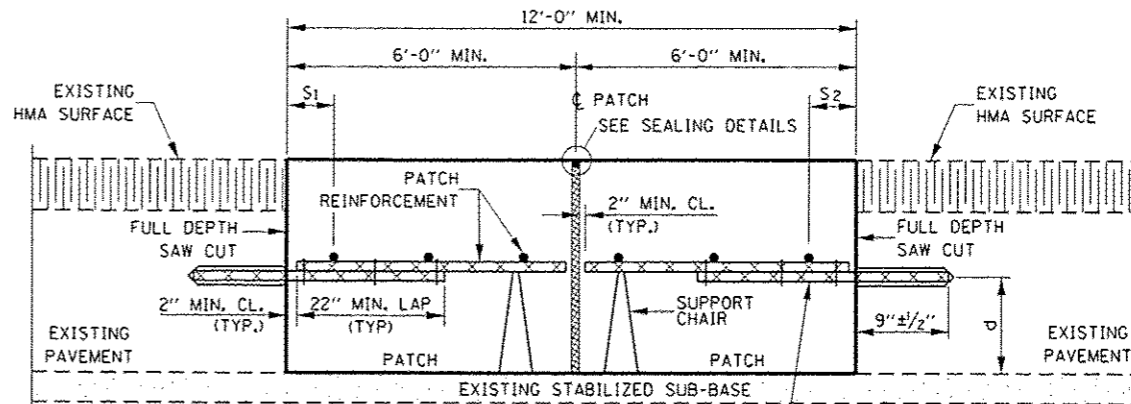

WITH HMA OVERLAY

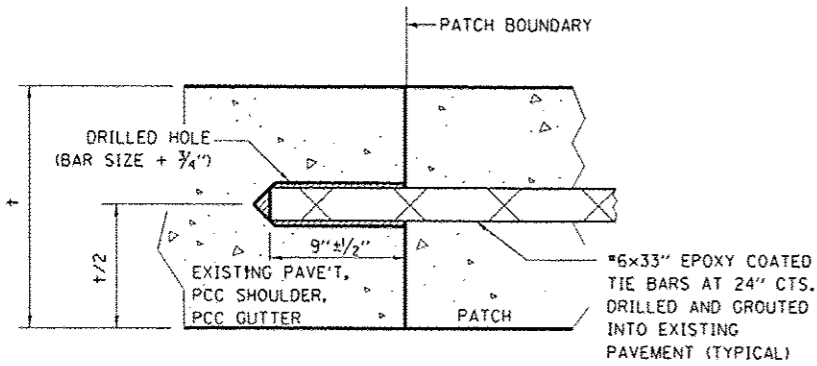

LONGITUDINAL CONSTRUCTION JOINT

PATCHES ARE OVER 20' IN LENGTH

(TIE BAR GROUDED IN PLACE)

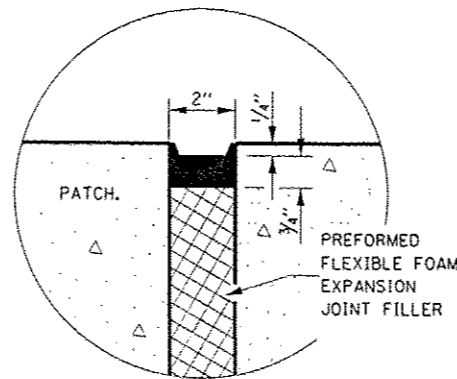

SEALING DETAIL

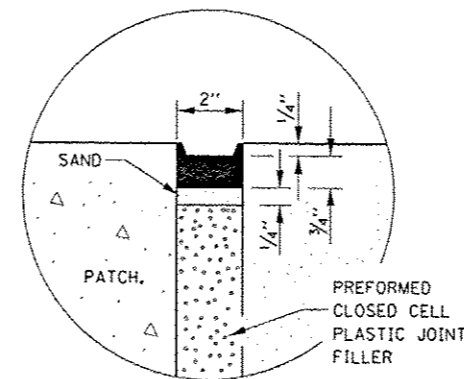

SEALING DETAIL

PATCHING DETAIL FOR CLASS A PATCHING (CRC PAVEMENT WITH EXPANSION)

NOTES:

- * EVERY THIRD INTERSECTION MUST BE TIED.
- ** WHEN THE MINIMUM CLEARANCE CANNOT BE OBTAINED WITH THE TRANSVERSE REBAR ON TOP, THEN THE TRANSVERSE REBAR SHALL BE TIED TO THE BOTTOM OF THE LONGITUDINAL REBAR.
- *** VARIABLES WHERE S_1 AND S_2 ARE $2\frac{1}{2}$ " MIN. AND 12" MAX.

LONGITUDINAL REINFORCEMENT SHALL MATCH SPACING OF EXISTING REINFORCEMENT.

SUPPORT CHAIRS SHALL BE REQUIRED WHENEVER PATCH LENGTH EXCEEDS 6'-0"

d = VERTICAL PLACEMENT OF EXISTING REINFORCEMENT.

DIAMETER OF DRILLED HOLE SHALL BE THE BAR + $\frac{3}{4}$ "

FILE NAME: p:\11\0842810\ITC\Illinois.gov\FK1001\06	USER NAME: woodstank1	DESIGNED: RW	REVISED: -
PROJECT: 1001 OFFICE: District 3: Projects: 036	DRAWN: RW	CHECKED: EP	REVISED: -
PLOT SCALE: 100:3000	DATE: 4/1/2016		
PLOT DATE: 5/18/2016			

STATE OF ILLINOIS
DEPARTMENT OF TRANSPORTATION

CLASS A PATCHING DETAILS

F.A.I. RTE.	SECTION	COUNTY	TOTAL SHEETS	SHEET NO.
80	D3 PATCHING 2017-2	GRUNDY	14	12
			CONTRACT NO. 66F40	
ILLINOIS FED. AID PROJECT				

SCALE: SHEET OF SHEETS STA. TO STA.

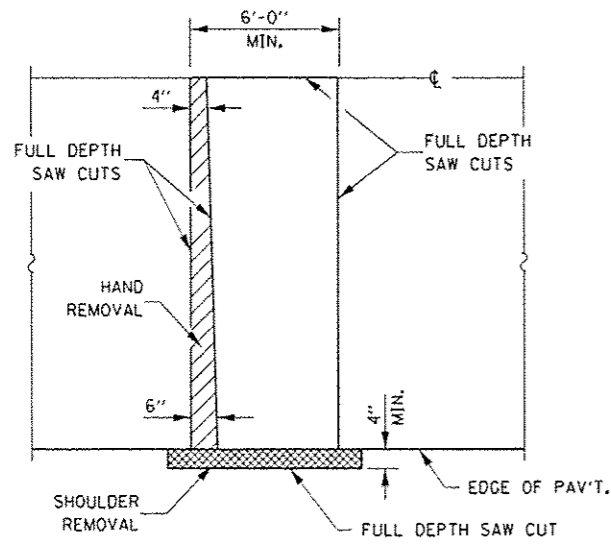

PAVEMENT SAWING DETAIL
(HMA SHOULDER)

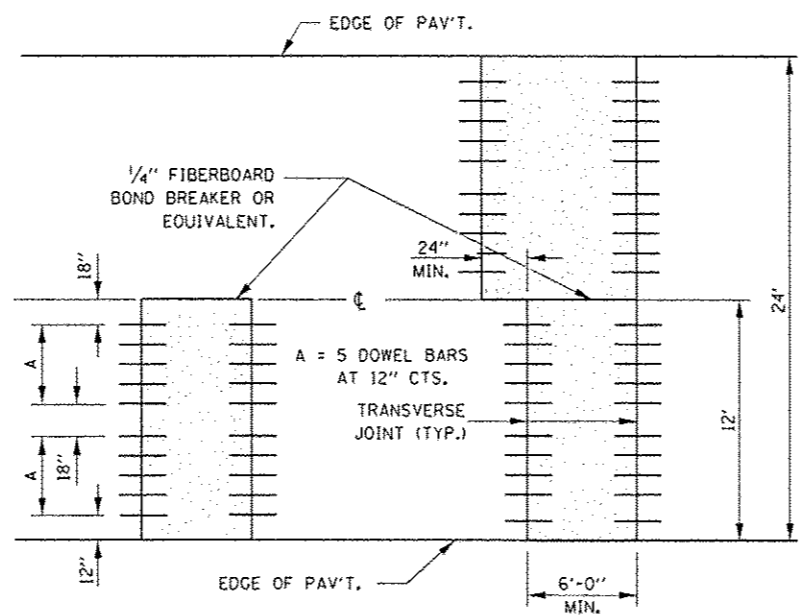

12' WIDE LANES

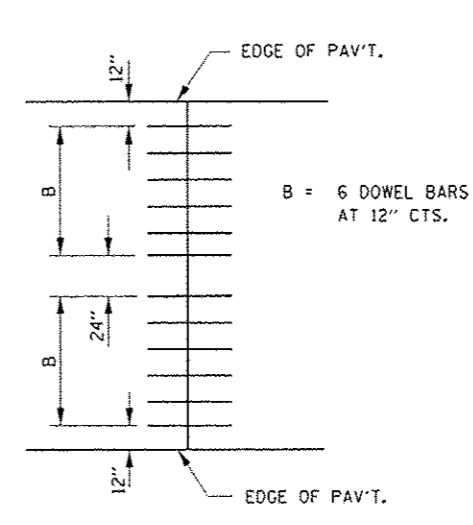

14' WIDE RAMP

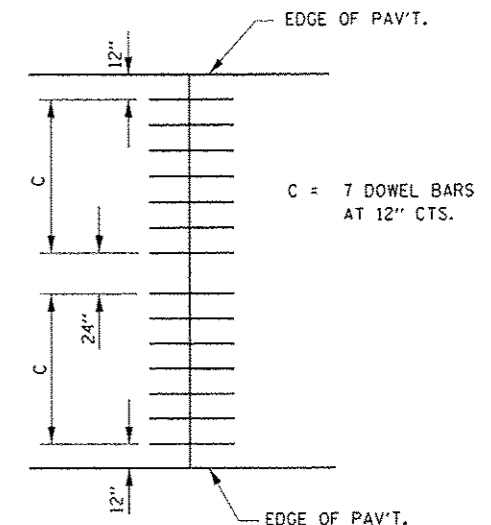

16' WIDE RAMP

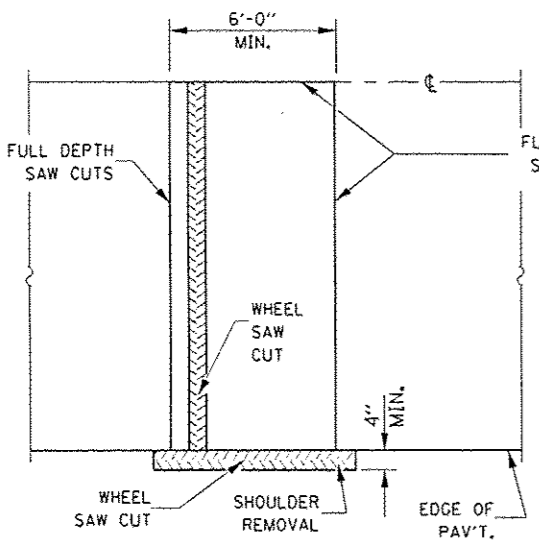

ALTERNATE SAWING DETAIL
(HMA SHOULDER)

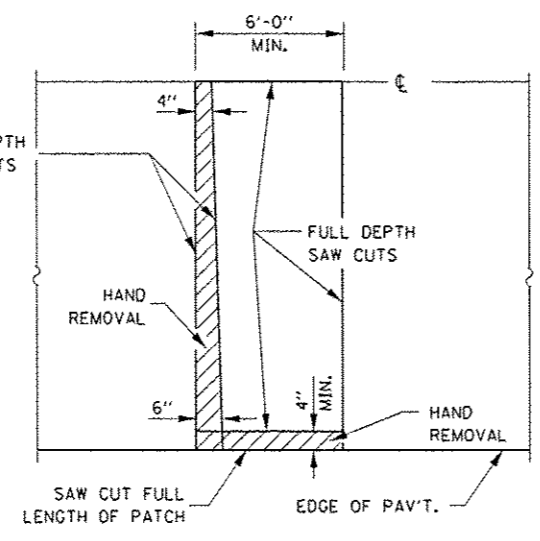

PAVEMENT SAWING DETAIL
(PCC SHOULDER)

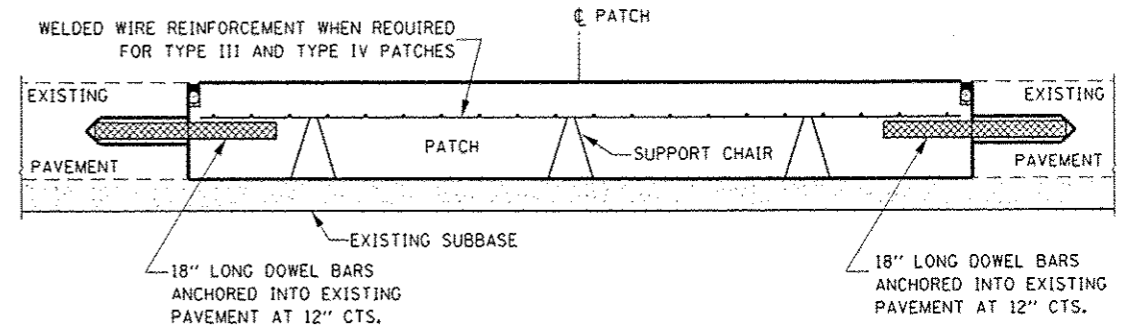

PATCHING WITHOUT HMA OVERLAY

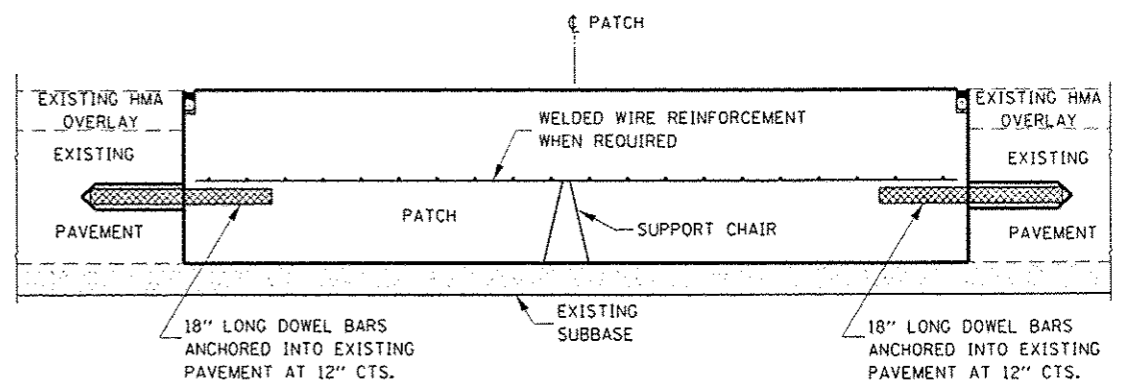

PATCHING WITH HMA OVERLAY

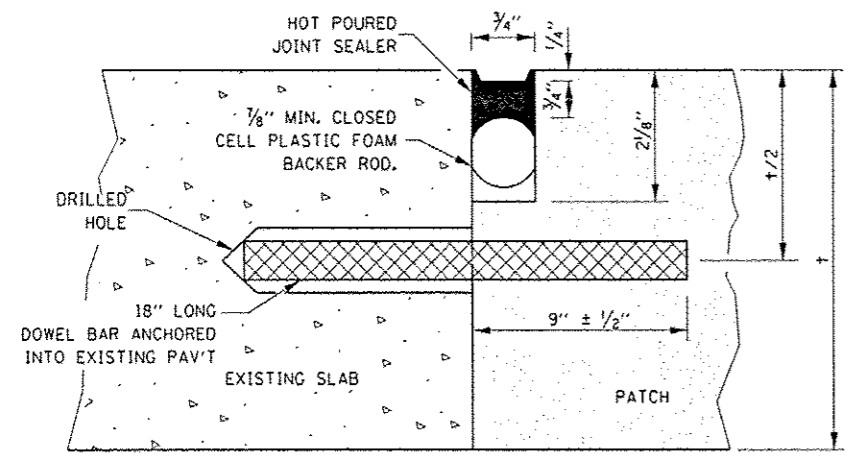

TRANSVERSE JOINT

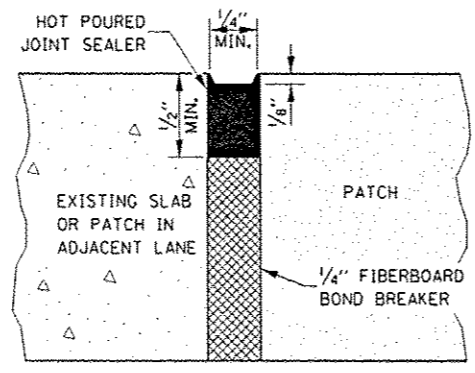

CENTERLINE JOINT

DOWEL BAR TABLE		
PAVEMENT THICKNESS	DOWEL BAR DIAMETER	HOLE DIAMETER
8" OR GREATER	1 1/2"	1 5/8"
7" THRU 7.99"	1 1/4"	1 3/8"
LESS THAN 7"	1"	1 1/8"

GENERAL NOTES

THE TRANSVERSE JOINTS FOR CLASS B PATCHES SHALL ALIGN WITH JOINTS OR CRACKS IN THE ADJACENT LANE WHENEVER POSSIBLE.
SEE STANDARD 420701 FOR DETAILS OF PAVEMENT WELDED WIRE REINFORCEMENT.

