

DATE	
BY	
SURVEYED	
PLOTTED	
NOTE BOOK	
AREAS CHECKED	

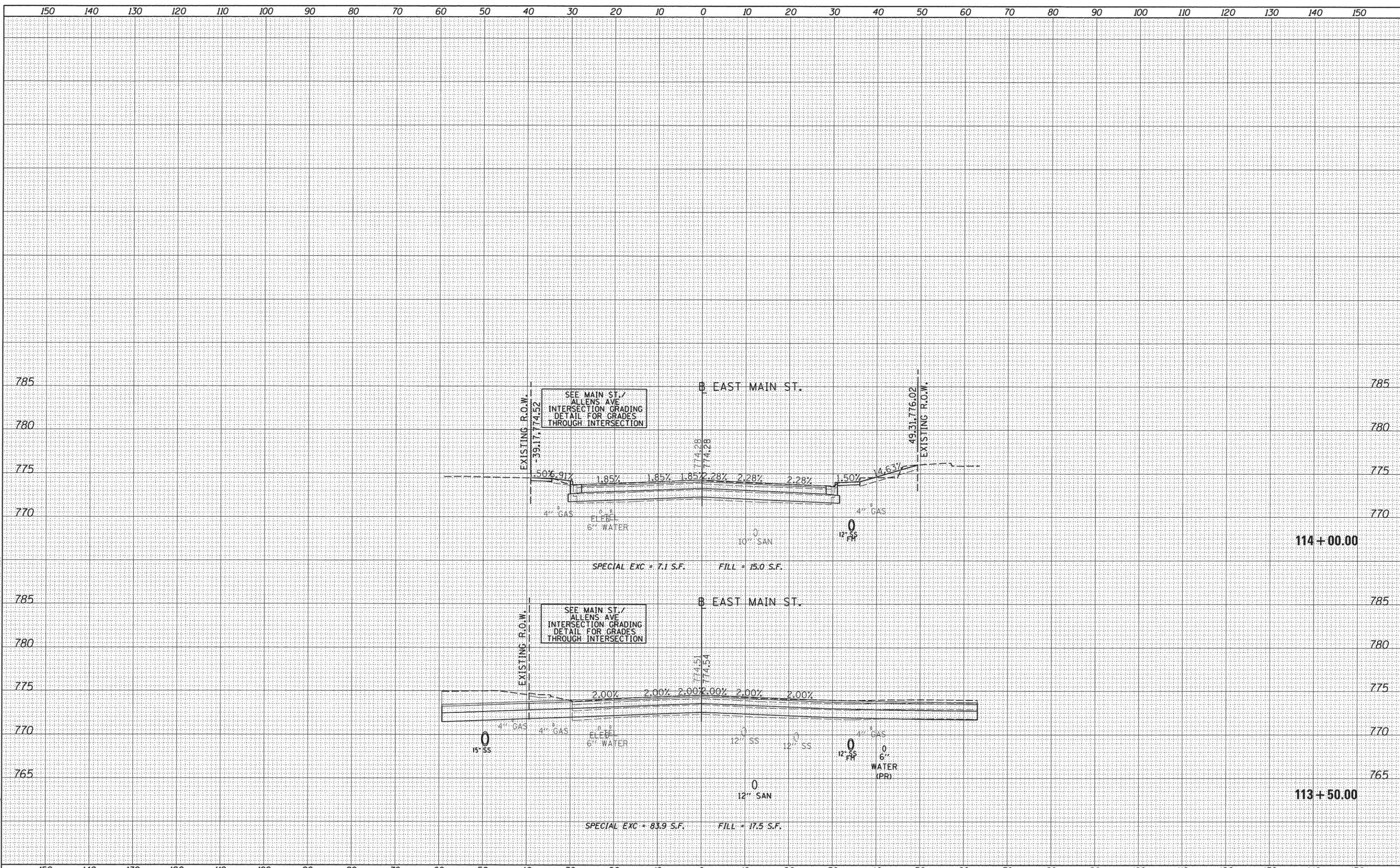

DATE	
BY	
SURVEYED	
PLOTTED	
NOTE BOOK	
AREAS CHECKED	



FILE NAME =  
 USER NAME = andr-00846  
 DESIGNED - RLA  
 DRAWN - MGD  
 CHECKED - MPB  
 DATE - 9/9/2015

REVISIONS  
 REVISED -  
 REVISED -  
 REVISED -  
 REVISED -

**STATE OF ILLINOIS  
 DEPARTMENT OF TRANSPORTATION**

**EAST MAIN STREET  
 CROSS SECTIONS**

SCALE: 1"=10'  
 SHEET OF SHEETS STA. TO STA.

F.A.U. RTE.	SECTION	COUNTY	TOTAL SHEETS	SHEET NO.
6800	05-00500-19-GS	KNOX	216	201
50VB			CONTRACT NO.89417	
ILLINOIS FED. AID PROJECT				

FINAL SURVEY	BY	DATE
PLOTTED		
NOTE BOOK		
AREAS CHECKED		



ORIGINAL SURVEY	BY	DATE
NOTE BOOK		
AREAS CHECKED		

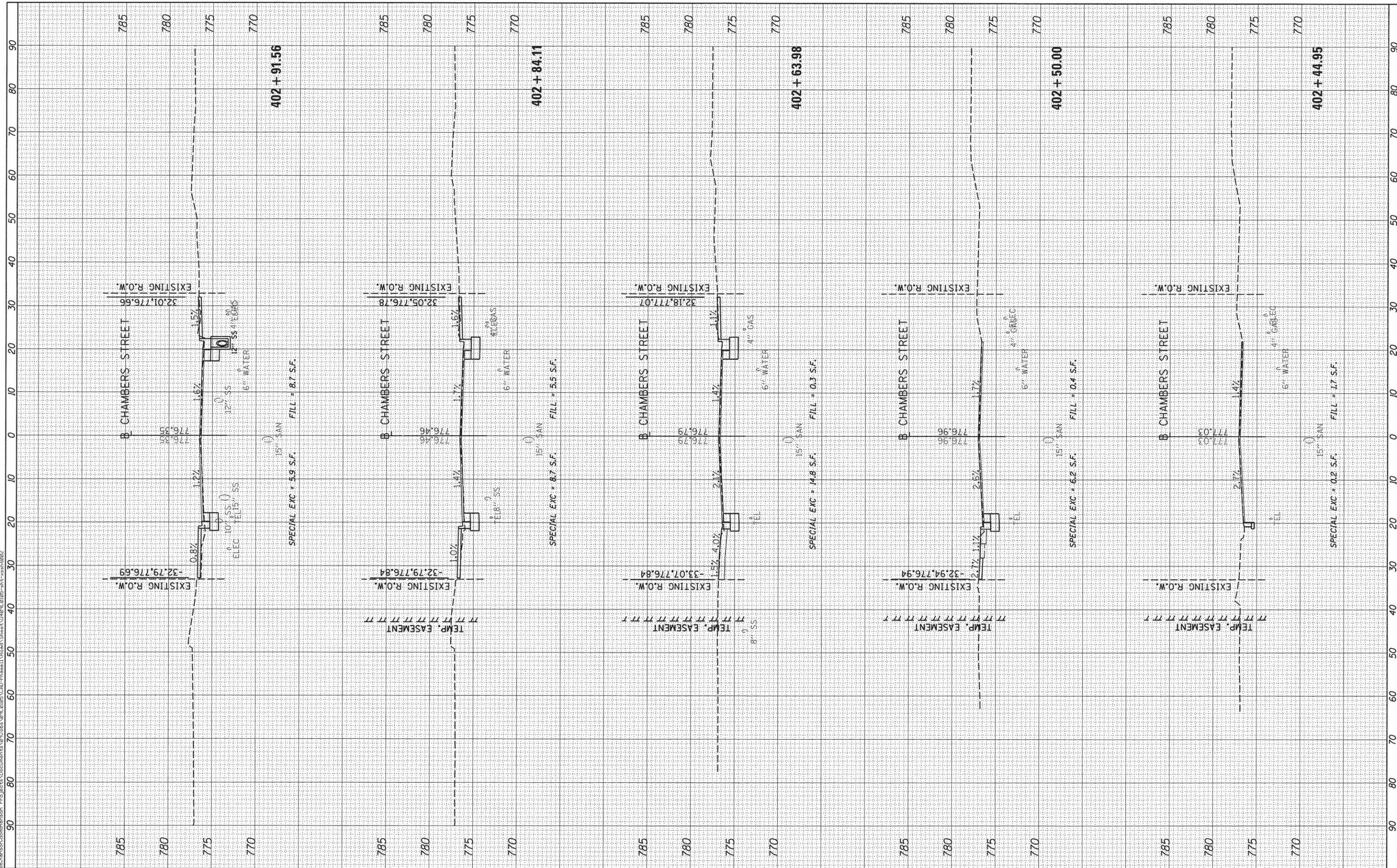

FILE NAME = c:\pwise\_work\do\_not\_delete\0273754\0409\0105\shhtxsht002.dgn  
 USER NAME = nder00846  
 PLOT SCALE = 10.0000' / 1"  
 PLOT DATE = 11/13/2015

DESIGNED - RLA  
 DRAWN - MGD  
 CHECKED - MPB  
 DATE - 9/9/2015

REVISED -  
 REVISED -  
 REVISED -  
 REVISED -

STATE OF ILLINOIS  
 DEPARTMENT OF TRANSPORTATION

CHAMBERS STREET  
 CROSS SECTIONS

SCALE: 1"=10'  
 SHEET OF SHEETS STA. 402+44.95 TO STA. 402+91.56

F.A.U. RTE.	SECTION	COUNTY	TOTAL SHEETS	SHEET NO.
6800	05-00500-19-GS	KNOX	216	202
50VB		CONTRACT NO.89417		
ILLINOIS FED. AID PROJECT				

FINAL SURVEY	BY	DATE
PLOTTED		
NOTE BOOK		
AREAS CHECKED		
NO.		



ORIGINAL SURVEY	BY	DATE
PLOTTED		
NOTE BOOK		
AREAS CHECKED		
NO.		

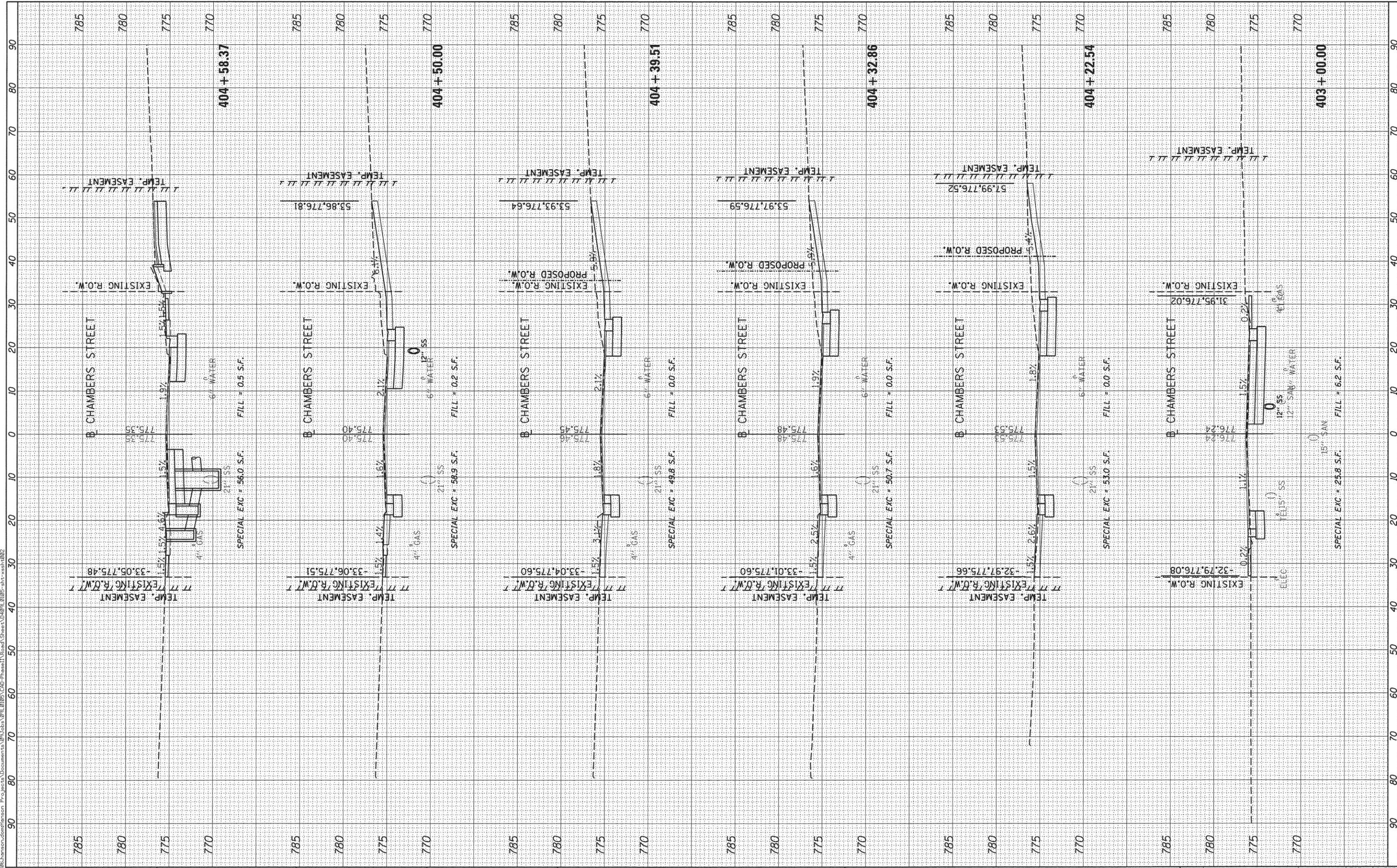

FILE NAME = c:\pwise\_work\do\_not\_delete\0273754\040\%0105\shht-xshht002.dgn  
 USER NAME = andr-00846  
 PLOT SCALE = 10.0000' / 1in.  
 PLOT DATE = 11/13/2015

DESIGNED - RLA  
 DRAWN - MGD  
 CHECKED - MPB  
 DATE - 9/9/2015

REVISED -  
 REVISED -  
 REVISED -  
 REVISED -

**STATE OF ILLINOIS  
 DEPARTMENT OF TRANSPORTATION**

SCALE: 1"=10'

SHEET OF SHEETS STA. 403+00.00 TO STA. 404+58.37

**CHAMBERS STREET  
 CROSS SECTIONS**

F.A.U. RTE.	SECTION	COUNTY	TOTAL SHEETS	SHEET NO.
6800	05-00500-19-GS	KNOX	216	203
	50VB		CONTRACT NO.89417	
ILLINOIS FED. AID PROJECT				

FINAL SURVEY	BY	DATE
PLOTTED		
NOTE BOOK		
AREAS CHECKED		
NO.		

ORIGINAL SURVEY	BY	DATE
NOTE BOOK		
TEMPLATE		
AREAS CHECKED		
NO.		

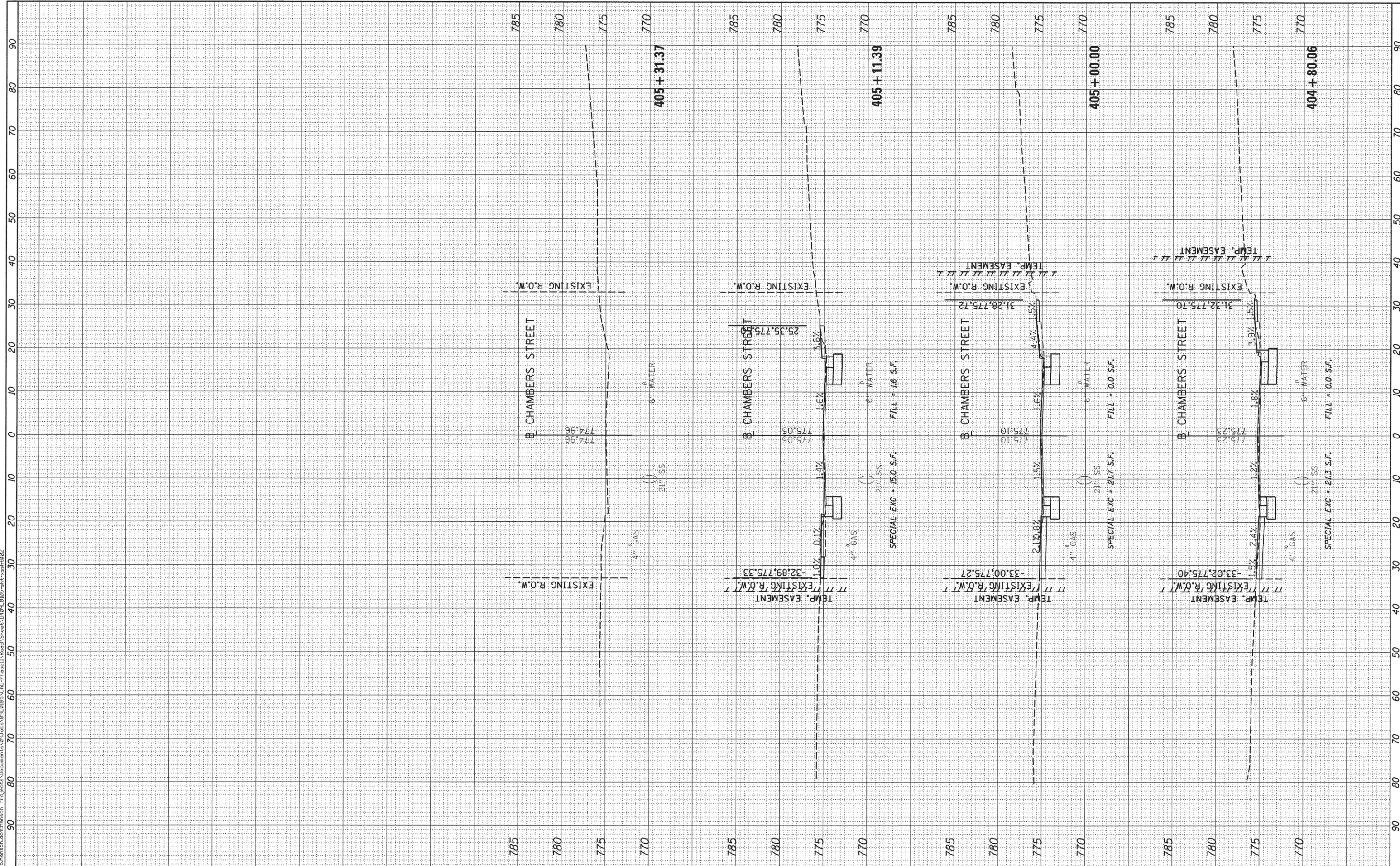

FILE NAME =  
 USER NAME = andr00846  
 c:\pwise\_work\do\_not\_delete\d0273754\0409L0105  
 sht-xsst02.dgn  
 PLOT SCALE = 10.0000' / 1"  
 PLOT DATE = 11/13/2015

DESIGNED - RLA	REVISD -
DRAWN - MGD	REVISD -
CHECKED - MPB	REVISD -
DATE - 9/9/2015	REVISD -

**STATE OF ILLINOIS  
 DEPARTMENT OF TRANSPORTATION**

**CHAMBERS STREET  
 CROSS SECTIONS**

SCALE: 1"=10'  
 SHEET OF SHEETS STA. TO STA. 405+31.37

F.A.U. RTE.	SECTION	COUNTY	TOTAL SHEETS	SHEET NO.
6800	05-00500-19-GS	KNOX	216	204
	50VB		CONTRACT NO.89417	
ILLINOIS FED. AID PROJECT				

BY	DATE
SURVEYED	
PLOTTED	
NOTE BOOK	
AREAS CHECKED	

BY	DATE
ORIGINAL SURVEY	
PLOTTED	
NOTE BOOK	
AREAS CHECKED	

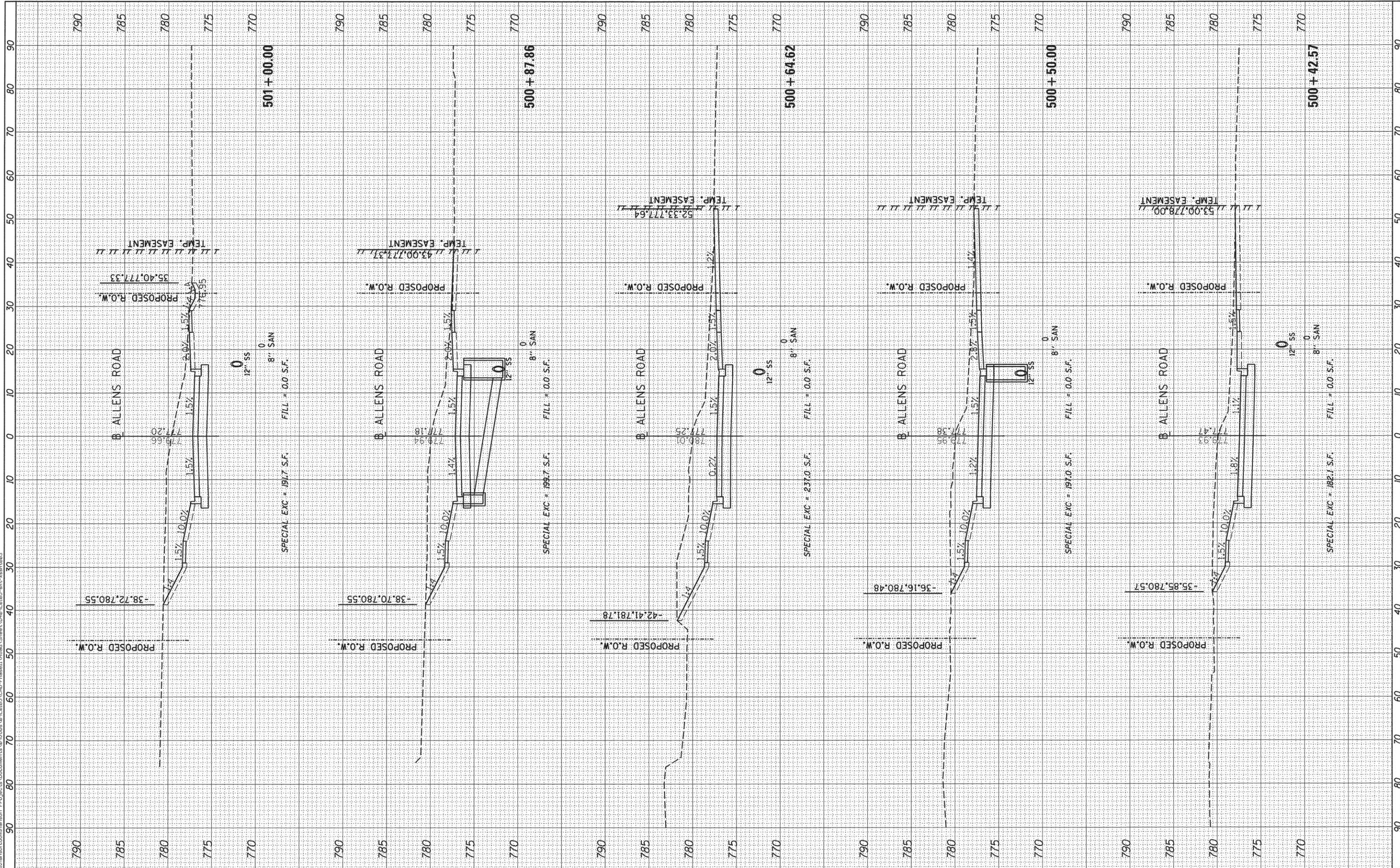

FILE NAME =  
 USER NAME = andr00846  
 c:\pwise\_work\do\_not\_delete\20273754\040\%L0105  
 sht-sssh003.dgn  
 PLOT SCALE = 10.0000' / 1" / in.  
 PLOT DATE = 11/13/2015

DESIGNED - RLA  
 DRAWN - MGD  
 CHECKED - MPB  
 DATE - 9/9/2015

REVISED -  
 REVISED -  
 REVISED -  
 REVISED -

**STATE OF ILLINOIS  
 DEPARTMENT OF TRANSPORTATION**

**ALLENS AVENUE  
 CROSS SECTIONS**

SCALE: 1"=10' SHEET OF SHEETS STA. TO STA. 501+00.00

F.A.U. RTE.	SECTION	COUNTY	TOTAL SHEETS	SHEET NO.
6800	05-00500-19-GS	KNOX	216	205
	50VB		CONTRACT NO. 89417	
ILLINOIS FED. AID PROJECT				

FINAL SURVEY	BY	DATE
PLOTTED		
NOTE BOOK		
AREAS CHECKED		
NO.		



ORIGINAL SURVEY	BY	DATE
PLOTTED		
NOTE BOOK		
AREAS CHECKED		
NO.		

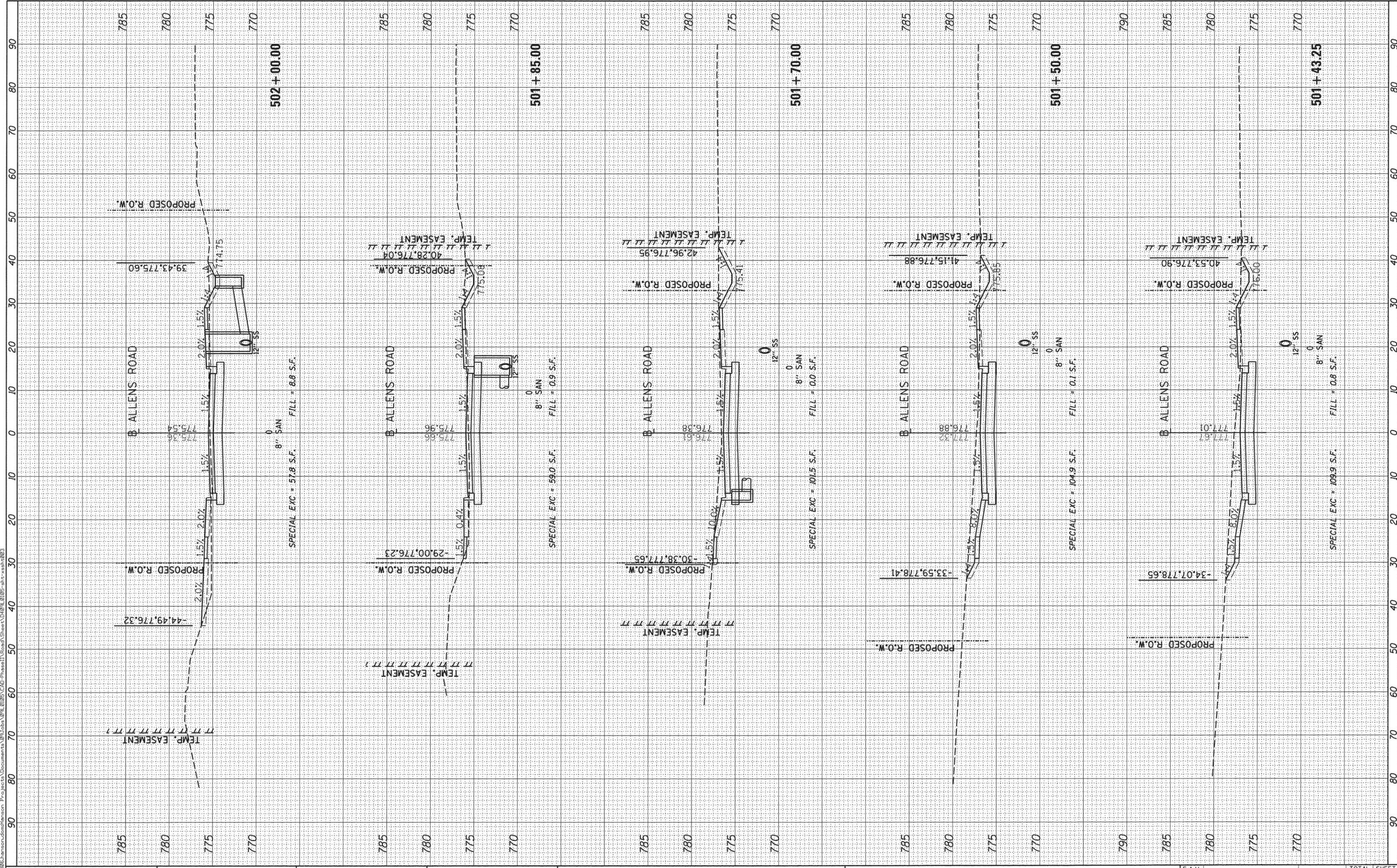

FILE NAME =  
 USER NAME = andr00846  
 DESIGNED - RLA  
 DRAWN - MGD  
 CHECKED - MPB  
 DATE - 9/9/2015

REVISIONS  
 REVISED -  
 REVISED -  
 REVISED -  
 REVISED -

STATE OF ILLINOIS  
 DEPARTMENT OF TRANSPORTATION

ALLENS AVENUE  
 CROSS SECTIONS

SCALE: 1"=10'  
 SHEET OF SHEETS STA. TO STA. 502+00.00

F.A.U. RTE.	SECTION	COUNTY	TOTAL SHEETS	SHEET NO.
6800	05-00500-19-GS	KNOX	216	206
	50VB		CONTRACT NO.89417	
ILLINOIS FED. AID PROJECT				







FINAL SURVEY	BY	DATE
PLOTTED		
NOTE BOOK		
AREAS		
AREAS CHECKED		
NO.		



ORIGINAL SURVEY	BY	DATE
PLOTTED		
NOTE BOOK		
AREAS		
AREAS CHECKED		
NO.		

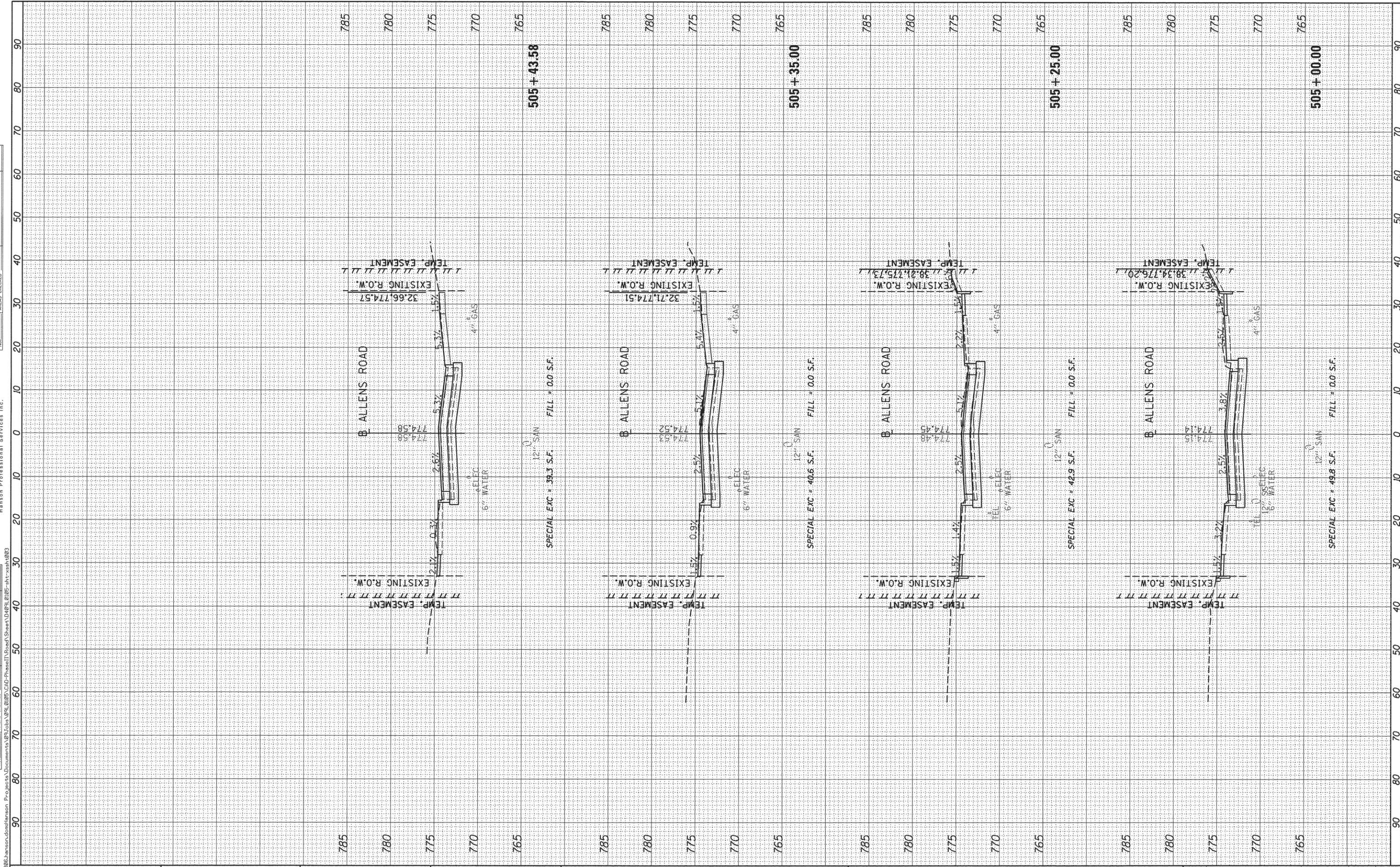

FILE NAME = c:\pwise\_work\do\_not\_delete\d0273754\0409L0105

USER NAME = andr-00846  
 DRAWN - MGD  
 CHECKED - MPB  
 DATE - 9/9/2015

DESIGNED - RLA  
 DRAWN - MGD  
 CHECKED - MPB  
 DATE - 9/9/2015

REVISED -  
 REVISED -  
 REVISED -  
 REVISED -

**STATE OF ILLINOIS  
 DEPARTMENT OF TRANSPORTATION**

SCALE: 1"=10' SHEET OF SHEETS STA. 505+00.00 TO STA. 505+43.58

**ALLENS AVENUE  
 CROSS SECTIONS**

F.A.U. RTE.	SECTION	COUNTY	TOTAL SHEETS	SHEET NO.
6800	05-0050-19-GS	KNOX	216	209
50VB		CONTRACT NO.89417		
ILLINOIS FED. AID PROJECT				

FINAL SURVEY	BY	DATE
PLOTTED		
NOTE BOOK		
AREAS CHECKED		
NO.		



ORIGINAL SURVEY	BY	DATE
PLOTTED		
NOTE BOOK		
AREAS CHECKED		
NO.		

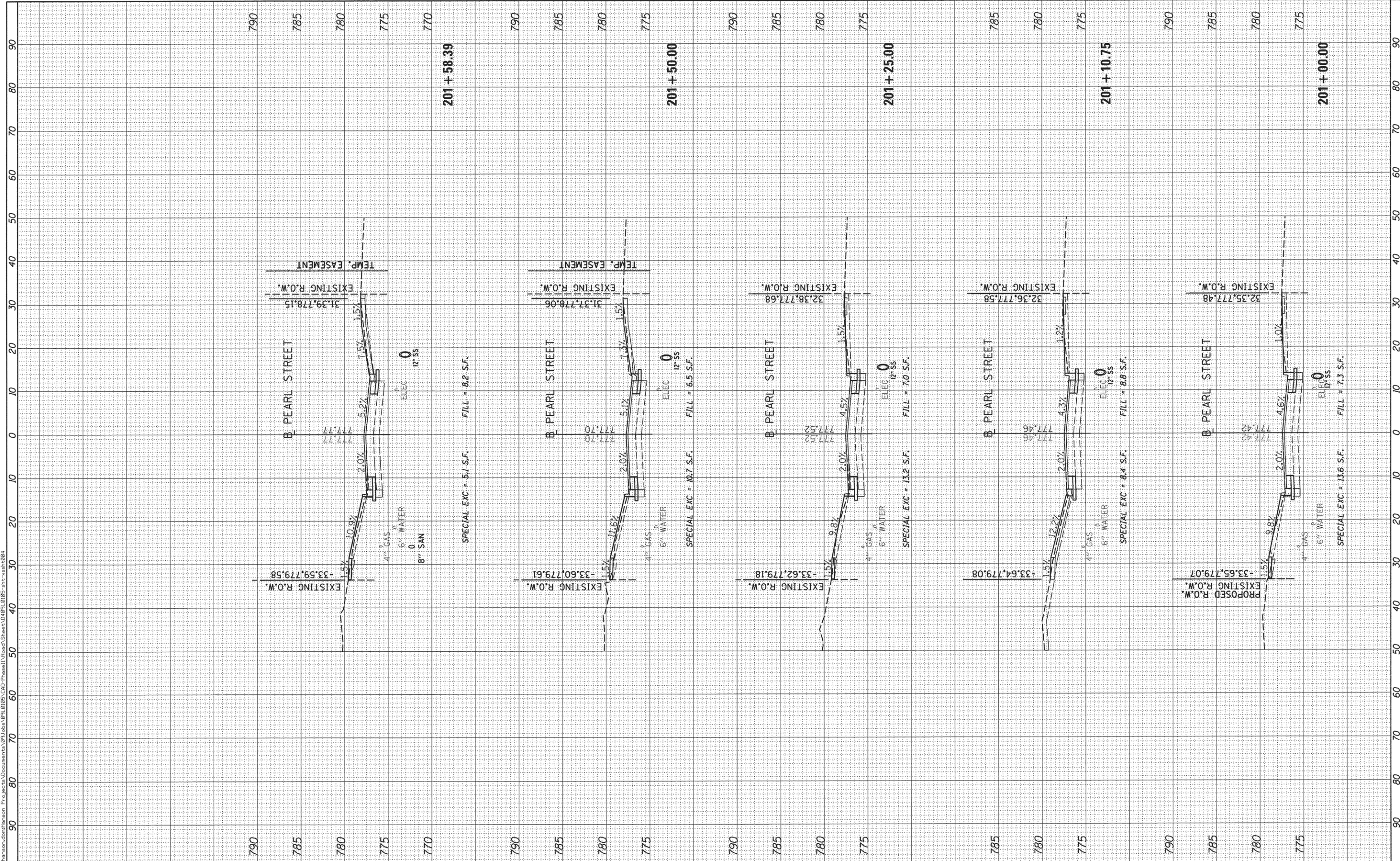

FILE NAME = USER NAME = andr00846  
 c:\pwise\_work\do\_not\_delete\20273754\1040\10105\shh-xshh004.dgn  
 PLOT SCALE = 10.0000' / in.  
 PLOT DATE = 11/13/2015

DESIGNED - RLA	REVISED -
DRAWN - MGD	REVISED -
CHECKED - MPB	REVISED -
DATE - 9/9/2015	REVISED -

**STATE OF ILLINOIS  
DEPARTMENT OF TRANSPORTATION**

**PEARL STREET  
CROSS SECTIONS**

SCALE: 1"=10' SHEET OF SHEETS STA. 201+00.00 TO STA. 201+00.00

F.A.U. RTE.	SECTION	COUNTY	TOTAL SHEETS	SHEET NO.
6800	05-00500-19-GS	KNOX	216	210
	50VB			CONTRACT NO.89417
				ILLINOIS FED. AID PROJECT

FINAL SURVEY	BY	DATE
PLOTTED		
NOTE BOOK		
AREAS CHECKED		
NO.		



ORIGINAL SURVEY	BY	DATE
PLOTTED		
NOTE BOOK		
AREAS CHECKED		
NO.		

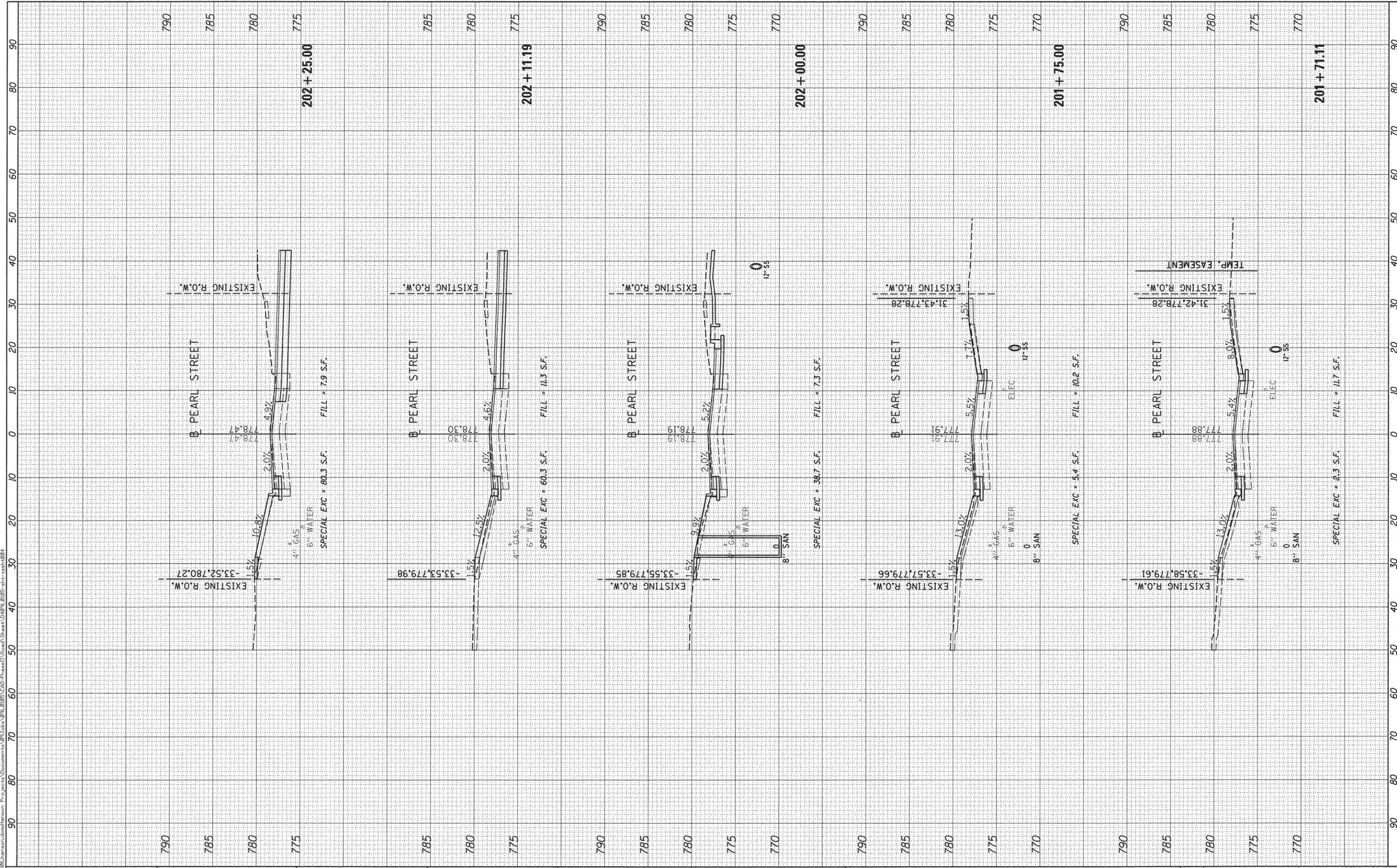

FILE NAME =  
 USER NAME = andr00846  
 es:\pwise\_work\do\_not\_delete\0273754\0409L0105\shh\ssht004.dgn  
 PLOT SCALE = 10.0000' / 1" / in.  
 PLOT DATE = 11/13/2015

DESIGNED - RLA  
 DRAWN - MGD  
 CHECKED - MPB  
 DATE - 9/9/2015

REVISED -  
 REVISED -  
 REVISED -  
 REVISED -

**STATE OF ILLINOIS  
 DEPARTMENT OF TRANSPORTATION**

SCALE: 1"=10'  
 SHEET OF SHEETS  
 STA. 201+71.11 TO STA. 202+25.00

**PEARL STREET  
 CROSS SECTIONS**

F.A.U. RTE.	SECTION	COUNTY	TOTAL SHEETS	SHEET NO.
6800	05-00500-19-GS	KNOX	216	211
50VB			CONTRACT NO.89417	
ILLINOIS FED. AID PROJECT				





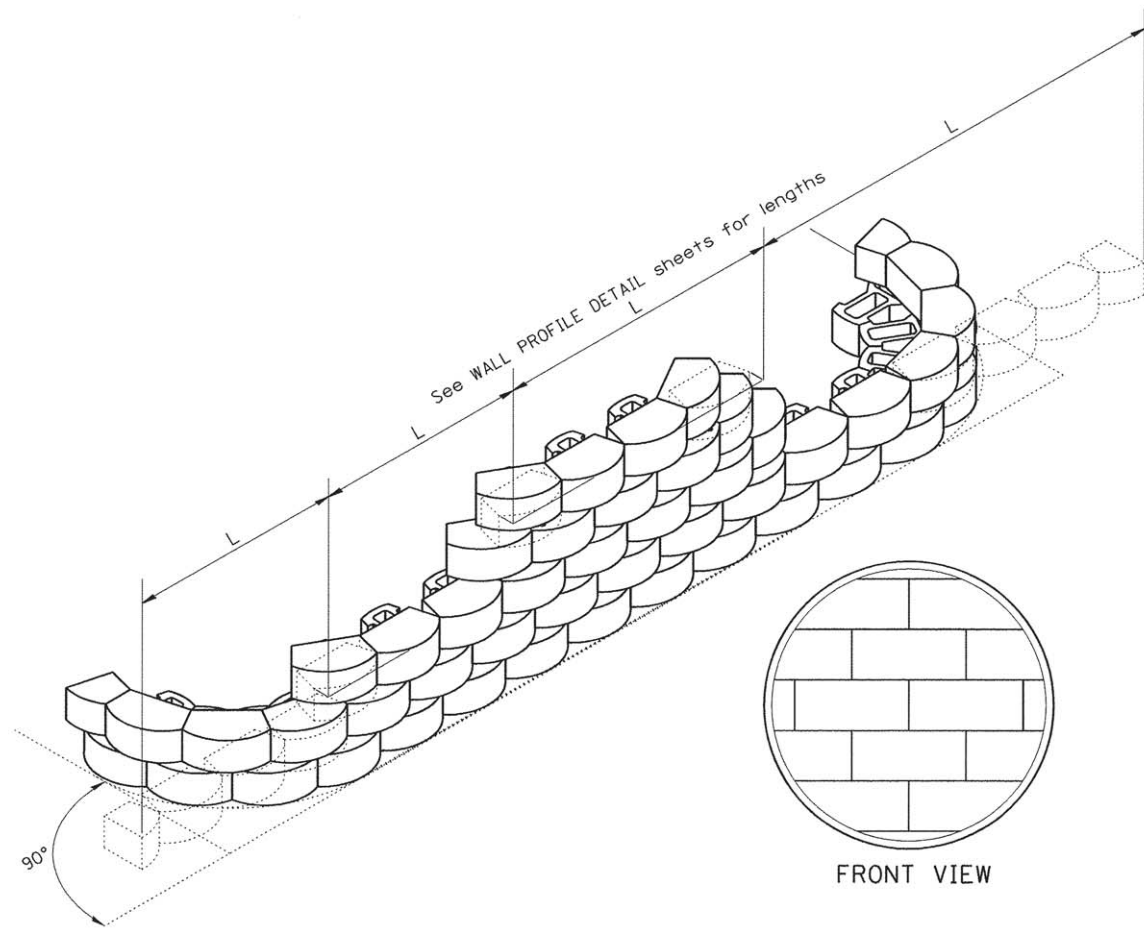

**INSTALLATION OF COURSES IN RUNNING BOND**

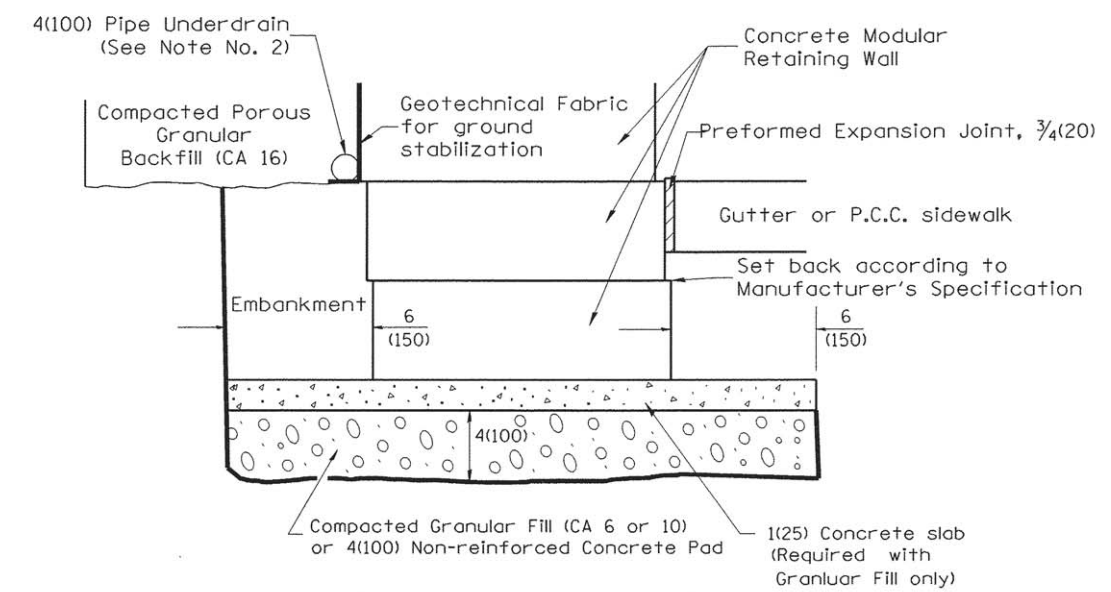

**LEVELING BASE PAD DETAIL**

**NOTES:**

1. At the Contractor's option the portion of the stone wall below top of sidewalk elevation may be constructed with class SI concrete. The width shall match the width of the modular block plus the 12(300) maximum trench.
2. 4(100) Pipe Underdrains shall outlet into inlets or storm sewer.
3. Pipe drains and pipe underdrains shall meet the requirements of the applicable portions of section 601 of the Standard Specifications.
4. Preformed expansion joint filler shall be placed between the gutter or sidewalk and the wall.
5. The geotechnical fabric shall meet the requirements of the applicable portions of Sections 210 and 1080 of the Standard Specifications.

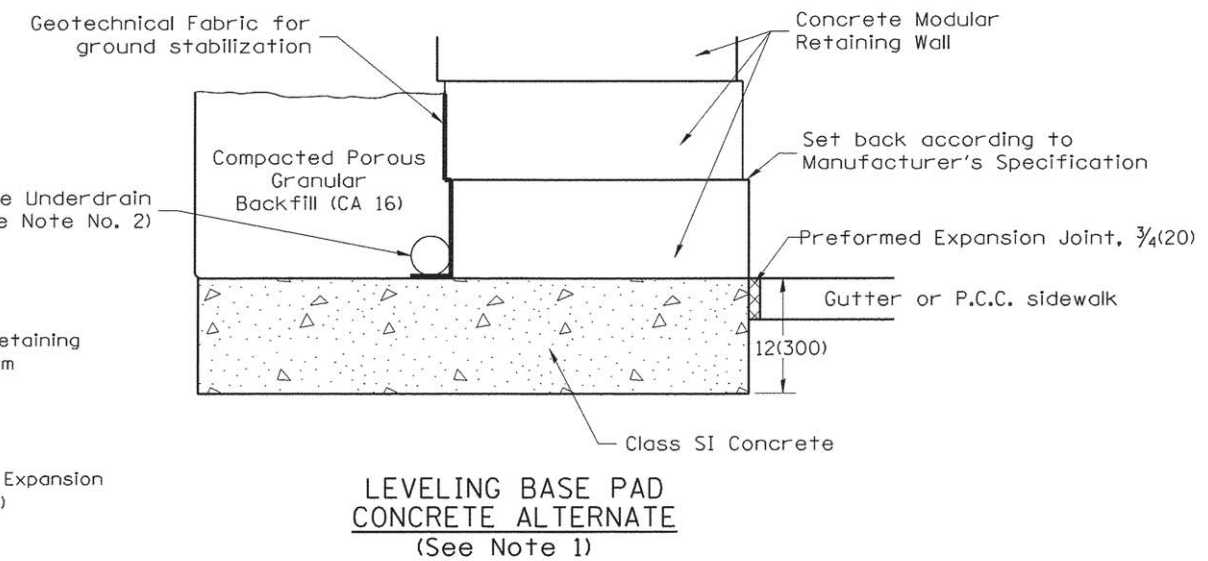
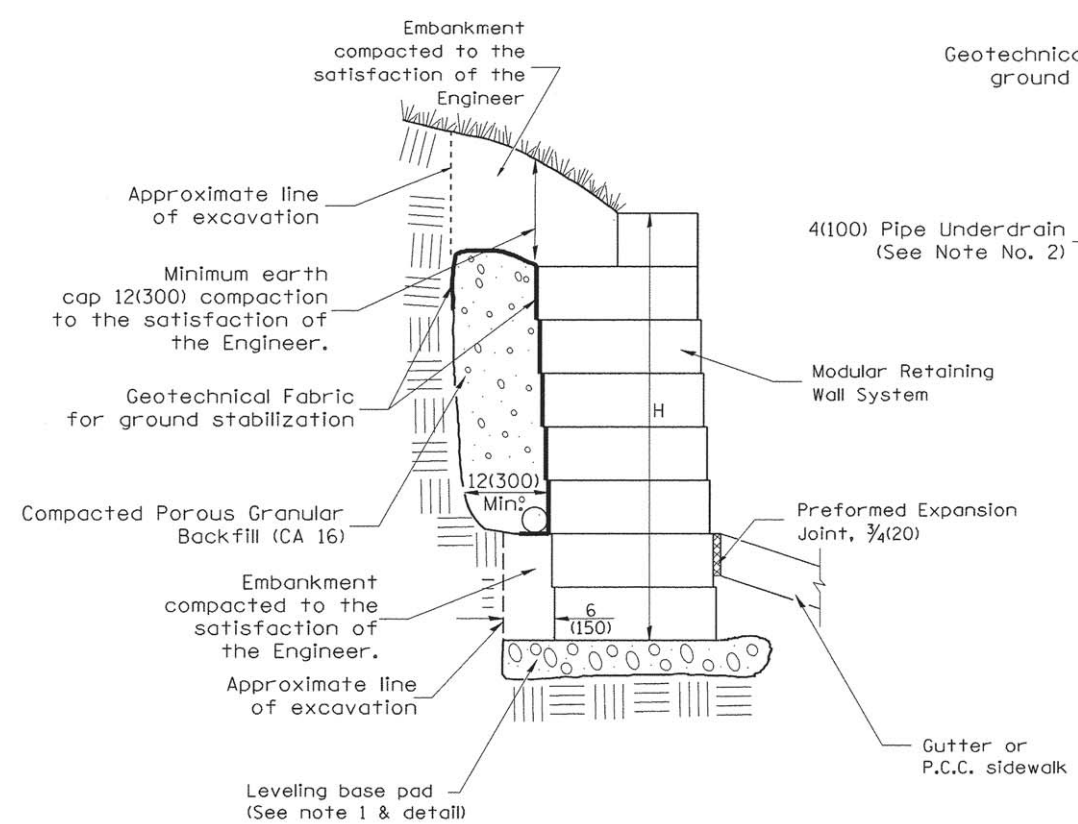

**LEVELING BASE PAD CONCRETE ALTERNATE (See Note 1)**

All dimensions are in inches (millimeters) unless otherwise noted.

LAYOUT	
DRAWN	
REVIEWED	

FILE NAME =	USER NAME = andr00846	DESIGNED -	REVISED -
c:\pwise_work\do_not_delete\d0273754\0449L0105-sht-stander.d01.dgn		DRAWN -	REVISED -
PLOT SCALE = 50,0000 ' / in.		CHECKED -	REVISED -
PLOT DATE = 11/13/2015		DATE = 9/9/2015	REVISED -

**STATE OF ILLINOIS  
 DEPARTMENT OF TRANSPORTATION**

<b>MODULAR RETAINING WALL SYSTEM DETAIL</b>			
SCALE: N/A	SHEET NO.	OF SHEETS	STA. TO STA.

F.A.U. RTE.	SECTION	COUNTY	TOTAL SHEETS	SHEET NO.
6800	05-00500-19-GS	KNOX	216	214
50VB		CONTRACT NO.89417		
FED. ROAD DIST. NO.		ILLINOIS FED. AID PROJECT		

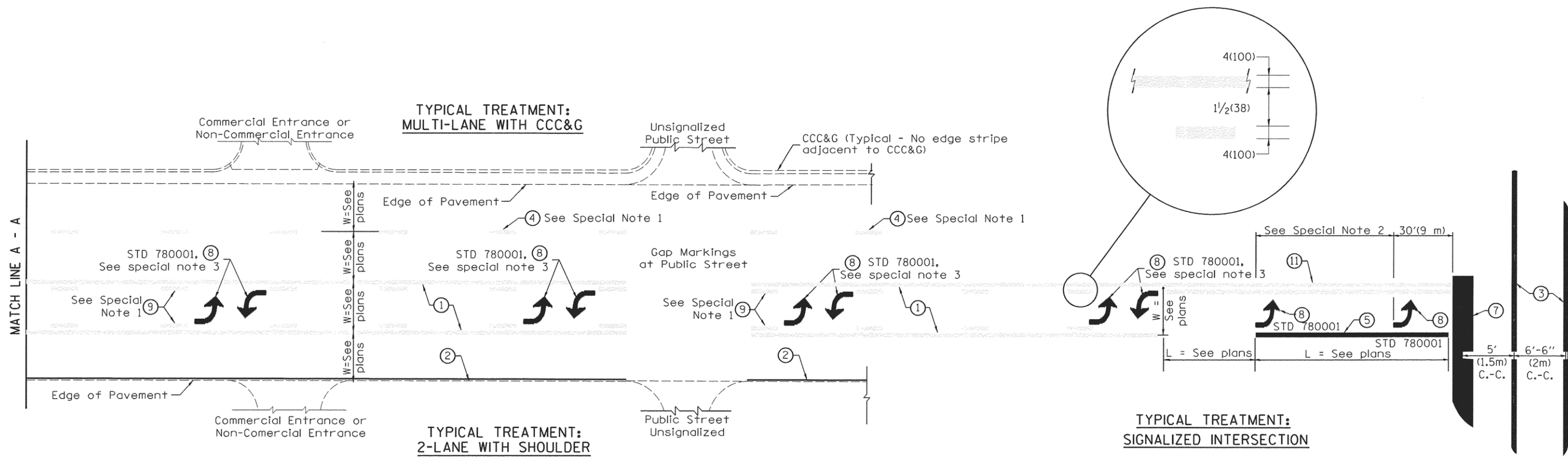

**FLUSH PAVED MEDIAN: TWO-WAY LEFT TURN LANE WITH ONE-WAY LEFT TURN LANE AT SIGNALIZED INTERSECTION**

**TYPICAL PAVEMENT MARKING LEGEND**

(Note: This is a District Standard Legend. Some elements may not apply to specific project.)

- ① 4(100) Solid (Yellow)
- ② 4(100) Solid (White)
- ③ 2-6(150) Crosswalk @ 6'-6" (2m)min C.-C. (White)  
2-8(200) Crosswalk @ 6'-6" (2m)min C.-C. (White) (When traffic signals are present.)
- ④ 6(150) Skip-Dash (White) (See Special Note 1)
- ⑤ 8(200) Solid (White)
- ⑥ 12(300) Diagonal (White) (Item ⑥ is shown on Std. 780001)
- ⑦ 24(600) Stop Bar (White)
- ⑧ Letters & Arrows (See Std. 780001 and Special Notes 2 & 3)
- ⑨ 4(100) Skip-Dash (Yellow) (See Special Note 1)
- ⑩ 12(300) Diagonal (Yellow) (See Table A) (See Table A)
- ⑪ 4(100) Double Solid (Yellow) (See Table A)

**SPECIAL NOTES**

1. Skip-Dash markings will be centered between both ends of city blocks and shall be placed in alignment transversely across the pavement.
2. The following shall apply to arrows located in one-way left turn lanes:
  - A. A minimum of two (2) arrows is required.
  - B. The maximum spacing between arrows is 80' (24 m).
  - C. Arrows shall be evenly spaced if three (3) or more are required.
3. The following shall apply to arrow pairs located in two-way left turn lanes:
  - A. A minimum of two (2) arrow pairs is required.
  - B. The maximum spacing between arrow pairs is 200' (61 m).
  - C. Arrow pairs shall be evenly spaced if three (3) or more are required.
  - D. The spacing between Bi Directional Left Turn Arrows is 33' (10 m).

**GENERAL NOTES**

1. Refer to State Standard 780001 for additional Pavement Markings including letters & arrows.
2. See Plans for Pavement Markings adjacent to curbed islands and medians, and through lane reductions.

LAYOUT	
DRAWN	
REVIEWED	

FILE NAME =	USER NAME = andr00846	DESIGNED -	REVISED -
c:\pwise_work\do_not_delete\d0273754\049	9L0105-ah-t-standard001.dgn	DRAWN -	REVISED -
	PLOT SCALE = 50.0000' / in.	CHECKED -	REVISED -
	PLOT DATE = 11/13/2015	DATE - 9/9/2015	REVISED -

**STATE OF ILLINOIS  
 DEPARTMENT OF TRANSPORTATION**

**TYPICAL PAVEMENT MARKINGS**

SCALE: N/A	SHEET NO.	OF	SHEETS	STA.	TO STA.
------------	-----------	----	--------	------	---------

F.A.U. RTE.	SECTION	COUNTY	TOTAL SHEETS	SHEET NO.
6800	05-00500-19-GS	KNOX	216	215
50VB		CONTRACT NO.89417		
FED. ROAD DIST. NO. ILLINOIS FED. AID PROJECT				

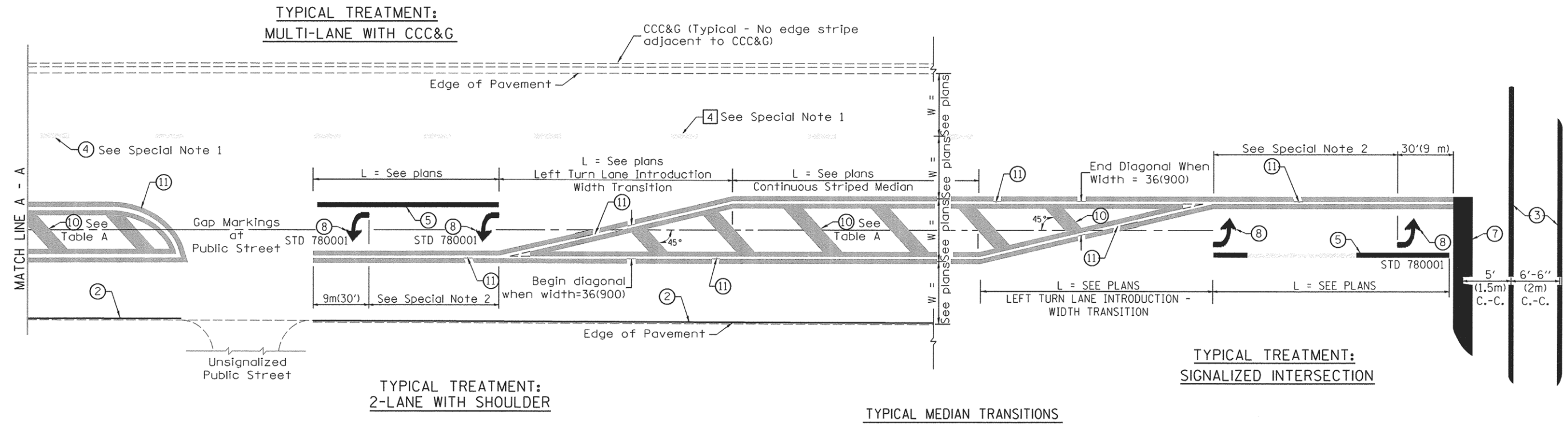

**FLUSH PAVED MEDIAN: RESTRICTED LEFT TURN LANE**

**TABLE A**  
 RECOMMENDED SPACING BETWEEN DIAGONAL LINES

SPEED LIMIT RANGE	INTERSECTION CHANNELIZATION (Includes Width Transitions for Median and Left Turn Lane Introductions)	
	CONTINUOUS	
Less Than 30 mph (50 km/h)	50' (15m)	15' (5m)
30 - 45 mph (50 - 70 km/h)	75' (23m)	20' (6m)
Over 45 mph (70 km/h)	150' (46m)	30' (9m)

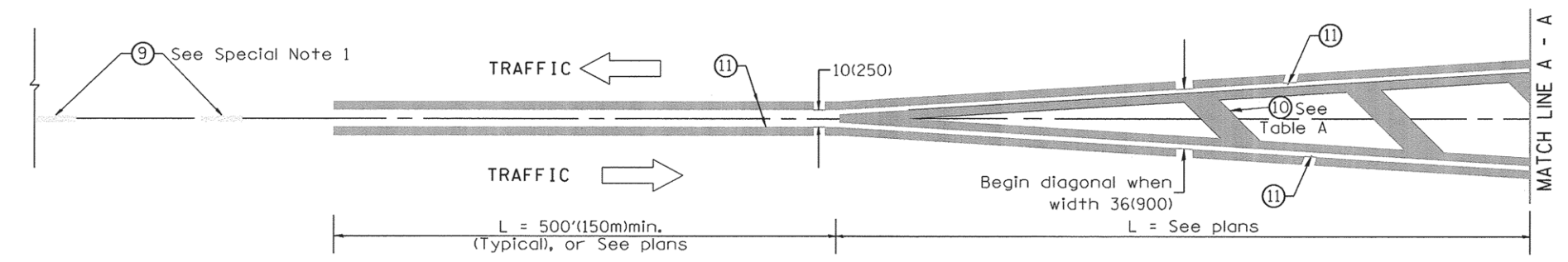

All dimensions are in inches (millimeters) unless otherwise noted.

<b>STATE OF ILLINOIS</b> <b>DEPARTMENT OF TRANSPORTATION</b>				<b>TYPICAL PAVEMENT MARKINGS</b>				F.A.U. RTE. SECTION COUNTY TOTAL SHEETS SHEET NO. 6800 05-00500-19-GS KNOX 216 216 50VB CONTRACT NO.89417	
SCALE: N/A	SHEET NO.	OF SHEETS	STA.	TO STA.	FED. ROAD DIST. NO.	ILLINOIS FED. AID PROJECT			