

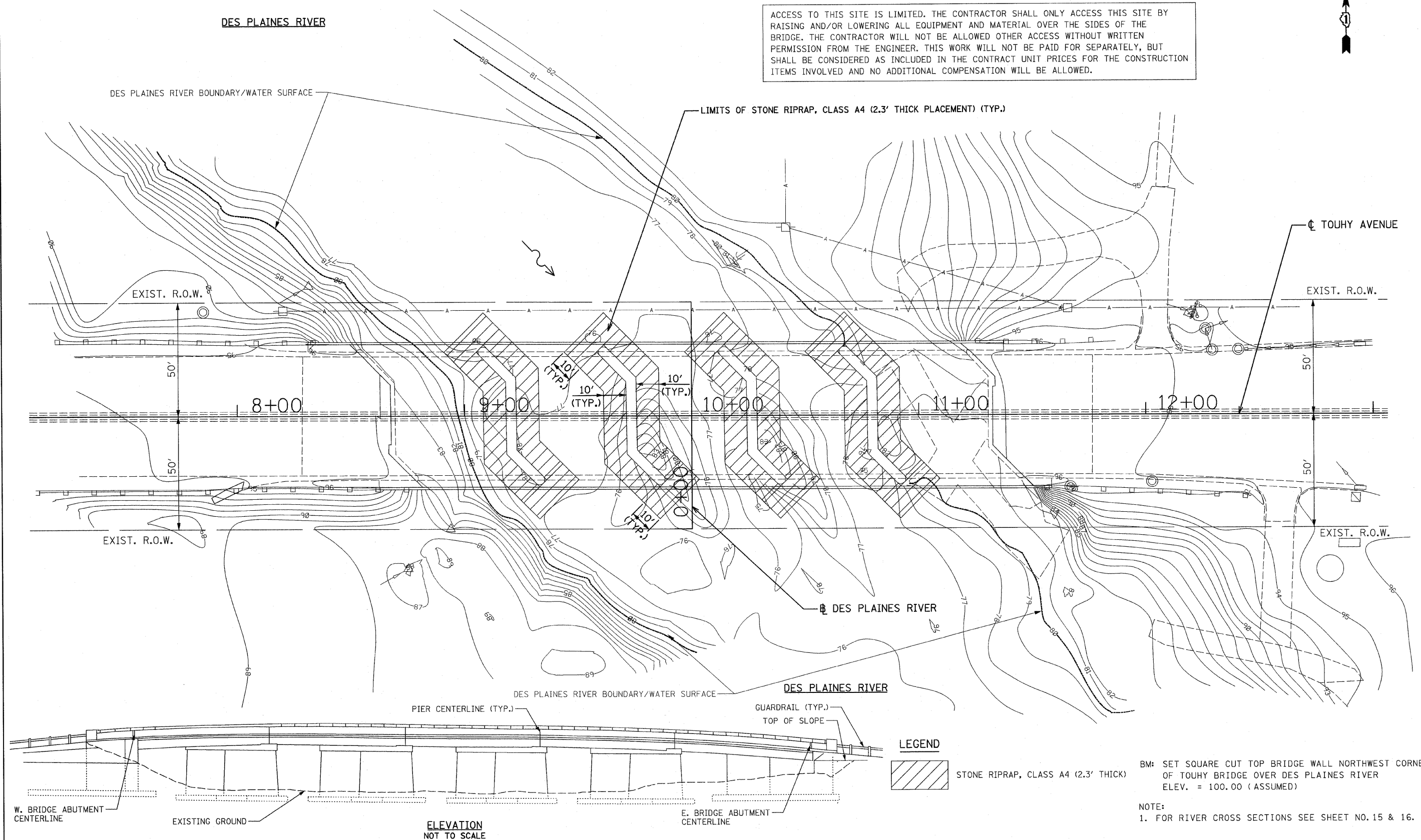

ACCESS TO THIS SITE IS LIMITED. THE CONTRACTOR SHALL ONLY ACCESS THIS SITE BY RAISING AND/OR LOWERING ALL EQUIPMENT AND MATERIAL OVER THE SIDES OF THE BRIDGE. THE CONTRACTOR WILL NOT BE ALLOWED OTHER ACCESS WITHOUT WRITTEN PERMISSION FROM THE ENGINEER. THIS WORK WILL NOT BE PAID FOR SEPARATELY, BUT SHALL BE CONSIDERED AS INCLUDED IN THE CONTRACT UNIT PRICES FOR THE CONSTRUCTION ITEMS INVOLVED AND NO ADDITIONAL COMPENSATION WILL BE ALLOWED.



FILE NAME = 0160J08-10-shr-eros.dgn
PLOT DATE = 5/6/2010

CHRISTIAN-ROGE & ASSOCIATES, INC.
ENGINEERS-PLANNERS-SURVEYORS
211 WEST WACKER DRIVE
CHICAGO, ILLINOIS 60606
PHONE: (312)372-2023 FAX: (312)372-5274

DESIGNED - G.F.L.
DRAWN - J.V./K.R.K.
CHECKED - E.J.M.
DATE - APRIL 28, 2010

REVISED -
REVISED -
REVISED -
REVISED -

STATE OF ILLINOIS
DEPARTMENT OF TRANSPORTATION

EROSION AND SEDIMENT CONTROL PLAN
TOUHY AVENUE OVER DES PLAINES RIVER
SCALE: 1" = 20'
SHEET NO. 2 OF 2 SHEETS
STA. 8+00 TO STA. 12+00

F.A.P. RTE.	SECTION	COUNTY	TOTAL SHEETS	SHEET NO.
VAR.	2009-108 1	COOK/KANE	23	10
CONTRACT NO. 60J08				
FED. ROAD DIST. NO. 1 ILLINOIS FED. AID PROJECT				

ELEVATION
NOT TO SCALE

BM: SET SQUARE CUT TOP BRIDGE WALL NORTHWEST CORNER OF TOUHY BRIDGE OVER DES PLAINES RIVER
ELEV. = 100.00 (ASSUMED)

NOTE:
1. FOR RIVER CROSS SECTIONS SEE SHEET NO. 15 & 16.