

F.A.U. RTE.	SECTION	COUNTY	TOTAL SHEETS	SHEET NO.
2423	2009-119 RS	KANE	14	1
FED. ROAD DIST. NO.	ILLINOIS	CONTRACT NO.	60J71	

STATE OF ILLINOIS
DEPARTMENT OF TRANSPORTATION
DIVISION OF HIGHWAYS
PROPOSED HIGHWAY PLANS
FAU ROUTE 2423: FOOTHILL RD
RANDALL RD TO AIRLITE ST
SECTION: 2009-119 RS
RESURFACING

FOR INDEX OF SHEETS, SEE SHEET NO. 2

THE PROJECT IS LOCATED IN THE CITY OF ELGIN

TRAFFIC DATA

ADT = NO DATA
POSTED SPEED LIMIT = 40 MPH

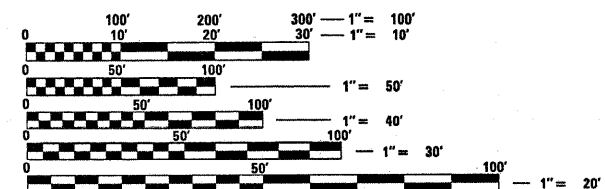

FULL SIZE PLANS HAVE BEEN PREPARED USING STANDARD ENGINEERING SCALES. REDUCED SIZED PLANS WILL NOT CONFORM TO STANDARD SCALES. IN MAKING MEASUREMENTS ON REDUCED PLANS, THE ABOVE SCALES MAY BE USED.

J.U.L.I.E.
JOINT UTILITY LOCATION INFORMATION FOR EXCAVATION
1-800-892-0123
OR 811

PROJECT ENGINEER ROBERT BORO (847)705-4178
PROJECT MANAGER KEN ENG

CONTRACT NO. 60J71

KANE COUNTY
C-91-261-10

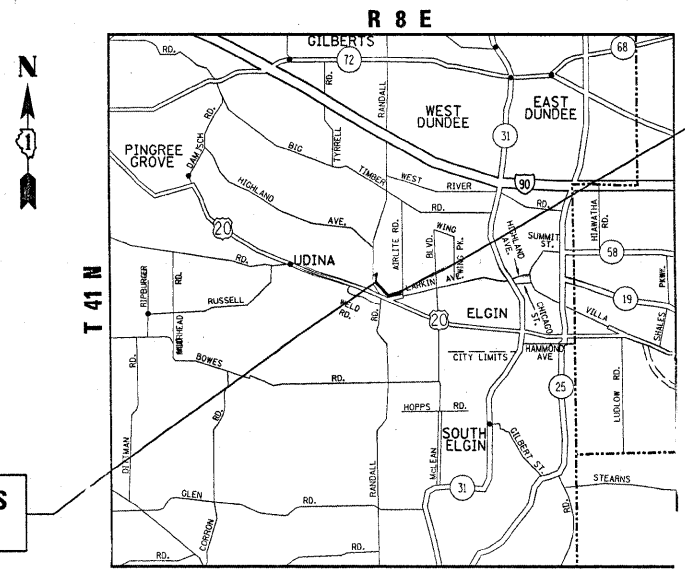
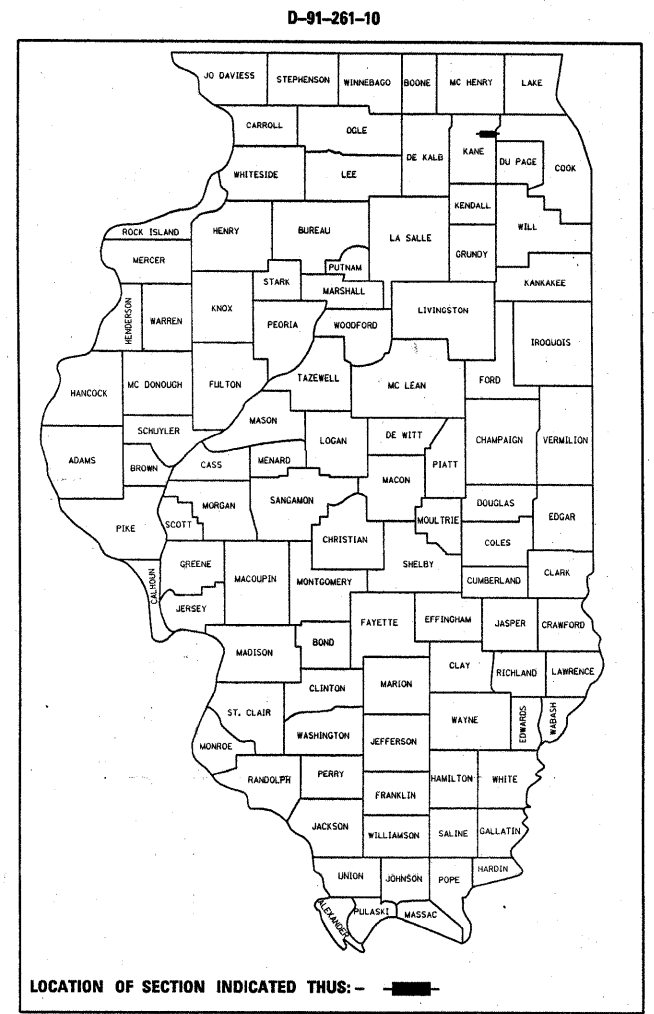

PROJECT BEGINS
STA. 8+92

PROJECT ENDS
STA. 30+91

ELGIN TOWNSHIP

GROSS & NET LENGTH OF IMPROVEMENT = 2199 FEET = 0.42 MILES

STATE OF ILLINOIS
DEPARTMENT OF TRANSPORTATION
DIVISION OF HIGHWAYS

SUBMITTED February 3, 2010
Diana M. O'Keefe
DEPUTY DIRECTOR OF HIGHWAYS, REGION ENGINEER

March 19, 2010
Scott E. Stitt, P.E.
ACTING ENGINEER OF DESIGN AND ENVIRONMENT

March 19, 2010
Christine M. Reed
DIRECTOR OF HIGHWAYS, CHIEF ENGINEER

**PRINTED BY THE AUTHORITY
OF THE STATE OF ILLINOIS**