

F.A.U. ROUTE	SECTION	COUNTY	TOTAL SHEETS	SHEET NO.
2411	10-00076-00-RS	KANE	16	1
CONTRACT NO. 63476				

FOR INDEX OF SHEETS SEE SHEET NO. 2

STATE OF ILLINOIS
DEPARTMENT OF TRANSPORTATION
DIVISION OF HIGHWAYS
PLANS FOR PROPOSED FEDERAL AID HIGHWAY
F.A.U. ROUTE 2411 (WESTERN AVENUE)
MCKEE STREET TO FABYAN PARKWAY
RESURFACING
SECTION: 10-00076-00-RS
PROJECT NO. ARA-9003(584)
CITY OF BATAVIA
KANE COUNTY
C-91-394-10

TRAFFIC DATA

ADT (2008) = 5880
 POSTED SPEED 30 MPH
 DESIGN SPEED 35 MPH

FUNCTIONAL CLASSIFICATION: COLLECTOR



LOCATION OF SECTION INDICATED THIS: - ■ -

STATE OF ILLINOIS
 DEPARTMENT OF TRANSPORTATION
 DIVISION OF HIGHWAYS

APPROVED: 5/26/10
Nell Baugni
 CITY ENGINEER

PASSED: MAY 27, 2010
Chris Hertz
 BUREAU CHIEF OF LOCAL ROADS AND STREETS

RELEASING FOR BID
 BASED ON LIMITED REVIEW: MAY 26, 2010
Diane M. O'Keefe
 DEPUTY DIRECTOR OF HIGHWAYS, REGION #1 ENGINEER

DATE: 5/26/10
 BY: *Karen R. Young*
 KAREN R. YOUNG, P.E.
 REGISTERED P.E. STATE OF ILLINOIS
 LICENSE EXPIRES: NOVEMBER 30, 2011

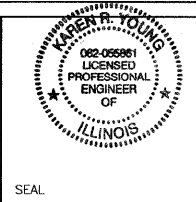

**PRINTED BY THE AUTHORITY
 OF THE STATE OF ILLINOIS**

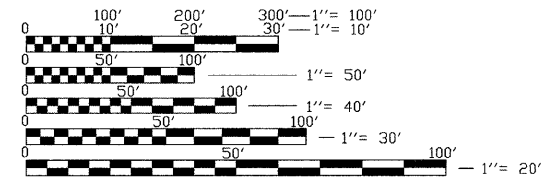

FULL SIZE PLANS HAVE BEEN PREPARED USING STANDARD ENGINEERING SCALES. REDUCED SIZED PLANS WILL NOT CONFORM TO STANDARD SCALES. IN MAKING MEASUREMENTS ON REDUCED PLANS, THE ABOVE SCALES MAY BE USED.

J.U.L.I.E.
 JOINT UTILITY LOCATION FOR EXCAVATION
 1-800-892-0123

 I.D.O.T. BUREAU OF TRAFFIC
 MEADE ELECTRIC
 1-773-287-7672

 KANE COUNTY DEPARTMENT OF TRANSPORTATION
 1-630-208-3130

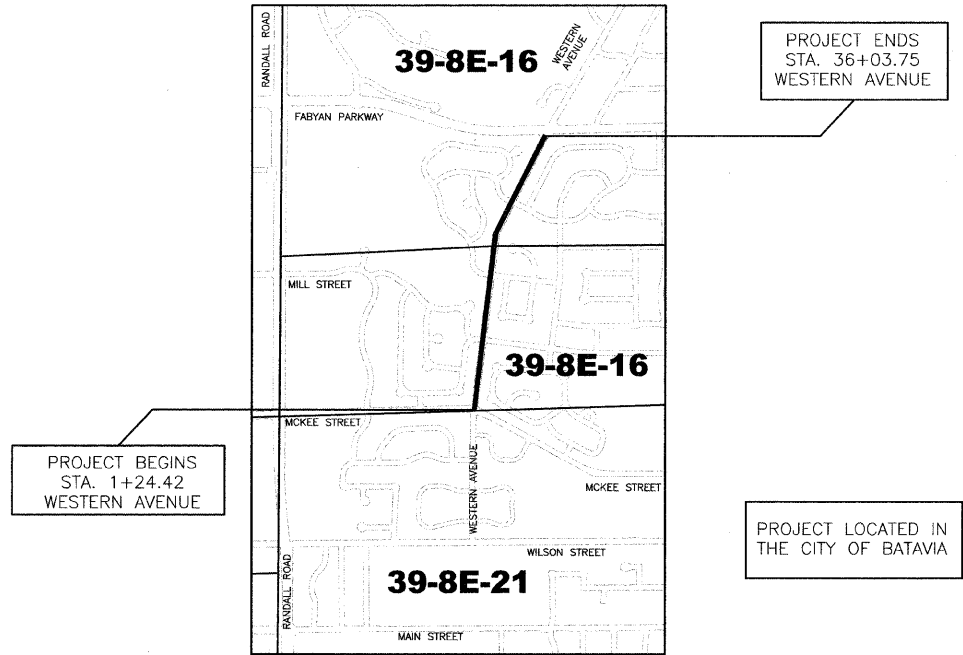

LOCATION MAP
 N.T.S.

PROJECT LOCATION = TOWNSHIP 39 NORTH,
 RANGE 8 EAST, BATAVIA TOWNSHIP, 3RD P.M.
 GROSS LENGTH OF PROJECT = 3,479.33 FEET (0.66 MILES)
 NET LENGTH OF PROJECT = 3,479.33 FEET (0.66 MILES)

FIELD ENGINEER: MARILYN SOLOMON, P.E. (847) 705-4407

Stream:\STR_10_004_Western_Ave\plan\001_001.dwg(01_001_VER_MAR) PLOTTED: Wednesday, 26 May 2010 - 5:19pm SAVED: Tuesday, 25 May 2010 - 4:57pm

CONTRACT NO. 63476