

STATE OF ILLINOIS
DEPARTMENT OF TRANSPORTATION

F.A.I. RTE.	SECTION	COUNTY	TOTAL SHEETS	SHEET NO.
70	D 7 HT PVMNT MRK RPR 22-16	CLARK	9	1
		ILLINOIS	CONTRACT NO. 46580	

FOR INDEX OF SHEETS, SEE SHEET NO. 2

PROPOSED
HIGHWAY PLANS

INTERSTATE 70 (I-70)
SECTION D 7 HT PVMNT MRK RPR 22-16
HIGH TYPE PAVEMENT MARKING
CLARK COUNTY
M-60-017-22

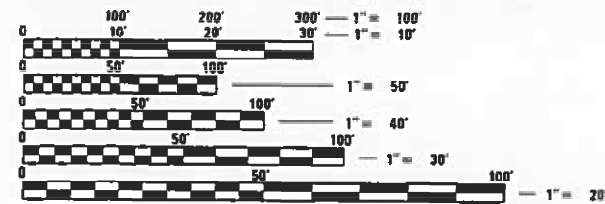

FULL SIZE PLANS HAVE BEEN PREPARED USING STANDARD ENGINEERING SCALES. REDUCED SIZED PLANS WILL NOT CONFORM TO STANDARD SCALES. IN MAKING MEASUREMENTS ON REDUCED PLANS, THE ABOVE SCALES MAY BE USED.

J.U.L.I.E.
JOINT UTILITY LOCATION INFORMATION FOR EXCAVATORS
1-800-892-0123
OR 811

PROJECT ENGINEER DEWAYNE SEACHRIST
PROJECT MANAGER ROBERT GREUEL

CONTRACT NO. 46580

STATE OF ILLINOIS
DEPARTMENT OF TRANSPORTATION

SUBMITTED JUNE 16 2021
Jeffrey P. Myerles
REGIONAL ENGINEER

June 25, 2021
Scott A. Etk
ENGINEER OF DESIGN AND ENVIRONMENT

June 25, 2021
James J. Gu
DIRECTOR OF HIGHWAYS PROJECT IMPLEMENTATION

PRINTED BY THE AUTHORITY
OF THE STATE OF ILLINOIS

INDEX OF SHEETS

1	COVER SHEET
2	INDEX AND STANDARDS
3	SUMMARY OF QUANTITIES
4 - 9	DISTRICT 7 DETAIL NO. 78000001 & 78000002

STANDARDS

701101-05	OFF- ROAD OPERATIONS, MULTILANE, 15' (4.5 m) TO 24' (600 mm) FROM PAVEMENT EDGE
701106-02	OFF- ROAD OPERATIONS, MULTILANE, 15' (4.5 m) AWAY
701400-10	APPROACH TO LANE CLOSURE, FREEWAY / EXPRESSWAY
701401-12	LANE CLOSURE, FREEWAY / EXPRESSWAY
701406-12	LANE CLOSURE, FREEWAY / EXPRESSWAY, DAY OPERATIONS ONLY
701411-09	LANE CLOSURE, MULTILANE, AT ENTRANCE OR EXIT RAMP FOR SPEEDS \geq 45 MPH
701428-01	TRAFFIC CONTROL, SETUP AND REMOVAL, FREEWAY / EXPRESSWAY
701456-05	PARTIAL EXIT RAMP CLOSURE FREEWAY / EXPRESSWAY
701901-08	TRAFFIC CONTROL DEVICES

REV. - MS

MODEL: Default
 FILE: Main.dwg
 PLOT: P:\GIS\DOT\Documents\DOT - Office\District 7\Project\16580\CA\303\303\CA\SheetID746580-std-genmode.dwg

USER NAME = steffemk DESIGNED - DRAWN - PLOT SCALE = 100.0000" / in. CHECKED - PLOT DATE = 6/16/2021 DATE - REVISIONS -	DESIGNED - DRAWN - CHECKED - DATE -	REVISED - REVISED - REVISED + REVISED +	STATE OF ILLINOIS DEPARTMENT OF TRANSPORTATION	INDEX OF SHEETS STANDARDS				F.I.A. RTE.	SECTION	COUNTY	TOTAL SHEETS	SHEET NO.
				70	D 7 HT PVMNT MRK RPR 22-16	CLARK	9	2	CONTRACT NO. 46580		ILLINOIS FED. AID PROJECT	
SCALE:				SHEET	OF	SHEETS	STA.	TO STA.				

100%
STATE
URBAN

SUMMARY OF QUANTITIES			TOTAL QUANTITIES	CONSTRUCTION TYPE CODE		
CODE NO	ITEM	UNIT		0023		
67100100	MOBILIZATION	L SUM	1	1		
70107025	CHANGEABLE MESSAGE SIGN	CAL DA	14	14		
X0320100	GROOVING FOR RECESSED PAVEMENT MARKING 10"	FOOT	28500	28500		
X2700010	PREFORMED PLASTIC PAVEMENT MARKING, TYPE D - LINE 6"	FOOT	187960	187960		
X2700012	PREFORMED PLASTIC PAVEMENT MARKING, TYPE D - LINE 8"	FOOT	13750	13750		
X2700026	PREFORMED PLASTIC PAVEMENT MARKING, TYPE D - LINE 12"	FOOT	750	750		
X7010216	TRAFFIC CONTROL AND PROTECTION, (SPECIAL)	L SUM	1	1		
X7030078	GROOVING FOR RECESSED PAVEMENT MARKING 13"	FOOT	750	750		
X7830074	GROOVING FOR RECESSED PAVEMENT MARKING 7"	FOOT	235000	235000		
X7830076	GROOVING FOR RECESSED PAVEMENT MARKING 9"	FOOT	13750	13750		
X2700028	PREFORMED PLASTIC PAVEMENT MARKING, TYPE D - LINE 6" (INSTALL ONLY)	FOOT	47040	47040		
X2700029	PREFORMED PLASTIC PAVEMENT MARKING, TYPE D - LINE 9" (INSTALL ONLY)	FOOT	28500	28500		

SUMMARY OF QUANTITIES			TOTAL QUANTITIES	CONSTRUCTION TYPE CODE		
CODE NO	ITEM	UNIT				

MODEL: Default
FILE: M:\MS-Projects\46580\CAD\Drawings\DOT\7\Project\46580\CAD\Drawings\DOT\7\Project\46580-Plt-S00.dgn
PLOT: 6/16/2021 11:30:58 AM
PLOT SCALE: 100.0000' / in.
PLOT DATE: 6/16/2021

REV. - MS

USER NAME = steffenmk	DESIGNED -	REVISED -
	DRAWN -	REVISED -
PLOT SCALE = 100.0000' / in.	CHECKED -	REVISED -
PLOT DATE = 6/16/2021	DATE -	REVISED -

STATE OF ILLINOIS
DEPARTMENT OF TRANSPORTATION

SUMMARY OF QUANTITIES

SCALE: _____ SHEET _____ OF _____ SHEETS STA. _____ TO STA. _____

F.A.I. RTE.	SECTION	COUNTY	TOTAL SHEETS	SHEET NO.
70	D 7 HT PVMNT MRK RPR 22-16	CLARK	9	3
CONTRACT NO. 46580				
ILLINOIS FED. AID PROJECT				

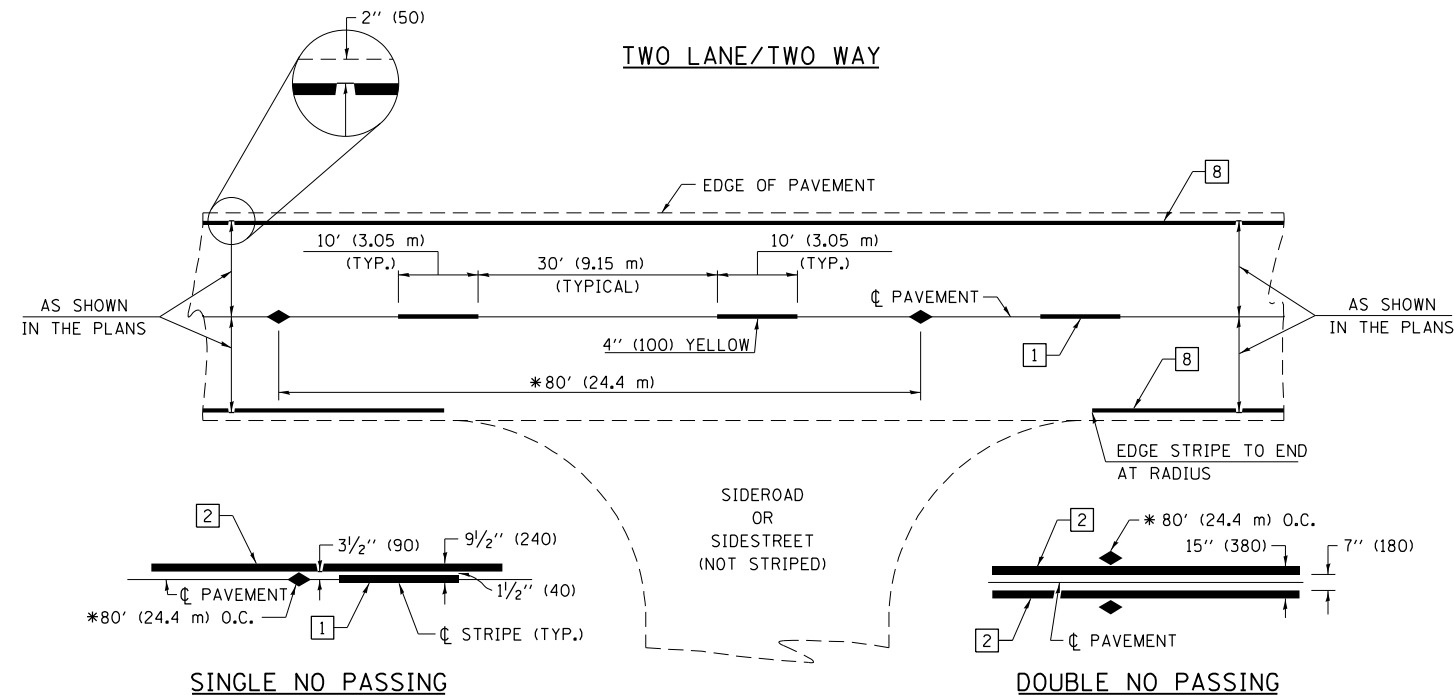

* REDUCE TO 40' (12.2 m) O.C. ON CURVES WITH POSTED OR ADVISORY SPEEDS OF 45 mph (70 km/h) OR LESS.

PAVEMENT MARKING LEGEND

- 1 4'' (100) SKIP-DASH (YELLOW)
 - 2 4'' (100) SOLID (YELLOW)
 - 3 12'' (300) DIAGONAL (YELLOW)
 - 4 4'' (100) DOUBLE YELLOW (NARROW)
 - 5 12'' (300) SOLID WHITE
 - 6 RESERVED
 - 7 6'' (150) SKIP-DASH (WHITE)
 - 8 4'' (100) SOLID (WHITE)
 - 9 12'' (300) DIAGONAL (WHITE)
 - 10 6'' (150) SOLID (WHITE)
 - 11 24'' (600) STOP BAR (WHITE)
 - 12 8'' (200) SOLID (WHITE)
 - 13 4'' (100) PARKING WHITE
-

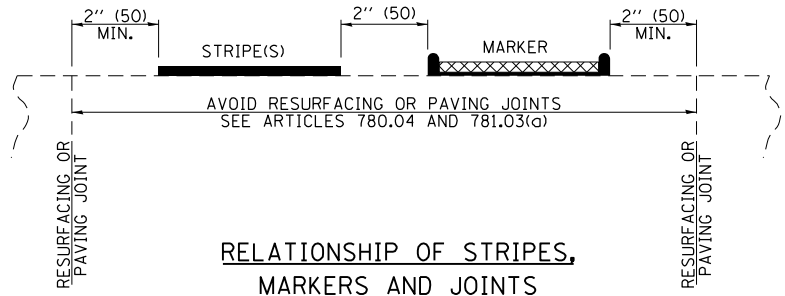

TYPICAL PAVEMENT MARKERS LEGEND

- ◆ TWO-WAY AMBER MARKER
- ▶ ONE-WAY AMBER MARKER
- ▷ ONE-WAY CRYSTAL MARKER

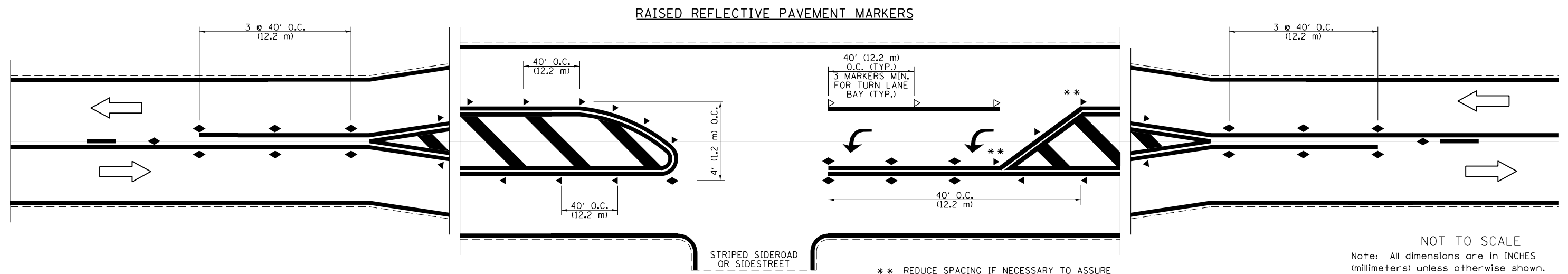

NOT TO SCALE
Note: All dimensions are in INCHES (millimeters) unless otherwise shown.

MODEL: Default
FILE NAME: p:\pub\baronm.dwg
PROJECT: 78000001.DISTRICT 7
OFFICE: DISTRICT 7
DATE: 6/16/2021

USER NAME = steffenmk	DESIGNED -	REVISED -
	DRAWN -	REVISED -
PLOT SCALE = 100,0000' / in.	CHECKED -	REVISED -
PLOT DATE = 6/16/2021	DATE -	REVISED -

STATE OF ILLINOIS
DEPARTMENT OF TRANSPORTATION

PAVEMENT MARKING AND RAISED REFLECTIVE PAVEMENT MARKERS
(RURAL & URBAN APPLICATIONS)

SCALE: SHEET OF SHEETS STA. TO STA.

DISTRICT 7 DETAIL NO. 78000001				
F.A.I. RTE.	SECTION	COUNTY	TOTAL SHEETS	SHEET NO.
70	D 7 HT PVMNT MRK RPR 22-16	CLARK	9	4
CONTRACT NO. 46580				
ILLINOIS		FED. AID PROJECT		

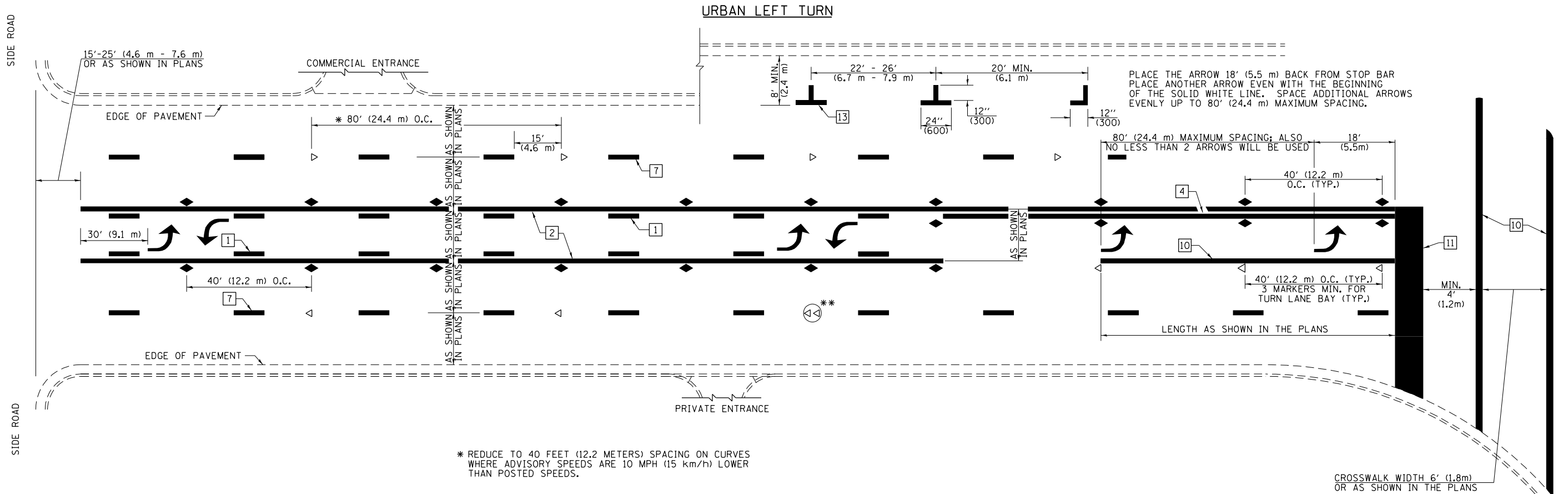

PLACE THE ARROW 18' (5.5 m) BACK FROM STOP BAR
PLACE ANOTHER ARROW EVEN WITH THE BEGINNING
OF THE SOLID WHITE LINE. SPACE ADDITIONAL ARROWS
EVENLY UP TO 80' (24.4 m) MAXIMUM SPACING.

- * REDUCE TO 40 FEET (12.2 METERS) SPACING ON CURVES WHERE ADVISORY SPEEDS ARE 10 MPH (15 km/h) LOWER THAN POSTED SPEEDS.
- ** DOUBLE LANE LINE MARKERS SHALL BE SPECIFIED AND SPACED AS SHOWN IN HIGHWAY STANDARD 781001 FOR MULTI-LANE DIVIDED AND UNDIVIDED HIGHWAYS.

PAVEMENT MARKING LEGEND

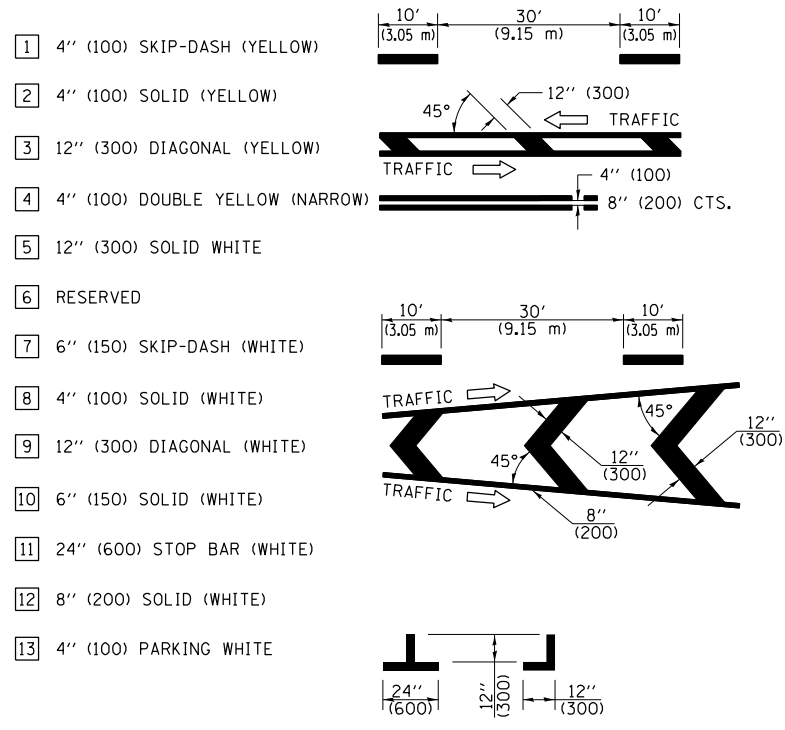

GENERAL NOTES

1. TURN ARROW PAIRS SHALL BE PLACED AT 250' (75 m) INTERVALS AND SHALL BE EVENLY SPACED BETWEEN BOTH ENDS OF THE BIDIRECTIONAL LEFT TURN LANE. USE A MINIMUM OF TWO PAIRS PER BLOCK.
2. THE SOLID YELLOW PAVEMENT MARKINGS [2] SHOULD GENERALLY START OR END NEAR THE RADIUS POINT OF EACH STREET RETURN EXCEPT WHERE ONE OR BOTH ENDS WOULD INCLUDE STOP BARS.
3. THE SKIP-DASH PAVEMENT MARKINGS [1] OR [7] SHOULD BE CENTERED BETWEEN BOTH ENDS OF EACH CITY BLOCK AND SHALL BE PLACED SO THEY LINE UP ACROSS FROM EACH OTHER.
4. USE LARGE ARROW SIZE FOR BOTH RURAL AND URBAN LOCATIONS. (SEE LAST PAGE OF SECTION 780x FOR SYMBOLS TABLE)
5. LANE LINE EXTENSIONS SHALL BE THE SAME COLOR AND WIDTH AS THE LANE LINE BEING EXTENDED.

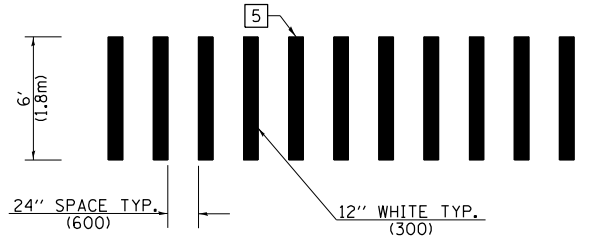

**CROSSWALK DETAIL
(DECATUR CITY LIMITS ONLY)**

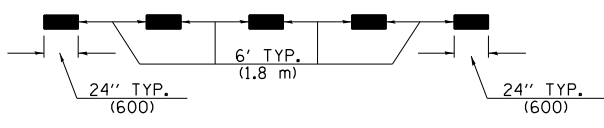

LANE LINE EXTENSIONS

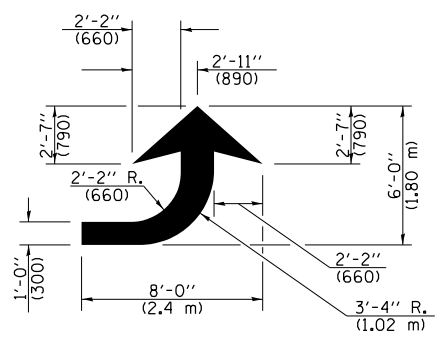

LEFT ARROW
REVERSE FOR RIGHT ARROW
AREA = 15.6 SQ. FT. (1.47 m²)
(WHITE)

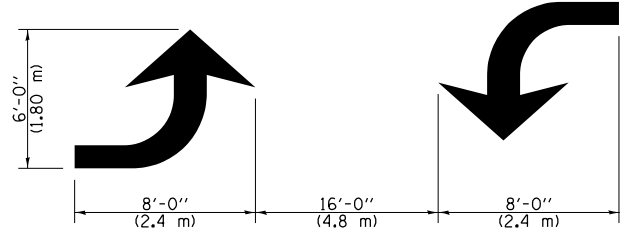

**TYPICAL DOUBLE
TURN ARROWS (WHITE)**

NOT TO SCALE

Note: All dimensions are in INCHES (millimeters) unless otherwise shown.

DISTRICT 7 DETAIL NO. 7800001

MODEL: Default
FILE NAME: p:\pub\baronm.dwt
PROJECT: 46580-CA00DataCAD\Project\7800001.dwg
PROJECT: 46580-CA00DataCAD\Project\7800001.dwg

USER NAME = stefenmk	DESIGNED -	REVISED -
	DRAWN -	REVISED -
PLOT SCALE = 100,0000' / in.	CHECKED -	REVISED -
PLOT DATE = 6/16/2021	DATE -	REVISED -

**STATE OF ILLINOIS
DEPARTMENT OF TRANSPORTATION**

PAVEMENT MARKING AND RAISED REFLECTIVE PAVEMENT MARKERS (RURAL & URBAN APPLICATIONS)			
SCALE:	SHEET	OF SHEETS	STA. TO STA.

F.A.I. RTE.	SECTION	COUNTY	TOTAL SHEETS	SHEET NO.
70	D 7 HT PVMNT MRK RPR 22-16	CLARK	9	5
CONTRACT NO. 46580			ILLINOIS FED. AID PROJECT	

ISLAND

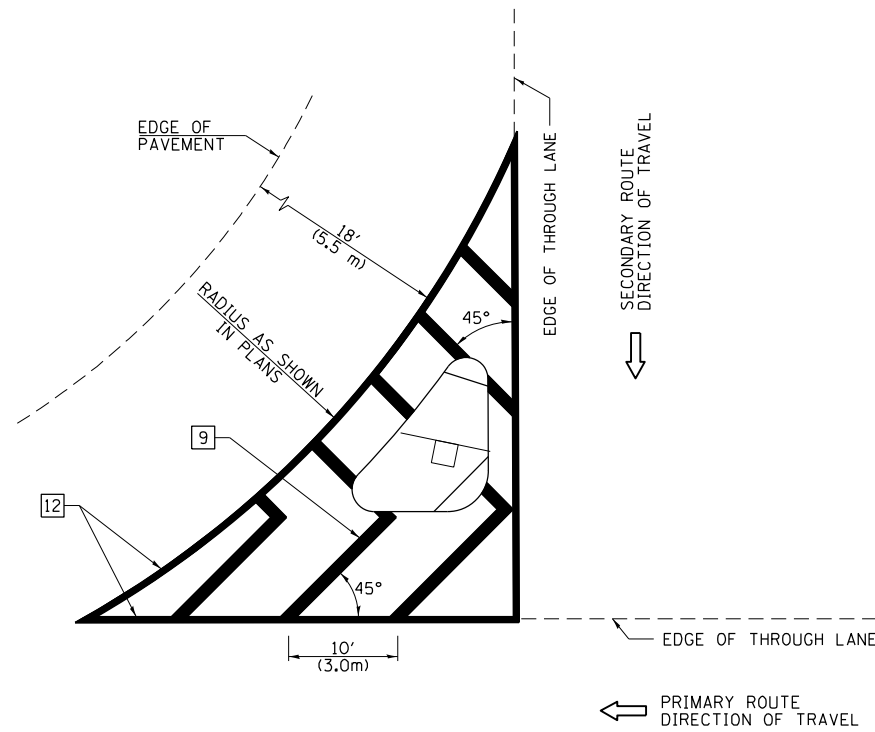

GENERAL NOTES

1. RAISED AND CORRUGATED MEDIANS SHALL BE OUTLINED WITH [2] IF PRESENT.
2. SOME OF THE INFORMATION INCLUDED WITH THIS DETAIL MAY NOT BE APPLICABLE TO THIS IMPROVEMENT.
3. PAVEMENT MARKINGS ARE TO BE EXTENDED THROUGH OMISSIONS WHEN APPLICABLE.
4. FINAL PAVEMENT MARKINGS SHALL BE IN PLACE PRIOR TO PLACING ANY RAISED REFLECTIVE PAVEMENT MARKERS.
5. THE FOLLOWING CRITERIA SHALL BE USED FOR SELECTING THE DIAGONAL PAVEMENT MARKING SPACING:

< 30 MPH (< 50 km/h)	15' (4.5 m)
30-45 MPH (50-75 km/h)	20' (6.0 m)
> 45 MPH (> 75 km/h)	30' (9.0 m)

PAVEMENT MARKING LEGEND

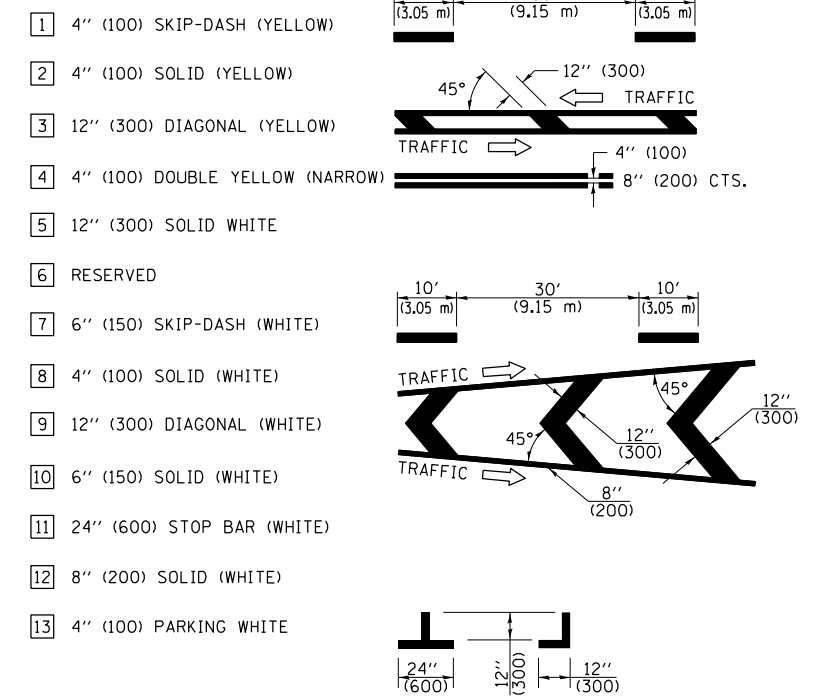

RURAL LEFT TURN STRIPING

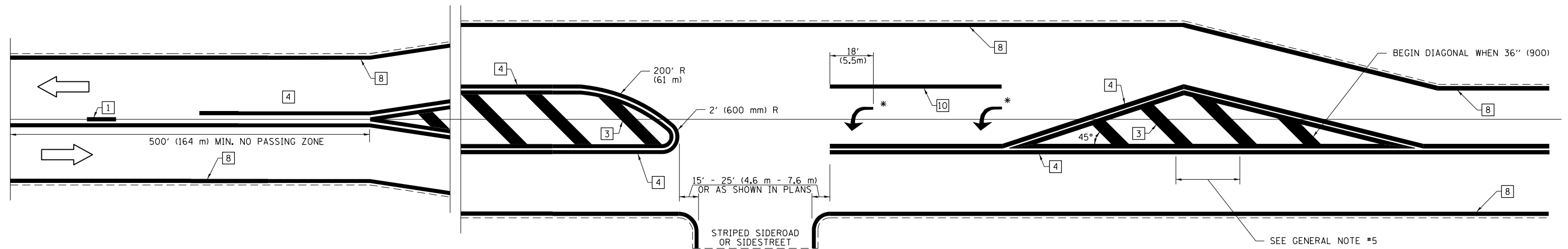

* PLACE AN ARROW 18' (5.5 m) BACK FROM STOP BAR. PLACE ANOTHER ARROW EVEN WITH THE BEGINNING OF THE SOLID WHITE LINE. SPACE ADDITIONAL ARROWS EVENLY UP TO 80' (24.4 m) MAXIMUM SPACING. USE MINIMUM OF 2 ARROWS.

SEE GENERAL NOTE #5

NOT TO SCALE

Note: All dimensions are in INCHES (millimeters) unless otherwise shown.

DISTRICT 7 DETAIL NO. 7800001

**STATE OF ILLINOIS
DEPARTMENT OF TRANSPORTATION**

**PAVEMENT MARKING AND RAISED REFLECTIVE PAVEMENT MARKERS
(RURAL & URBAN APPLICATIONS)**

F.A.I. RTE.	SECTION	COUNTY	TOTAL SHEETS	SHEET NO.
70	D 7 HT PVMNT MRK RPR 22-16	CLARK	9	6
			CONTRACT NO. 46580	
ILLINOIS FED. AID PROJECT				

SCALE: SHEET OF SHEETS STA. TO STA.

MODEL: Default
FILE NAME: p:\pub\baronm.dwt
PROJECT: 46580\CADD\Drawings\DOT - Office\Detail.dwg
7/16/2021 10:00:00 AM

USER NAME = steffenmk	DESIGNED -	REVISED -
PLOT SCALE = 100,0000' / in.	DRAWN -	REVISED -
PLOT DATE = 6/16/2021	CHECKED -	REVISED -
	DATE -	REVISED -

PAVEMENT MARKINGS AT RAILROAD-HIGHWAY GRADE CROSSING

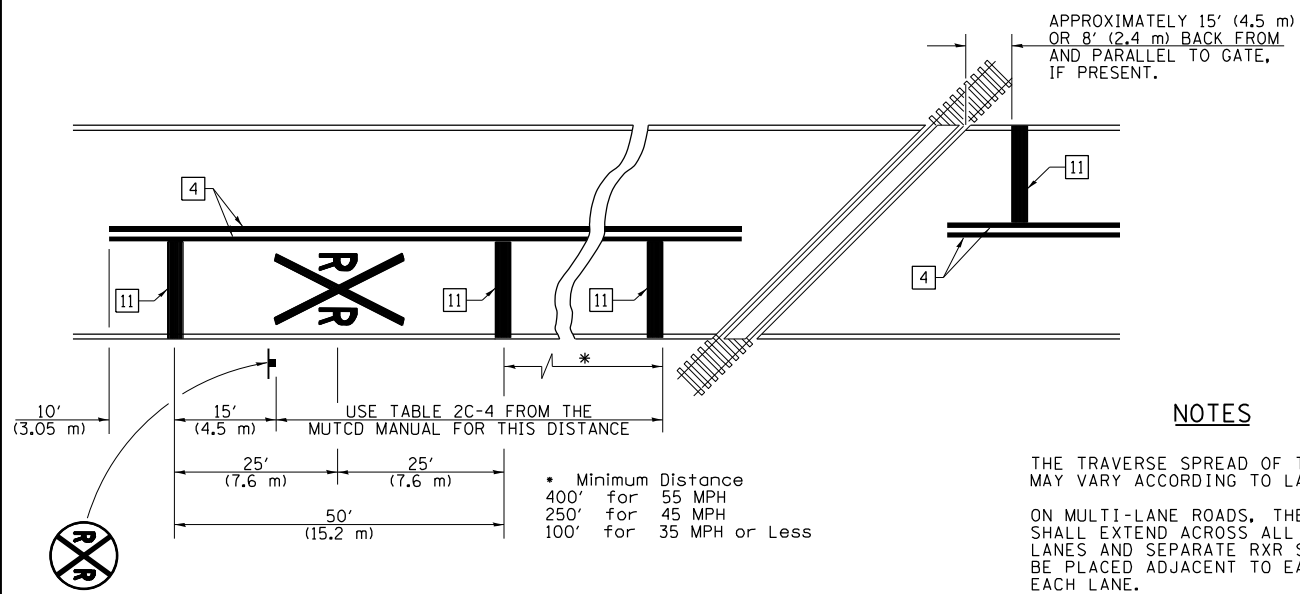

NOTES

THE TRAVERSE SPREAD OF THE "X" MAY VARY ACCORDING TO LANE WIDTH.

ON MULTI-LANE ROADS, THE STOP LINES SHALL EXTEND ACROSS ALL APPROACH LANES AND SEPARATE RXR SYMBOLS SHALL BE PLACED ADJACENT TO EACH OTHER IN EACH LANE.

WHEN THE PAVEMENT MARKING SYMBOL IS USED, A PORTION OF THE SYMBOL SHOULD BE LOCATED DIRECTLY ADJACENT TO THE ADVANCE WARNING SIGN (W10-1) AS PLACED BY TABLE II-1, CONDITION B OF THE MUTCD.

PAVEMENT MARKING LEGEND

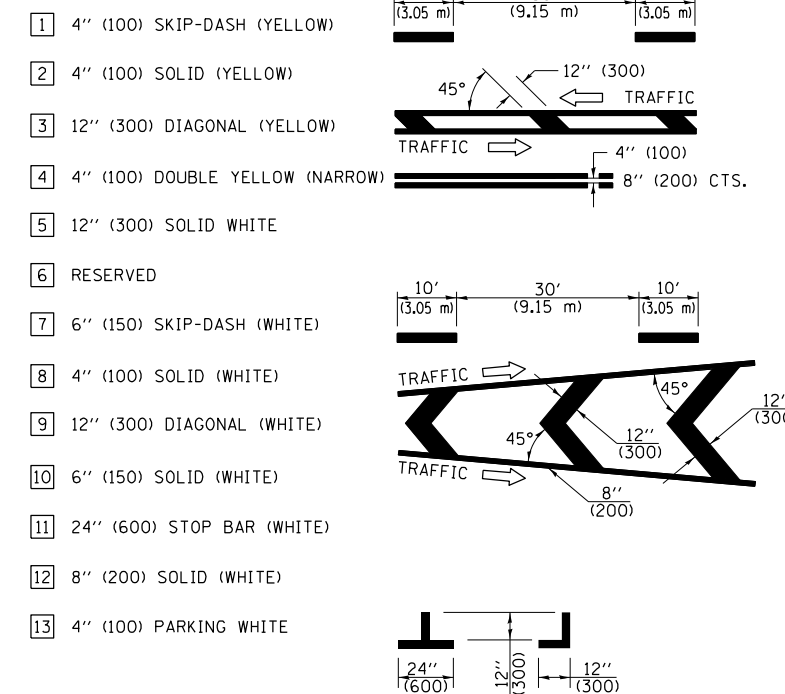

RAILROAD CROSSING WITH INTERCONNECT ONLY

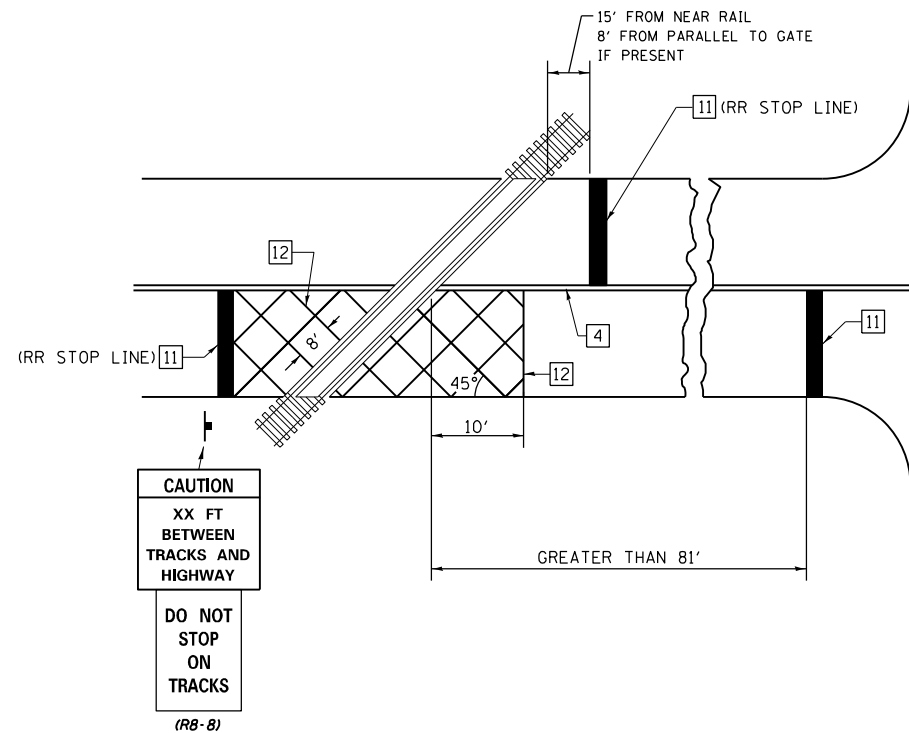

RAILROAD CROSSING WITH INTERCONNECT AND PRE-SIGNALS

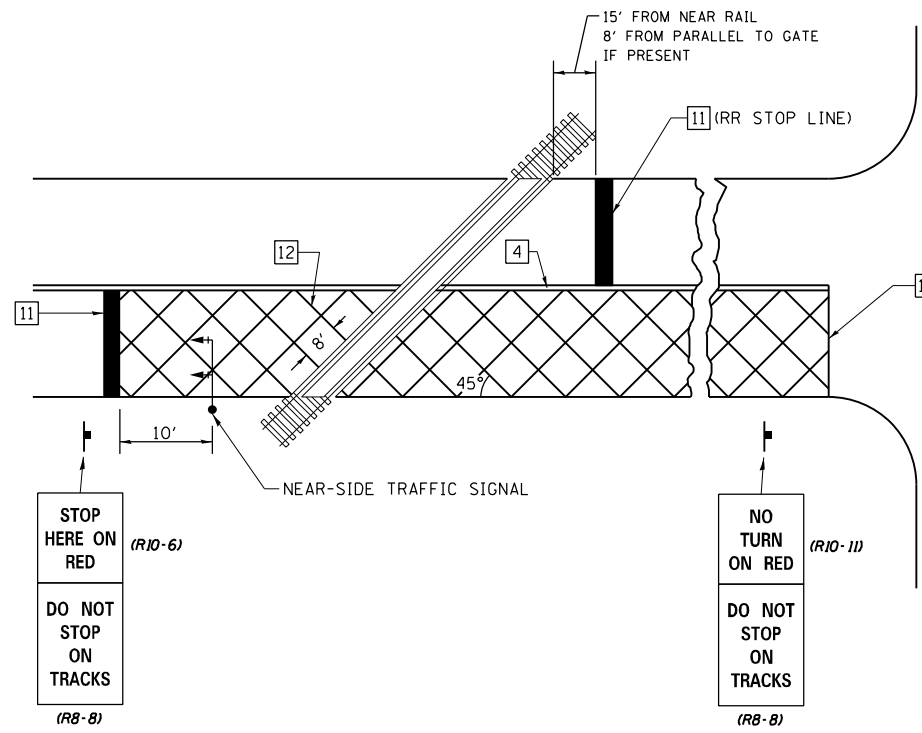

GENERAL NOTES

- SUPPLEMENTAL PAVEMENT MARKINGS TO BE INSTALLED ONLY ON APPROACHES TO INTERSECTIONS CONTROLLED BY TRAFFIC SIGNALS WHICH ARE INTERCONNECTED WITH THE RAILROAD WARNING SIGNALS.
- EXTEND PAVEMENT MARKINGS TO THE INTERSECTION ONLY WHERE NEAR-SIDE TRAFFIC SIGNALS ARE USED.

SUPPLEMENTAL PAVEMENT MARKING TREATMENT FOR RAILROAD-HIGHWAY GRADE CROSSING

NOT TO SCALE

Note: All dimensions are in INCHES (millimeters) unless otherwise shown.

DISTRICT 7 DETAIL NO. 78000001

STATE OF ILLINOIS
DEPARTMENT OF TRANSPORTATION

PAVEMENT MARKING AND RAISED REFLECTIVE PAVEMENT MARKERS
(RURAL & URBAN APPLICATIONS)

USER NAME = stefenmk	DESIGNED -	REVISED -
PLOT SCALE = 100,0000' / in.	DRAWN -	REVISED -
PLOT DATE = 6/16/2021	CHECKED -	REVISED -
	DATE -	REVISED -

F.A.I. RTE.	SECTION	COUNTY	TOTAL SHEETS	SHEET NO.
70	D 7 HT PVMNT MRK RPR 22-16	CLARK	9	7
			CONTRACT NO. 46580	
ILLINOIS FED. AID PROJECT				

SCALE: SHEET OF SHEETS STA. TO STA.

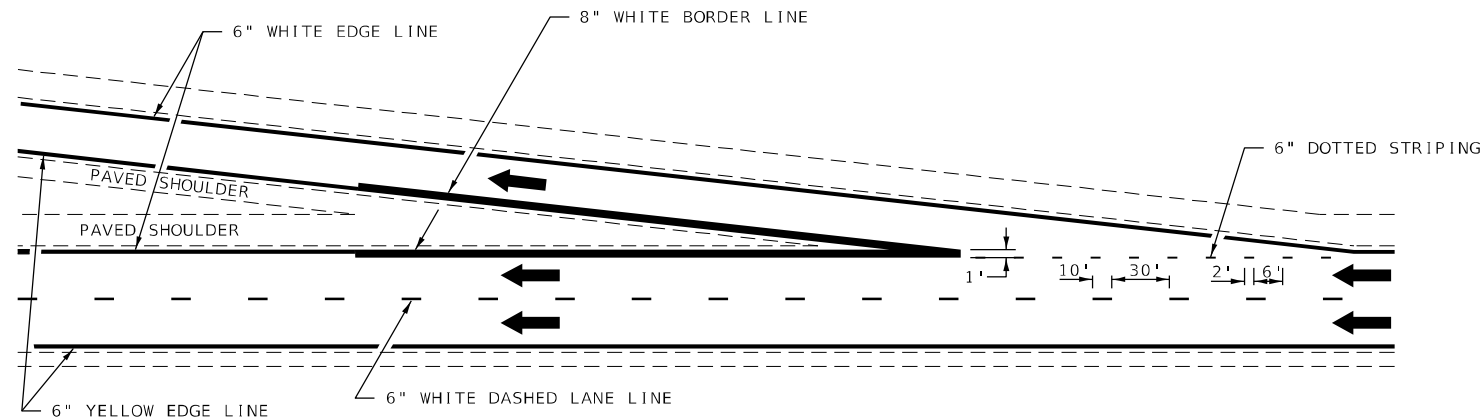

TYPICAL EXIT RAMP MARKING

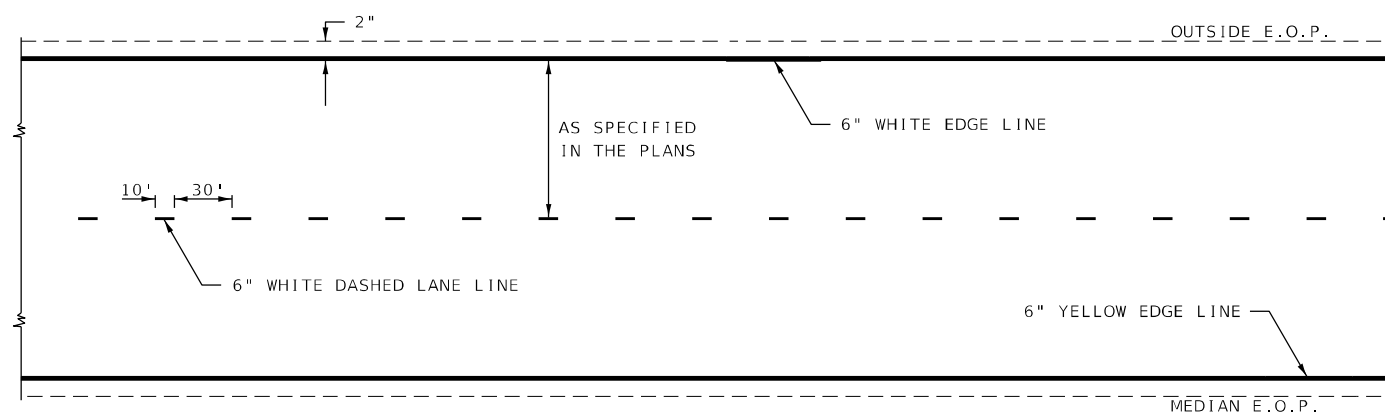

TYPICAL CENTERLING & EDGELINE MARKINGS

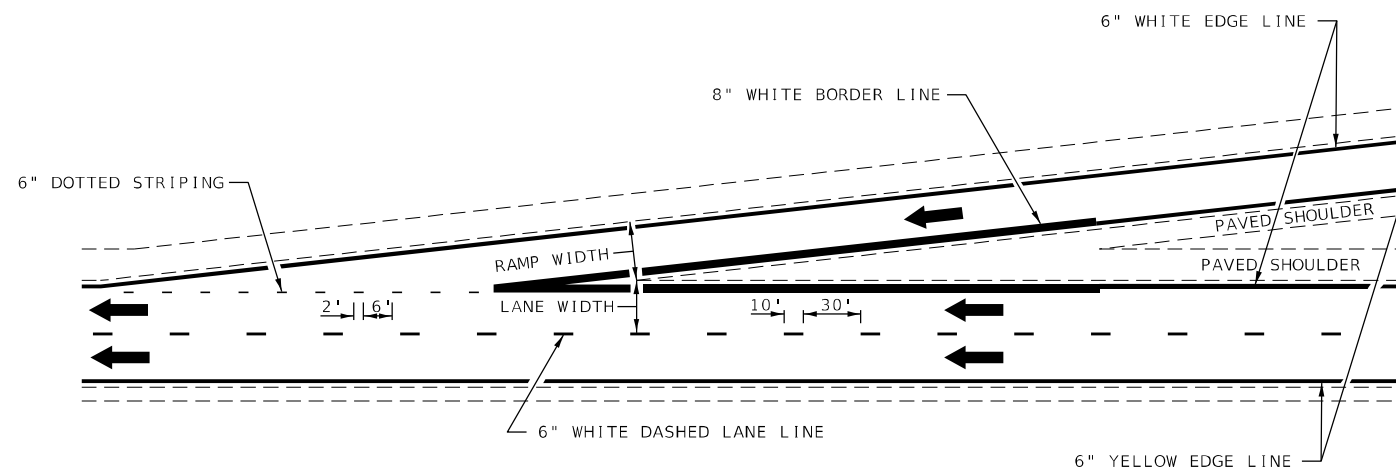

TYPICAL ENTRANCE RAMP MARKING

NOT TO SCALE

DISTRICT 7 DETAIL NO. 7800002

STATE OF ILLINOIS
DEPARTMENT OF TRANSPORTATION

TYPICAL APPLICATIONS OF INTERSTATE PAVEMENT MARKING

USER NAME = steffenmk	DESIGNED -	REVISED -
	DRAWN -	REVISED -
PLOT SCALE = 100,0000' / in.	CHECKED -	REVISED -
PLOT DATE = 6/16/2021	DATE -	REVISED -

SCALE: SHEET OF SHEETS STA. TO STA.

F.A.I. RTE.	SECTION	COUNTY	TOTAL SHEETS	SHEET NO.
70	D 7 HT PVMNT MRK RPR 22-16	CLARK	9	8
			CONTRACT NO. 46580	
ILLINOIS FED. AID PROJECT				

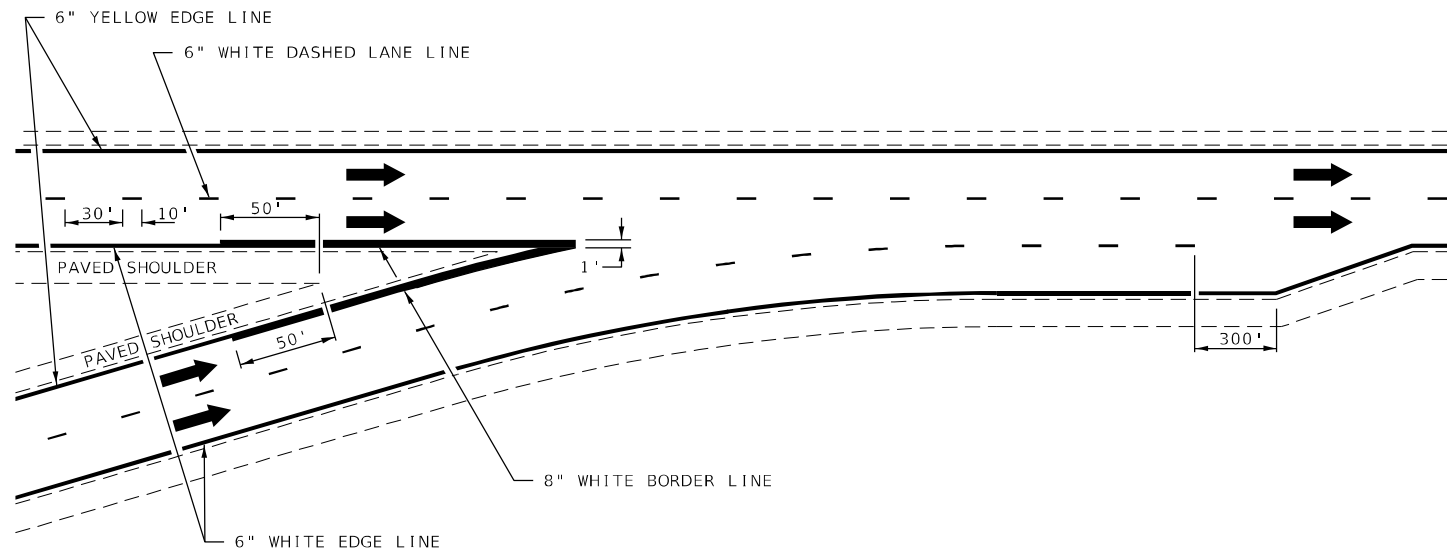

TYPICAL CONVERGENCE MARKING

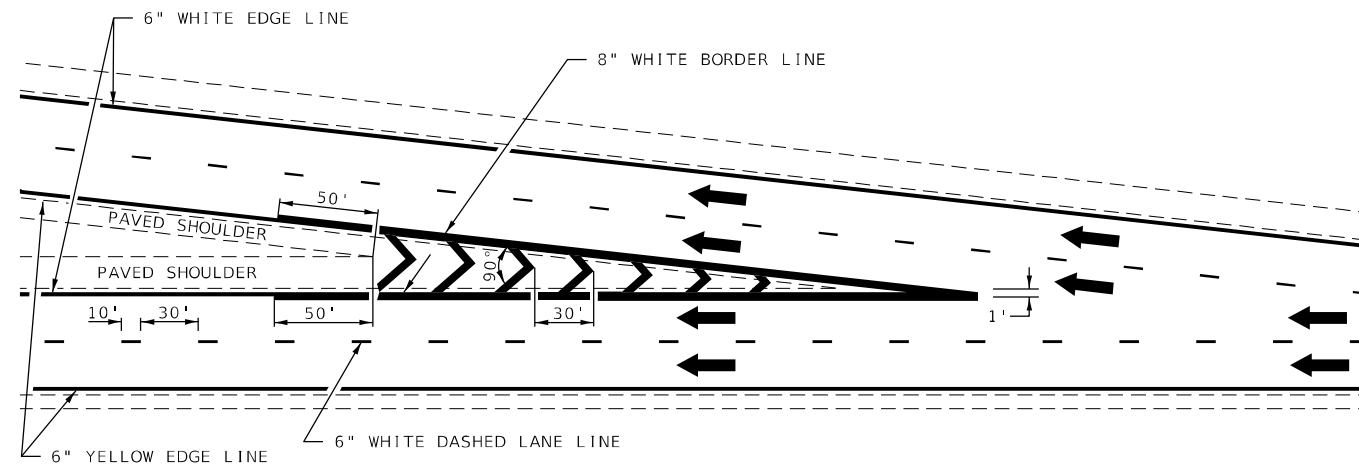

TYPICAL DIVERGENCE MARKING

AERIAL SPEED CHECK ZONES

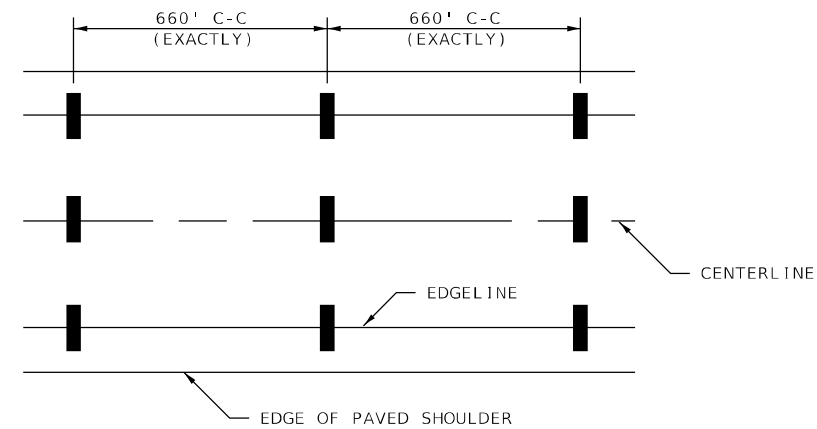

IT WILL BE NECESSARY TO HAVE A REPRESENTATIVE OF THE STATE POLICE PRESENT SO THAT THE ACCURACY OF MEASUREMENT CAN BE ATTESTED TO IN COURT.

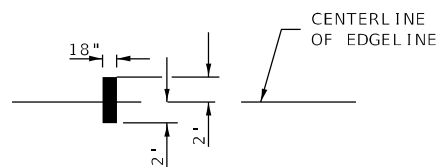

NOT TO SCALE

DISTRICT 7 DETAIL NO. 7800002

STATE OF ILLINOIS
 DEPARTMENT OF TRANSPORTATION

TYPICAL APPLICATIONS OF INTERSTATE PAVMENT MARKING

SCALE: SHEET OF SHEETS STA. TO STA.

F.A.I. RTE.	SECTION	COUNTY	TOTAL SHEETS	SHEET NO.
70	D 7 HT PVMNT MRK RPR 22-16	CLARK	9	9
			CONTRACT NO. 46580	
ILLINOIS FED. AID PROJECT				

MODEL: Default
 FILE NAME: p:\pub\harronm.dwt
 PROJECT: 46580-CA00DataCAD\Projects\1746580-514-dwt.rlk.dgn

USER NAME = steffenmk	DESIGNED -	REVISED -
	DRAWN -	REVISED -
PLOT SCALE = 100,0000' / in.	CHECKED -	REVISED -
PLOT DATE = 6/16/2021	DATE -	REVISED -