

STATE OF ILLINOIS
DEPARTMENT OF TRANSPORTATION

FAI RTE.		SECTION	COUNTY	TOTAL SHEETS	SHEET NO.
57				6	1
ILLINOIS CONTRACT NO. 78872					

**PROPOSED
HIGHWAY PLANS**

FAI 57 ROUTE I-57/US 51
SECTION D9 PAVT PRESERVATION 2021-1
PROJECT NHPP-WTR5(208)
MICROSURFACING
UNION AND PULASKI COUNTIES

FOR INDEX OF SHEETS, SEE SHEET NO. 3
FOR SUMMARY OF QUANTITIES, SEE SHEET NO. 4

TRAFFIC DATA

	2020	2021	2031	2041
PV	2825	2870	3330	3865
SU	175	180	205	240
MU	3500	3550	4125	4785
ADT	6500	6600	7660	8890

TOWNSHIPS

DONGOLA
WETAUG

DESIGN DESIGNATION : N/A
COORDINATE SYSTEM : N/A
POSTED SPEED : 70 MPH

J.U.L.I.E.
JOINT UTILITY LOCATION INFORMATION FOR EXCAVATION
1-800-892-0123
OR 811

PROJECT ENGINEER VALERIE ROLLA
PROJECT DESIGNER LISA DAILY

CONTRACT NO. 78872

C-99-066-21

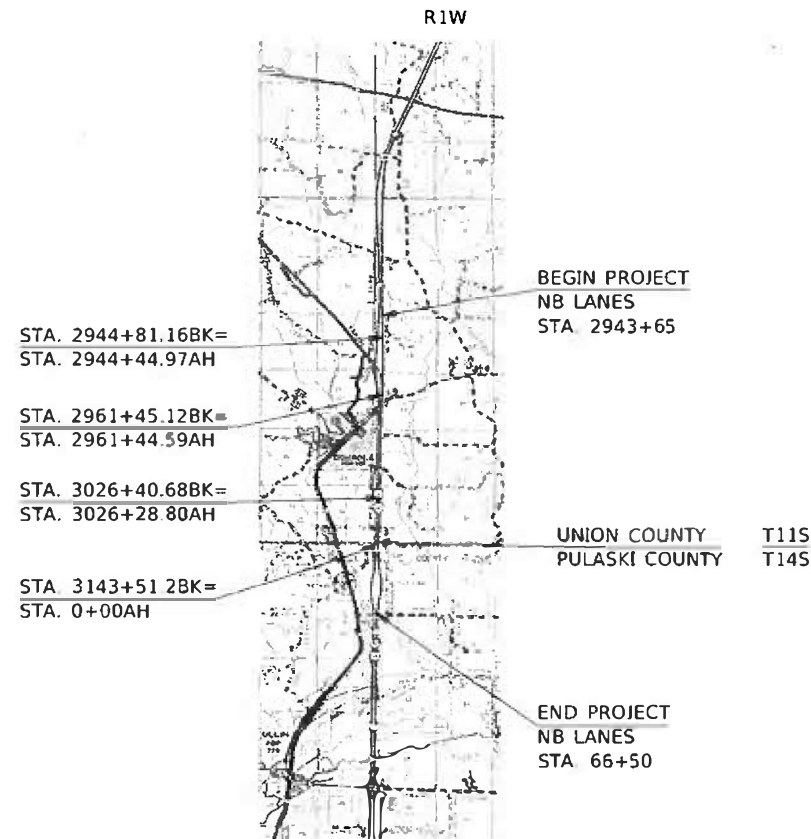

GROSS LENGTH = 26224.89 FT. = 4.97 MILES
NET LENGTH = 26684.80 FT. = 5.05 MILES

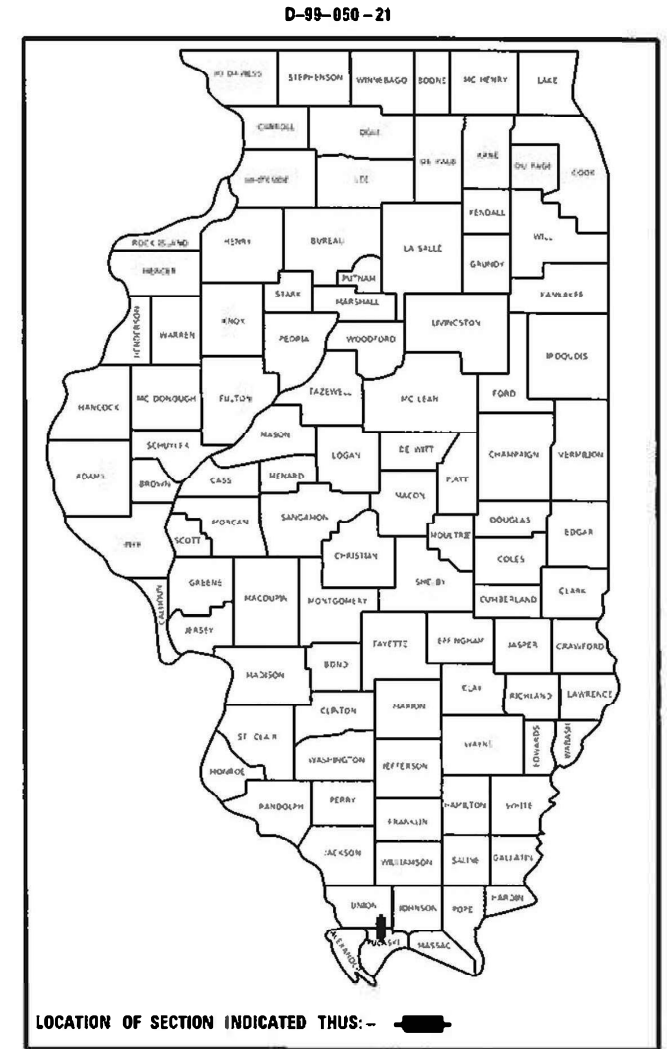

STATE OF ILLINOIS
DEPARTMENT OF TRANSPORTATION

SUBMITTED 04-19-2021
[Signature]
REGION FIVE ENGINEER

June 25, 2021
[Signature]
ENGINEER OF DESIGN AND ENVIRONMENT

June 25, 2021
[Signature]
DIRECTOR OF HIGHWAYS PROJECT IMPLEMENTATION

**PRINTED BY THE AUTHORITY
OF THE STATE OF ILLINOIS**

Model: D:\Auto... FILE NAME: ...

Prepared By: Charles Stein
 DISTRICT STUDIES & PLANS ENGINEER

Examined By: Nancy [Signature]
 DISTRICT LAND ACQUISITION ENGINEER

Examined By: Cam [Signature]
 DISTRICT PROGRAM DEVELOPMENT ENGINEER

Examined By: Kevin [Signature]
 DISTRICT OPERATIONS ENGINEER

Examined By: [Signature]
 DISTRICT PROJECT IMPLEMENTATION ENGINEER

Examined By: Douglas [Signature]
 DISTRICT CONSTRUCTION ENGINEER

Examined By: Rob Graeff (AH)
 DISTRICT MATERIALS ENGINEER

USER NAME = dailyj	DESIGNED - _____	REVISED - _____
	DRAWN - _____	REVISED - _____
PLOT SCALE = 100.0000' / in.	CHECKED - _____	REVISED - _____
PLOT DATE = 4/9/2021	DATE - _____	REVISED - _____

**STATE OF ILLINOIS
 DEPARTMENT OF TRANSPORTATION**

SIGNATURE SHEET

SCALE: _____ SHEET _____ OF _____ SHEETS STA. _____ TO STA. _____

F.A.I. RTE.	SECTION	COUNTY	TOTAL SHEETS	SHEET NO.
57			6	2
CONTRACT NO. 78872				

SUMMARY OF QUANTITIES

COUNTY:	UNION COUNTY	PULASKI COUNTY
ROUTE:	FAI 57	FAI 57
FUNDING:	90% FEDERAL 10% STATE	90% FEDERAL 10% STATE
LOCATION:	URBAN	URBAN
	ROADWAY	ROADWAY
	0005	0005

CODE NUMBER	ITEM DESCRIPTION	UNIT	TOTAL QUANTITY	ROADWAY 0005	ROADWAY 0005
4040020	BUMP REMOVAL	EACH	1	1	
4040018	MICRO-SURFACING, SINGLE PASS	SQ YD	69,937	52,203	17,734
40600290	BITUMINOUS MATERIALS (TACK COAT)	POUND	15,735	11,745	3,990
67100100	MOBILIZATION	L SUM	1	0.75	0.25
70100420	TRAFFIC CONTROL AND PROTECTION, STANDARD 701411	EACH	3	3	
70100800	TRAFFIC CONTROL AND PROTECTION, STANDARD 701401	L SUM	1	0.75	0.25
70107025	CHANGEABLE MESSAGE SIGN	CAL DA	42	28	14
70300100	SHORT TERM PAVEMENT MARKING	FOOT	2622	1966	656
70300150	SHORT TERM PAVEMENT MARKING REMOVAL	SQ FT	874	655	219
70300240	TEMPORARY PAVEMENT MARKING - LINE 6"	FOOT	59036	44066	14970
* 78001130	PAINT PAVEMENT MARKING - LINE 6"	FOOT	59036	44066	14970
* 78100100	RAISED REFLECTIVE PAVEMENT MARKER	EACH	664	496	168
78300200	RAISED REFLECTIVE PAVEMENT MARKER REMOVAL	EACH	664	496	168
78300201	PAVEMENT MARKING REMOVAL - GRINDING	SQ FT	19680	14690	4990

* SPECIALTY ITEM

MODIFIED: D:\aun... FILE NAME: ... PROJECT: ... SHEETS: 4

USER NAME = daly	DESIGNED -	REVISED -
PLOT SCALE = 100 0000	DRAWN -	REVISED -
PLOT DATE = 4/16/2021	CHECKED -	REVISED -
	DATE -	REVISED -

**STATE OF ILLINOIS
DEPARTMENT OF TRANSPORTATION**

SUMMARY OF QUANTITIES

SCALE _____ SHEET _____ OF _____ SHEETS STA. _____ TO STA. _____

F.A.I. RTE.	SECTION	COUNTY	TOTAL SHEETS	SHEET NO.
57		..	6	4
CONTRACT NO. 78872				

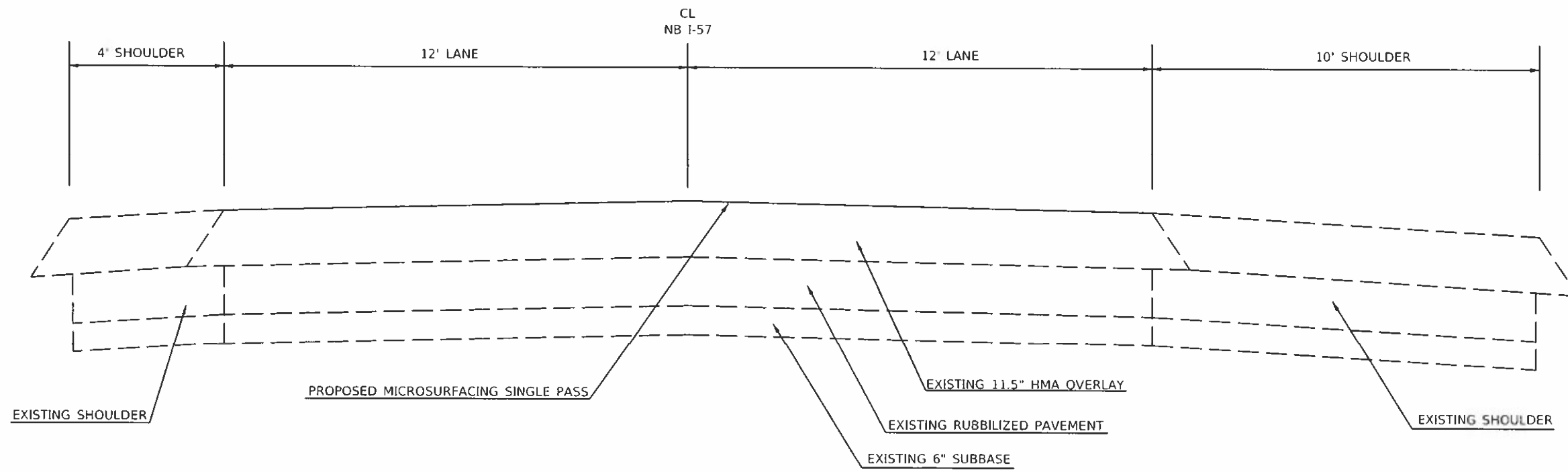

NORTHBOUND
 STA. 2943+65 TO STA. 3073+00
 STA. 3079+00 TO STA. 66+50

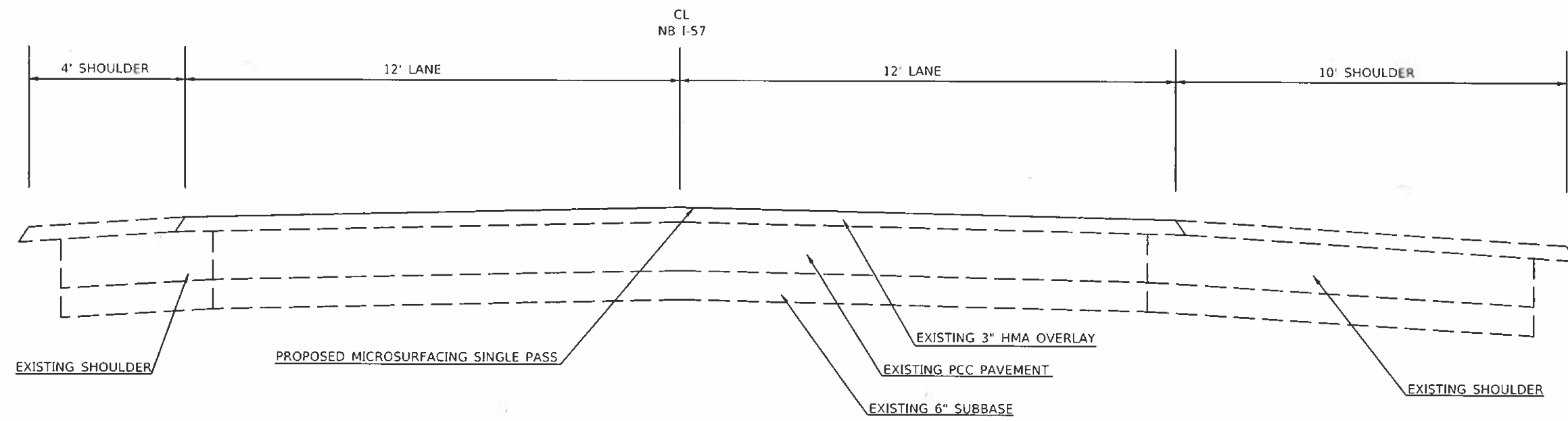

NORTHBOUND
 STA. 3073+00 TO STA. 3079+00

MODEL: D:\work\...
 FILE NAME: ...

USER NAME = baryll	DESIGNED - _____	REVISED - _____
PLOT SCALE = 100 0000' / in.	DRAWN - _____	REVISED - _____
PLOT DATE = 4/16/2021	CHECKED - _____	REVISED - _____
	DATE - _____	REVISED - _____

**STATE OF ILLINOIS
 DEPARTMENT OF TRANSPORTATION**

TYPICAL SECTIONS	
SCALE _____	SHEET _____ OF _____ SHEETS
STA _____	TO STA _____

F.A.L. RTE.	SECTION	COUNTY	TOTAL SHEETS	SHEET NO.
57			6	5
CONTRACT NO. 78872				

