

F.A.I. RTE.	SECTION	COUNTY	TOTAL SHEETS	SHEET NO.
90/94	2005-032 I	COOK	37	15
STA. 201+70.50		TO STA. 203+00		
FED. ROAD DIST. NO. 1 ILLINOIS FED. AID PROJECT				

60A03

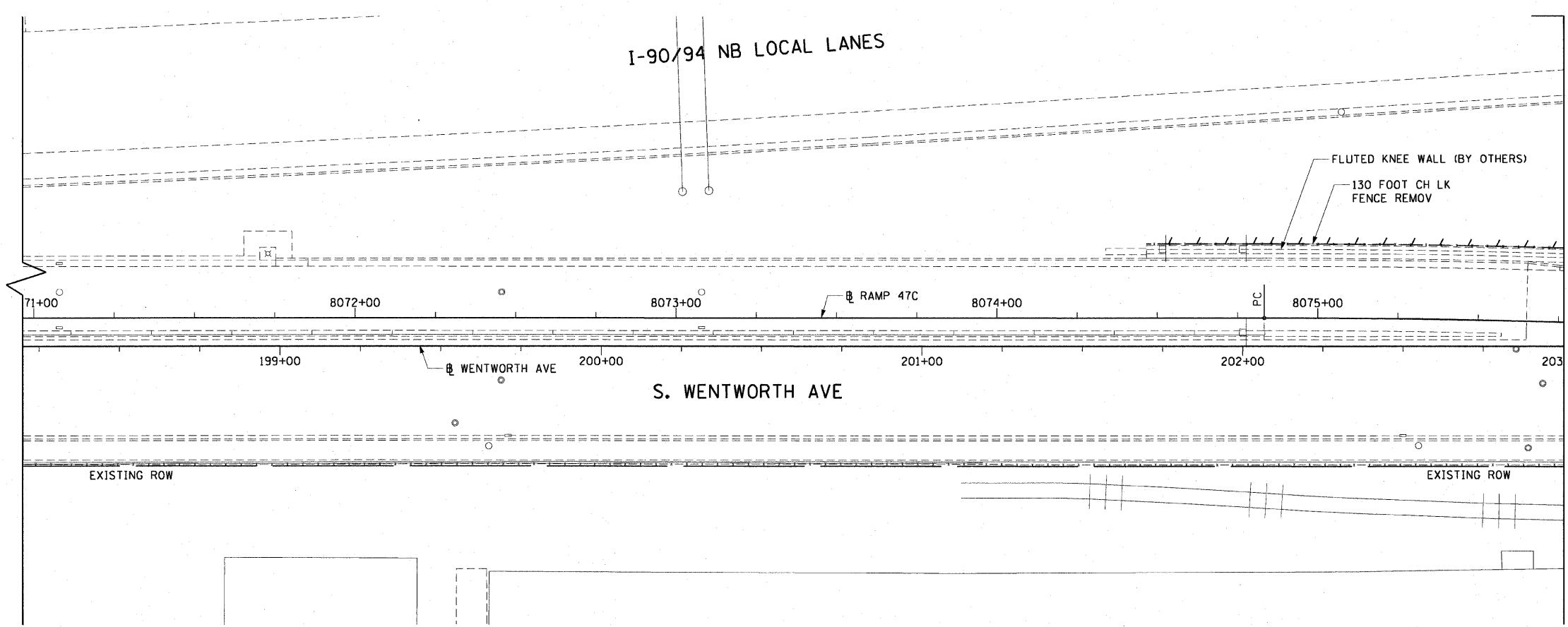
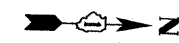

LEGEND:  

 LINEAR REMOVALS

EXISTING CONDITIONS AND REMOVAL  
 PROPOSED IMPROVEMENTS

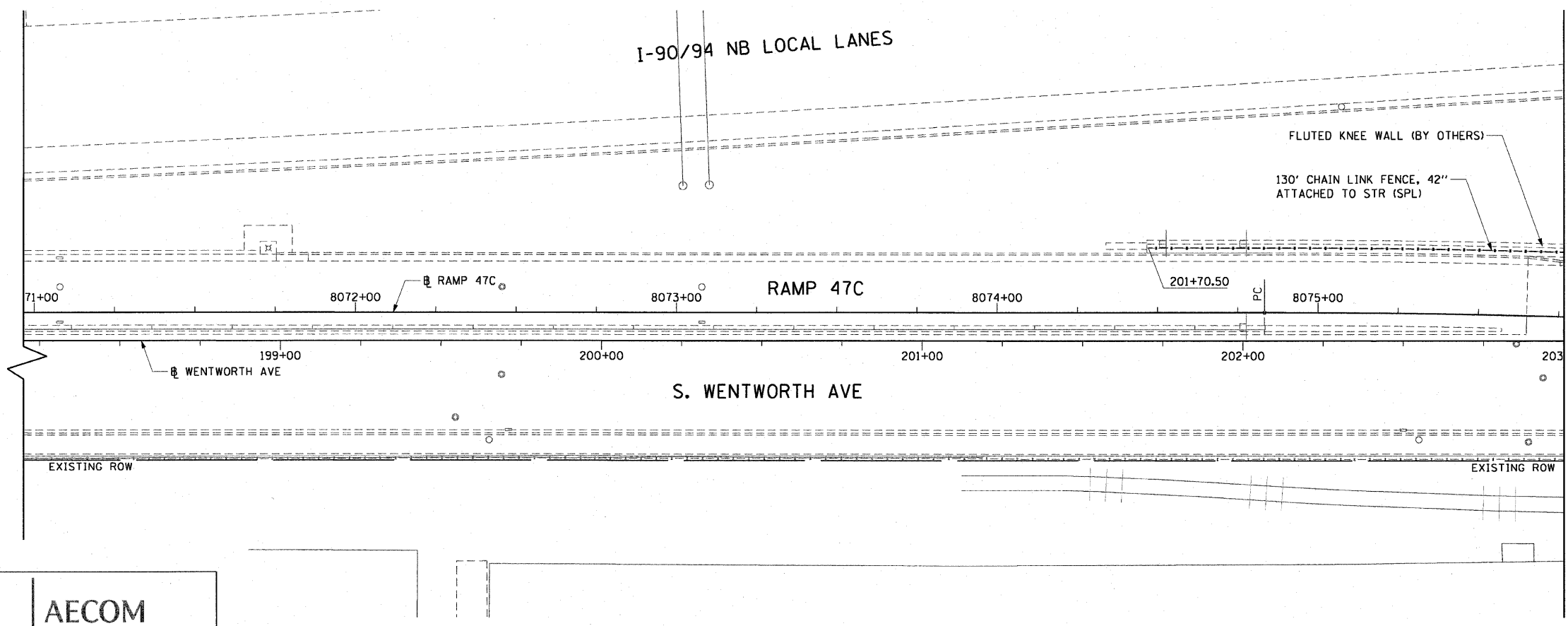

- NOTES:
1. SEE STRUCTURAL DETAILS FOR CHAIN LINK FENCE DETAILS.
  2. ALL STATION CALLOUTS ARE TAKEN AT THE CENTERLINE OF THE CHAIN LINK FENCE.
  3. FLUTED KNEE WALL CONSTRUCTED IN CONTRACT 62986.

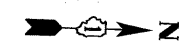

MATCH LINE STA 203+00

REVISIONS	
NAME	DATE

ILLINOIS DEPARTMENT OF TRANSPORTATION  
 F.A.I. 90/94 (DAN RYAN EXPRESSWAY)  
 71ST ST TO 47TH ST (NB & SB FENCE AND GATES)

EXISTING AND PROPOSED ROADWAY PLANS  
 WENTWORTH AVENUE

SCALE: 1"=20'  
 DATE: JANUARY 14, 2009

DRAWN BY: NJH  
 CHECKED BY: RMG

AECOM

12:34:15 PM  
 1/13/2009