

F.A.I. RTE.	SECTION	COUNTY	TOTAL SHEETS	SHEET NO.
90/94	2005-032 I	COOK	37	17
STA. 208+00		TO STA. 208+91.05		
FED. ROAD DIST. NO. 1		ILLINOIS FED. AID PROJECT		

60A03

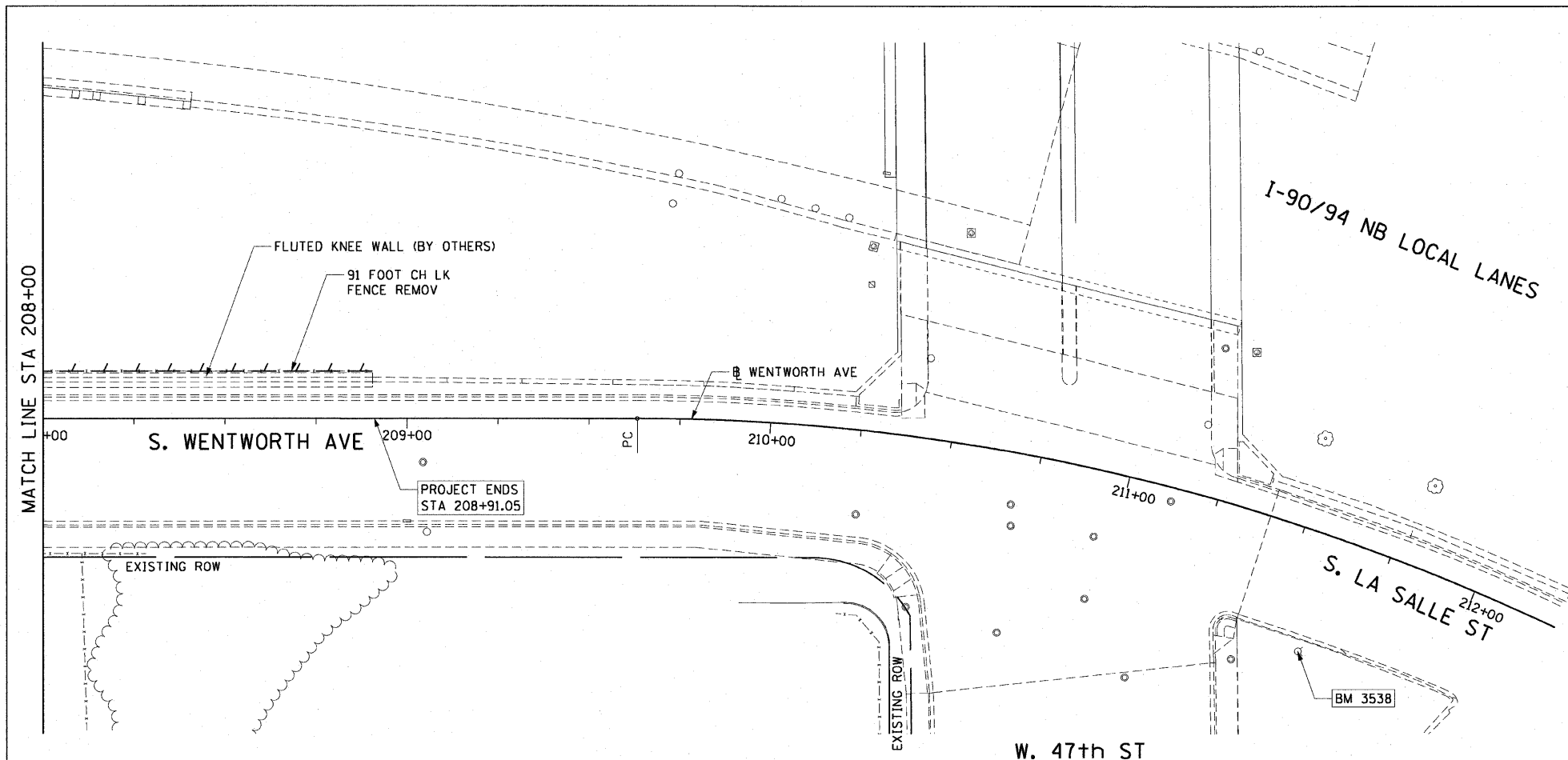
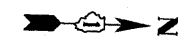

LEGEND:
 LINEAR REMOVALS

EXISTING CONDITIONS AND REMOVAL
 PROPOSED IMPROVEMENTS

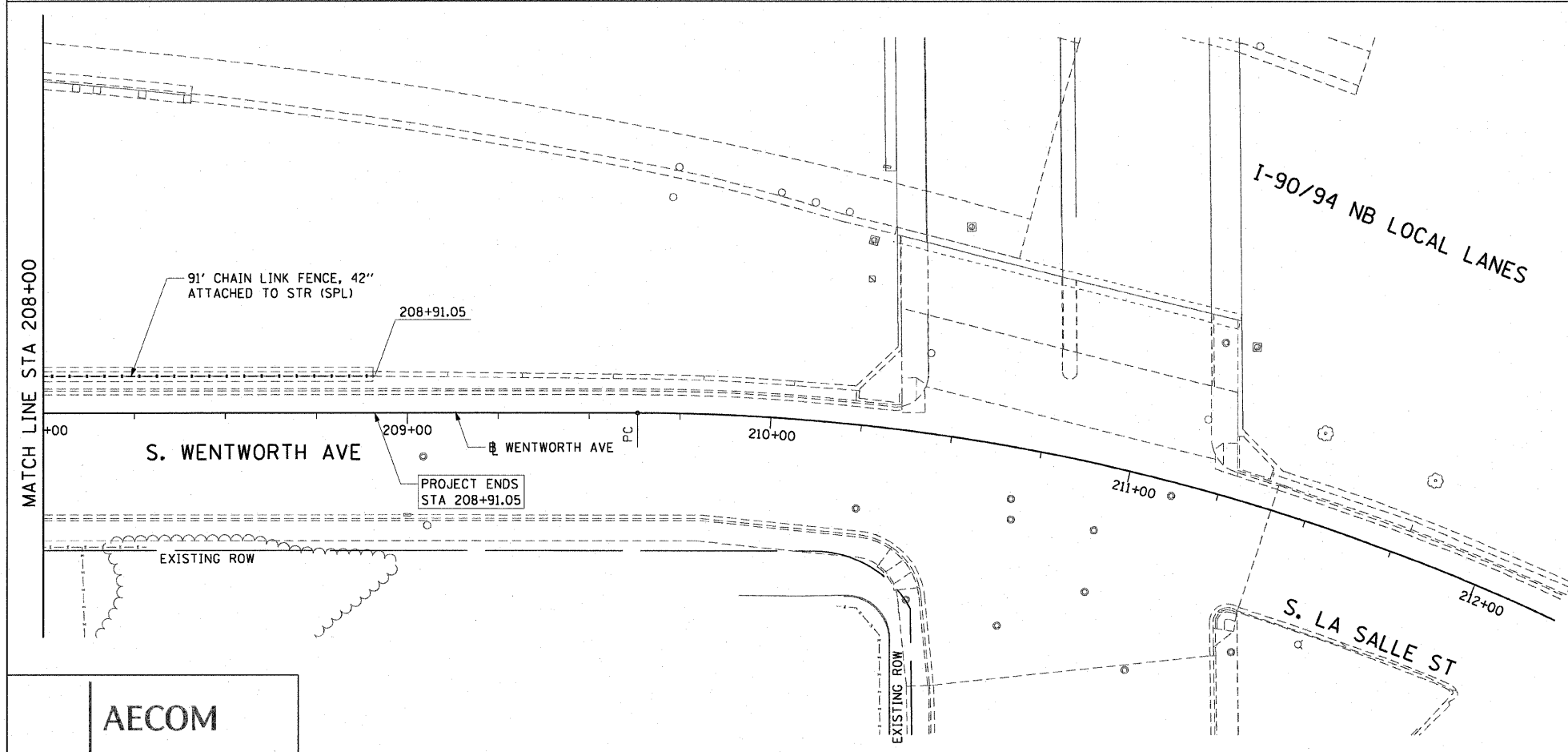

- NOTES:
1. SEE STRUCTURAL DETAILS FOR CHAIN LINK FENCE DETAILS.
 2. ALL STATION CALLOUTS ARE TAKEN AT THE CENTERLINE OF THE CHAIN LINK FENCE.
 3. FLUTED KNEE WALL CONSTRUCTED IN CONTRACT 62986.

REVISIONS	
NAME	DATE

ILLINOIS DEPARTMENT OF TRANSPORTATION
 F.A.I. 90/94 (DAN RYAN EXPRESSWAY)
 71ST ST TO 47TH ST (NB & SB FENCE AND GATES)
 EXISTING AND PROPOSED ROADWAY PLANS
 WENTWORTH AVENUE
 SCALE: 1"=20'
 DATE: JANUARY 14, 2009
 DRAWN BY: NJH
 CHECKED BY: RMG

AECOM

N:\sch\1207\p40465\p40465.dwg 12/28/09 12:34:16 PM