

STATE OF ILLINOIS
DEPARTMENT OF TRANSPORTATION

F.A.P. RTE.	SECTION	COUNTY	TOTAL SHEETS	SHEET NO.
315	(116) RS-7	LOGAN	8	1
		ILLINOIS	CONTRACT NO. 72L81	

D-96-047-20

FOR INDEX OF SHEETS, SEE SHEET NO. 2

HIGHWAY CLASSIFICATION

F.A.P. Route 315 (US 136)
fr 0.1 Mi W of IL Central RR near EMDEN
to 0.1 Mi W of Emden Rd (600th Ave)

CLASSIFICATION: OTHER PRINCIPLE ARTERIAL

ADT: 2,200 (2019) PV = 86.75%
DESIGN SPEED: 60 MPH SU = 10.75%
POSTED SPEED: 55 MPH MU = 2.50%

**PROPOSED
HIGHWAY PLANS**

**FAP ROUTE 315 (US 136)
SECTION (116) RS-7
PROJECT NHPP-H911(636)
RESURFACING
LOGAN COUNTY**

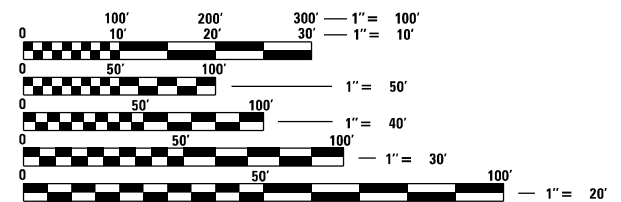
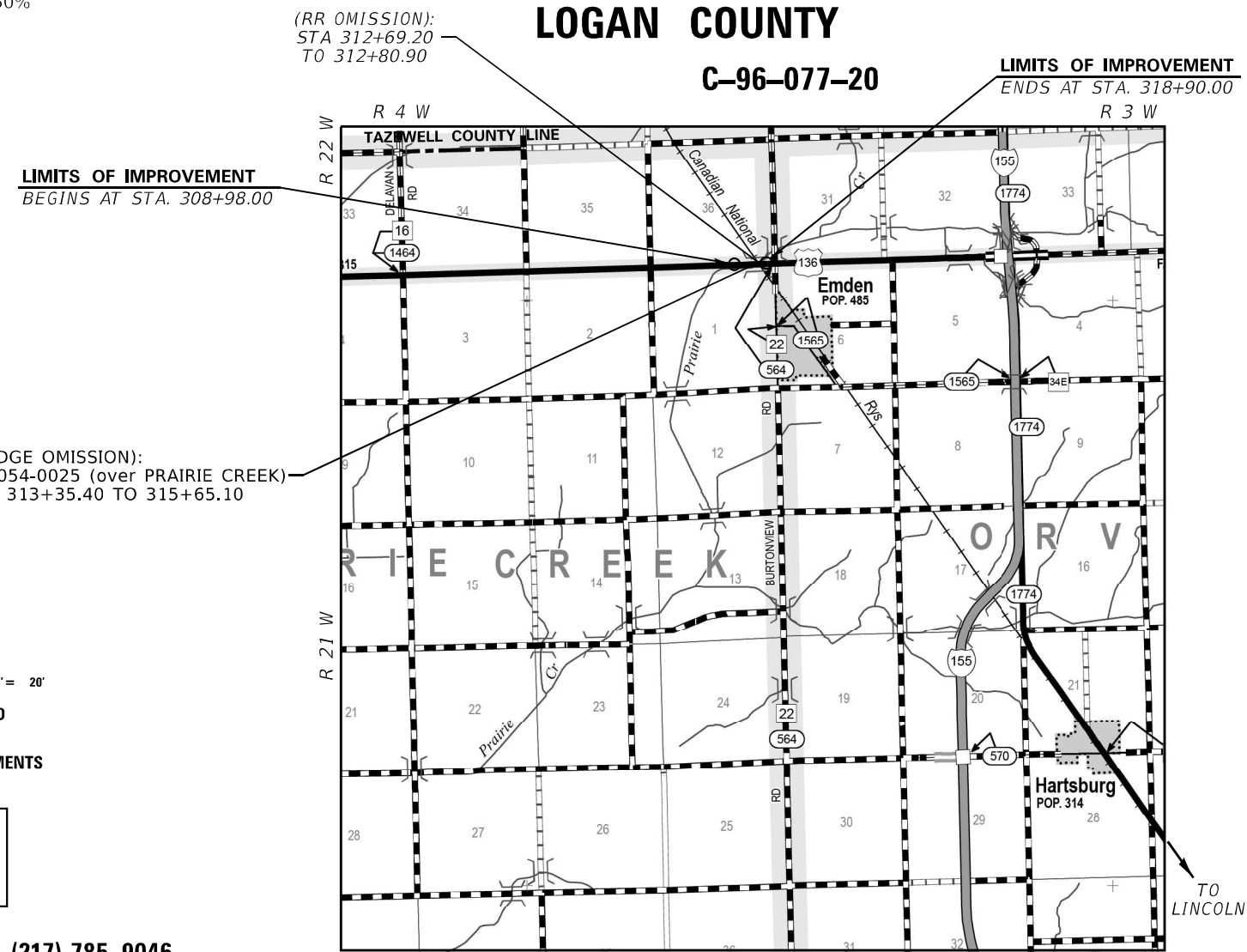
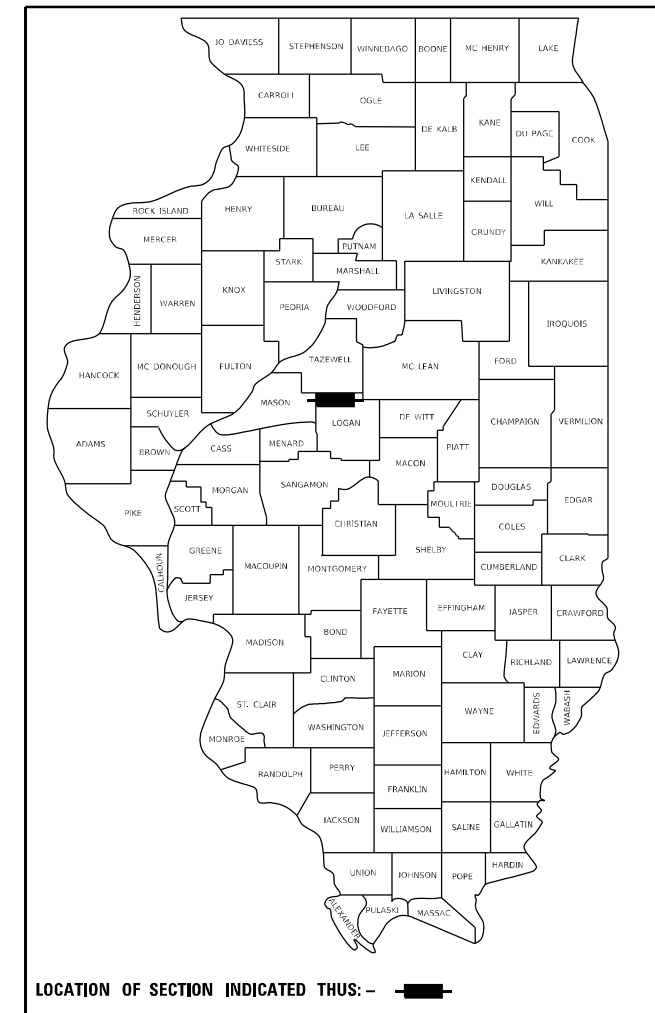

FULL SIZE PLANS HAVE BEEN PREPARED USING STANDARD ENGINEERING SCALES. REDUCED SIZED PLANS WILL NOT CONFORM TO STANDARD SCALES. IN MAKING MEASUREMENTS ON REDUCED PLANS, THE ABOVE SCALES MAY BE USED.

J.U.L.I.E.
JOINT UTILITY LOCATION INFORMATION FOR EXCAVATORS
1-800-892-0123
OR 811

PROJECT ENGINEER: JAY WAVERING (217) 785-9046
TEAM ENGINEER: RENE CABRERA (217) 558-5140

CONTRACT NO. 72L81

NET LENGTH = 750.60 FT. = 0.14 MI.
GROSS LENGTH = 992.00 FT. = 0.19 MI.

STATE OF ILLINOIS
DEPARTMENT OF TRANSPORTATION

SUBMITTED May 8 2020

Jay P. Wavering REGIONAL ENGINEER

June 26, 2020

Scott A. Etk ENGINEER OF DESIGN AND ENVIRONMENT

June 26, 2020

James J. Gu DIRECTOR OF HIGHWAYS PROJECT IMPLEMENTATION

**PRINTED BY THE AUTHORITY
OF THE STATE OF ILLINOIS**

GENERAL NOTES

GENERAL NOTES

- ① THE APPROXIMATE AVERAGE THICKNESS OF 1½" IS USED FOR CALCULATING QUANTITY FOR AGGREGATE WEDGE SHOULDER, TYPE B.
- ② THE FOLLOWING MIXTURE REQUIREMENTS ARE APPLICABLE:

LOCATION(S):	US 136	US 136	US 136
MIXTURE USE(S):	HMA CONC SURF CSE	HMA CONC BIND CSE	HMA SHLDR
AC/PG:	PG 64-22	PG 64-22	PG 64-22
DESIGN AIR Voids	4.0% @ N design = 50	4.0% @ N design = 50	4.0% @ N design = 50
MIXTURE COMPOSITION (Gradation Mixture)	IL 9.5	IL 19.0	IL 9.5
FRICTION AGGREGATE	MIX "C"	N/A	MIX "C"
QUALITY MANAGEMENT	QC/QA	QC/QA	QC/QA
SUBLOT SIZE	N/A	N/A	N/A

INDEX OF SHEETS

- 1 COVER SHEET
- 2 INDEX OF SHEETS, LISTS OF STANDARDS, GENERAL NOTES AND COMMITMENTS
- 3 - 4 SUMMARY OF QUANTITIES (2)
- 5 SCHEDULE OF QUANTITIES
- 6 TYPICAL SECTIONS
- 7 - 8 PLAN SHEETS (2)

STANDARDS

- 000001-07 STANDARD SYMBOLS, ABBREVIATIONS, AND PATTERNS
- 001006 DECIMAL OF AN INCH AND OF A FOOT
- 642006 SHOULDER RUMBLE STRIPS, 8 INCHES
- 701001-02 OFF-ROAD OPERATIONS, 2L, 2W, MORE THAN 15' (4.5 m) AWAY
- 701006-05 OFF-ROAD OPERATIONS, 2L, 2W, 15' (4.5 m) 24" (600 mm) FROM PAVEMENT EDGE
- 701301-04 LANE CLOSURE, 2L, 2W, DAY ONLY, SHORT TIME OPERATIONS
- 701306-04 LANE CLOSURE, 2L, 2W, SLOW MOVING OPERATIONS ONLY, FOR SPEEDS ≥ 45 MPH (resurf)
- 701311-03 LANE CLOSURE, 2L, 2W, MOVING OPERATIONS - DAY ONLY (pavt mrkg)
- 701901-08 TRAFFIC CONTROL DEVICES
- 780001-05 TYPICAL PAVEMENT MARKING
- 781001-04 TYPICAL APPLICATIONS OF RAISED REFLECTIVE PAVEMENT MARKINGS

RATES OF APPLICATION TABLES

THE FOLLOWING RATES OF APPLICATION HAVE BEEN ASSUMED IN CALCULATING PLAN QUANTITIES.

BITUMINOUS MATERIALS (TACK COAT): 0.05 LBS / SQ FT (FOR MILLING)
 0.025 LBS / FT (FOR LIFTS)
 HMA SURFACE MIX C / BINDER (112 LBS): 0.056 TON / SQ YD * in
 AGGREGATE MATERIALS: 1.60 TONS / CU YD

COMMITMENTS

(NONE)

**STATE OF ILLINOIS
 DEPARTMENT OF TRANSPORTATION
 DIVISION OF HIGHWAYS
 DISTRICT 6**

EXAMINED May 6 2020

[Signature]
ENGINEER OF OPERATIONS

EXAMINED April 23 2020

[Signature]
ENGINEER OF PROJECT IMPLEMENTATION

EXAMINED April 22 2020

[Signature]
ENGINEER OF PROGRAM DEVELOPMENT

MODEL: Default
 FILE: h:\mhc\p\pub\haronom.dwg
 PROJECT: 0672181\CAD\DATA\CAD\sheet\0672181-2-htr-nom.dgn

USER NAME = cabrerars	DESIGNED - RSC	REVISED -
	DRAWN - RSC	REVISED -
PLOT SCALE = 40.0000 ' / in.	CHECKED -	REVISED -
PLOT DATE = 5/1/2020	DATE -	REVISED -

**STATE OF ILLINOIS
 DEPARTMENT OF TRANSPORTATION**

**INDEX OF SHEETS &
 GENERAL NOTES**

SCALE: NTS SHEET 1 OF 1 SHEETS STA. TO STA.

F.A.P. RTE.	SECTION	COUNTY	TOTAL SHEETS	SHEET NO.
315	(116) RS-7	MASON	8	2
CONTRACT NO. 72L81				
ILLINOIS FED. AID PROJECT				

6-01423-0000
 80% FEDERAL
 20% STATE
 ROADWAY
 0005
 RURAL

CODE NO.	ITEM	UNIT	TOTAL QUANTITY	
40600290	BITUMINOUS MATERIALS (TACK COAT)	POUND	1,964	1,964
40600990	TEMPORARY RAMP	SQ YD	351	351
40603080	HOT-MIX ASPHALT BINDER COURSE, IL-19.0, N50	TON	253	253
40604050	HOT-MIX ASPHALT SURFACE COURSE, IL-9.5, MIX "C", N50	TON	168	168
44000155	HOT-MIX ASPHALT SURFACE REMOVAL, 1 1/2"	SQ YD	1,362	1,362
44000164	HOT-MIX ASPHALT SURFACE REMOVAL, 3 3/4"	SQ YD	2,002	2,002
48102100	AGGREGATE WEDGE SHOULDER, TYPE B	TON	45	45
48203100	HOT-MIX ASPHALT SHOULDERS	TON	115	115
64200108	SHOULDER RUMBLE STRIPS, 8 INCH	FOOT	1,502	1,502
67100100	MOBILIZATION	L SUM	1	1
70100460	TRAFFIC CONTROL AND PROTECTION, STANDARD 701306	L SUM	1	1
70300100	SHORT TERM PAVEMENT MARKING	FOOT	338	338
70300150	SHORT TERM PAVEMENT MARKING REMOVAL	SQ FT	44	44
* 78001120	PAINT PAVEMENT MARKING - LINE 5"	FOOT	3,085	3,085

* SPECIALTY ITEM

MODEL: Default
 FILE: Model_C:\pub\harcourt\dot\illinois\poc\p\WIDOT\Documents\DOT_Offices\Dir\dot_6\Projects\0672181\CADD\Drawings\CAD\Sheets\0672181_rht-500.dgn

USER NAME = cabrerars	DESIGNED - RSC	REVISED -
	DRAWN - RSC	REVISED -
PLOT SCALE = 100.0000 ' / in.	CHECKED -	REVISED -
PLOT DATE = 5/1/2020	DATE -	REVISED -

STATE OF ILLINOIS
 DEPARTMENT OF TRANSPORTATION

SUMMARY OF QUANTITIES

SCALE: NTS SHEET 1 OF 2 SHEETS STA. TO STA.

F.A.P. RTE.	SECTION	COUNTY	TOTAL SHEETS	SHEET NO.
315	(116) RS-7	LOGAN	8	3
CONTRACT NO. 72L81				
ILLINOIS FED. AID PROJECT				

MODEL: Default
 FILE NAME: P:\uplanroom.dat\illinois.gov\PIWIDOT\Documents\DOT Offices\District 8\Projects\0672181\CADD\Drawn\CAD\Sheets\0672181-sht-500.dgn

CODE NO.	ITEM	UNIT	TOTAL QUANTITY	6-01423-0000
				80% FEDERAL
				20% STATE ROADWAY
				0005 RURAL
* 78003100	PREFORMED PLASTIC PAVEMENT MARKING, TYPE B - INLAID - LETTERS AND SYMBOLS	SQ FT	123	123
* 78003180	PREFORMED PLASTIC PAVEMENT MARKING, TYPE B - INLAID - LINE 24"	FOOT	72	72
* 78100100	RAISED REFLECTIVE PAVEMENT MARKER	EACH	13	13
78300200	RAISED REFLECTIVE PAVEMENT MARKER REMOVAL	EACH	13	13
X0327980	PAVEMENT MARKING REMOVAL - WATER BLASTING	SQ FT	421	421
Z0048665	RAILROAD PROTECTIVE LIABILITY INSURANCE	L SUM	1	1

* SPECIALTY ITEM

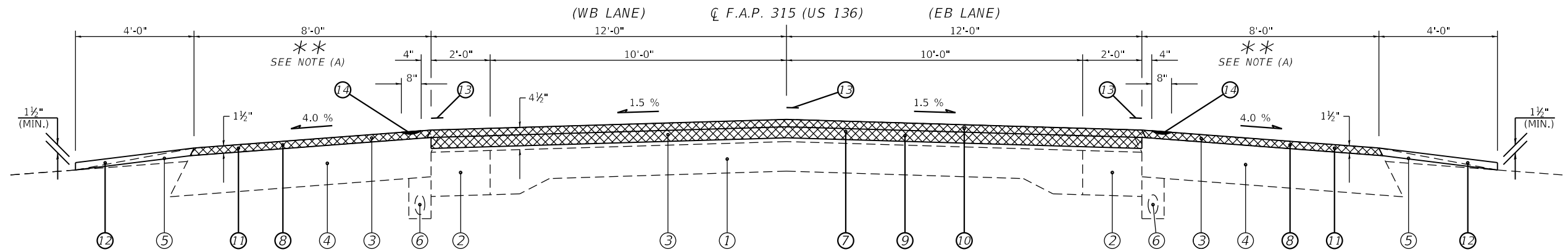

(1) STA 308+98.00 TO STA 312+69.20 [371.20']
 (2) STA 312+80.90 TO STA 313+35.40 [54.50']

RAILROAD OMISSION:
 STA 312+69.20 TO 312+80.90

BRIDGE OMISSION:
 SN: 054-0025
 STA 313+35.40 TO 315+65.10

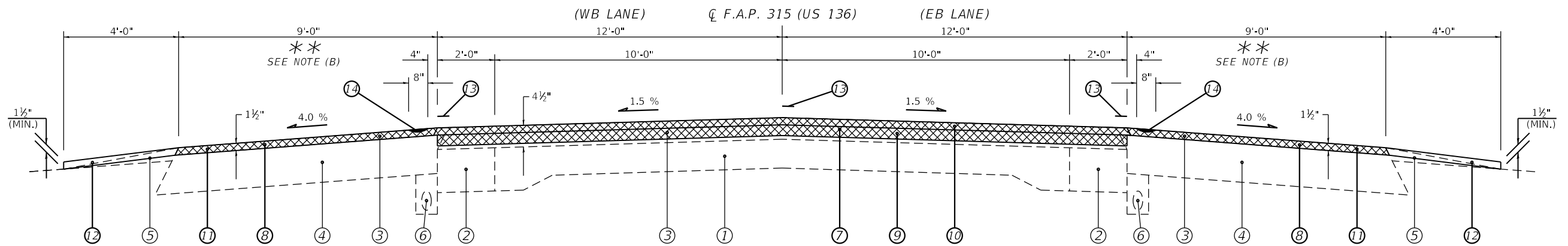

(3) STA 315+65.10 TO STA 318+90.00 [324.90']

LEGEND	
① EXIST. PCC PAVEMENT, 9'-6"-9"	⑦ PROP. HOT-MIX ASPHALT SURFACE REMOVAL, 3 3/4"
② EXIST. BITUMINOUS BASE COURSE WIDENING, 9"	⑧ PROP. HOT-MIX ASPHALT SURFACE REMOVAL, 1 1/2"
③ EXIST. BITUMINOUS OVERLAY	⑨ PROP. HOT-MIX ASPHALT BINDER COURSE, IL-19.0, N50 2 1/4"
④ EXIST. BITUMINOUS SHOULDER, 8"	⑩ PROP. HOT-MIX ASPHALT SURFACE COURSE, IL-9.5, MIX "C", N50 1 1/2"
⑤ EXIST. AGGREGATE SHOULDER	⑪ PROP. HOT-MIX ASPHALT SHOULDER, 1 1/2"
⑥ EXIST. PIPE UNDERDRAIN	⑫ PROP. AGGREGATE WEDGE SHOULDER, TYPE B
	⑬ PROP. PAINT PAVEMENT MARKING - LINE 5"
	⑭ PROP. SHOULDER RUMBLE STRIP, 8"

**** NOTES:**

- (A) WIDTH VAR. FR. 4'-0" TO 8'-0" FR. STA 308+98.00 TO 309+50.00.
 (B) WIDTH VAR. FR. 9'-0" TO 4'-0" LT AND 9'-0" TO 6'-0" RT FR. STA 318+40.00 TO 318+90.00.

MODEL: Default
 FILE: \\nas101.pswp.ibm.com\data\illinois.gov\PIUIDOT\Documents\DOT_Offices\District_6\Projects\0672181\CADD\data\CAD\sheets\0672181_rht\typical.dgn

USER NAME = cabrerars	DESIGNED - RSC	REVISED -
	DRAWN - RSC	REVISED -
PLOT SCALE = 100.0002 ft / in.	CHECKED -	REVISED -
PLOT DATE = 5/1/2020	DATE -	REVISED -

**STATE OF ILLINOIS
 DEPARTMENT OF TRANSPORTATION**

TYPICAL SECTIONS

SCALE: NTS SHEET 1 OF 1 SHEETS STA. 308+98.00 TO STA. 318+90.00

F.A.P. RTE.	SECTION	COUNTY	TOTAL SHEETS	SHEET NO.
315	(116) RS-7	LOGAN	8	6
CONTRACT NO. 72L81				
ILLINOIS FED. AID PROJECT				

AG INC.

RR OMISSION:
STA 312+69.20
TO 312+80.90

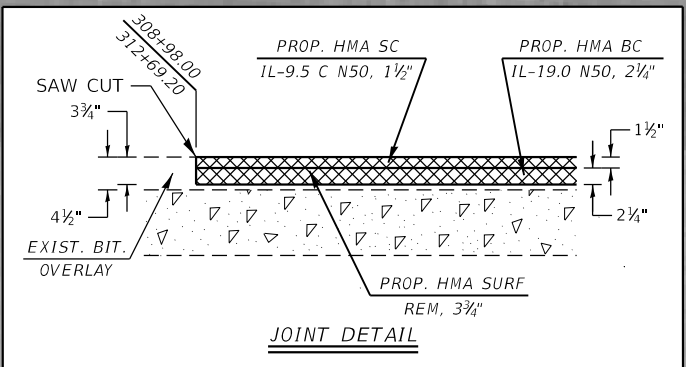
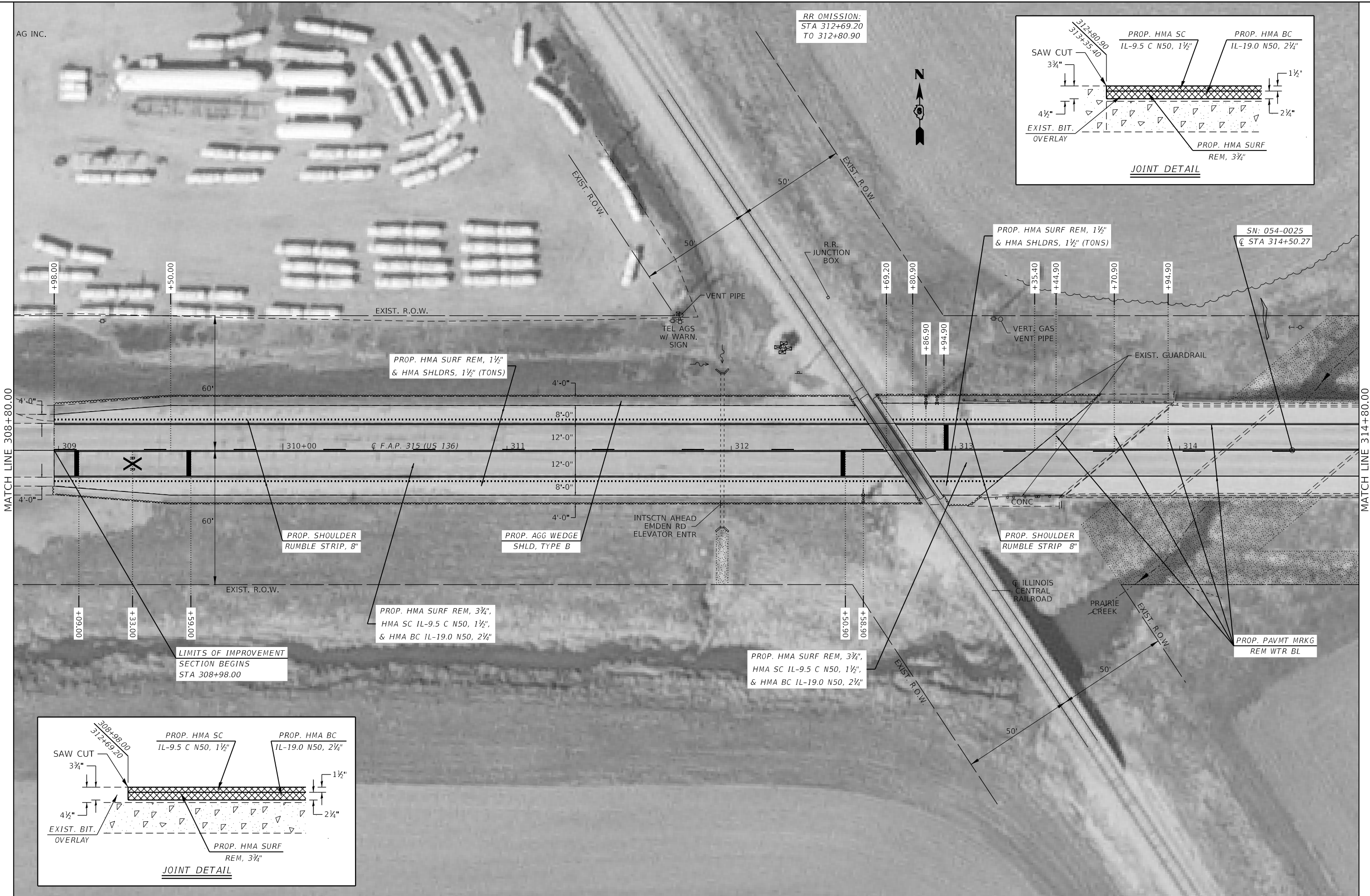
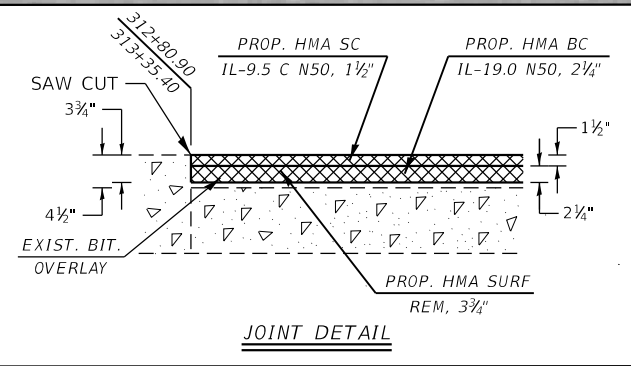

MODEL: Default
FILE: h:\a\c\p\pub\barcom\da\illinois\p\p\WIDOT\Documents\DOT Offices\Dir\ct 6\Projects\0672181\ICADD\DATA\CAD\sheet\0672181-rb-pln.dgn

USER NAME = cabrerars	DESIGNED - RSC	REVISED -
	DRAWN - RSC	REVISED -
PLOT SCALE = 40.0000' / in.	CHECKED -	REVISED -
PLOT DATE = 5/1/2020	DATE -	REVISED -

STATE OF ILLINOIS
DEPARTMENT OF TRANSPORTATION

PLAN SHEETS

SCALE: 20 SHEET 1 OF 2 SHEETS STA. 308+80.00 TO STA. 314+80.00

F.A.P. RTE.	SECTION	COUNTY	TOTAL SHEETS	SHEET NO.
315	(116) RS-7	LOGAN	8	7
CONTRACT NO. 72L81				
ILLINOIS FED. AID PROJECT				

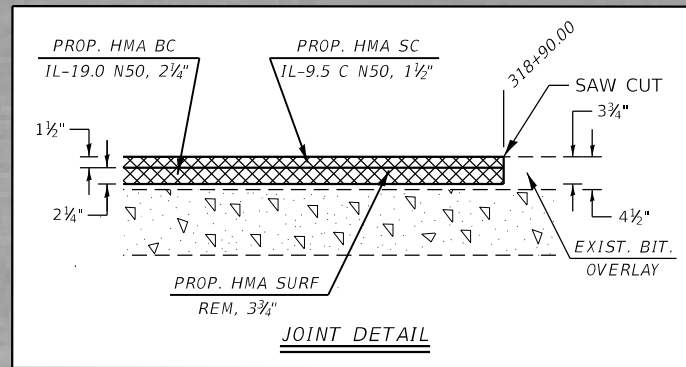
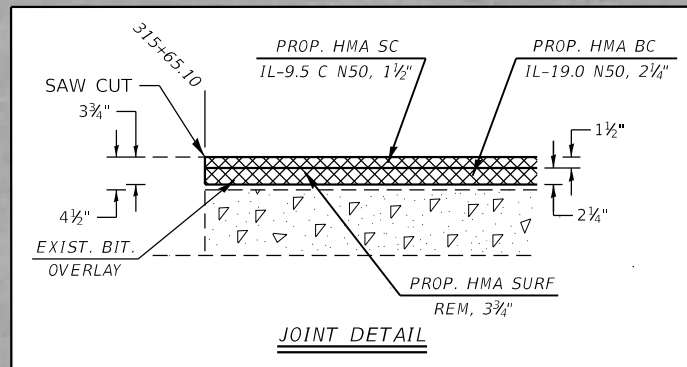
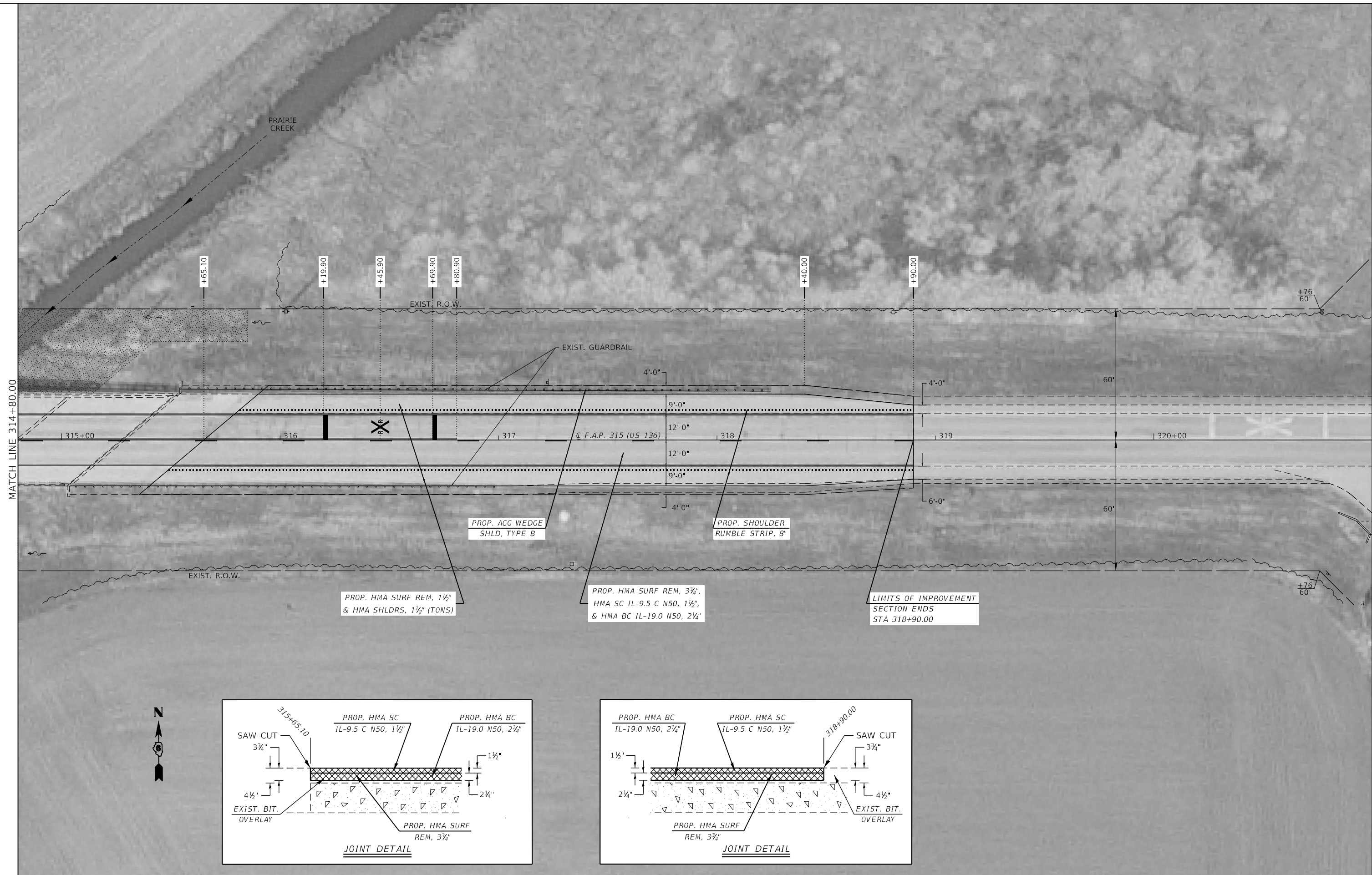

USER NAME = cabrerars	DESIGNED - RSC	REVISED -
	DRAWN - RSC	REVISED -
PLOT SCALE = 40,0000 ' / in.	CHECKED -	REVISED -
PLOT DATE = 5/3/2020	DATE -	REVISED -

**STATE OF ILLINOIS
DEPARTMENT OF TRANSPORTATION**

PLAN SHEETS

SCALE: 20 SHEET 2 OF 2 SHEETS STA. 314+80.00 TO STA. 321+00.00

F.A.P. RTE.	SECTION	COUNTY	TOTAL SHEETS	SHEET NO.
315	(116) RS-7	LOGAN	8	8
CONTRACT NO. 72L81				
ILLINOIS FED. AID PROJECT				

MODEL: Default
 FILE: \\nrcs-pub\pubroom\dat\illinois\pwr\DOT\Documents\DOT_Offices\Illin\CA\00Data\CAD\Sheets\0672181-rhe\plan.dgn