

# SUMMARY OF QUANTITIES - CONT

COUNTY:	WILLIAMSON
ROUTE:	I-57
FUNDING:	90% FEDERAL 10% STATE
LOCATION:	URBAN
TOTAL QUANTITY	ROADWAY
	0005

CODE NUMBER	ITEM DESCRIPTION	UNIT	TOTAL QUANTITY	
X0100020	EARTH EXCAVATION (UNSUITABLE MATERIAL)	CU YD	3,474	3,474
21001000	GEOTECHNICAL FABRIC FOR GROUND STABILIZATION	SQ YD	333	333
X0325110	BIAXIAL GEOGRID	SQ YD	333	333
X0327979	PAVEMENT MARKING REMOVAL - GRINDING	SQ FT	48,413	48,413
X7010216	TRAFFIC CONTROL AND PROTECTION, (SPECIAL)	L SUM	1	1
* X7030078	GROOVING FOR RECESSED PAVEMENT MARKING 13"	FOOT	260	260
* X7830060	GROOVING FOR RECESSED PAVEMENT MARKING, LETTERS AND SYMBOLS	SQ FT	49	49
* X7830074	GROOVING FOR RECESSED PAVEMENT MARKING 7"	FOOT	90,312	90,312
* X7830076	GROOVING FOR RECESSED PAVEMENT MARKING 9"	FOOT	4,051	4,051
* X7830090	GROOVING FOR RECESSED PAVEMENT MARKING 25"	FOOT	114	114
Z0001800	APPROACH SLAB REPAIR (PARTIAL DEPTH)	SQ YD	5	5
Z0034105	MATERIAL TRANSFER DEVICE	TON	23,019	23,019
∅ Z0076600	TRAINEES	HR	500	500
* Z0054400	ROCK FILL	CU YD	3,474	3,474
∅ Z0076604	TRAINEES TRAINING PROGRAM GRADUATE	HR	500	500



\* SPECIALTY ITEM  
∅ 0042

△ REV. 7-17-2020  
REV. - MS

MODEL: Default  
FILE: \\p101planroom.ctb: \\p101planroom.ctb  
PROJECT: 157 Williamson Co. Resurface CAD Data\CAD sheets\0578787\_Sheets.dgn  
PLOT DATE: 5/15/2020

USER NAME = bbrandonja	DESIGNED -	REVISED -
	DRAWN -	REVISED -
PLOT SCALE = 100.0000' / in.	CHECKED -	REVISED -
PLOT DATE = 5/15/2020	DATE -	REVISED -

STATE OF ILLINOIS  
DEPARTMENT OF TRANSPORTATION

SUMMARY OF QUANTITIES

F.A.I. RTE.	SECTION	COUNTY	TOTAL SHEETS	SHEET NO.
57	*	WILLIAMSON	51	9
CONTRACT NO. 78787				

SCALE: SHEET OF SHEETS STA. TO STA.

(ILLINOIS) FED. AID PROJECT  
\*(X1-6,X1-6-3,X1-5,X1-4-1,X1-4)RS-4

# NORTHBOUND SPECIAL PATCH #1

TRAFFIC CONTROL FOR PEAK HOURS

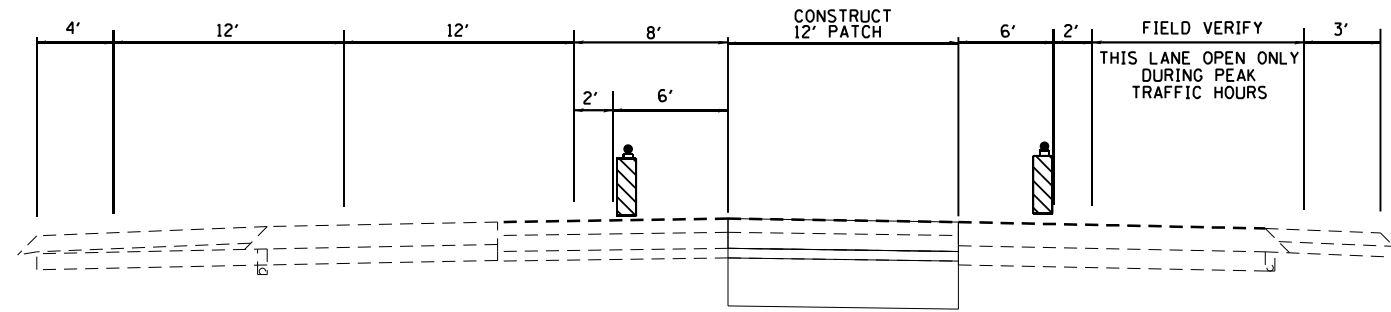

VIEW A-A

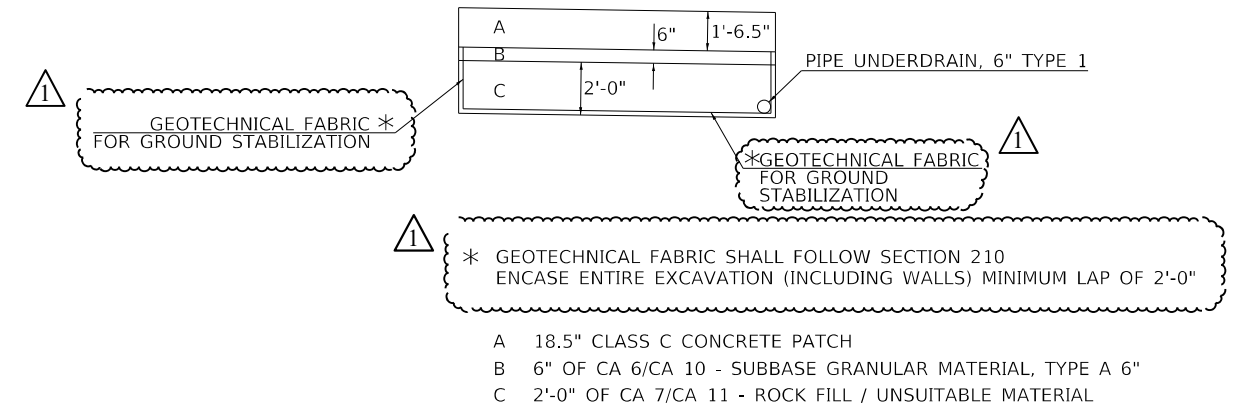

VIEW B-B

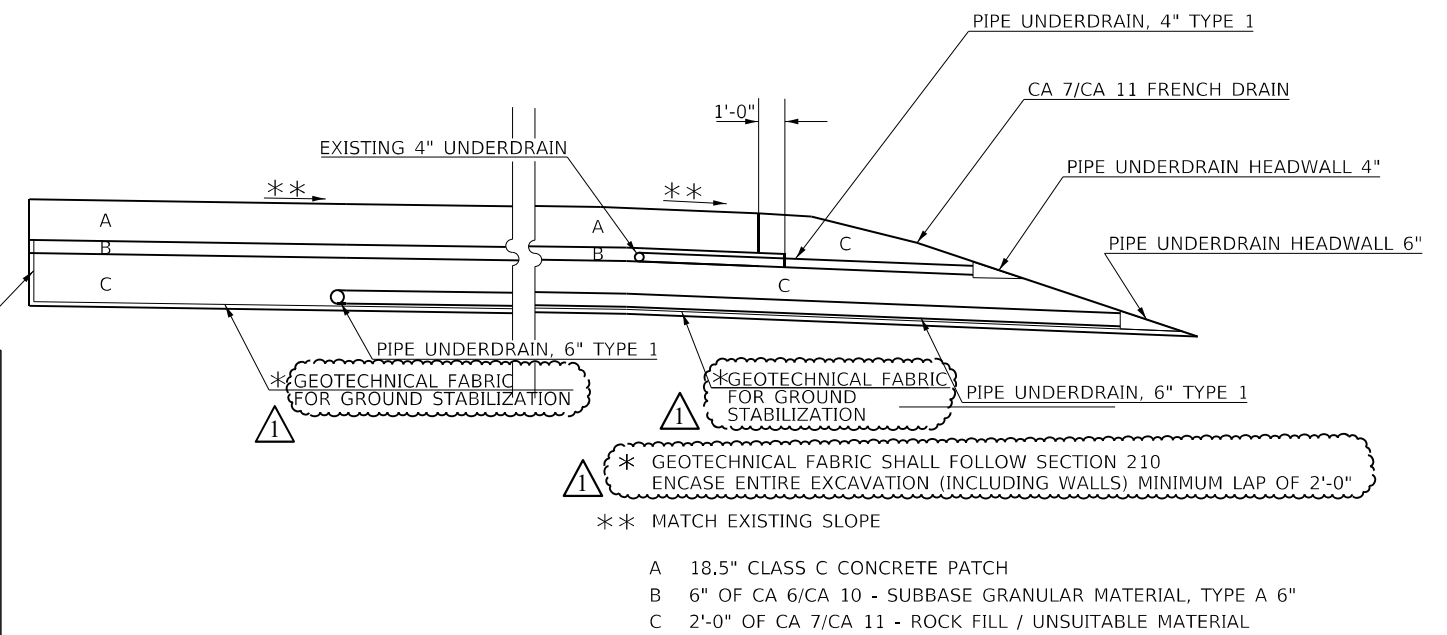

**NOTE:**  
A FRENCH DRAIN SHALL BE CONSTRUCTED BY ENCASING THE ENTIRE TRENCH WITH GEOTECHNICAL FABRIC AND BACKFILLING AS SHOWN IN THE DETAILS ABOVE. THE PIPE UNDERDRAINS AND BACKFILL SHALL DAYLIGHT AT THE OUTSIDE FORESLOPE. THE PIPE UNDERDRAINS SHALL BE PLACED AT AN ELEVATION TO PROVIDE DRAINAGE TO THE OUTSIDE FORESLOPE. THE CLASS C PATCH SHALL INCLUDE WELDED WIRE REINFORCEMENT AND DOWEL BARS 1 1/2" AND SHALL BE POURED MONOLITHICALLY.

ELEVATION VIEW

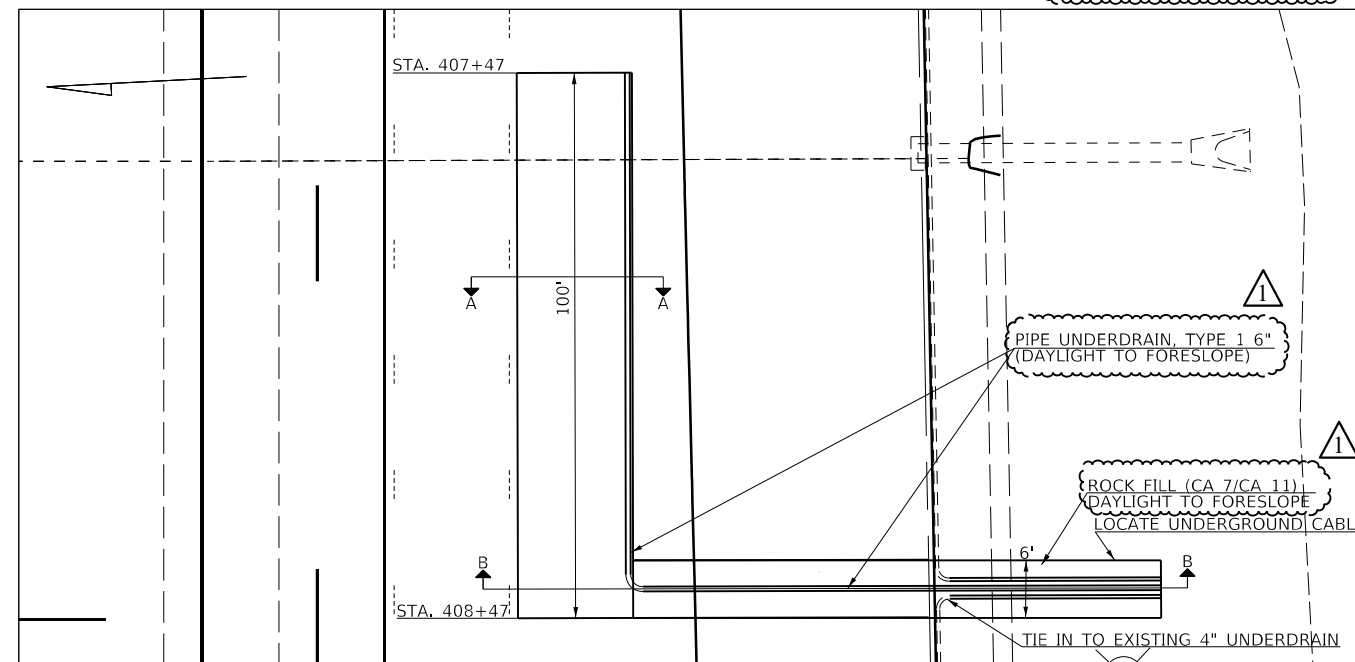

△ REV. 7-17-2020

MODEL: Default  
 FILE: I:\MSD\Projects\RD\DOT\Documents\DOT Office\District 9\Projects\57 Williamson Co. Resurfacing\CAD\Drawings\0978787\_Sheets.dgn

USER NAME = rollavr	DESIGNED - _____	REVISED - _____
DRAWN - _____	REVISIONS - _____	REVISIONS - _____
PLOT SCALE = 100.0000' / in.	CHECKED - _____	REVISIONS - _____
PLOT DATE = 7/15/2020	DATE - _____	REVISIONS - _____

**STATE OF ILLINOIS  
DEPARTMENT OF TRANSPORTATION**

<b>NORTHBOUND SPECIALTY PATCH DETAIL</b>	
SCALE: _____	SHEET _____ OF _____ SHEETS
STA. _____	TO STA. _____

F.A.L. RTE. = 57	SECTION = *	COUNTY = WILLIAMSON	TOTAL SHEETS = 51	SHEET NO. = 49
CONTRACT NO. 78787				
ILLINOIS FED. AID PROJECT				

\*(X1-6,X1-6-3,X1-5,X1-4-1,X1-4)RS-4

# NORTHBOUND SPECIAL PATCH #2

TRAFFIC CONTROL FOR PEAK HOURS

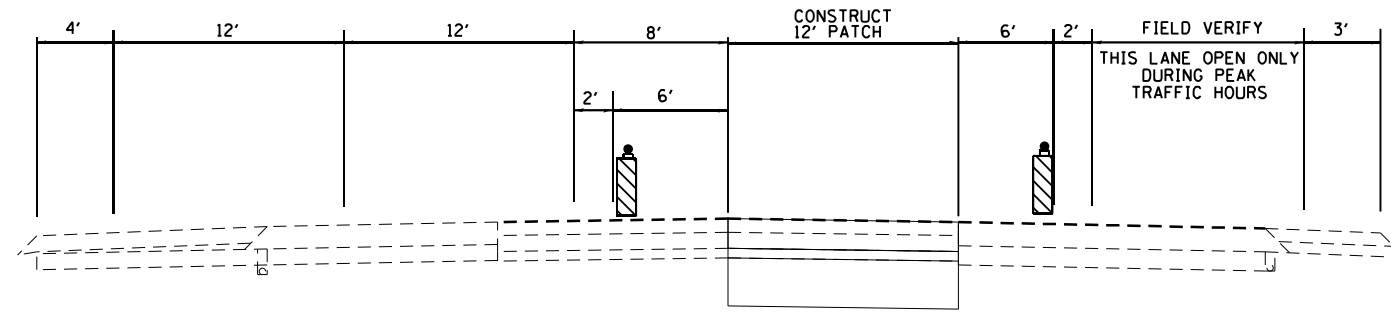

VIEW A-A

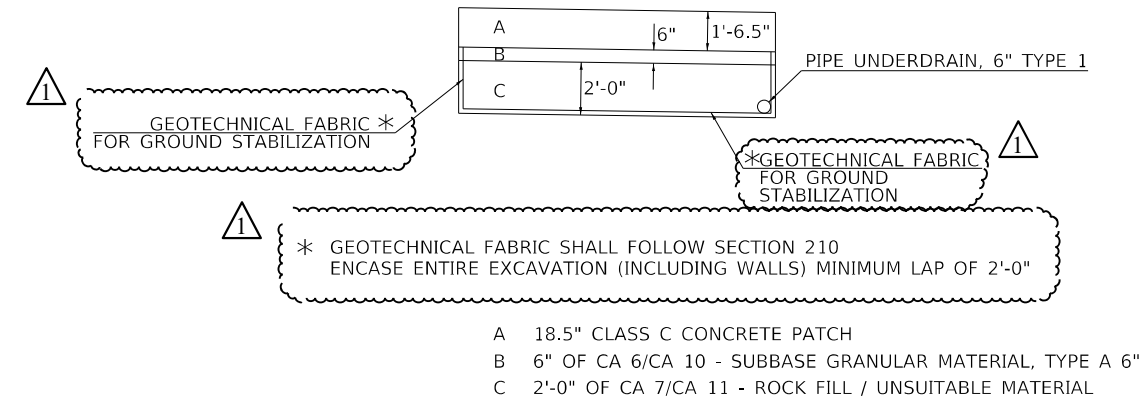

VIEW B-B

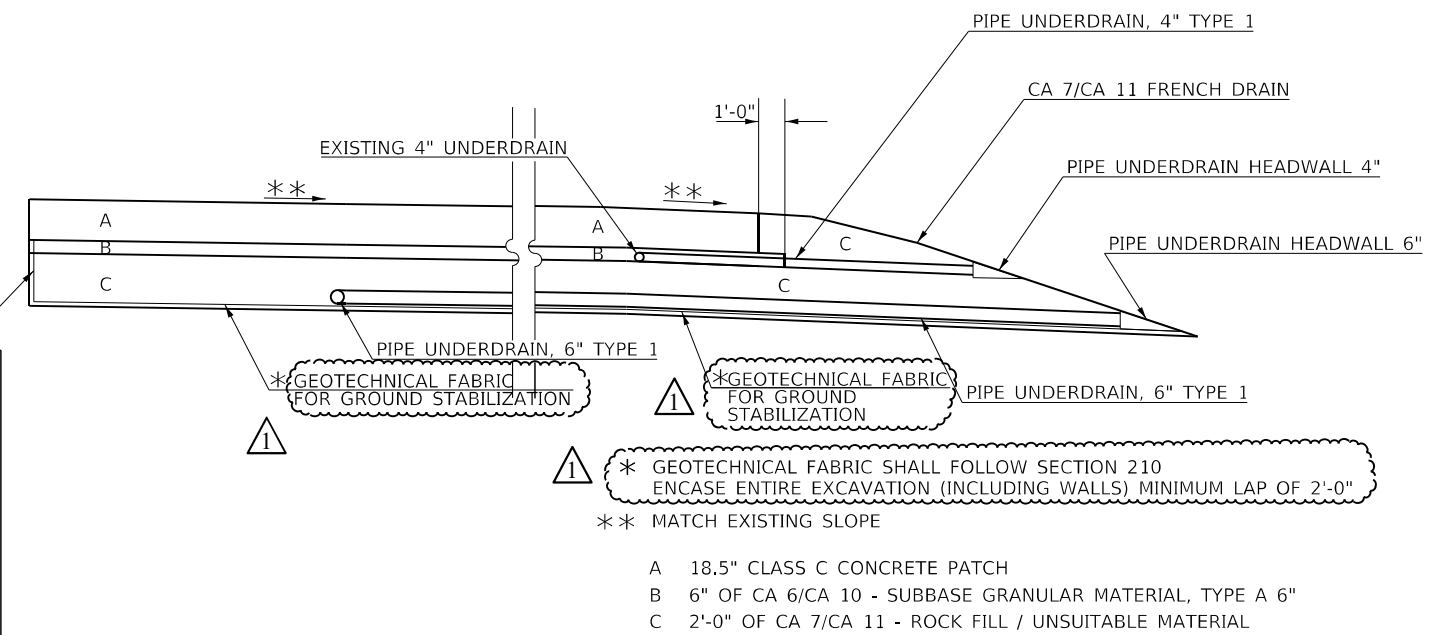

ELEVATION VIEW

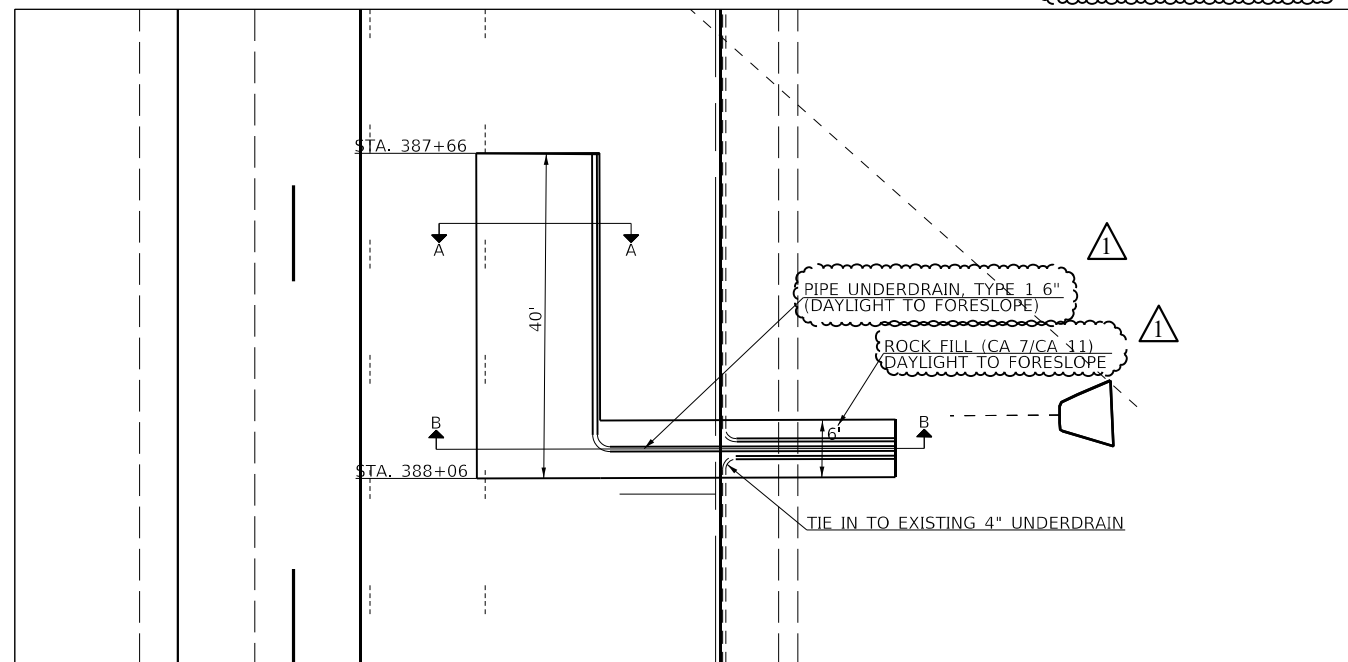

**NOTE:**  
A FRENCH DRAIN SHALL BE CONSTRUCTED BY ENCASING THE ENTIRE TRENCH WITH GEOTECHNICAL FABRIC AND BACKFILLING AS SHOWN IN THE DETAILS ABOVE. THE PIPE UNDERDRAINS AND BACKFILL SHALL DAYLIGHT AT THE OUTSIDE FORESLOPE. THE PIPE UNDERDRAINS SHALL BE PLACED AT AN ELEVATION TO PROVIDE DRAINAGE TO THE OUTSIDE FORESLOPE. THE CLASS C PATCH SHALL INCLUDE WELDED WIRE REINFORCEMENT AND DOWEL BARS 1 1/2" AND SHALL BE POURED MONOLITHICALLY.

REV. 7-17-2020

MODEL: Default  
 FILE: I:\MSA\Projects\2020\Northbound\Northbound\DOT\Office\Drawings\9\Projects\157\Williamson Co. Resurfacing\CADD\Drawings\9\78787\Sheet57.dgn

USER NAME = rollavr	DESIGNED - _____	REVISED - _____
DRAWN - _____	REVISIONS - _____	REVISIONS - _____
PLOT SCALE = 100.0000' / in.	CHECKED - _____	REVISIONS - _____
PLOT DATE = 7/15/2020	DATE - _____	REVISIONS - _____

**STATE OF ILLINOIS  
DEPARTMENT OF TRANSPORTATION**

**NORTHBOUND SPECIALTY PATCH DETAIL**

SCALE: \_\_\_\_\_ SHEET \_\_\_\_\_ OF \_\_\_\_\_ SHEETS STA. \_\_\_\_\_ TO STA. \_\_\_\_\_

F.A.L. RTE.	SECTION	COUNTY	TOTAL SHEETS	SHEET NO.
.57	*	WILLIAMSON	51	50
CONTRACT NO. 78787			ILLINOIS FED. AID PROJECT	

\*(X1-6,X1-6-3,X1-5,X1-4-1,X1-4)RS-4