

F. A. S. NO.	SECTION	COUNTY	SHEET	SHEET NO.
2855	08-00057-00-RS	COOK	11	05
STA. 10+77.25		TO STA. 36+23.96		
FED. ROAD DIST. NO.	BLANKS	FED. RD PROJECT		

CONTRACT #63043

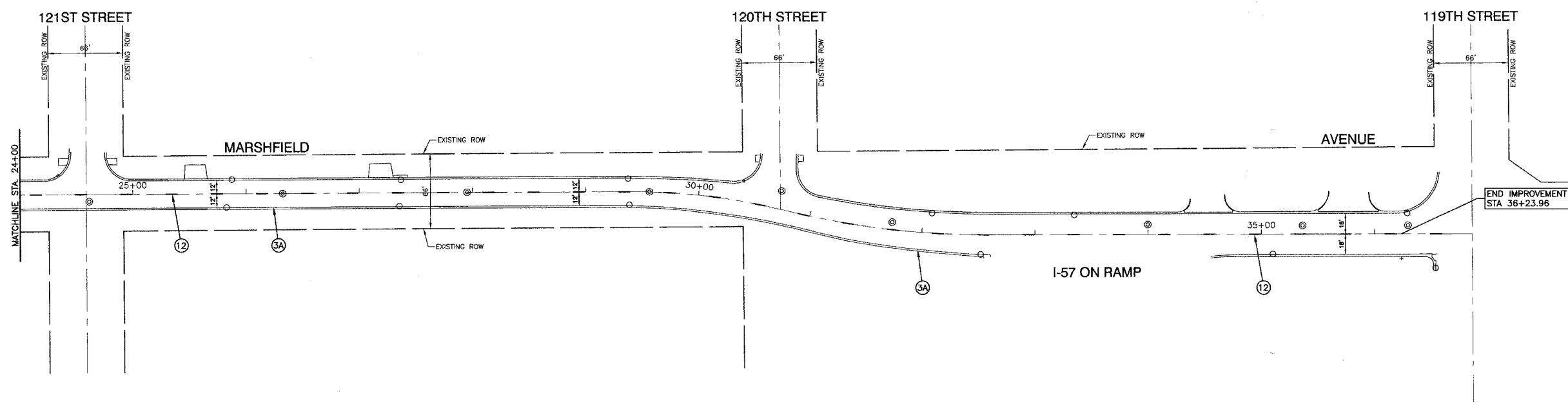
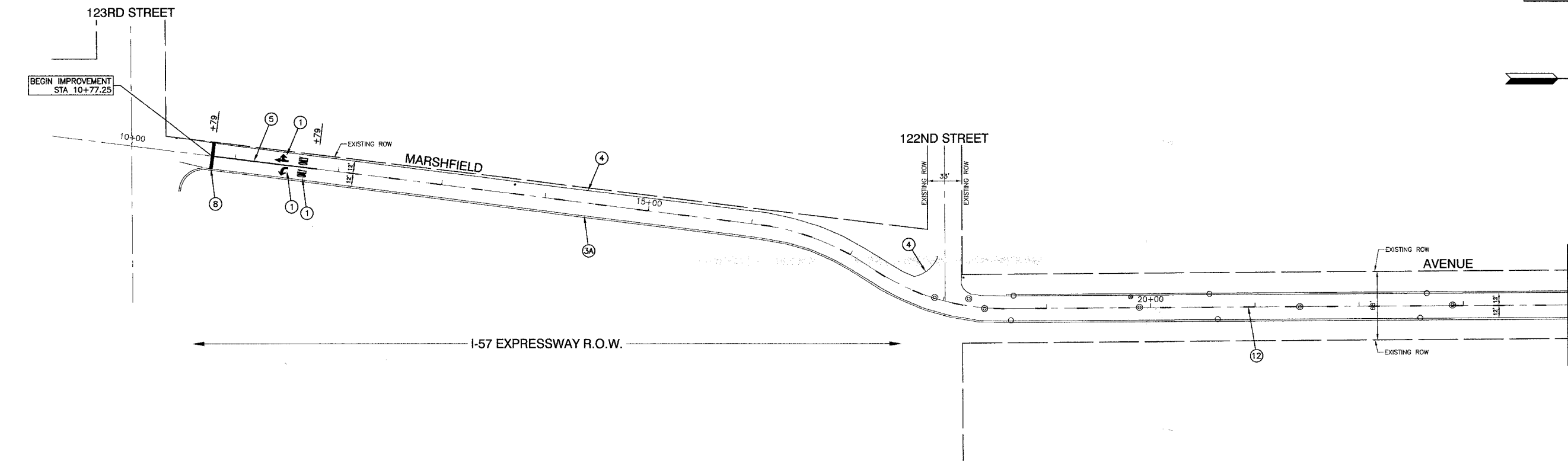

NOTE:
ALL LEGEND ITEMS ARE THERMOPLASTIC
PAVEMENT MARKING OF THE WIDTH AND TYPE SPECIFIED

PAVEMENT MARKING LEGEND

- ① WHITE LETTERS & SYMBOLS
- ② DOUBLE 4" YELLOW CENTERLINE (11" C/C)
- ③ DOUBLE YELLOW MEDIAN OUTLINE (11" C/C)
- ④ 4" YELLOW LINE
- ⑤ 4" WHITE EDGE LINE
- ⑥ 6" WHITE LANE LINE
- ⑦ 6" WHITE SKIP-DASH LINE (2' LINE - 6' SPACE)
- ⑧ 12" YELLOW DIAGONAL LINE (20' C/C)
- ⑨ 24" WHITE STOP BAR
- ⑩ 6" WHITE CROSSWALK (6' C/C)
- ⑪ 6" WHITE CROSSWALK (10' C/C)
- ⑫ 12" WHITE LINE (45° ANGLE, 20' C/C)
- ⑬ 4" WHITE SKIP - DASH LINE (10' LINE - 30' SPACE)
- ⑭ 4" YELLOW SKIP - DASH LINE (10' LINE - 30' SPACE)
- ▲ ONE-WAY AMBER MARKER
40' C/C UNLESS OTHERWISE INDICATED
- ◀ ONE-WAY CRYSTAL MARKER
80' C/C UNLESS OTHERWISE INDICATED
- ◆ TWO-WAY AMBER MARKER
40' C/C UNLESS OTHERWISE INDICATED
- ▼ TRAFFIC SIGN

REVISIONS	
NAME	DATE

ILLINOIS DEPARTMENT OF TRANSPORTATION

**MARSHFIELD AVENUE
STREET RESURFACING
PAVEMENT MARKINGS**

VERT. NA
SCALE: HORIZ. 1"=50'
DATE 05/07/08

DRAWN BY EDG
CHECKED BY RS

ROBINSON ENGINEERING, LTD.
11000 SOUTH PARK AVENUE, SOUTH HOLLAND, ILLINOIS 60476
(708) 381-0700 FAX (708) 381-3829
ILLINOIS DESIGN FIRM REGISTRATION NO. 19401129 07614-PMKG-01 - P01