

PROJECT ENGR.: MAUREEN ADDIS  
(309)671-3454

DESIGNER: STACEY LONG  
(309)671-3477

DESIGNER: STACEY LONG  
(309)671-3477

**STATE OF ILLINOIS  
DEPARTMENT OF TRANSPORTATION  
DIVISION OF HIGHWAYS**

**ROUTE (IL90) FAP 661**

**SECTION 103 RS-3**

**PEORIA COUNTY**

**C-94-081-02**

PROJECT - F-0661(008)

- INDEX OF SHEETS
1. COVER SHEET
  - 2-3. GENERAL NOTES
  - 4-5. SUMMARY OF QUANTITIES
  - 6-8. TYPICAL SECTIONS
  - 9-12. SCHEDULE OF QUANTITIES
  13. SCHEDULE OF RESURFACING QUANTITIES
  - 14-15. RECOVERY TIES
  16. LINE DIAGRAM
  - 17-21. CADD STANDARDS

STANDARDS

442201-03	701201-02
482011-03	701301-02
667101	701306-01
701006-02	701311-02
701011-01	701901
	780001-01

DESIGN DESIGNATION

CLASS II TRUCK ROUTE  
MINOR ARTERIAL (NON-URBAN)

ADT = 1350 (2006)  
MU = 5.9% (2006)  
SU = 6.7% (2006)

CONTRACT NO. 68259  
CATALOG NO. 032562-00D

GROSS LENGTH = 13271 FT. (2.51 MI.)  
NET LENGTH = 13040 FT. (2.47 MI.)

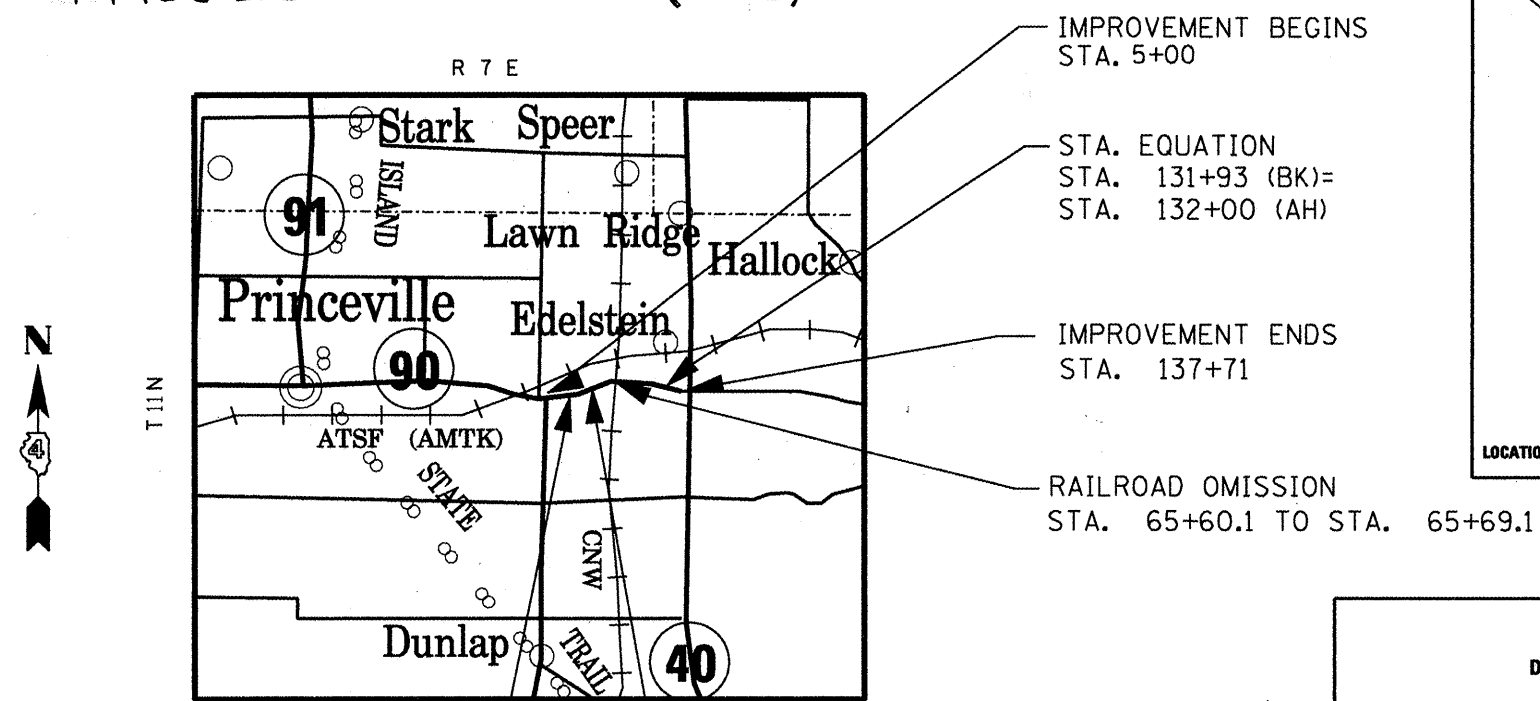
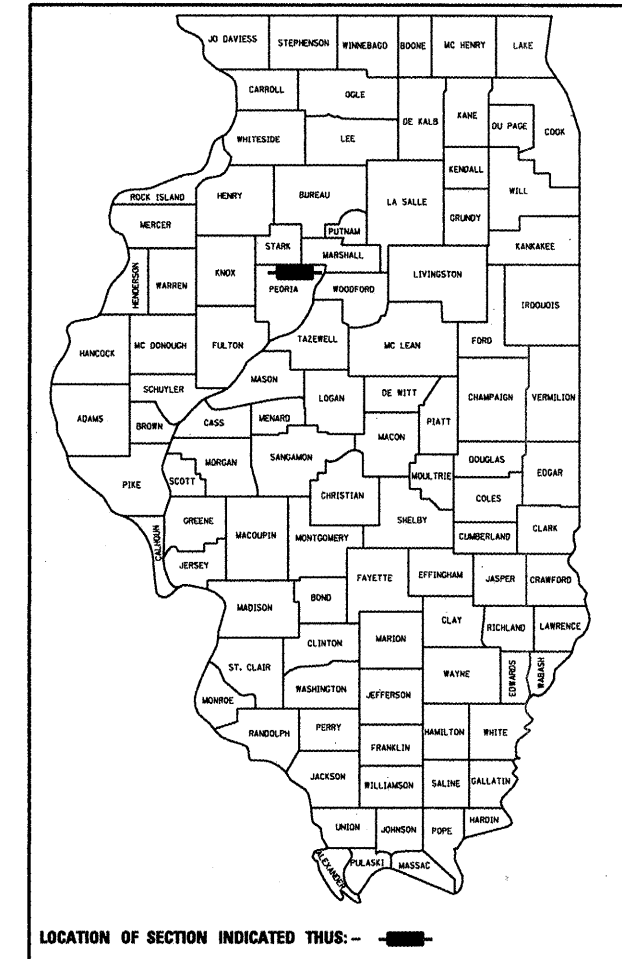

MILL AND RESURFACE ON IL 90 FROM IL 91 (S) TO IL 40  
JUST SOUTH OF EDELSTEIN IN PEORIA COUNTY.

J.U.L.I.E.  
JOINT UTILITY LOCATION INFORMATION FOR EXCAVATION  
1-800-892-0123

STATE OF ILLINOIS  
DEPARTMENT OF TRANSPORTATION  
DIVISION OF HIGHWAYS

SUBMITTED MM 6 20 08

[Signature]  
DEPUTY DIRECTOR OF HIGHWAYS, REGION ENGINEER

June 27, 20 08  
Eric E. Harms  
ENGINEER OF DESIGN AND ENVIRONMENT

June 27, 20 08  
Christine M. Reed  
DIRECTOR OF HIGHWAYS, CHIEF ENGINEER

**PRINTED BY THE AUTHORITY  
OF THE STATE OF ILLINOIS**