

T.R. RTE.	SECTION	COUNTY	TOTAL SHEETS	SHEET NO.
50	05-03104-00-BR	JERSEY	12	1
CONTRACT NO. 97334				
FED. ROAD DIST. NO. - ILLINOIS FED. AID PROJECT				

INDEX OF SHEETS

- 1 - TITLE SHEET
- 2 - SUMMARY OF QUANTITIES, GENERAL NOTES, DETAILS, & TYPICAL SECTIONS
- 3 - PLAN & PROFILE
- 4 - GENERAL PLAN & ELEVATION
- 5 - SUPERSTRUCTURE
- 6 - RAILING
- 7 - SOUTH ABUTMENT
- 8 - NORTH ABUTMENT
- 9 - ABUTMENT DETAILS
- 10 - 12 - CROSS SECTIONS

STANDARDS

- STANDARD 515001-02
- STANDARD 701901
- STANDARD BLR 21-7

LIST OF UTILITIES

- Frontier Communications
225 N. Broad Street
Carlinville, Illinois 62626
1-217-854-4013
- M.J.M. Electric Cooperative, Inc.
P.O. Box 80
Carlinville, Illinois 62626
1-217-854-3137
- Jersey County Rural Water
1009 E. Shipman Road
Jerseyville, Illinois 62052
1-618-498-9534

SCALE IN FEET

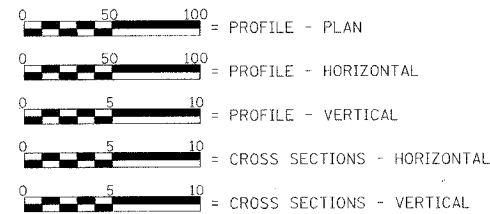

LAND SECTION - 8
 LAND QUARTER SECTION - N.E.
 FUNCTIONAL CLASSIFICATION: LOCAL ROAD (NON-URBAN)
 A.D.T. - 75 (2002)
 A.D.T. - 120 (2021)
 30 M.P.H. DESIGN SPEED

STATE OF ILLINOIS DEPARTMENT OF TRANSPORTATION PLANS FOR PROPOSED HIGHWAY BRIDGE PROGRAM

**PROJECT NO. BROS-0083(041)
 T.R. 50 OVER TRIBUTARY OF PHILS CREEK
 SECTION 05-03104-00-BR
 FIDELITY TOWNSHIP
 JERSEY COUNTY
 JOB NO. C-98-358-06**

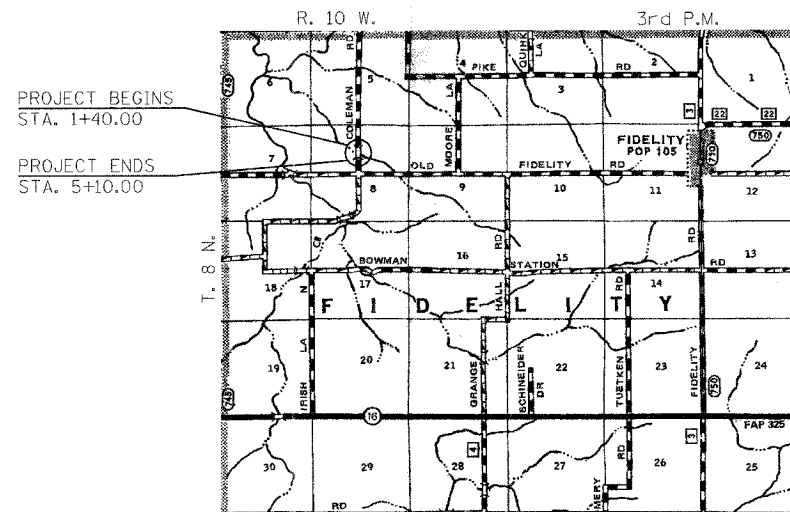
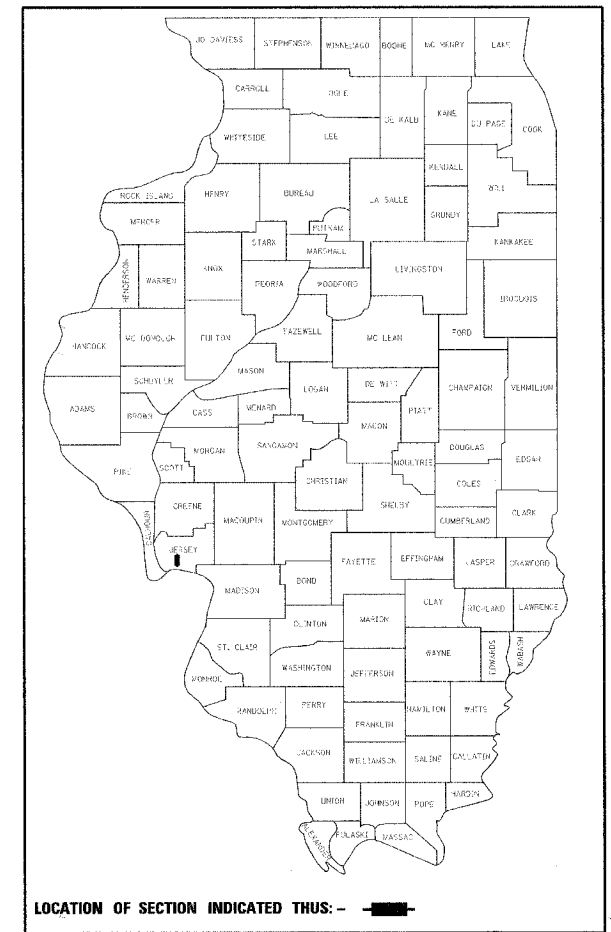

LOCATION PLAN

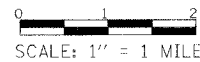

EXISTING STRUCTURE:
 SINGLE SPAN POURED CONCRETE DECK ON STEEL STRINGERS FOUNDED ON CLOSED CONCRETE ABUTMENTS. ±20'-0" OUT.-OUT. DECK, ±20'-6" BK.-BK. ABUTMENTS. STEEL CHANNEL RAIL POSTS WITH NO RAILING. 0° SKEW.
 EXISTING STRUCTURE NO. 042-3049.

PROPOSED STRUCTURE:
 SINGLE SPAN PRECAST PRESTRESSED CONCRETE DECK BEAM (21') BRIDGE ON CLOSED CONCRETE ABUTMENTS. 24'-0" OUT. TO OUT. DECK, 48'-0" BK.-BK. ABUTMENTS. STEEL RAILING TYPE S1. 25° SKEW LT. FORWARD.
 PROPOSED STRUCTURE NO. 042-3144.



Christopher P. Koblun 2/19/08
 EXPIRATION: 11/30/2009

APPROVED: 2/15 2008
Randy Williams
 TOWNSHIP HIGHWAY COMMISSIONER

APPROVED: 2/15 2008
Thomas I. Wanner
 COUNTY ENGINEER

PASSED: 4/9 2008
[Signature]
 DISTRICT EIGHT ENGINEER OF LOCAL ROADS & STREETS

Releasing For Bid Based on Limited Review: 4/9 2008
Wayne [Signature]
 DEPUTY DIRECTOR OF HIGHWAYS, REGION FIVE ENGINEER

STATE OF ILLINOIS
 DEPARTMENT OF TRANSPORTATION

TOLL FREE
 "JOINT UTILITY LOCATION INFORMATION FOR EXCAVATORS"
 (J.U.L.I.E.) TELEPHONE NUMBER
 1-800-892-0123

FILE NAME =	USER NAME = #USER#	DESIGNED -	REVISED -	 Allen Henderson & Associates, Inc. Civil and Structural Engineers Springfield, IL 62703 Phone: (217)544-8033 IL Design Firm No. 184-001907	TITLE SHEET SCALE: 1" = 1 MILE SHEET NO. 1 OF 12 SHEETS STA. 1+40.00 TO STA. 5+10.00	T.R. RTE.	SECTION	COUNTY	TOTAL SHEETS	SHEET NO.	
#FILE#		DRAWN -	REVISED -			50	05-03104-00-BR	JERSEY	12	1	
PLANT SCALE = #SCALE#		CHECKED -	REVISED -			CONTRACT NO. 97334					
PLOT DATE = #DATE#		DATE -	REVISED -			FED. ROAD DIST. NO. - ILLINOIS FED. AID PROJECT					