

75 70 65 60 55 50 45 40 35 30 25 20 15 10 5 0 5 10 15 20 25 30 35 40 45 50 55 60 65 70 75

T.R. RTE.	SECTION	COUNTY	TOTAL SHEETS	SHEET NO.
50	05-03104-00-BR	JERSEY	12	10
FED. ROAD DIST. NO.			ILLINOIS FED. AID PROJECT	
			CONTRACT NO. 97334	

DATE	BY
DATE	BY
DATE	BY
DATE	BY

DATE	BY
DATE	BY
DATE	BY
DATE	BY

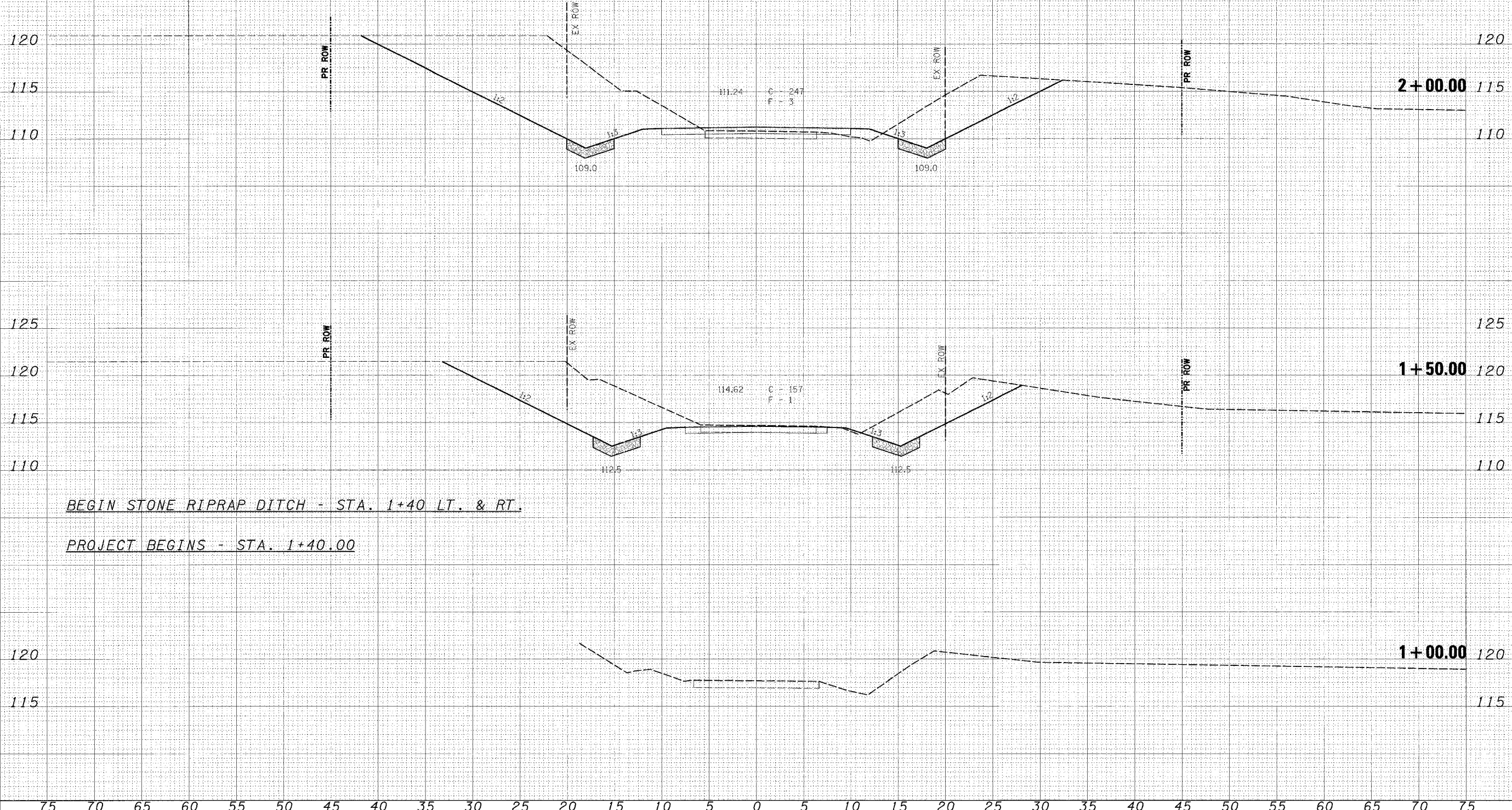

BEGIN STONE RIPRAP DITCH - STA. 1+40 LT. & RT.
 PROJECT BEGINS - STA. 1+40.00

FILE NAME -	USER NAME - #USER#	DESIGNED -	REVISED -	Allen Henderson & Associates, Inc. Civil and Structural Engineers Springfield, IL. 62703 Phone: (217)544-8033 IL. Design Firm No. 184-001907	F.A. RTE.	SECTION	COUNTY	TOTAL SHEETS	SHEET NO.
#FILE#		DRAWN -	REVISED -		50	05-03104-00-BR	JERSEY	12	10
		CHECKED -	REVISED -		CONTRACT NO.				
		DATE -	REVISED -		ILLINOIS FED. AID PROJECT				
					CROSS SECTIONS SCALE: SHEET NO. OF SHEETS STA. 1+00.00 TO STA. 2+00.00				