

11/11/27, 2008 3:13 PM HAGL000382
 I:\PROJECTS\VANDALIA\07AC08B\CAD\SHEETS\12-CON.DWG - DRAINAGE

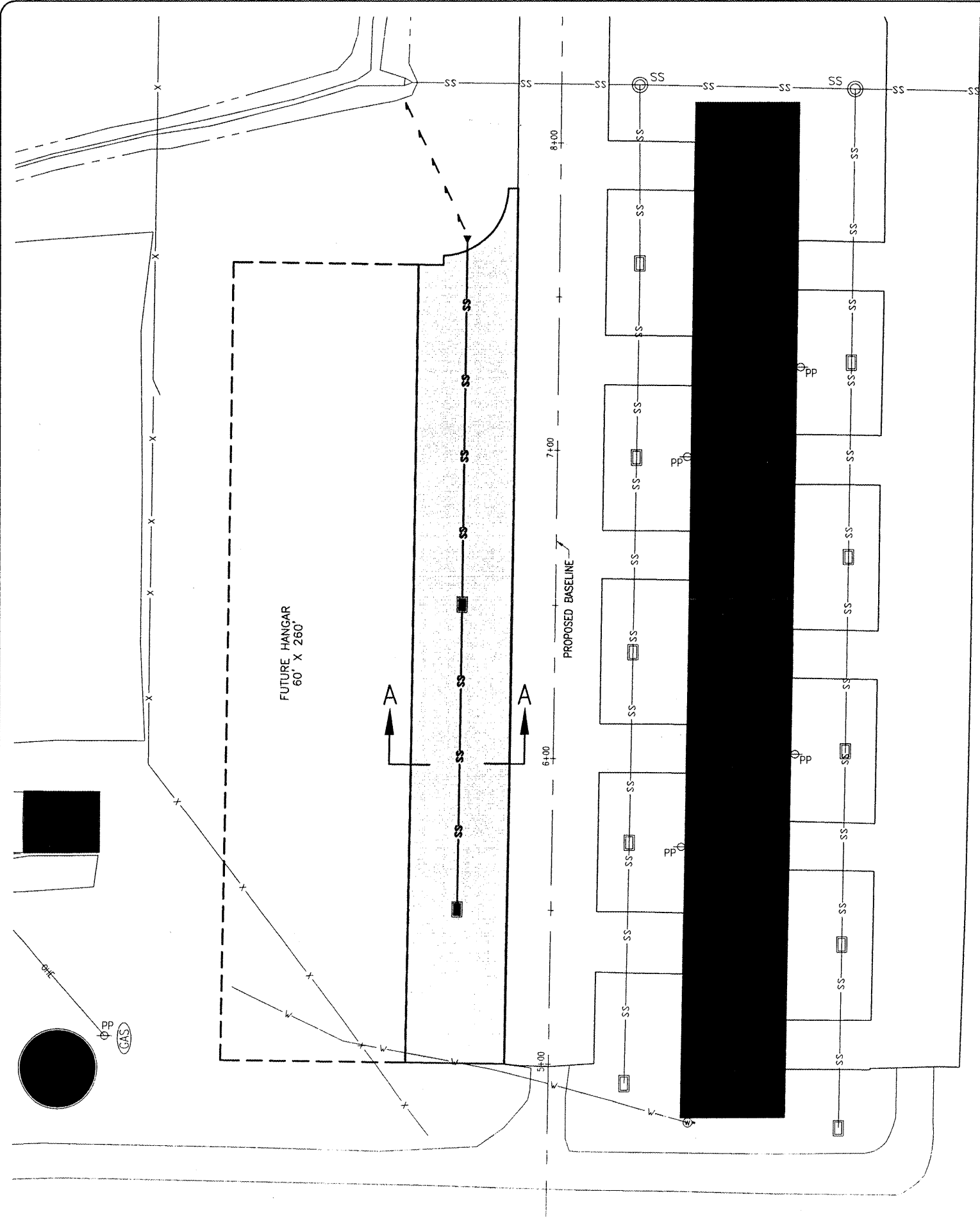

THE LOCATION, SIZE AND TYPE OF MATERIAL OF EXISTING UNDERGROUND UTILITIES INDICATED ON THE PLANS IS NOT REPRESENTED AS BEING ACCURATE, SUFFICIENT OR COMPLETE. IT SHALL BE THE CONTRACTOR'S RESPONSIBILITY TO DETERMINE THE ACTUAL LOCATION OF ALL SUCH FACILITIES, INCLUDING SERVICE CONNECTIONS TO UNDERGROUND UTILITIES. PRIOR TO CONSTRUCTION, THE CONTRACTOR SHALL NOTIFY THE UTILITY COMPANIES OF HIS OPERATIONAL PLANS AND SHALL OBTAIN FROM THE RESPECTIVE UTILITY COMPANIES DETAILED INFORMATION AND ASSISTANCE RELATIVE TO THE LOCATION OF THEIR FACILITIES AND THE WORKING SCHEDULE OF THE COMPANIES FOR REMOVAL OR ADJUSTMENT WHERE REQUIRED. IN THE EVENT AN UNEXPECTED UTILITY INTERFERENCE IS ENCOUNTERED DURING CONSTRUCTION, THE CONTRACTOR SHALL IMMEDIATELY NOTIFY THE UTILITY COMPANY OF JURISDICTION. THE ENGINEER SHALL ALSO BE IMMEDIATELY NOTIFIED. ANY SUCH MAINS AND SERVICES SHALL BE RESTORED TO SERVICE AT ONCE AND PAID FOR BY THE CONTRACTOR AT NO ADDITIONAL COST TO THE CONTRACT.

CALL J.U.L.I.E. FOR UTILITY INFORMATION AT 1-800-892-0123.
PAVEMENT SAWING
 THE WEST EDGE OF THE EXISTING HANGAR ACCESS TAXIWAY WILL BE SAWED FULL DEPTH. THE PROPOSED SAWING WILL REMOVE THE ROLLED DOWN EDGE AND PROVIDE A STRAIGHT PAVEMENT EDGE TO BUTT UP AGAINST.
 THE RESIDENT ENGINEER WILL MARK THE PROPOSED SAW LINE IN THE FIELD A DISTANCE OF 2" BACK FROM EXISTING EDGE OR AS REQUIRED.
 ANY BITUMINOUS PAVEMENT CUT FROM THE EXISTING HANGAR ACCESS TAXIWAY WILL BE COLLECTED AND DISPOSED OF OFF THE AIRPORT SITE.

THIS ITEM OF WORK SHALL BE PAID FOR UNDER ITEM:
 AR401655 "BITUMINOUS PAVEMENT SAWING" ___ PER L.F.

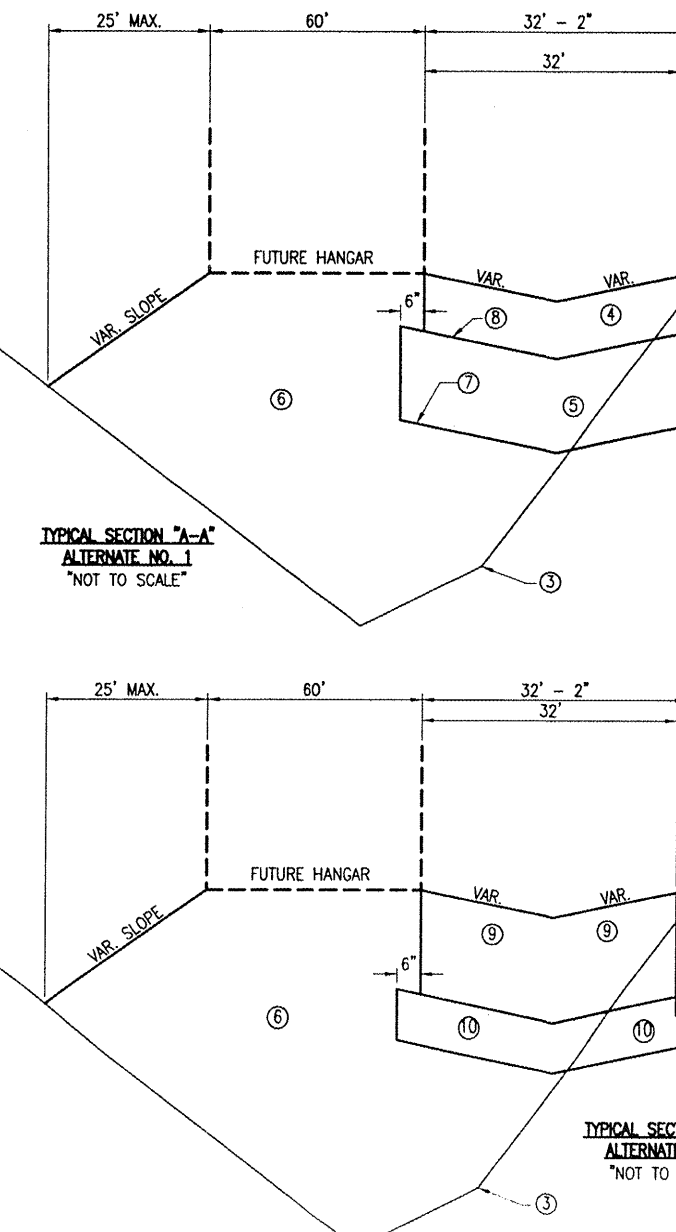

- LEGEND**
- [] EXISTING PAVEMENT
 - [] PROPOSED PAVEMENT
 - [] EXISTING BUILDING
 - [] FUTURE BUILDING
 - SS— EXISTING STORM SEWER
 - SS— PROPOSED STORM SEWER
 - X- EXISTING FENCE
 - OHE- EXISTING OVERHEAD ELECTRIC LINE
 - W- EXISTING WATER LINE (TO BE RELOCATED)
 - [] EXISTING DRAINAGE DITCH
 - [] PROPOSED DRAINAGE DITCH
 - ⊕ EXISTING WATER SPIGOT
 - [] EXISTING INLET
 - [] PROPOSED INLET
 - ⊙SS EXISTING DROP INLET
 - ▽ EXISTING FLARED END SECTION
 - ▶ PROPOSED SPECIAL STRUCTURE
 - ⊕PP EXISTING POWER POLE
 - (GAS) EXISTING PROPANE TANK

- LEGEND FOR TYPICAL SECTIONS "A-A"**
- ① EXISTING BITUMINOUS SURFACE COURSE (1-1/2" DEPTH)
 - ② EXISTING BITUMINOUS LEVELING COURSE (VAR. DEPTH)
 - ③ EXISTING GRADE
 - ④ PROPOSED BITUMINOUS SURFACE COURSE (4" DEPTH)
 - ⑤ PROPOSED CRUSHED AGGREGATE BASE COURSE (6" DEPTH)
 - ⑥ PROPOSED EARTH FILLETS
 - ⑦ PROPOSED BITUMINOUS PRIME COAT (0.35 GAL./S.Y.)
 - ⑧ PROPOSED BITUMINOUS TACK COAT (0.15 GAL./S.Y.)
 - ⑨ PROPOSED P.C.C. PAVEMENT (6" DEPTH)
 - ⑩ PROPOSED CRUSHED AGGREGATE BASE COURSE (4" DEPTH)

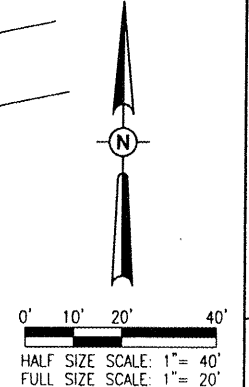

VA018

DATE	BY	REVISION							
VANDALIA MUNICIPAL AIRPORT VANDALIA, ILLINOIS									
ILL. PROJ.: VA-3724 A.I.P. PROJ.: 3-17-0102-B10									
HANSON PROFESSIONAL SERVICES INC. 1525 South State Street Springfield, Illinois 62703-2886 Offices Nationwide									
CONSTRUCT HANGAR ACCESS TAXIWAY PROPOSED CONSTRUCTION PLAN									
4									