

## MAINTENANCE OF TRAFFIC GENERAL NOTES

- ALL OF THE TRAFFIC CONTROL DEVICES SHALL BE IN PLACE BEFORE CONSTRUCTION IS STARTED. THE TRAFFIC CONTROL PLANS SHALL SERVE AS A GUIDE FOR THE SAFE DIVERSION OF TRAFFIC DURING EXECUTION OF THIS CONTRACT.
- A MINIMUM OF TWO LANES, ONE IN EACH DIRECTION, SHALL BE KEPT OPEN TO THROUGH TRAFFIC AT ALL TIMES EXCEPT AS NOTED IN PLANS. ANY LANE CLOSURES MUST BE APPROVED BY THE ENGINEER. THE MINIMUM LANE WIDTHS SHALL BE 11'-0".
- TAPER LENGTH FOR TRAFFIC CONTROL DEVICES IS DEFINED BY:  
 $L = (W) \times (S)$   
 WHERE EQUATION IS FOR SPEED LIMIT OF 45 MPH OR LESS. THE TAPER IS DEFINED AS FOLLOWS:  
 $L =$  TAPER LENGTH IN FEET  
 $W =$  WIDTH OF OFFSET IN FEET  
 $S =$  POSTED SPEED IN MPH.
- THE FOLLOWING TEMPORARY PAVEMENT MARKINGS SHALL BE PROVIDED IN ACCORDANCE WITH SECTION 703 "WORK ZONE PAVEMENT MARKINGS" OF STANDARD SPECIFICATIONS AT ALL THE FOLLOWING LOCATIONS IN EACH OF THE VARIOUS STAGES OF CONSTRUCTION:  
 4 IN WHITE EDGE LINE  
 4 IN DOUBLE YELLOW - BETWEEN OPPOSING LANES
- TEMPORARY RAISED REFLECTIVE PAVEMENT MARKERS SHALL BE PLACED THROUGHOUT THE PROJECT IN ACCORDANCE WITH THE DISTRICT ONE C.A.D.D. DETAIL FOR "RAISED REFLECTIVE PAVEMENT MARKERS" OR AS DIRECTED BY THE ENGINEER.

- TEMPORARY PAVEMENT IS REQUIRED TO MAINTAIN THE REQUIRED TRAFFIC LANES ON US ROUTE 14 AS SHOWN ON THE STAGING PLANS. SEE THE HMA MIXTURES REQUIREMENT TABLE ON SHEET 5 AND THE SPECIAL PROVISIONS FOR THE HMA MATERIALS.
- THE EDGE OF THE EXISTING PAVEMENT SHALL RECEIVE A PARTIAL DEPTH SAW CUT TO PROVIDE A CLEAN EDGE FOR CONSTRUCTION OF THE TEMPORARY PAVEMENT. THE PARTIAL DEPTH SAW CUT SHALL BE PAID FOR AS "SAW CUTTING". SEE SPECIAL PROVISIONS.
- THE REMOVAL OF TEMPORARY PAVEMENT SHALL BE PAID FOR AS "PAVEMENT REMOVAL". A FULL DEPTH PAVEMENT SAW CUT SHALL BE REQUIRED TO SEPARATE THE TEMPORARY PAVEMENT FROM TEMPORARY PAVEMENT THAT SHALL REMAIN IN PLACE. THE SAW CUT SHALL BE PAID FOR AS "SAWING PAVEMENT (FULL DEPTH)". SEE SPECIAL PROVISIONS.
- PORTABLE CHANGEABLE MESSAGE SIGNS SHALL BE PLACED PRIOR TO THE PROJECT AT THE NORTH AND SOUTH ENDS ALONG US ROUTE 14 AS DIRECTED BY THE ENGINEER. THESE SHALL BE PAID FOR AS "CHANGEABLE MESSAGE SIGN" (CAL. MONTH).
- THE CONTRACTOR WILL GIVE AT LEAST 48 HOURS PRIOR NOTICE TO THE RESIDENT ENGINEER PRIOR TO IMPLEMENTING LANE CLOSURES.
- THE NECESSARY TYPE III BARRICADES WILL BE PROVIDED AT THE LOCATIONS SHOWN IN THE PLANS. A MONO-DIRECTIONAL FLASHING AMBER BEACON SHALL BE MOUNTED TO THE FIRST TWO WARNING SIGNS ON EACH APPROACH DURING HOURS OF DARKNESS.
- POSITIVE DRAINAGE WITHIN THE WORK ZONE MUST BE MAINTAINED AT ALL TIMES. WHEN EXISTING DRAINAGE FACILITIES ARE DISTURBED THE CONTRACTOR SHALL PROVIDE AND MAINTAIN TEMPORARY INLETS, OUTLETS, AND CONNECTIONS FOR ALL EXISTING AND PROPOSED FACILITIES INCLUDING TEMPORARY PUMPING IF NECESSARY. TEMPORARY ACCOMMODATIONS SHALL BE MAINTAINED UNTIL SUCH TIME AS THE PERMANENT FACILITIES ARE IN SERVICE. THE COST OF ALL LABOR, EQUIPMENT, AND MATERIALS (TEMPORARY OR PERMANENT USED AS TEMPORARY) TO COMPLY WITH THIS REQUIREMENT WILL NOT BE PAID FOR DIRECTLY, BUT THE COST SHALL BE CONSIDERED INCLUDED IN THE PROPOSED ITEMS OF WORK IN THE CONTRACT.

- ALL TEMPORARY CONCRETE BARRIER WALL AND TEMPORARY IMPACT ATTENUATORS MUST BE SEATED ON BARE, CLEAN PAVEMENT OR PAVED SHOULDER.
- ADVANCE WIDTH RESTRICTION SIGNS, W12-1103, SHALL BE INSTALLED. ONE SIGN SHALL BE INSTALLED APPROXIMATELY 3.5 MILES SOUTH OF THE PROJECT AT THE INTERSECTION OF US ROUTE 14 AND IL ROUTE 173. ONE SIGN SHALL BE INSTALLED NORTH OF THE PROJECT AT THE INTERSECTION OF US ROUTE 14 AND STATE LINE ROAD.

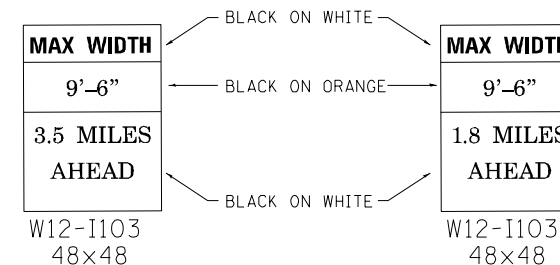

### SUGGESTED CONSTRUCTION STAGING

**PRE-STAGE I**  
 INSTALL SIGNING THAT WILL BE USED DURING STAGED CONSTRUCTION. COVER SIGNS THAT ARE NOT APPLICABLE TO THE PRE-STAGE CONDITION. INSTALL TEMPORARY EROSION CONTROL. CONSTRUCT TEMPORARY PAVEMENT AND DITCHING ADJACENT TO N.B. TRAVEL LANE. REMOVE EXISTING RAISED REFLECTIVE PAVEMENT MARKERS THAT CONFLICT WITH STAGE CONSTRUCTION. UTILIZE STATE STANDARDS 701006, 701011, 701301, 701326 AND 701901 FOR TRAFFIC CONTROL AND PROTECTION.

**STAGE I**  
 ESTABLISH TRAFFIC CONTROL AND PROTECTION IN ACCORDANCE WITH THE SUGGESTED STAGES CONSTRUCTION & TRAFFIC CONTROL PLAN. REMOVE PORTION OF EXISTING BOX CULVERT (SEE STRUCTURAL PLANS). CONSTRUCT PORTION OF NEW BOX CULVERT (SEE STRUCTURAL PLANS). INSTALL TEMPORARY EROSION CONTROL TO BE USED IN STAGE II. CONSTRUCT TEMPORARY PAVEMENT AND TEMPORARY DITCHING TO BE USED IN STAGE II.

**STAGE II**  
 ESTABLISH TRAFFIC CONTROL AND PROTECTION IN ACCORDANCE WITH THE SUGGESTED STAGES CONSTRUCTION & TRAFFIC CONTROL PLAN. REMOVE THE EAST PORTION OF THE OLD BOX CULVERT (SEE STRUCTURAL PLANS). CONSTRUCT EAST PORTION OF BOX CULVERT (SEE STRUCTURAL PLANS). CONSTRUCT N.B. PAVEMENT. PAVEMENT SHALL BE CONSTRUCTED UP TO HMA SURFACE COURSE. THE AREA IMMEDIATELY WEST OF AND ADJACENT TO THE N.B. LANE SHALL BE BACKFILLED SO THE DROP OFF DOES NOT EXCEED 12 INCHES. CONSTRUCT HMA SHOULDERS (INCLUDING HMA SURFACE COURSE AND INSTALL GUARDRAIL ADJACENT TO N.B. LANE. INSTALL PIPE CULVERT AND CONSTRUCT FIELD ENTRANCE AT STATION 98+52.20 (RT). RE-ESTABLISH FINAL DITCHING AND PLANT FINAL SEEDING ALONG EAST SIDE OF US ROUTE 14.

**STAGE III**  
 REMOVE THE TEMPORARY CONCRETE BARRIER THAT IS IMMEDIATELY ADJACENT TO THE STAGE II N.B. TRAVELED LANE. INSTALL DRUMS WITH STEADY BURNING LIGHTS (SEE STRUCTURAL PLANS). THE DRUM SPACING SHALL BE 100' C-C. THE SPACING OF THE DRUMS BETWEEN STA. 99+45 TO 100+45 SHALL BE AT 20' C-C. CONSTRUCT S.B. PAVEMENT UP TO HMA SURFACE COURSE.

**STAGE IV**  
 INSTALL FINAL PAVEMENT MARKINGS AND PLACE S.B. TRAFFIC ON NEWLY CONSTRUCTED S.B. PAVEMENT. INSTALL GUARDRAIL. AFTER GUARDRAIL INSTALLATION IS COMPLETE, REMOVE TEMPORARY CONCRETE BARRIER THAT WAS IMMEDIATELY ADJACENT TO THE STAGE III S.B. TRAVELED LANE. REMOVE PORTION OF TEMPORARY PAVEMENT. RE-ESTABLISH FINAL DITCHING AND PLANT FINAL SEEDING ALONG WEST SIDE OF US ROUTE 14. UTILIZE STATE STANDARDS 701006, 701011, 701301, 701326 AND 701901 FOR TRAFFIC CONTROL AND PROTECTION.

**POST STAGE**  
 INSTALL RAISED REFLECTIVE PAVEMENT MARKERS. REMOVE SIGNING USED DURING STAGED CONSTRUCTION. COMPLETE PUNCH LIST ITEMS.

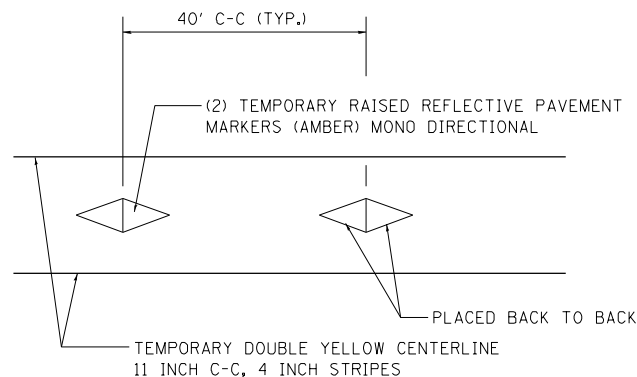
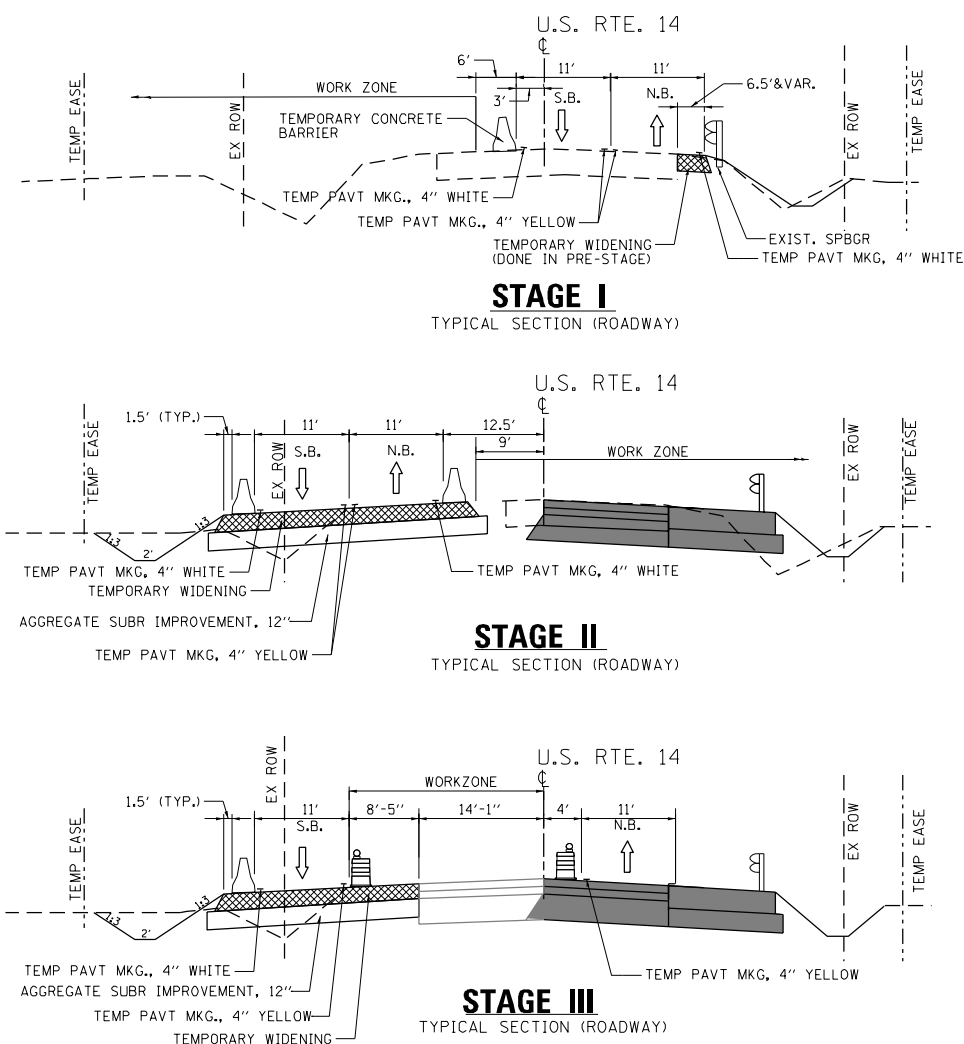

FILE NAME = P:\2011\ME11007\_Ver-Var-Ph1\CADD\W006\_US14\Shets\13-D16\025-sht-STG00\_Notes.dgn  
 PLOT SCALE = 2.0000 / 1" = 100'  
 USER NAME = Millennium Professional Services

2600 Warrenville Road, Suite 203, Downers Grove, IL 60515  
 630.785.0110 voice, 630.839.2566 fax  
 www.mps-ill.com  
**MILLENNIA PROFESSIONAL SERVICES**

DESIGNED -	TVN/MG	REVISED -	
DRAWN -	MG/JP	REVISED -	
CHECKED -	TVN	REVISED -	
DATE -	3/14/2014	REVISED -	

**STATE OF ILLINOIS**  
**DEPARTMENT OF TRANSPORTATION**

**US ROUTE 14 OVER LAWRENCE CREEK TRIBUTARY**  
**SUGGESTED CONSTRUCTION STAGING**  
**TRAFFIC CONTROL & GENERAL NOTES**

SCALE: N/A SHEET NO. 1 OF 3 SHEETS STA. TO STA.

F.A.P. RTE.	SECTION	COUNTY	TOTAL SHEETS	SHEET NO.
066	21B-R	MCHENRY	40	13
FED. ROAD DIST. NO. 1   ILLINOIS FED. AID PROJECT			CONTRACT NO. 60V25	

P:\2011\ME11007\_Ver-Var-Ph1\CADD\W006\_US14\Shets\13-D16\025-sht-STG00\_Notes.dgn