

STATE OF ILLINOIS  
DEPARTMENT OF TRANSPORTATION  
DIVISION OF HIGHWAYS  
**PROPOSED  
HIGHWAY PLANS**

FAS 1741 (FR I-55 WEST)  
SECTION (116)RS

PATCHING, 3P RESURFACING  
MONTGOMERY COUNTY

C-96-077-14

F.A.S. R.T.E. 1741	SECTION ***	COUNTY MONTGOMERY	TOTAL SHEETS 14	SHEET NO. 1
		ILLINOIS	CONTRACT NO. 72H06	

\*\*\* (116) RS

- INDEX OF SHEETS**
- 1 COVER SHEET
  - 2 GENERAL NOTES
  - 3-4 SUMMARY OF QUANTITIES
  - 5 SCHEDULE OF QUANTITIES
  - 6 TYPICAL SECTIONS
  - 7-10 PLAN SHEET
  - 11-14 DETAILS

**STANDARDS**

- 442201-03
- 701901-03
- 780001-04
- 781001-03
- BLR21-9
- BLR22-7

WHEREVER IN THESE PLANS SECTION D6 SPRING RD REPAIR 2014-4 IS MENTIONED, IT SHALL MEAN SECTION (116)RS

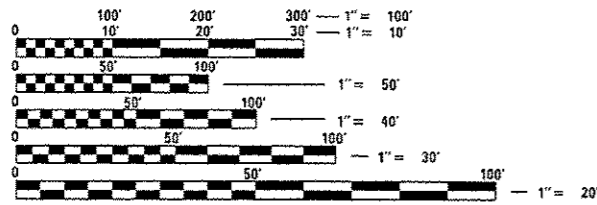
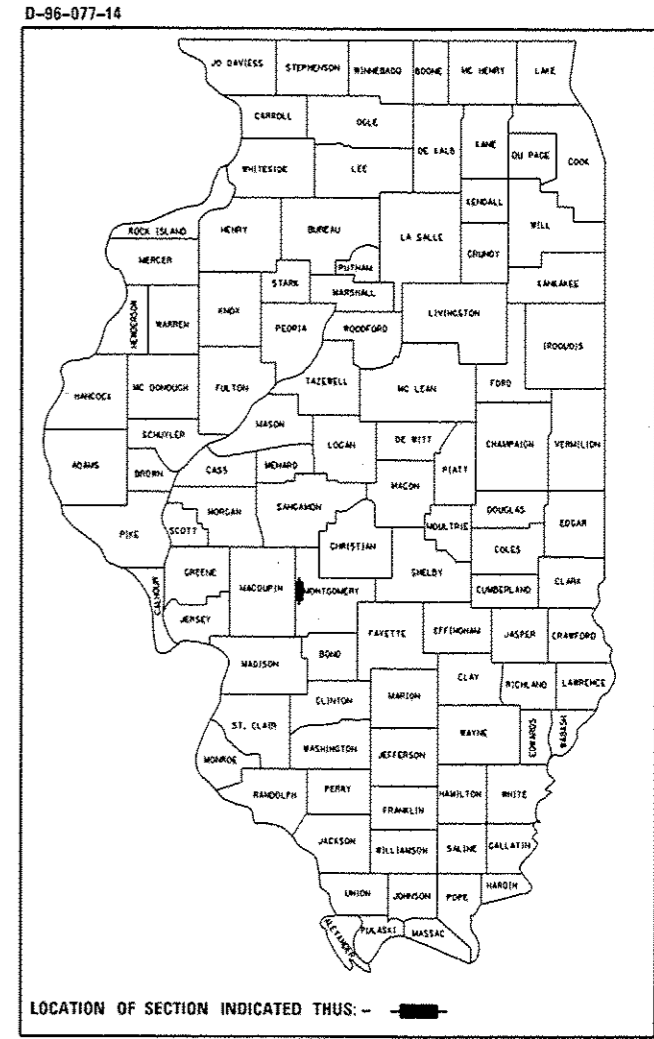

FULL SIZE PLANS HAVE BEEN PREPARED USING STANDARD ENGINEERING SCALES. REDUCED SIZED PLANS WILL NOT CONFORM TO STANDARD SCALES. IN MAKING MEASUREMENTS ON REDUCED PLANS, THE ABOVE SCALES MAY BE USED.

J.U.L.I.E.  
JOINT UTILITY LOCATION INFORMATION FOR EXCAVATION  
1-800-892-0123  
OR 811

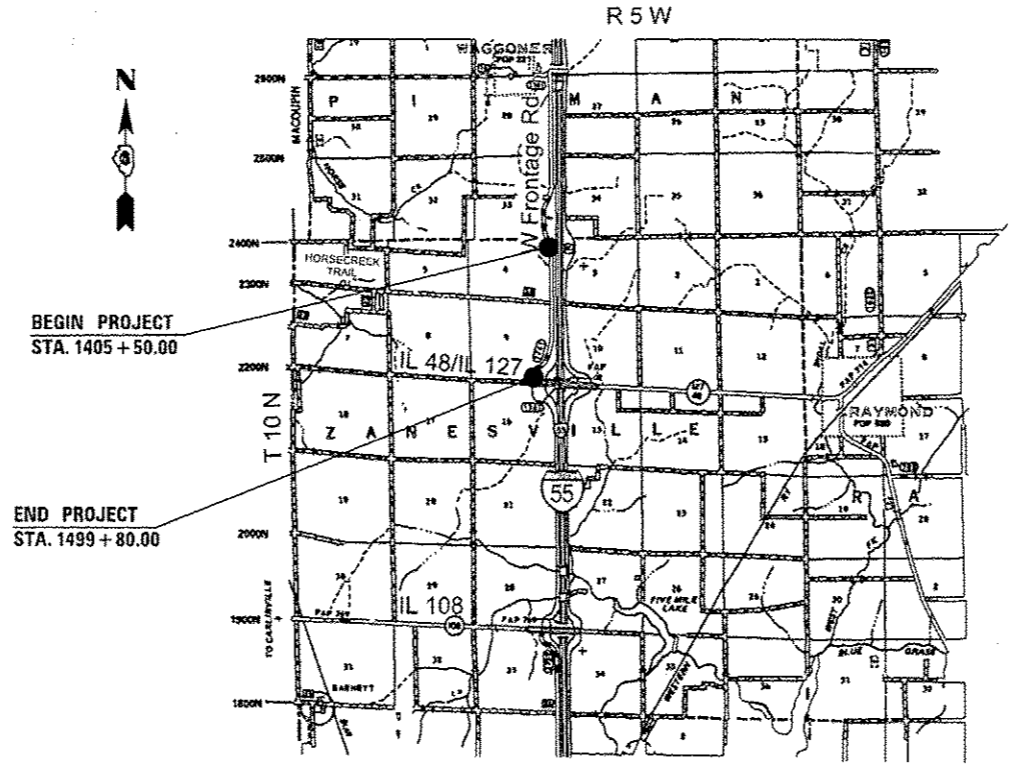

**LOCATION MAP**

GROSS LENGTH = 9,430.00 FT. = 1.786 MILE  
NET LENGTH = 9,430.00 FT. = 1.786 MILE

**TRAFFIC COUNT**

ADT = 450(2010)  
PV = N/A  
SU = N/A  
MU = N/A

STATE OF ILLINOIS  
DEPARTMENT OF TRANSPORTATION  
DIVISION OF HIGHWAYS

SUBMITTED May 21 2014  
Roger Zornick  
DEPUTY DIRECTOR OF HIGHWAYS, REGION ENGINEER

June 07 2014  
John D. Baronzoli, PE, SE, BC  
ENGINEER OF DESIGN AND ENVIRONMENT

June 27 2014  
Chris Osman, PE, BC  
DIRECTOR OF HIGHWAYS, CHIEF ENGINEER

SENIOR TEAM ENGINEER: MARK DUST (217) 785-0597  
TEAM MANAGER: JARED MARTIN (217) 524-0064

CONTRACT NO. 72H06

**PRINTED BY THE AUTHORITY  
OF THE STATE OF ILLINOIS**