

PLAN	SURVEYED	DATE
	PLOTTED	
	GRADES CHECKED	
	STRUCTURE NOTATIONS OK'D	
	NOTE BOOK	
	NO.	

PROFILE	SURVEYED	DATE
	PLOTTED	
	GRADES CHECKED	
	STRUCTURE NOTATIONS OK'D	
	NOTE BOOK	
	NO.	

P:\Jobs\2010\20103003\cod\site\ogn\01\06053-sht+planpr of-02.dgn
 5/16/2013 2:55:11 PM

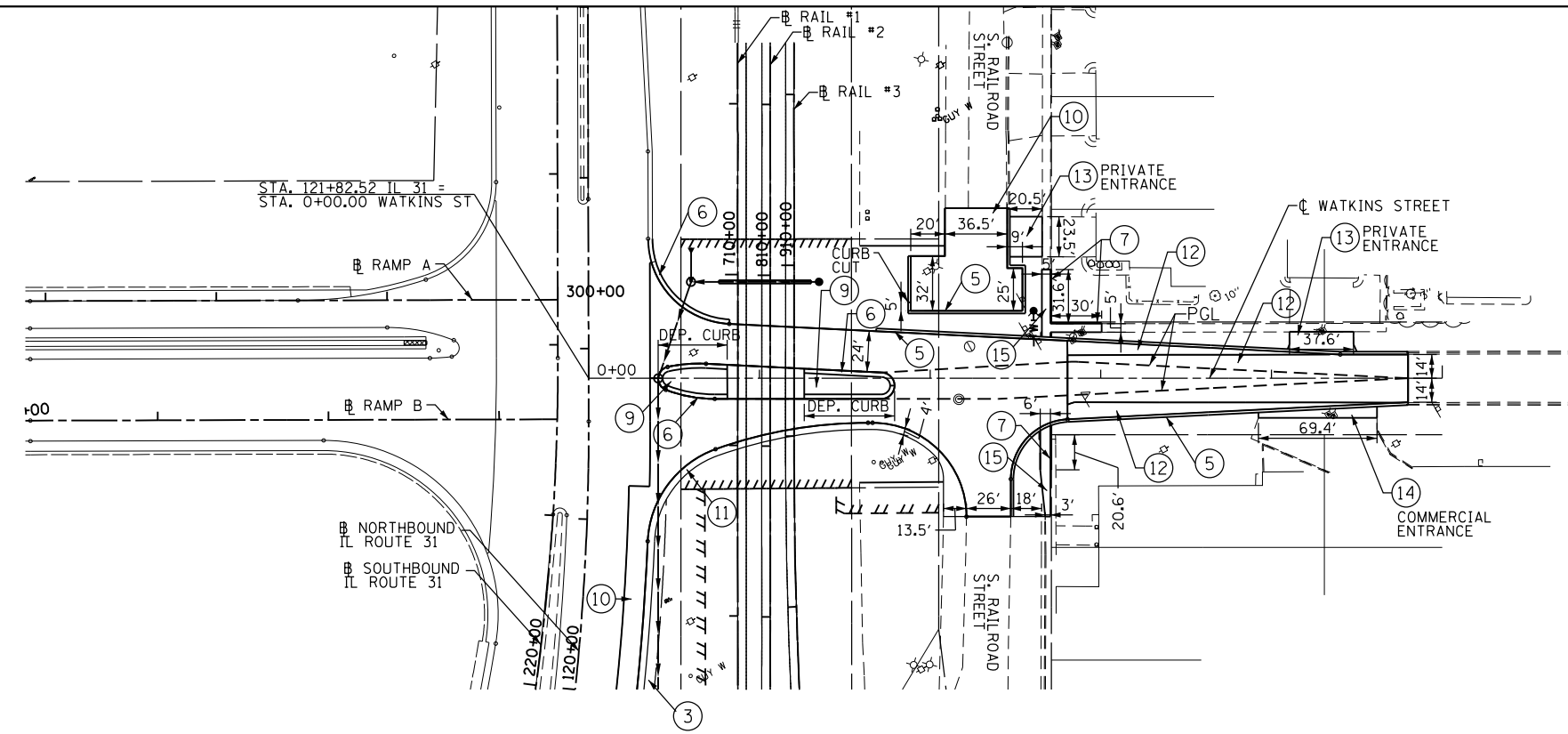

- LEGEND**
- ① STEEL PLATE BEAM GUARDRAIL, TYPE A, 6 FT POSTS
 - ② TRAFFIC BARRIER TERMINAL, TYPE 2
 - ③ AGGREGATE SHOULDER, TYPE B, 8"
 - ④ AGGREGATE WEDGE SHOULDER, TYPE B, 3" MAX.
 - ⑤ B-6.12 CURB AND GUTTER
 - ⑥ B-6.24 CURB AND GUTTER
 - ⑦ CONCRETE CURB, TYPE B
 - ⑧ TOPSOIL, FURNISH & PLACE, 30"
 - ⑨ CONCRETE MEDIAN, 4"
 - ⑩ HOT-MIX ASPHALT PAVEMENT (FULL DEPTH)
 - ⑪ HOT-MIX ASPHALT SHOULDER
 - ⑫ HOT-MIX ASPHALT PAVEMENT OVERLAY AND WIDENING
 - ⑬ HOT-MIX ASPHALT DRIVEWAY
 - ⑭ P.C.C. DRIVEWAY PAVEMENT, 8"
 - ⑮ P.C.C. SIDEWALK, 6"
- NOTES:**
- SEE ROADWAY PLAN DETAILS SHEET FOR MORE INFORMATION REGARDING WORK AT THIS LOCATION.

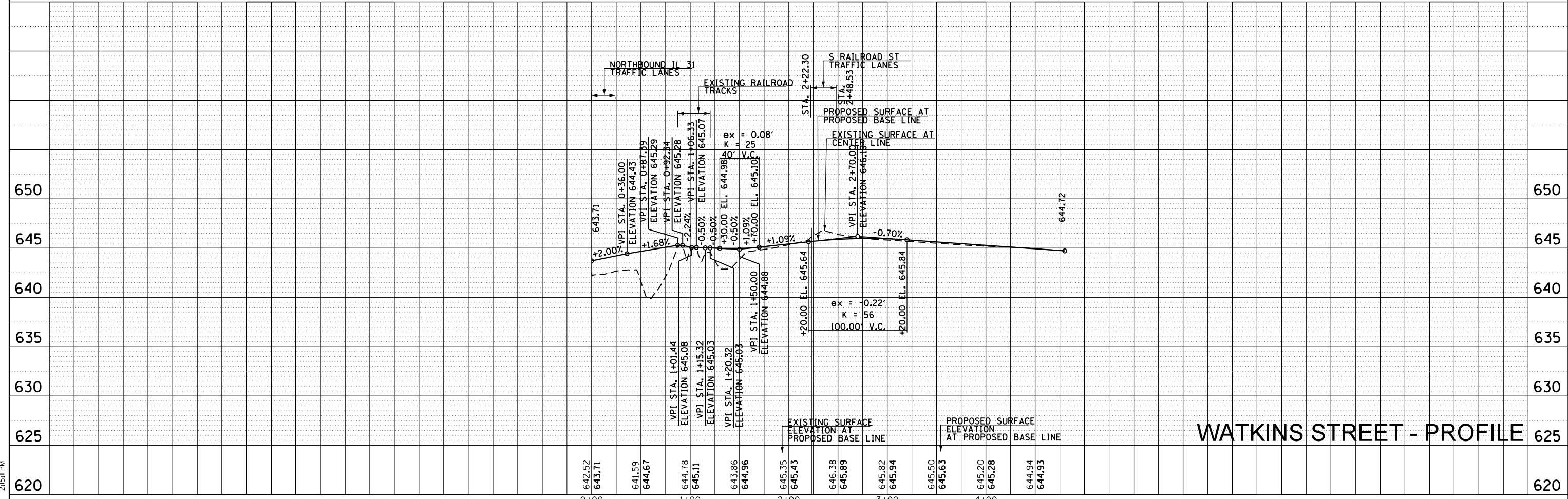
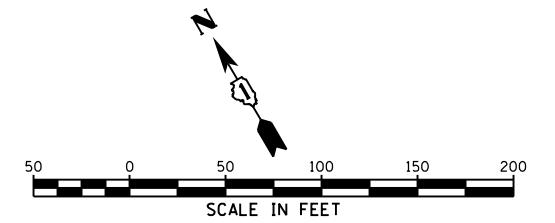

WATKINS STREET - PROFILE

GRAEF
 8501 W. Higgins Road, Suite 280
 Chicago, Illinois 60631
 (773) 399-0112

USER NAME = 1654	DESIGNED - JWB	REVISED -
	DRAWN - JWB	REVISED -
PLOT SCALE = 100.0000' / 1"	CHECKED - RS	REVISED -
PLOT DATE = 5/16/2013	DATE - 05/17/2013	REVISED -

**STATE OF ILLINOIS
 DEPARTMENT OF TRANSPORTATION**

**WATKINS STREET AT IL ROUTE 31
 ROADWAY PLAN AND PROFILE - WATKINS STREET**

F.A.U. RTE.	SECTION	COUNTY	TOTAL SHEETS	SHEET NO.
3902	12R-N	KANE	92	26
CONTRACT NO. 60V53				