

STATE OF ILLINOIS  
DEPARTMENT OF TRANSPORTATION  
DIVISION OF HIGHWAYS

PLANS FOR PROPOSED  
FEDERAL AID HIGHWAY

F.A.U. 1300 (CENTRAL ROAD) AT DEE ROAD  
HARRISON STREET FROM MEADOW LANE TO DEE ROAD  
SIDEWALK IMPROVEMENT  
SECTION NO. 12-11100-90-SW  
SRTS-4009(233)  
MAINE TOWNSHIP  
COOK COUNTY  
JOB NO. C-91-101-13

INDEX OF SHEETS

SHEET NO.	DESCRIPTION
1	COVER SHEET
2	GENERAL NOTES
3	SUMMARY OF QUANTITIES
4	TYPICAL SECTIONS
5-9	EXISTING AND PROPOSED PLAN
10	MAINTENANCE OF TRAFFIC PLAN
11	EROSION CONTROL PLAN
12-15	CROSS SECTIONS
16	STANDARD DETAILS

HIGHWAY STANDARDS

000001-06	STANDARD SYMBOLS ABBREVIATIONS AND PATTERNS
001006	DECIMAL OF INCH & FOOT
280001-07	TEMPORARY EROSION CONTROL SYSTEMS
424001-07	PERPENDICULAR CURB RAMPS FOR SIDEWALKS
424026-01	ENTRANCE/ALLEY PEDESTRIAN CROSSING
482001-02	HMA SHOULDER ADJACENT TO FLEXIBLE PAVEMENT
606001-05	CONCRETE CURB TYPE B AND COMBINATION CONCRETE CURB AND GUTTER
701006-04	OFF-ROAD OPERATIONS, 2L, 2W, 15' TO 24' FROM EDGE OF PAVEMENT
701011-03	OFF-ROAD MOVING OPERATIONS, 2L, 2W, DAY ONLY
701301-04	LAKE CLOSURE, 2L, 2W, SHORT TIME OPERATIONS
701501-06	URBAN LANE CLOSURE, 2L, 2W, UNDIVIDED
701801-05	SIDEWALK CORNER AND CROSSWALK CLOSURE
701901-02	TRAFFIC CONTROL DEVICES
TC-13	DISTRICT 1 TYPICAL PAVEMENT MARKINGS

CENTRAL ROAD: ARTERIAL	SPEED LIMIT: 35 MPH	ADT: 13200
HARRISON STREET: COLLECTOR	SPEED LIMIT: 25 MPH	ADT: 1475
DEE ROAD: COLLECTOR	SPEED LIMIT: 25 MPH	ADT: 1050

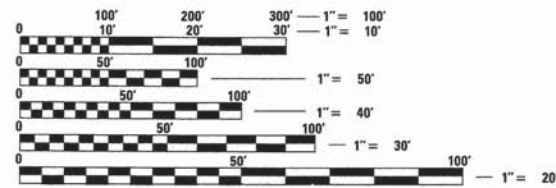

FULL SIZE PLANS HAVE BEEN PREPARED USING STANDARD ENGINEERING SCALES. REDUCED SIZED PLANS WILL NOT CONFORM TO STANDARD SCALES. IN MAKING MEASUREMENTS ON REDUCED PLANS, THE ABOVE SCALES MAY BE USED.

J.U.L.I.E.  
JOINT UTILITY LOCATION INFORMATION FOR EXCAVATION  
CALL: 1-800-892-0123

CONTRACT NO. 63828

F.A.U. ROUTE	SECTION	COUNTY	TOTAL SHEETS	SHEET NO.
1300	12-11100-90-SW	COOK	16	1

CONTRACT NO. 63828



LOCATION OF SECTION INDICATED THIS: -

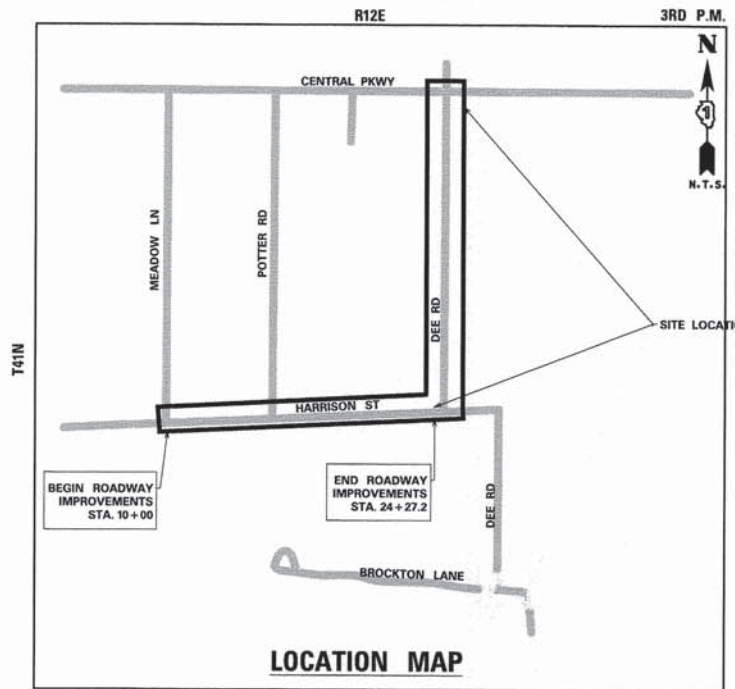

LOCATION MAP

MAINE TOWNSHIP  
GROSS LENGTH = 1427.2 FT  
NET LENGTH = 1427.2 FT

STATE OF ILLINOIS  
DEPARTMENT OF TRANSPORTATION  
DIVISION OF HIGHWAYS

APPROVED May 10 2013  
Robert P. Brown  
MAINE TOWNSHIP HIGHWAY COMMISSIONER

APPROVED May 10 2013  
Scottie Clay  
SUPERINTENDENT, EAST MAINE SCHOOL DISTRICT 63

PASSED MAY 29 2013  
C.H. H.  
DISTRICT 1 ENGINEER OF LOCAL ROADS AND STREETS

RELEASING FOR BID  
BASED ON LIMITED  
REVIEW May 20 2013  
John F. ...  
DEPUTY DIRECTOR OF HIGHWAYS, REGION 1 ENGINEER

Thomas J. McCabe, Jr. 5-13-13 DATE  
ENGINEER  
THOMAS McCABE, JR., P.E.  
ILLINOIS REGISTRATION NO.: 062-044159  
EXPIRATION DATE: 11/30/2013  
PROFESSIONAL DESIGN FIRM NO.: 184-001157  
EXPIRATION DATE: 04/30/2015  
THESE PLANS OR ANY PART THEREOF SHALL BE CONSIDERED VOID WITHOUT THE SIGNATURE, SEAL, AND EXPIRATION DATE OF SEAL OF THE ENGINEER

CONSULTING ENGINEERS  
SITE DEVELOPMENT ENGINEERS  
LAND SURVEYORS

9575 W. Higgins Road, Suite 700, Rosemont, Illinois 60018  
Phone: (847) 696-4040 Fax: (847) 696-4045

PROFESSIONAL DESIGN FIRM NO. 184-001157  
EXPIRATION DATE: 04/30/2015

PRINTED BY THE AUTHORITY  
OF THE STATE OF ILLINOIS

**GENERAL NOTES, SPECIFICATIONS, AND SPECIAL PROVISIONS**

1. ALL CONSTRUCTION SHALL BE DONE IN ACCORDANCE WITH THE "STANDARD SPECIFICATIONS FOR ROAD AND BRIDGE CONSTRUCTION" ADOPTED JANUARY 1, 2012, THE " SUPPLEMENTAL SPECIFICATIONS AND RECURRING SPECIAL PROVISIONS", THE LATEST REVISION; THE LATEST EDITION OF THE ILLINOIS "MANUAL ON UNIFORM TRAFFIC CONTROL DEVICES FOR STREET AND HIGHWAY"; THE DETAILS IN THE PLANS AND THE "SPECIAL PROVISIONS" INCLUDED IN THE CONTRACT DOCUMENTS.
2. THE LOCATION OF DRAINAGE STRUCTURES, STORM SEWERS, WATERMANS, SANITARY SEWERS, AND OTHER PUBLIC OR PRIVATE UTILITIES AS SHOWN ON THE PLANS IS APPROXIMATE AND THEIR EXACT LOCATION IS TO BE DETERMINED IN THE FIELD BY THE CONTRACTOR. THIS WORK SHALL BE CONSIDERED INCLUDED IN THE COST OF MOBILIZATION UNIT BID PRICE OF THE CONTRACT, AND NO ADDITIONAL COMPENSATION WILL BE ALLOWED.
3. ALL AREAS DISTURBED DURING CONSTRUCTION OPERATIONS AND NOT PART OF THE WORK AS SHOWN HEREON SHALL BE RESTORED TO ORIGINAL CONDITION TO THE SATISFACTION OF THE ENGINEER AT NO ADDITIONAL COMPENSATION TO THE CONTRACTOR. IT IS INCUMBENT UPON THE CONTRACTOR TO SHOW THAT DAMAGED AREAS WERE NOT DISTURBED BY CONSTRUCTION OPERATIONS.
4. THESE DRAWINGS ASSUME THAT THE CONTRACTOR WILL UTILIZE AN ELECTRONIC DRAWING FILE AND STAKE ALL SITE IMPROVEMENTS USING COORDINATES TIED INTO THE PROVIDED CONTROL POINTS. THE DIMENSIONS INDICATED ON THE DRAWINGS ARE FOR THE CONVENIENCE OF THE CONTRACTOR ONLY.
5. THE CONTRACTOR SHALL TAKE ALL NECESSARY SAFETY PRECAUTIONS TO PROTECT ABUTTING PROPERTY, UTILITIES, PEDESTRIANS, AND VEHICULAR TRAFFIC. THIS WORK SHALL BE INCLUDED IN THE L.SUM COST FOR TRAFFIC CONTROL AND PROTECTION (SPECIAL).
6. THE CONTRACTOR IS RESPONSIBLE FOR ADJUSTING ALL EXISTING UTILITIES AND STRUCTURES AS NECESSARY TO THE FINAL PROPOSED SURFACE PROFILE GRADES. CONTRACTOR SHALL BE RESPONSIBLE FOR ALL COORDINATION WITH CITY DEPARTMENTS AND UTILITY OWNERS.
7. CONTRACTOR IS RESPONSIBLE FOR REMOVAL, STORAGE, AND RE-INSTALLATION OF ALL EXISTING SIGNAGE, MAIL/ UPS BOXES, STREET SIGNS, AND OTHER ITEMS THAT ARE IMPACTED BY THIS CONTRACT AND ARE NOT SHOWN AS BEING REPLACED. THE CONTRACTOR IS RESPONSIBLE FOR REPLACING ANY OF THESE ITEMS THAT ARE DAMAGED AS A RESULT OF THIS CONTRACT FOR NO ADDITIONAL COST. THE REMOVAL AND RE-INSTALLATION OF THESE ITEMS IS NOT QUANTIFIED SEPARATELY AND ARE INCLUDED IN THE COST OF MOBILIZATION.
8. THE CONTRACTOR SHALL MAINTAIN SURFACE DRAINAGE OF THE ROAD DURING CONSTRUCTION.
9. THE CONTRACTOR SHALL NOTIFY JULIE AND NON-JULIE UTILITY COMPANIES FOR FIELD LOCATIONS OF THEIR FACILITIES PRIOR TO BEGINNING CONSTRUCTION. THE CONTRACTOR WILL BE RESPONSIBLE FOR THE MAINTENANCE AND PRESERVATION OF THESE FACILITIES. ALL UTILITY LOCATIONS SHOWN MUST BE VERIFIED BY THE CONTRACTOR IN THE FIELD.
10. CARE MUST BE TAKEN FOR ANY EARTH EXCAVATION NEAR EXISTING TREES SO THAT DAMAGE TO THE TREE ROOTS DOES NOT OCCUR.
11. ACCESS MUST BE MAINTAINED TO ALL EXISTING PROPERTIES DURING CONSTRUCTION PER ARTICLE 107.09 UNLESS ARRANGEMENTS ARE MADE IN WRITING BY THE CONTRACTOR WITH THE PROPERTY OWNERS WITH A COPY TO THE ENGINEER FOR SHORT TERM CLOSURES.
12. IF THE CONTRACTOR CAUSES DEBRIS TO ENTER THE EXISTING SEWERS, THAT ENTIRE SECTION OF SEWER BETWEEN MANHOLES MUST IMMEDIATELY BE THOROUGHLY CLEANED AND RODDED BY THE CONTRACTOR AT NO ADDITIONAL COST TO THE CONTRACT. ALL SEWER AND WATER STRUCTURES SO CONTAMINATED MUST AT ONCE BE THOROUGHLY CLEANED BY THE CONTRACTOR AT NO ADDITIONAL COST TO THE CONTRACT.
13. ALL SAWCUTTING SHALL BE INCLUDED IN THE REMOVAL ITEMS AND SHALL BE PERFORMED PRIOR TO BEGINNING OF WORK. REMOVAL OF ANY ITEMS OF WORK REMOVED PRIOR TO SAWCUTTING WILL NOT BE MEASURED FOR PAYMENT.
14. DETECTABLE WARNINGS FOR THE HANDICAPPED SHALL BE INSTALLED AT ALL INTERSECTING STREETS, SIGNALIZED COMMERCIAL DRIVEWAYS, AND SIGNALIZED ALLEYS AS DIRECTED BY THE ENGINEER. CONTRACTOR SHALL VERIFY THAT ALL SLOPES MEET ADA REQUIREMENTS PRIOR TO INSTALLING SIDEWALK DETECTABLE WARNINGS AND ADJACENT CURB AND GUTTER.
15. THE ELEVATIONS INDICATED ON THE PLANS ARE FINISHED GRADES UNLESS OTHERWISE INDICATED.
16. PROPOSED CONCRETE CURB AND GUTTER SHALL BE TRANSITIONED TO EXISTING CURB AND GUTTER OVER A LENGTH OF 6 FEET. THIS WORK SHALL BE PAID FOR AT THE CONTRACT UNIT PRICE PER FOOT FOR COMBINATION CONCRETE CURB AND GUTTER, TYPE B-6.12.
17. THE CONTRACTOR SHALL CONTACT THE IDOT ATERIAL DISTRICT ONE TRAFFIC CONTROL SUPERVISOR AT (847) 705-4470 A MINIMUM OF 72 HOURS IN ADVANCE OF BEGINNING WORK FOR LOCATIONS OF UNDERGROUND TRAFFIC SIGNAL LINES, LIGHTING CABLE, OR INTERCONNECT CABLE CALL (847) 221-3078 TO LOCATE UNDERGROUND LIGHTING CABLE.
18. THE CONTRACTOR SHALL ADVISE THE POLICE AND FIRE DEPARTMENTS DAILY AS TO WHAT STREETS, IF ANY, ARE TO BE CLOSED OR PARTIALLY BLOCKED SO THAT THEY CAN EFFICIENTLY ROUTE THEIR EMERGENCY VEHICLES.
19. PAY ITEMS IN THE SUMMARY OF QUANTITIES HAVE BEEN ESTIMATED. IF, IN THE ENGINEER'S OPINION, THE WORK IS NOT REQUIRED, THE ITEM WILL BE DEDUCTED FROM THE CONTRACT AND NO ADDITIONAL COMPENSATION WILL BE ALLOWED.

20. THE COST OF CONNECTING EXISTING STORM SEWERS TO THE PROPOSED DRAINAGE SYSTEM AND CONNECTING PROPOSED STORM SEWER TO EXISTING STRUCTURES SHALL BE CONSIDERED INCLUDED IN THE CONTRACT UNIT PRICE FOR STORM SEWERS.

21. THE UNIT PRICE FOR COMBINATION CONCRETE CURB AND GUTTER, TYPE B-6.12 SHALL CONSIST ALL NECESSARY PAVEMENT SAW CUT, ADJACENT TO CURB PAVEMENT REMOVAL AND REPLACEMENT, EXCAVATION AND BACKFILL BEHIND THE CURB.

22. SPECIAL ATTENTION IS CALLED TO THE SPECIAL PROVISION FOR INSPECTION AS WELL AS ARTICLE 107.30 OF THE STANDARD SPECIFICATIONS. ANY DEFACED WORK SHALL BE CORRECTED OR REPLACED BY THE CONTRACTOR AT HIS SOLE EXPENSE PRIOR TO FINAL PAYMENT. THE EAST MAINE SCHOOL DISTRICT 63 SHALL COOPERATE WITH THE CONTRACTOR TO MINIMIZE VANDALISM, BUT THE CONTRACTOR SHALL BE ULTIMATELY RESPONSIBLE TO CORRECT ANY DAMAGE. THE OWNER, MUNICIPALITY, DEPARTMENT WILL NOT BE RESPONSIBLE FOR THE SECURITY OF THE WORK SITE IN THIS REGARD. OTHER THAN NORMAL PATROLLING AND RESPONSE TO EMERGENCIES. THE COST OF ADDITIONAL SECURITY REQUIRED TO MEET THIS PROVISION SHALL BE SOLELY THE CONTRACTOR'S RESPONSIBILITY.

**THE CONTRACTOR SHALL BE SOLELY RESPONSIBLE FOR JOB SITE SAFETY AS WELL AS SUPERVISION/DIRECTION AND MEANS/METHODS OF CONSTRUCTION.**

LOCAL AGENCY	TELEPHONE NUMBER
CITY OF DES PLAINES	847-391-5300
POLICE DEPARTMENT	847-391-5400
FIRE DEPARTMENT	847-391-5333

FILE NAME = 6421.88GN.dgn	USER NAME = JBUTCHER	DESIGNED -	REVISED -
		DRAWN -	REVISED -
	PLOT SCALE = 0.9973 ' / in.	CHECKED -	REVISED -
	PLOT DATE = 5/28/2013	DATE -	REVISED -

**STATE OF ILLINOIS  
DEPARTMENT OF TRANSPORTATION**

**GENERAL NOTES**

F.A.U. RTE.	SECTION	COUNTY	TOTAL SHEETS	SHEET NO.
1300	12-11100-90-SW	COOK	16	2
<b>CONTRACT NO. 63828</b>				
ILLINOIS FED. AID PROJECT				

SCALE: SHEET OF SHEETS STA. TO STA.

LOCATION OF WORK					TOTAL	HARRISON ST. 100% FED	CENTRAL RD. @ DEE RD. 100% FED
						ROADWAY URBAN	ROADWAY URBAN
CONSTRUCTION TYPE CODE					0021	0021	
SP	SI	PAY ITEM	PAY ITEM DESCRIPTION	UNIT			
		20101100	TREE TRUNK PROTECTION	EACH	9	6	3
		20101200	TREE ROOT PRUNING	EACH	7	6	1
		20101300	TREE PRUNING (1 TO 10 INCH DIAMETER)	EACH	6	6	
		20200100	EARTH EXCAVATION	CU YD	100	95	5
		20800150	TRENCH BACKFILL	CU YD	4	4	
		21101505	TOPSOIL EXCAVATION AND PLACEMENT	CU YD	604	602	2
		25000210	SEEDING, CLASS 2A	ACRE	0.29	0.29	
		25000400	NITROGEN FERTILIZER NUTRIENT	POUND	25	25	
		25000500	PHOSPHORUS FERTILIZER NUTRIENT	POUND	25	25	
		25000600	POTASSIUM FERTILIZER NUTRIENT	POUND	25	25	
		25100630	EROSION CONTROL BLANKET	SQ YD	1393	1367	26
		28000305	TEMPORARY DITCH CHECKS	FOOT	48	48	
		28000400	PERIMETER EROSION BARRIER	FOOT	1327	1327	
		28000500	INLET AND PIPE PROTECTION	EACH	12	10	2
		35101600	AGGREGATE BASE COURSE, TYPE B 4"	SQ YD	771	749	22
*		40201000	AGGREGATE FOR TEMPORARY ACCESS	TON	12	12	
		42300400	PORTLAND CEMENT CONCRETE DRIVEWAY PAVEMENT, 8 INCH	SQ YD	103	103	
		42400100	PORTLAND CEMENT CONCRETE SIDEWALK 4 INCH	SQ FT	6009	5815	194
		42400800	DETECTABLE WARNINGS	SQ FT	64	40	24
		44000100	PAVEMENT REMOVAL	SQ YD	103	103	
		44000500	COMBINATION CURB AND GUTTER REMOVAL	FOOT	27		27
		44000600	SIDEWALK REMOVAL	SQ FT	175		175
		48101600	AGGREGATE SHOULDERS, TYPE B 8"	SQ YD	23	23	
		542D0217	PIPE CULVERTS, CLASS D, TYPE 1 12"	FOOT	225	225	
		55100500	STORM SEWER REMOVAL 12"	FOOT	90	90	
		60603800	COMBINATION CONCRETE CURB AND GUTTER, TYPE B-6.12	FOOT	27		27
		67100100	MOBILIZATION	L SUM	1	1	
*		78000400	THERMOPLASTIC PAVEMENT MARKING - LINE 6"	FOOT	208	104	104
*		78000650	THERMOPLASTIC PAVEMENT MARKING - LINE 24"	FOOT	300		300
		78300100	PAVEMENT MARKING REMOVAL	SQ FT	86		86
*	*	X0326696	SIGN AND POST	EACH	3		3
*	*	X0326852	RADAR SPEED SIGN	EACH	2		2
*		X7010216	TRAFFIC CONTROL AND PROTECTION, (SPECIAL)	L SUM	1	1	
*		Z0003855	BICYCLE RACKS	EACH	3		3
		Z0013798	CONSTRUCTION LAYOUT	L SUM	1	1	
*		Z0017400	DRAINAGE & UTILITY STRUCTURES TO BE ADJUSTED	EACH	3	3	

FILE NAME = 6421\_BBS001.dgn

USER NAME = J BUTCHER  
 PLOT SCALE = 0.9973 ' / in.  
 PLOT DATE = 5/28/2013

DESIGNED -	REVISD -
DRAWN -	REVISED -
CHECKED -	REVISED -
DATE -	REVISED -

**STATE OF ILLINOIS  
DEPARTMENT OF TRANSPORTATION**

**SUMMARY OF QUANTITIES**

SCALE: SHEET OF SHEETS STA. TO STA.

F.A.U. RTE.	SECTION	COUNTY	TOTAL SHEETS	SHEET NO.
1300	12-11100-90-SW	COOK	16	3
<b>CONTRACT NO. 63828</b>				
ILLINOIS FED. AID PROJECT				

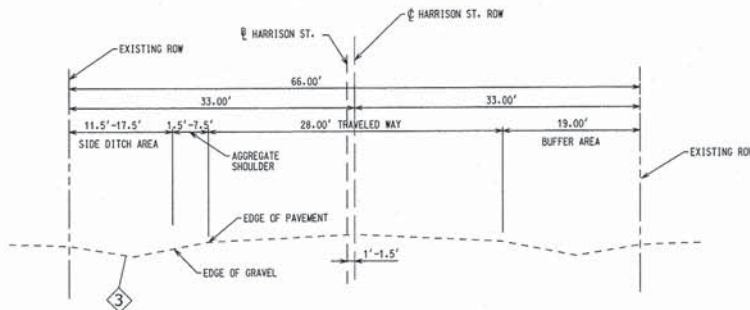

**EXISTING TYPICAL SECTION  
HARRISON ST.**

STA. 10+00 TO STA. 10+15  
 STA. 10+55 TO STA. 10+95  
 STA. 11+14 TO STA. 11+89  
 STA. 12+29 TO STA. 15+46  
 STA. 16+23 TO STA. 24+25

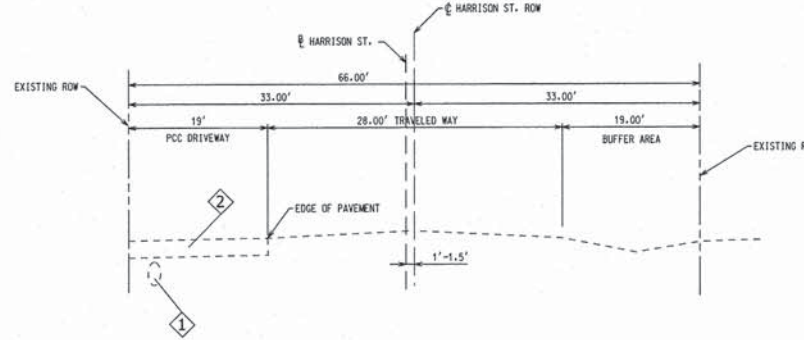

**EXISTING TYPICAL SECTION  
HARRISON ST.**

STA. 10+95 TO STA. 11+14  
 STA. 11+89 TO STA. 12+29

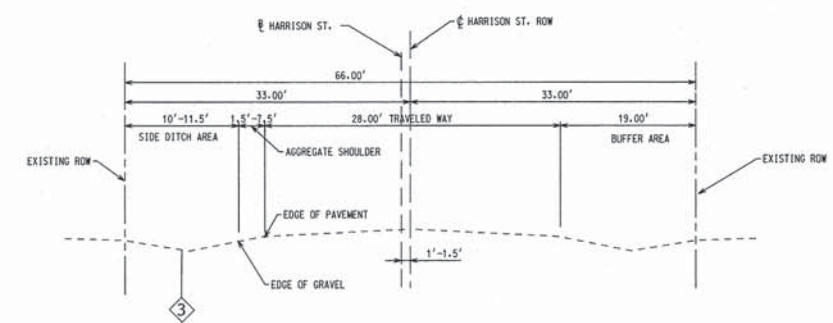

**EXISTING TYPICAL SECTION  
HARRISON ST.**

STA. 19+86 TO STA. 24+27.2

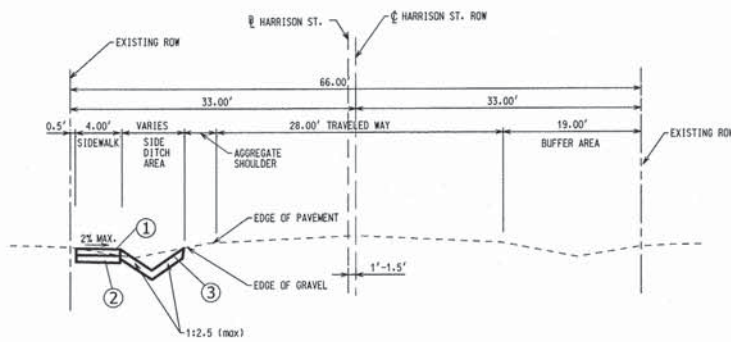

**PROPOSED TYPICAL SECTION  
HARRISON ST.**

STA. 10+00 TO STA. 10+15  
 STA. 10+67 TO STA. 10+95  
 STA. 11+14 TO STA. 11+89  
 STA. 12+57 TO STA. 13+79  
 STA. 14+07 TO STA. 15+46  
 STA. 16+23 TO STA. 16+45  
 STA. 16+64 TO STA. 17+92  
 STA. 18+13 TO STA. 19+14

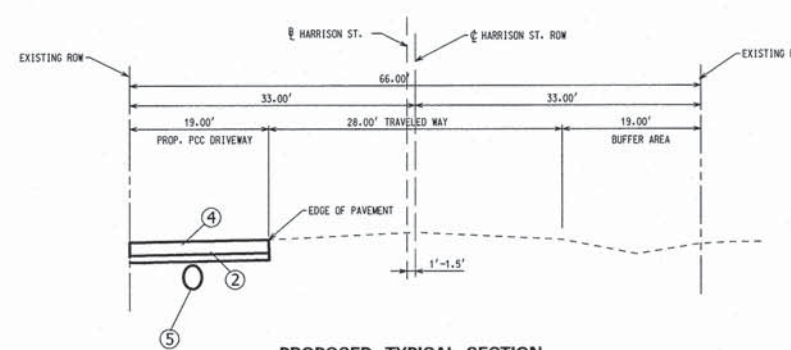

**PROPOSED TYPICAL SECTION  
HARRISON ST.**

STA. 10+95 TO STA. 11+14  
 STA. 11+89 TO STA. 12+29

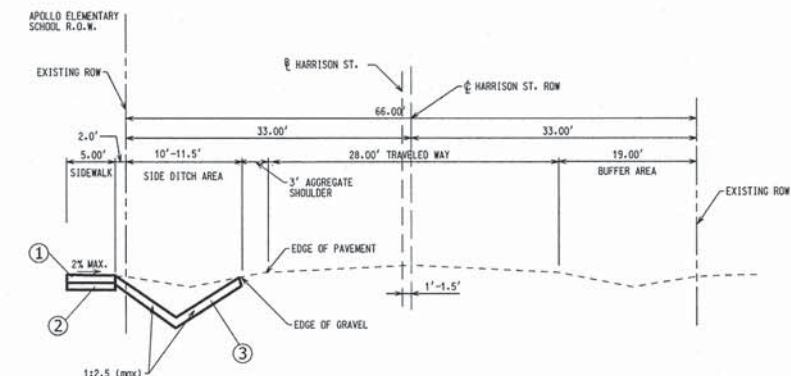

**PROPOSED TYPICAL SECTION  
HARRISON ST.**

STA. 19+86 TO STA. 24+27.2

**PROPOSED ITEMS**

- ① PCC SIDEWALK, 4"
- ② AGGREGATE BASE COURSE, TYPE B, 4"
- ③ TOPSOIL PLACEMENT, 6"
- ④ PCC PAVEMENT DRIVEWAY, 8"
- ⑤ PIPE CULVERT, CLASS D, TYPE 1, 12"

**REMOVAL ITEMS**

- ① STORM SEWER REMOVAL
- ② PAVEMENT REMOVAL
- ③ EARTH/TOPSOIL EXCAVATION

FILE NAME = 6421.BBTS.dgn

USER NAME = JBUTCHER

DESIGNED -

DRAWN -

CHECKED -

DATE -

REVISED -

REVISED -

REVISED -

REVISED -

**STATE OF ILLINOIS  
DEPARTMENT OF TRANSPORTATION**

**TYPICAL SECTIONS**

SCALE: SHEET OF SHEETS STA. TO STA.

F.A.U. RTE.	SECTION	COUNTY	TOTAL SHEETS	SHEET NO.
1300	12-11100-90-SW	COOK	16	4
<b>CONTRACT NO. 63828</b>				

ILLINOIS FED. AID PROJECT

MATCH LINE STA. 15+50 - SEE SHEET 6

MATCH LINE STA. 15+50 - SEE SHEET 6

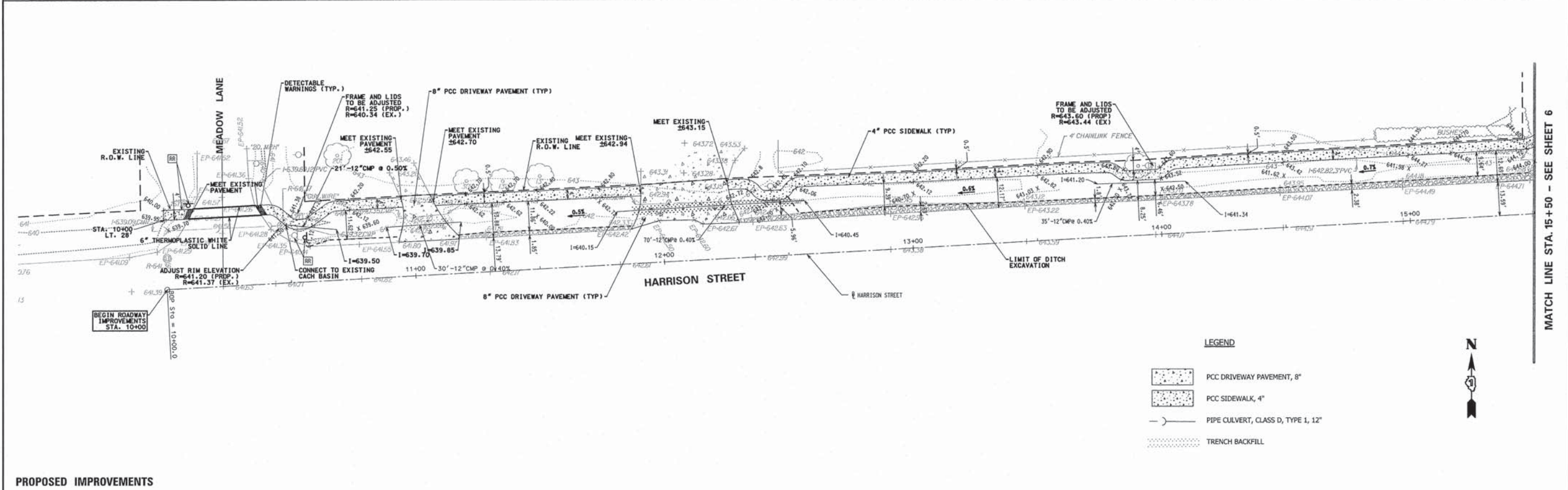
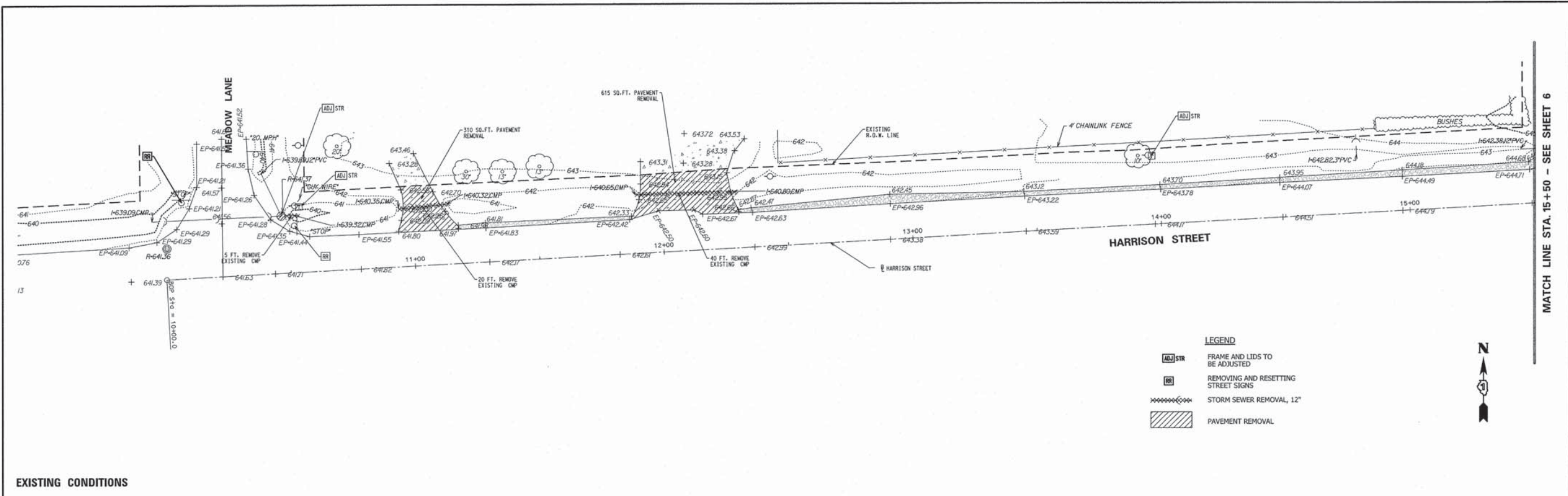

FILE NAME = 6421.88ENG01.dgn	USER NAME = JBUTCHER	DESIGNED -	REVISED -	<b>STATE OF ILLINOIS DEPARTMENT OF TRANSPORTATION</b>	<b>PROPOSED PLAN</b>			F.A.U. RTE. 1300	SECTION 12-11100-90-SW	COUNTY COOK	TOTAL SHEETS 16	SHEET NO. 5			
	PLOT SCALE = 1/8" = 1' / in.	DRAWN -	REVISED -					SCALE: 1:20	SHEET	OF	SHEETS	STA. 10+00	TO STA. 15+50	ILLINOIS FED. AID PROJECT	
	PLOT DATE = 5/28/2013	CHECKED -	REVISED -					CONTRACT NO. 63828							
		DATE -	REVISED -												

MATCH LINE STA. 15+50 - SEE SHEET 5

POTTER RD.

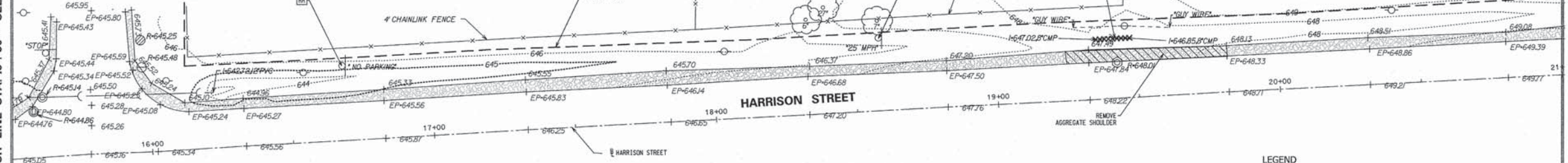

MATCH LINE STA. 21+00 - SEE SHEET 7

EXISTING CONDITIONS

- LEGEND**
- FRAME AND LIDS TO BE ADJUSTED
  - REMOVING AND RESETTNG STREET SIGNS
  - STORM SEWER REMOVAL, 12"
  - AGGREGATE SHOULDER REMOVAL (PAY ITEM #20200100 - EARTH EXCAVATION)

MATCH LINE STA. 15+50 - SEE SHEET 5

POTTER RD.

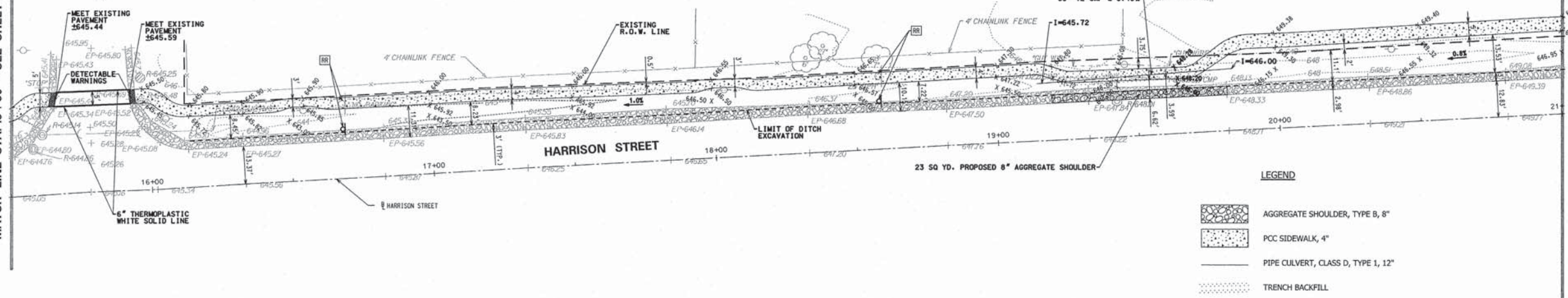

APOLLO ELEMENTARY SCHOOL

MATCH LINE STA. 21+00 - SEE SHEET 7

PROPOSED IMPROVEMENTS

- LEGEND**
- AGGREGATE SHOULDER, TYPE B, 8"
  - PCC SIDEWALK, 4"
  - PIPE CULVERT, CLASS D, TYPE 1, 12"
  - TRENCH BACKFILL

FILE NAME = 6421.08ENG02.dgn	USER NAME = JBUTCHER	DESIGNED -	REVISED -	<b>STATE OF ILLINOIS DEPARTMENT OF TRANSPORTATION</b>	<b>PROPOSED PLAN</b>		F.A.U. RTE. 1300	SECTION 12-11100-90-SW	COUNTY COOK	TOTAL SHEETS 16	SHEET NO. 6	
PLOT SCALE = 1/8" = 1'-0"	CHECKED -	REVISED -	REVISED -		SCALE: 1:20	SHEET OF SHEETS	STA. 15+50 TO STA. 21+00	CONTRACT NO. 63828				
PLOT DATE = 5/28/2013	DATE -	REVISED -	REVISED -		ILLINOIS FED. AID PROJECT							

N:\Project\6421\6421.08 Safe Routes to School - Harrison Street\ENG\6421.08ENG02.dgn Detail User=JBUTCHER

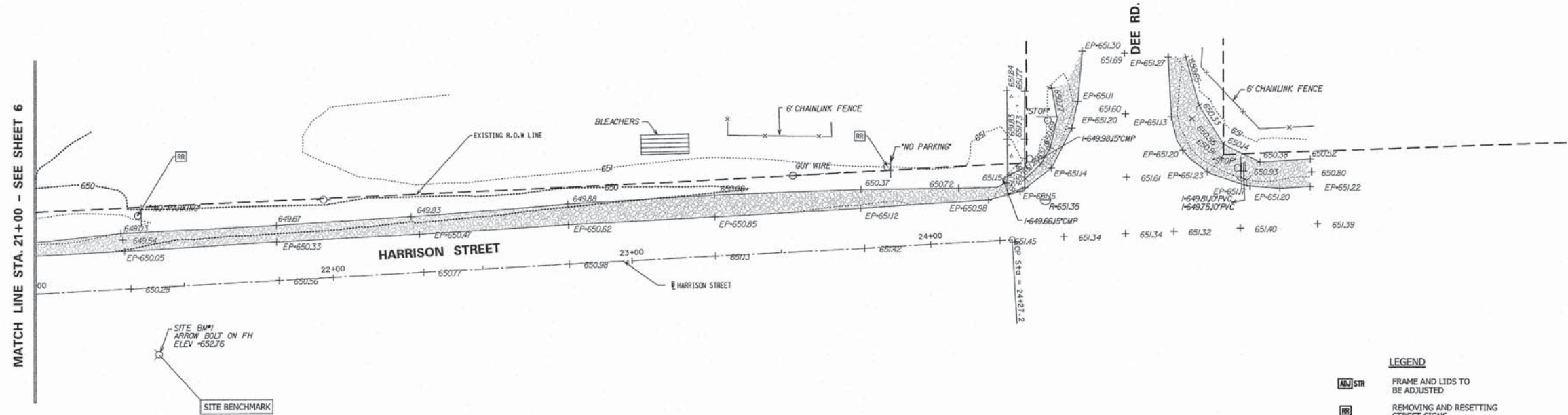

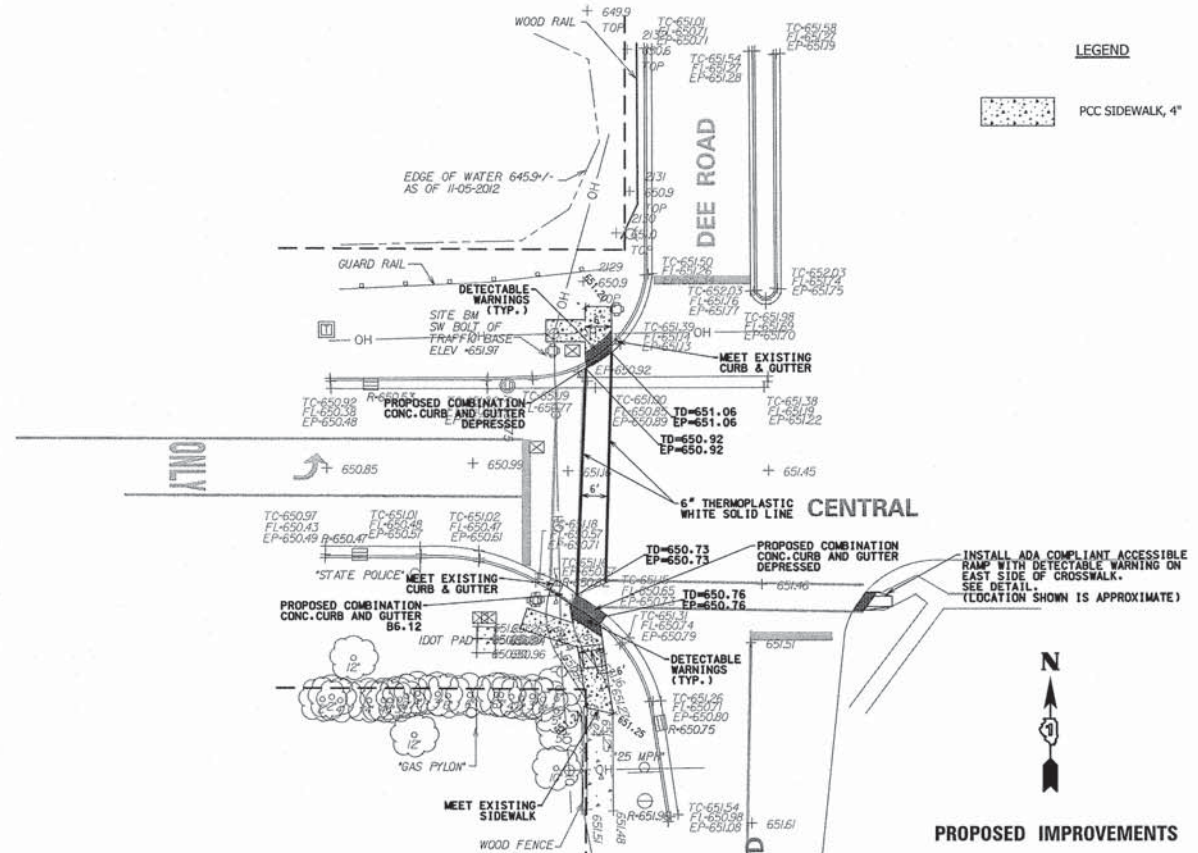
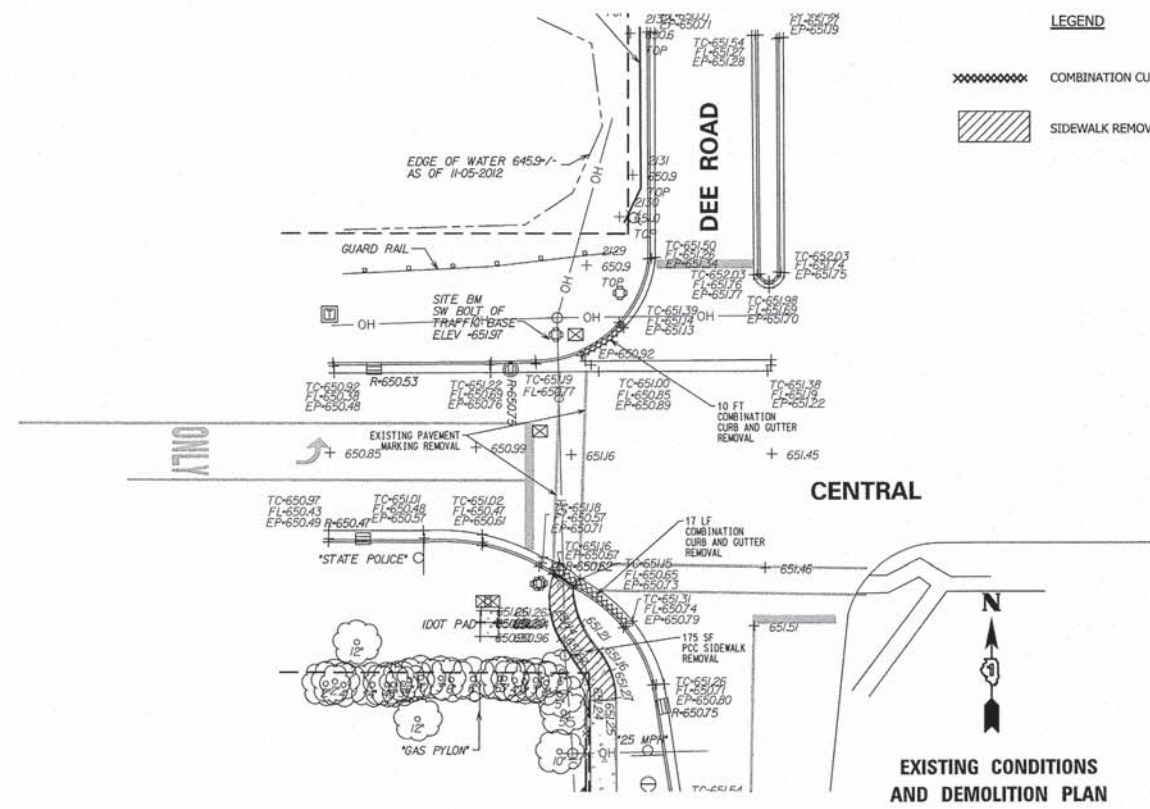

FILE NAME = 6421.BBENG04.dgn	USER NAME = JBUTCHER	DESIGNED -	REVISED -	<b>STATE OF ILLINOIS DEPARTMENT OF TRANSPORTATION</b>	<b>PROPOSED PLAN</b>			F.A.U. RTE.	SECTION	COUNTY	TOTAL SHEETS	SHEET NO.
	PLOT SCALE = 1/4" = 1'-0"	DRAWN -	REVISED -					1300	12-11100-90-SW	COOK	16	8
	PLOT DATE = 5/28/2013	CHECKED -	REVISED -					CONTRACT NO. 63828				
	DATE -	REVISED -		SCALE:	SHEET	OF	SHEETS	STA.	TO STA.	ILLINOIS FED. AID PROJECT		



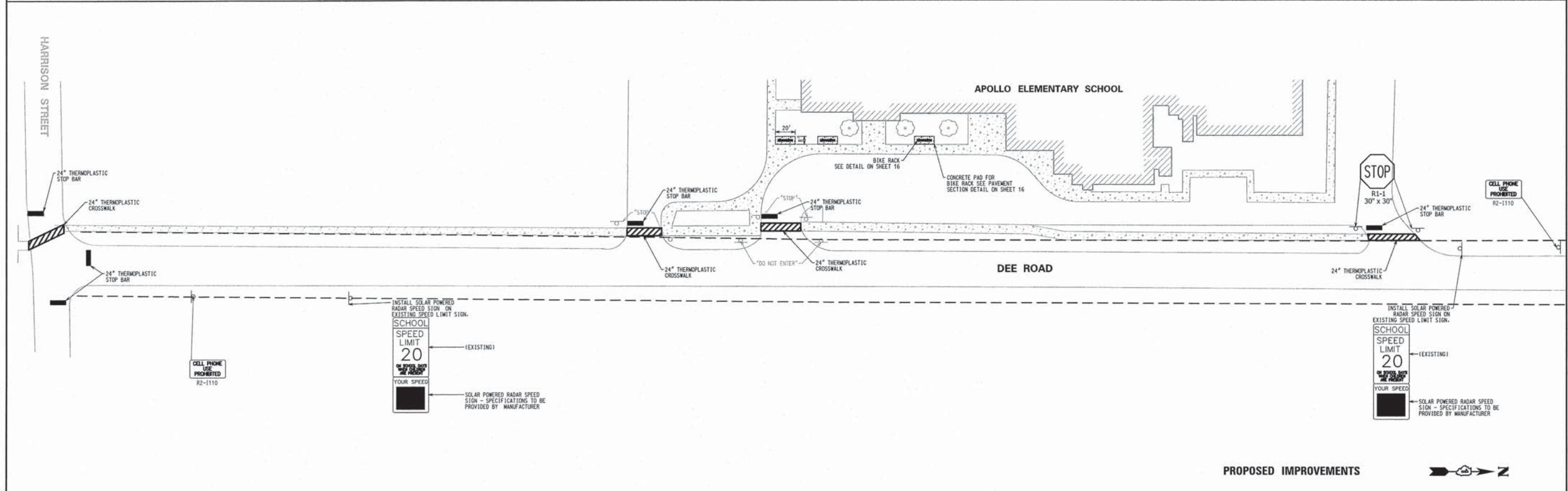
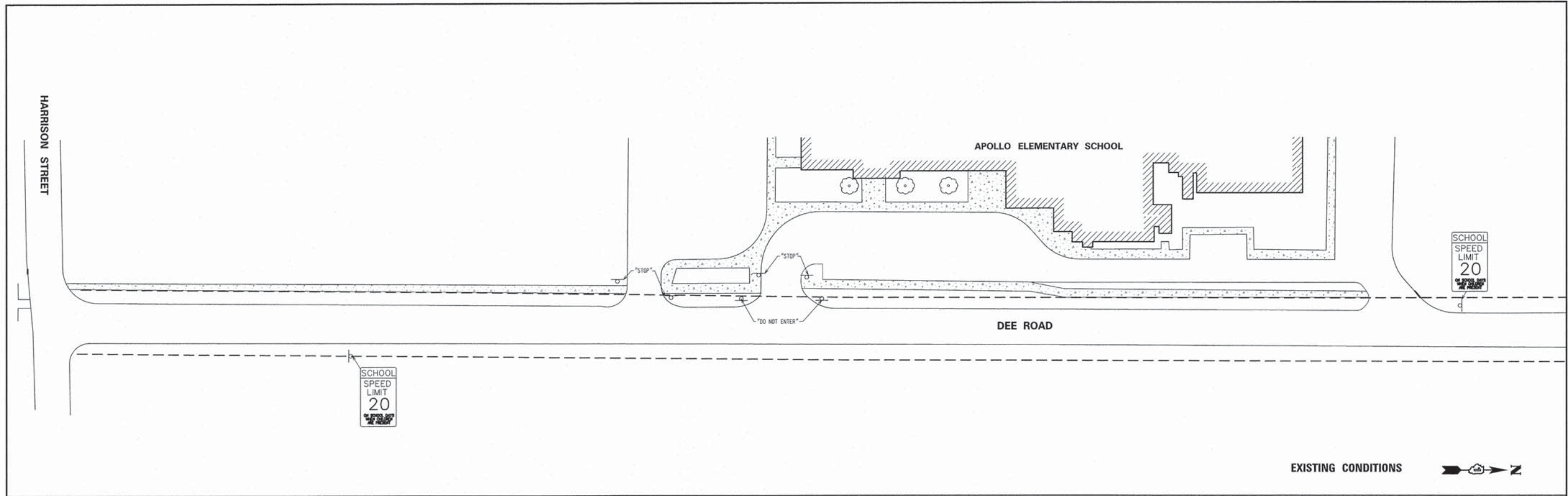

FILE NAME = 6421.BBENG05.dgn	USER NAME = JBUTCHER	DESIGNED -	REVISED -	<b>STATE OF ILLINOIS DEPARTMENT OF TRANSPORTATION</b>	<b>PROPOSED PLAN</b>		F.A.J. RTE. 1300	SECTION 12-11100-90-SW	COUNTY COOK	TOTAL SHEETS 16	SHEET NO. 9	
PLOT SCALE = 49.8629' / in.	CHECKED -	REVISED -	REVISED -		SCALE: 1:50	SHEET	OF	SHEETS	STA.	TO	STA.	CONTRACT NO. 63828
PLOT DATE = 5/28/2013	DATE -	REVISED -	REVISED -		ILLINOIS FED. AID PROJECT							

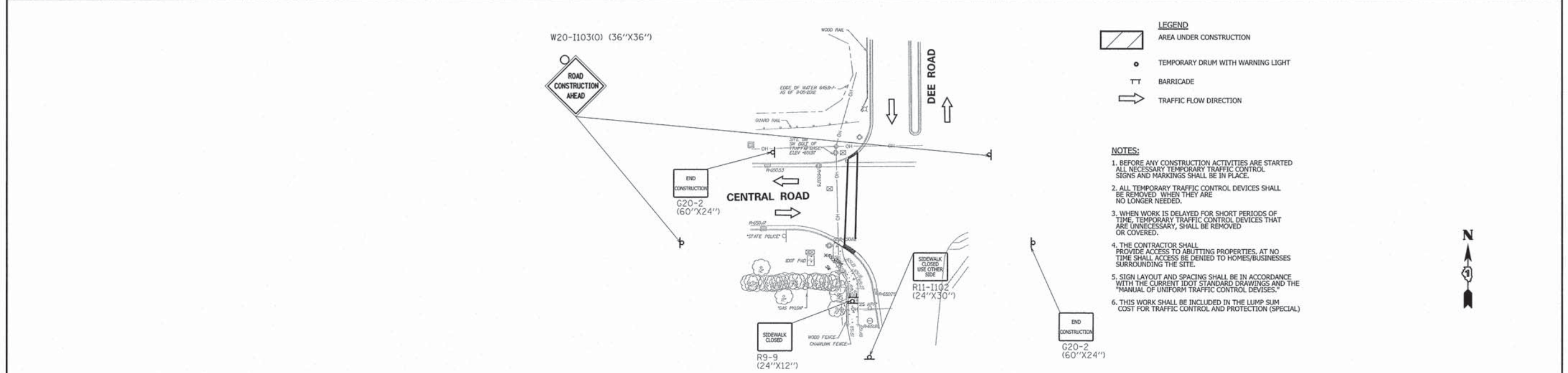
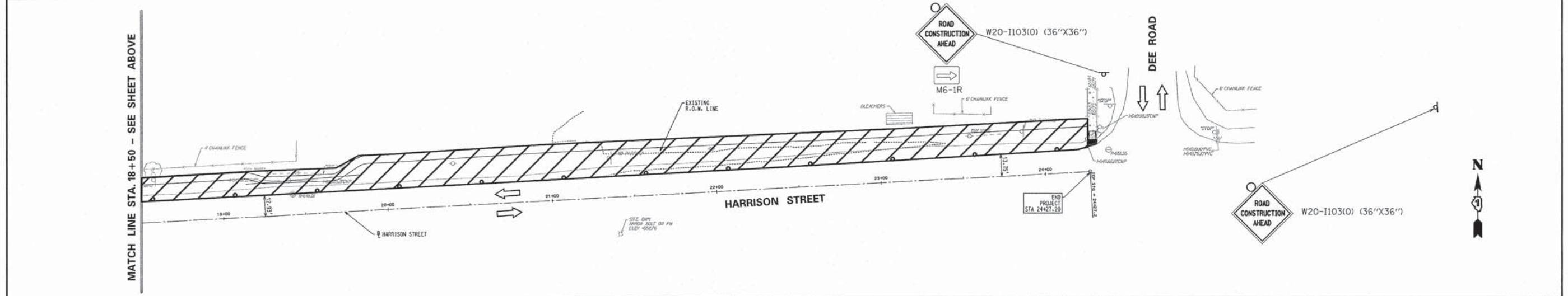
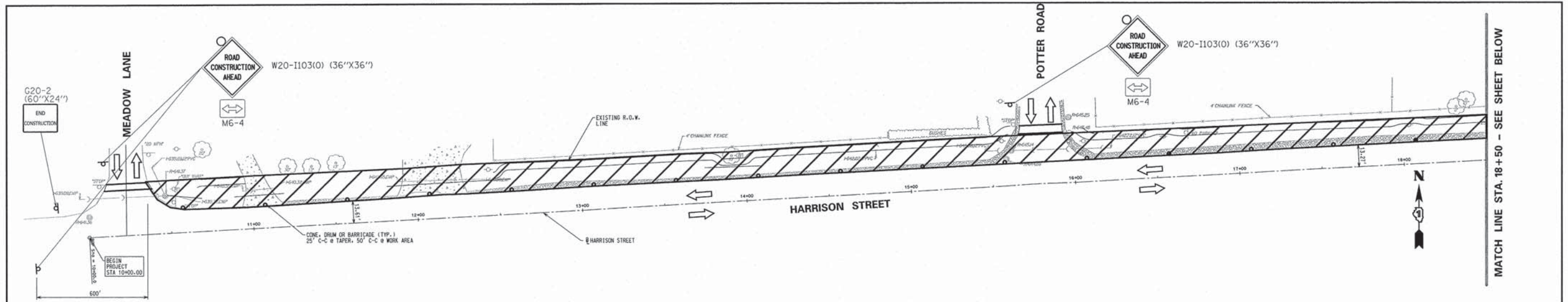

FILE NAME = 642L881CP01.dgn	USER NAME = JBUTCHER	DESIGNED -	REVISD -	<b>STATE OF ILLINOIS DEPARTMENT OF TRANSPORTATION</b>	<b>MAINTENANCE OF TRAFFIC PLAN</b>	F.A.U. RTE. 1300	SECTION 12-11100-90-SW	COUNTY COOK	TOTAL SHEETS 16	SHEET NO. 10		
PLOT SCALE = 29.9177' / in.	CHECKED -	REVISD -	SCALE:			SHEET OF SHEETS	STA. 10+00 TO STA. 24+27.2	CONTRACT NO. 63828				
PLOT DATE = 5/28/2013	DATE -	REVISD -	ILLINOIS FED. AID PROJECT									

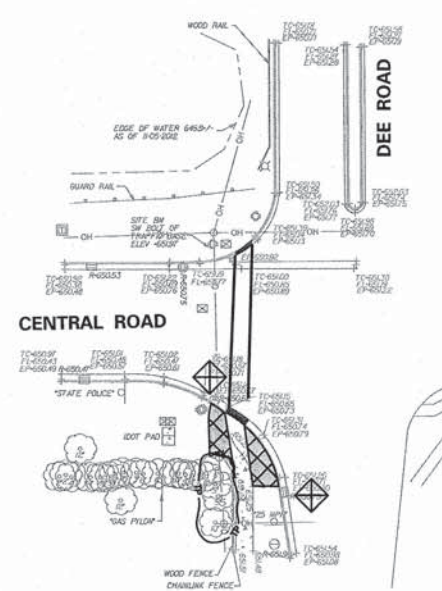
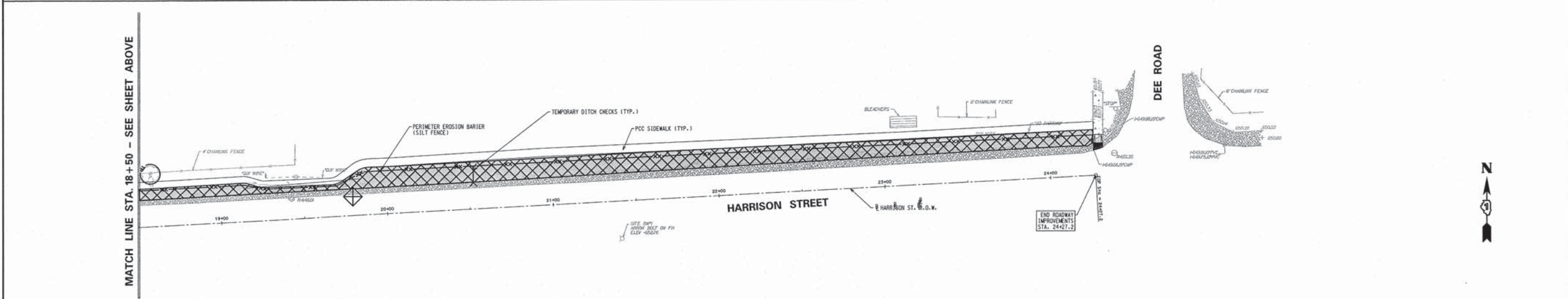
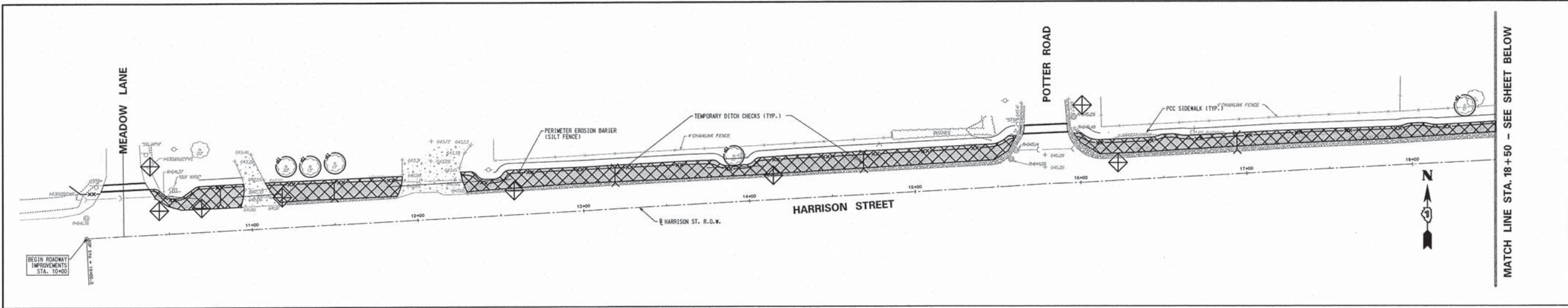

- LEGEND**
- XX— PERIMETER EROSION BARRIER
  - ◊ INLET AND PIPE PROTECTION
  - ▨ EROSION CONTROL BLANKET
  - ▩ SEEDING, CLASS 2A (SALT TOLERANT)
  - TREE TRUNK PROTECTION
  - Y Y TEMPORARY DITCH CHECKS



FILE NAME = 6421.08SE03.dgn	USER NAME = JBUTCHER	DESIGNED -	REVISED -	<b>STATE OF ILLINOIS DEPARTMENT OF TRANSPORTATION</b>	<b>EROSION CONTROL PLAN</b>	F.A.J. RTE. 1300	SECTION 12-11100-90-SW	COUNTY COOK	TOTAL SHEETS 16	SHEET NO. 11		
	PLOT SCALE = 29.9177' / 1" =	DRAWN -	REVISED -			SCALE: SHEET OF SHEETS STA. 10+00 TO STA. 24+27.2		CONTRACT NO. 63828				
	PLOT DATE = 5/28/2013	CHECKED -	REVISED -			ILLINOIS FED. AID PROJECT						
		DATE -	REVISED -									

N:\Project\6421\Safe Routes to School - Harrison Street\6421.08SE03.dgn D:\Ink User\JBUTCHER

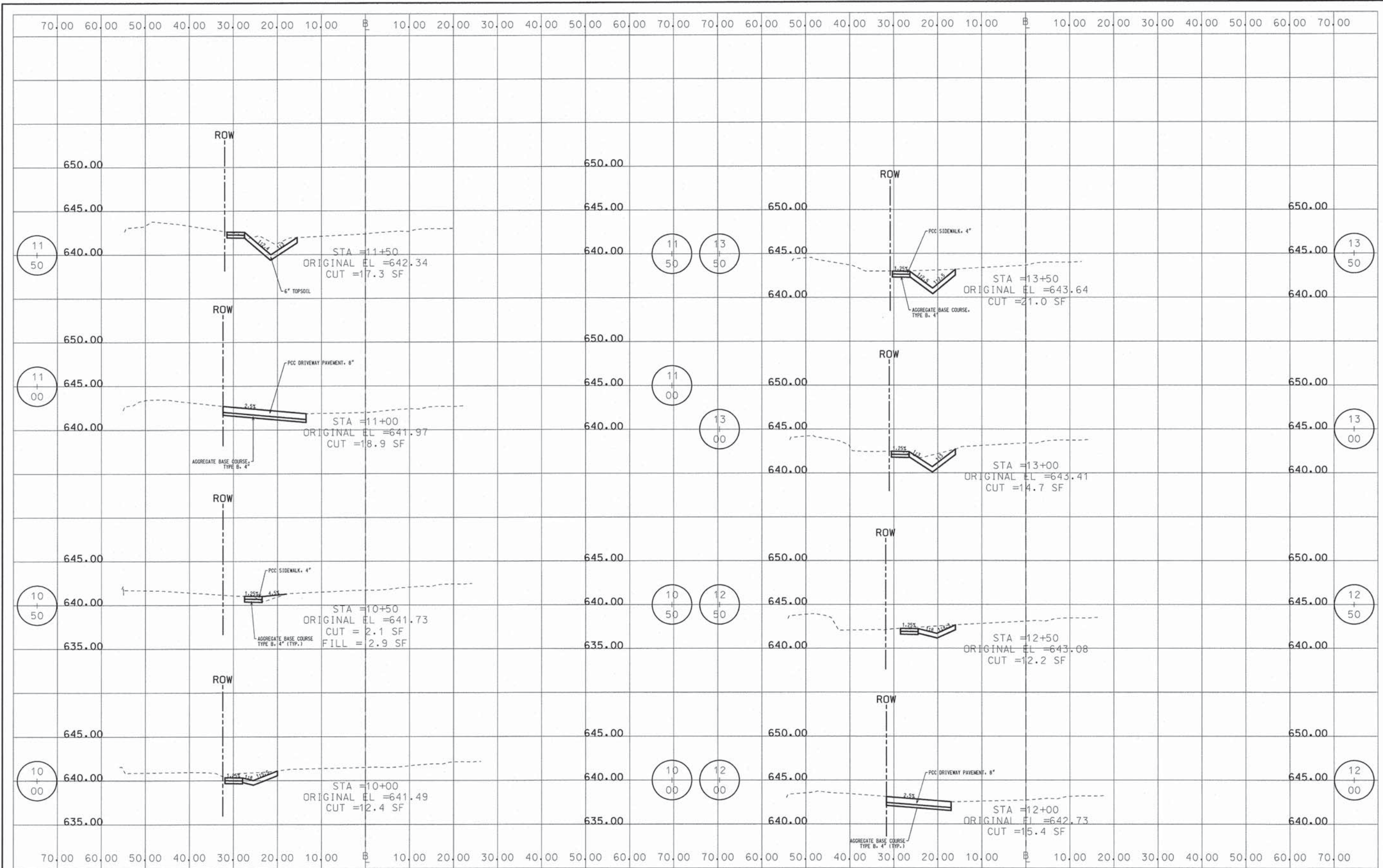

FILE NAME = 6821.84X501.DGN	USER NAME = JBUTCHER	DESIGNED -	REVISD -	<b>STATE OF ILLINOIS DEPARTMENT OF TRANSPORTATION</b>	<b>CROSS SECTIONS</b>	F.A.J. RTE. 1300	SECTION 12-11100-90-SW	COUNTY COOK	TOTAL SHEETS 16	SHEET NO. 12	
PLOT SCALE = 0.9973' / in.	CHECKED -	REVISD -	SCALE:			SHEET OF SHEETS	STA. 11+50 TO STA. 13+50	CONTRACT NO. 63828			
PLOT DATE = 5/28/2013	DATE -	REVISD -	ILLINOIS FED. AID PROJECT								

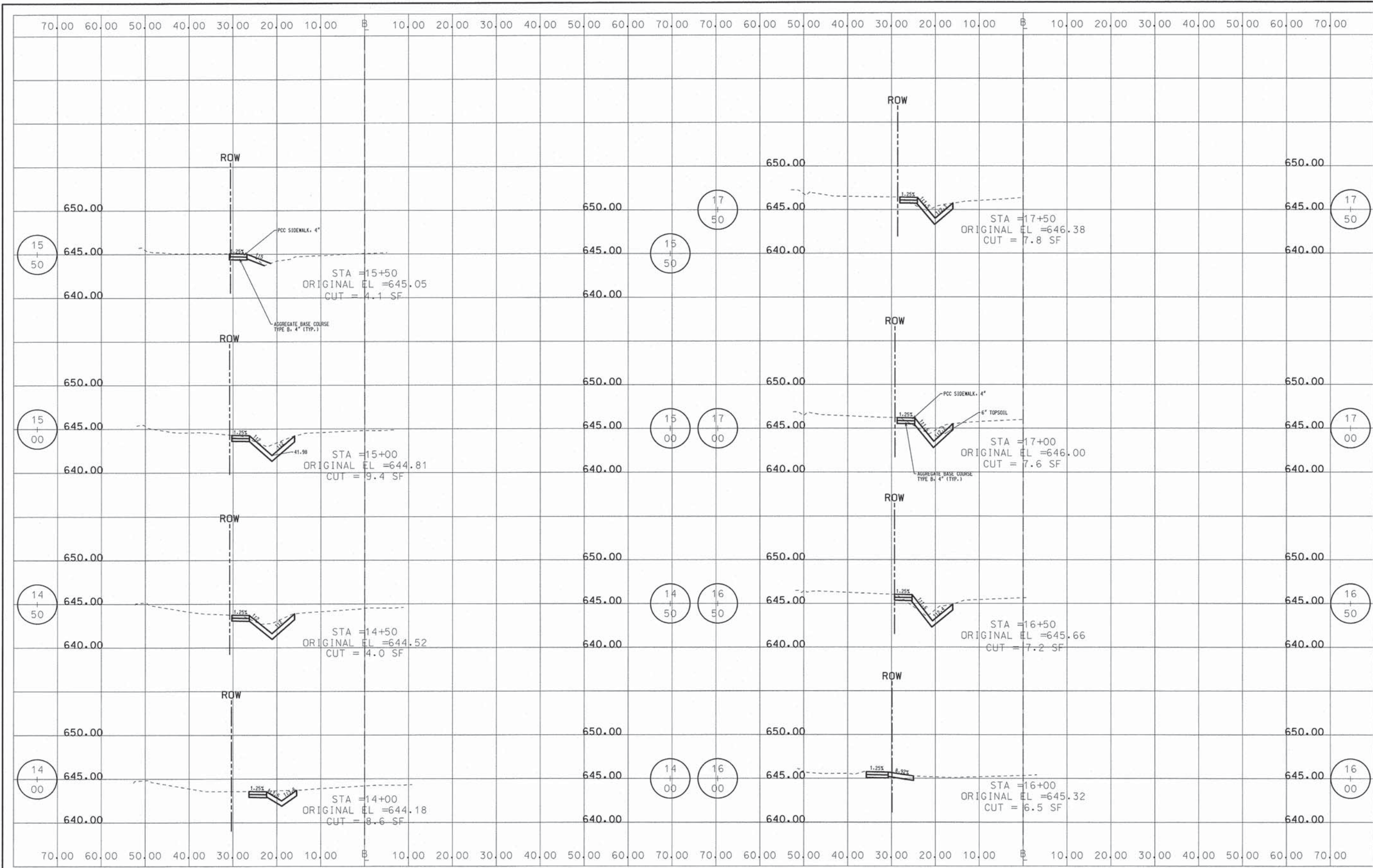

FILE NAME = 6821.04XS02.DGN	USER NAME = JBUTCHER	DESIGNED -	REVISED -	<b>STATE OF ILLINOIS DEPARTMENT OF TRANSPORTATION</b>	<b>CROSS SECTIONS</b>	F.A.U. RTE.	SECTION	COUNTY	TOTAL SHEETS	SHEET NO.	
	PLOT SCALE = 0.9973' / 1" =	DRAWN -	REVISED -			1300	12-11100-90-SW	COOK	16	13	
	PLOT DATE = 5/28/2013	CHECKED -	REVISED -			<b>CONTRACT NO. 63828</b>					
		DATE -	REVISED -			ILLINOIS FED. AID PROJECT					

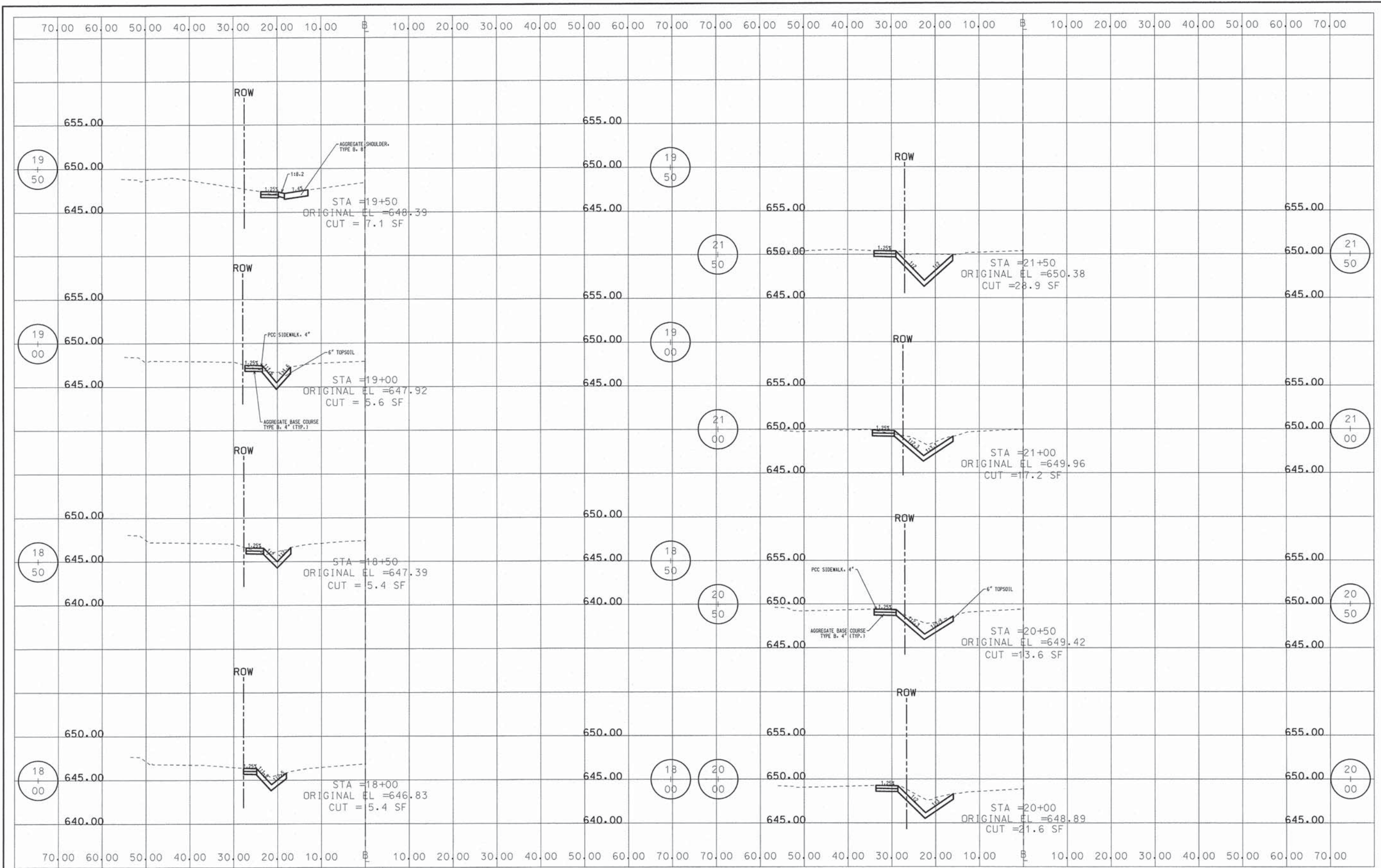

FILE NAME = 6821.04XS03.DGN	USER NAME = JBUTCHER	DESIGNED -	REVISED -	<b>STATE OF ILLINOIS DEPARTMENT OF TRANSPORTATION</b>	<b>CROSS SECTIONS</b>	F.A.U. RTE. 1300	SECTION 12-11100-90-SW	COUNTY COOK	TOTAL SHEETS 16	SHEET NO. 14	
PLOT SCALE = 0.9973' / in.	CHECKED -	REVISED -	SCALE:			SHEET OF SHEETS	STA. 18+00 TO STA. 21+50	<b>CONTRACT NO. 63828</b>		[ILLINOIS] FED. AID PROJECT	
PLOT DATE = 5/28/2013	DATE -	REVISED -									

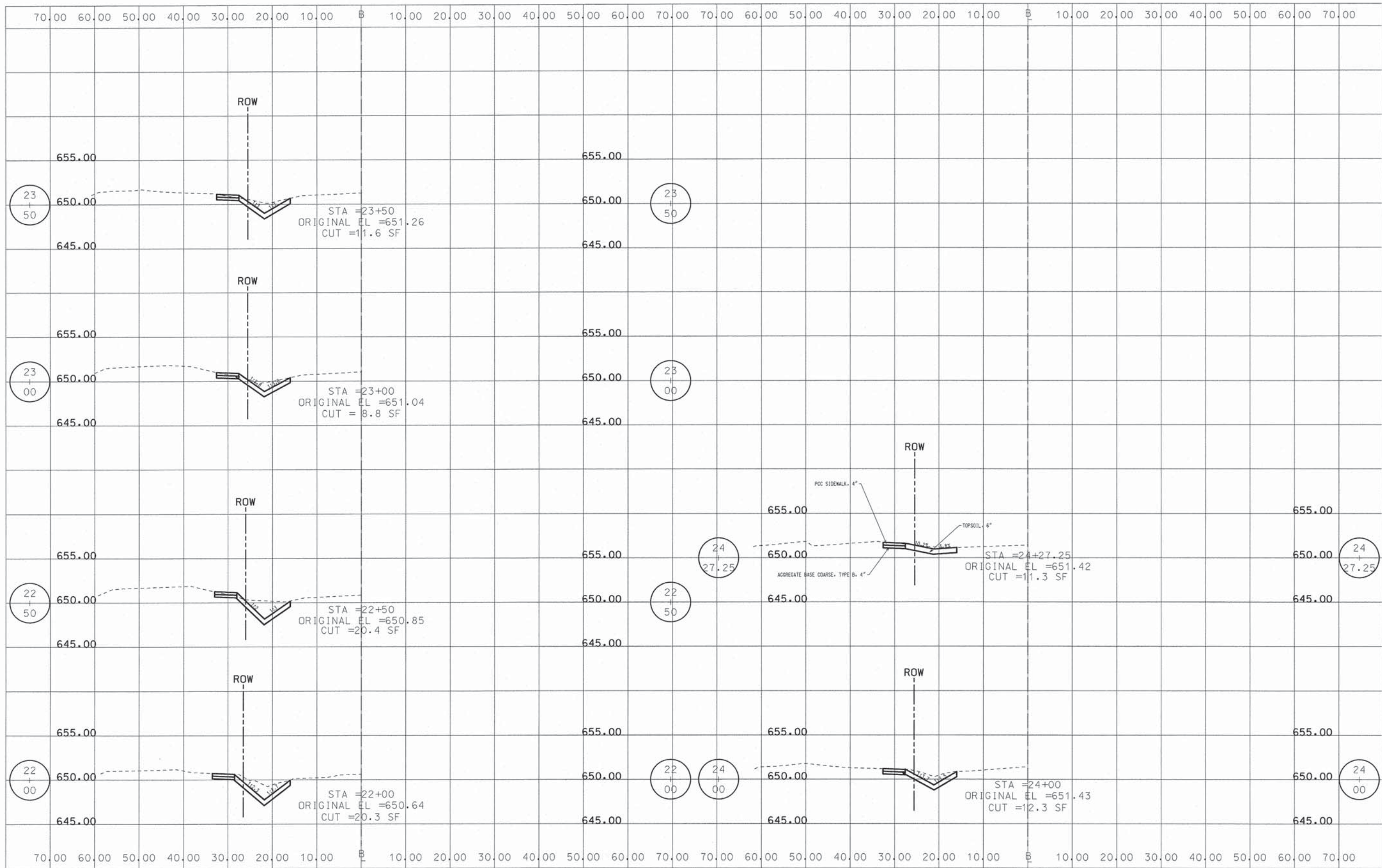

FILE NAME = 6821.84X584.DGN	USER NAME = JBUTCHER	DESIGNED -	REVISD -	<b>STATE OF ILLINOIS DEPARTMENT OF TRANSPORTATION</b>	<b>CROSS SECTIONS</b>			F.A.J.U. RTE.	SECTION	COUNTY	TOTAL SHEETS	SHEET NO.	
	PLOT SCALE = 0.9973' / 1" =	DRAWN -	REVISD -		SCALE:	SHEET	OF	SHEETS	1300	12-11100-90-SW	COOK	16	15
	PLOT DATE = 5/28/2013	CHECKED -	REVISD -		STA. 22+00	TO STA. 24+27.25	<b>CONTRACT NO. 63828</b>						
		DATE -	REVISD -		ILLINOIS FED. AID PROJECT								

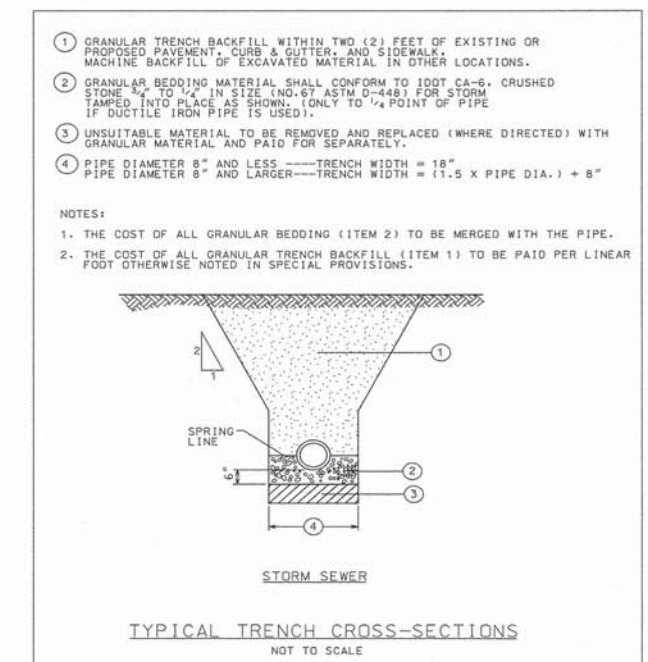
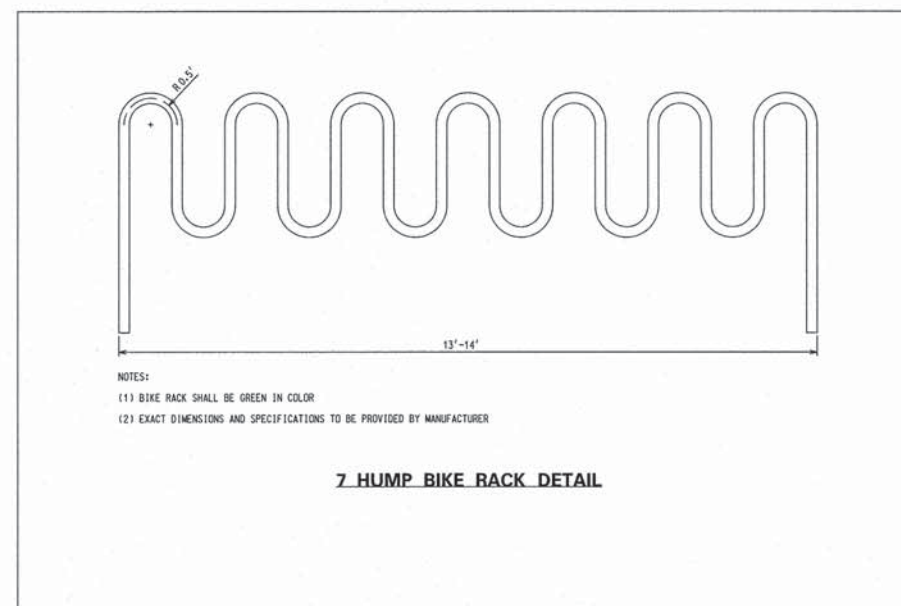
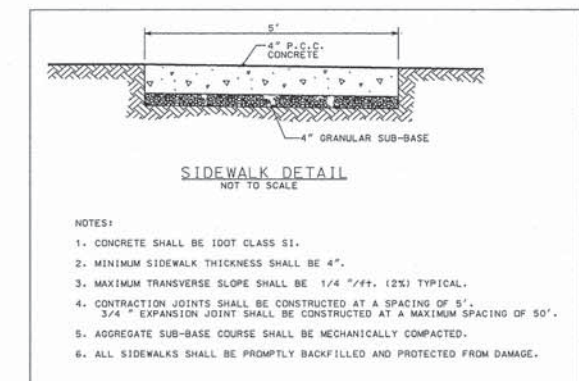
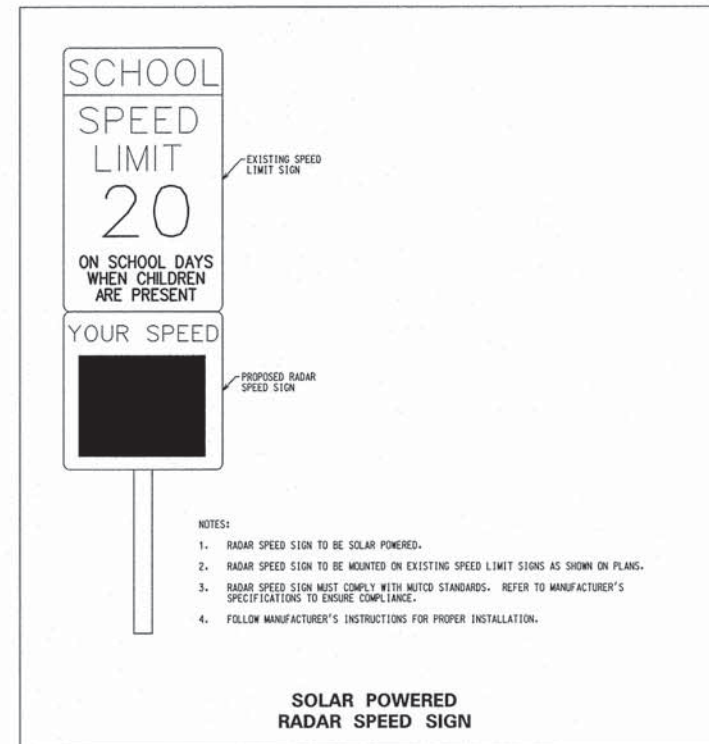

FILE NAME = 6421.880ET01.dgn	USER NAME = JBUTCHER	DESIGNED -	REVISED -
		DRAWN -	REVISED -
	PLOT SCALE = 0.9973' / in.	CHECKED -	REVISED -
	PLOT DATE = 5/28/2013	DATE -	REVISED -

**STATE OF ILLINOIS  
DEPARTMENT OF TRANSPORTATION**

**DETAILS**

SCALE: SHEET OF SHEETS STA. TO STA.

F.A.U. RTE.	SECTION	COUNTY	TOTAL SHEETS	SHEET NO.
1300	12-11100-90-SW	COOK	16	16
CONTRACT NO. 63828				
ILLINOIS FED. AID PROJECT				