

**IL ROUTE 3
EXISTING CROWN SECTION**
 STA. 774+92 TO STA. 791+23
 STA. 794+84 TO STA. 799+00
 STA. 805+71 TO STA. 808+52
 STA. 811+42 TO STA. 815+12
 STA. 816+63 TO STA. 827+90
 STA. 864+57 TO STA. 894+58
 *6' FROM STA. 810+52 TO STA. 815+57

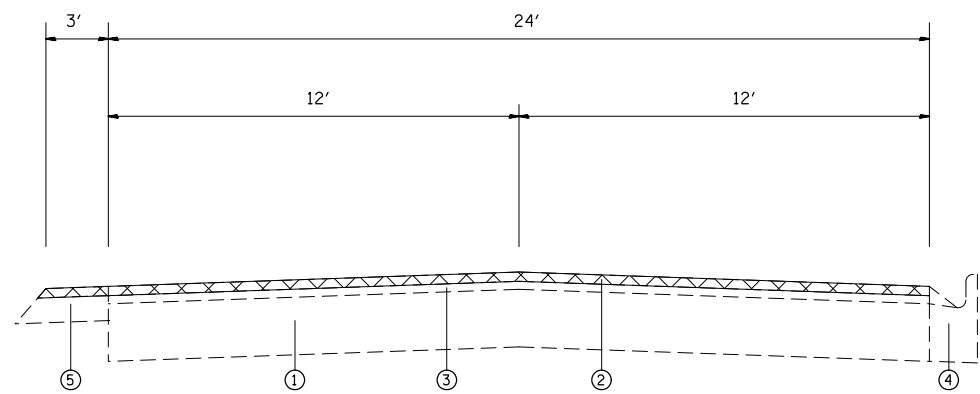

**IL ROUTE 3
EXISTING CROWN SECTION**
 STA. 838+89 TO STA. 842+18
 STA. 844+83 TO STA. 847+60
 STA. 851+00 TO STA. 893+87

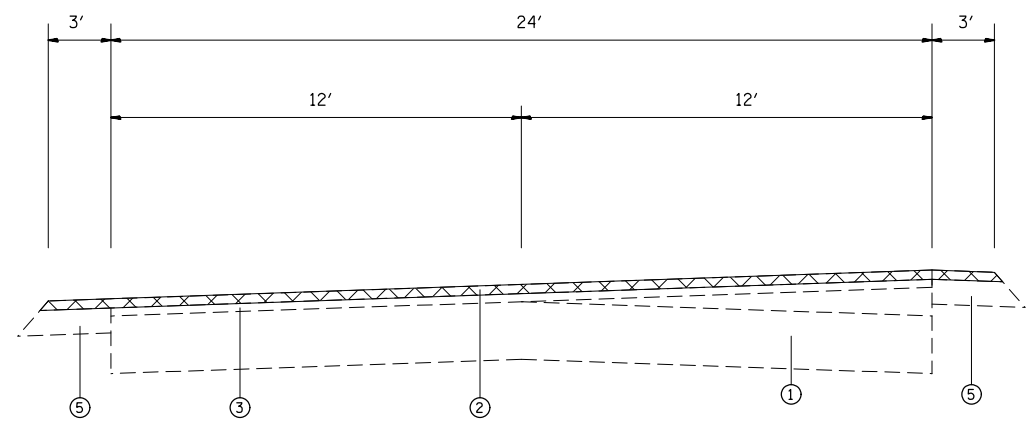

**IL ROUTE 3
EXISTING SUPERELEVATED SECTION**
 STA. 791+23 TO STA. 794+84
 STA. 815+12 TO STA. 816+63

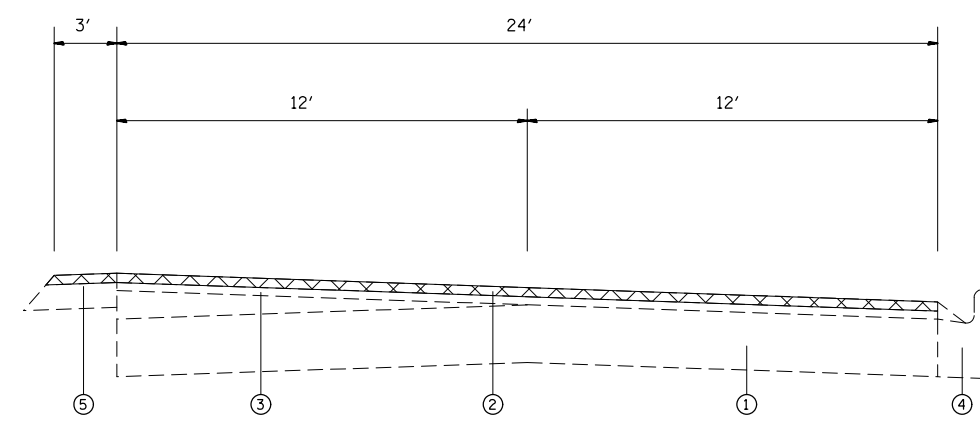

**IL ROUTE 3
EXISTING SUPERELEVATED SECTION**
 STA. 842+18 TO STA. 844+83

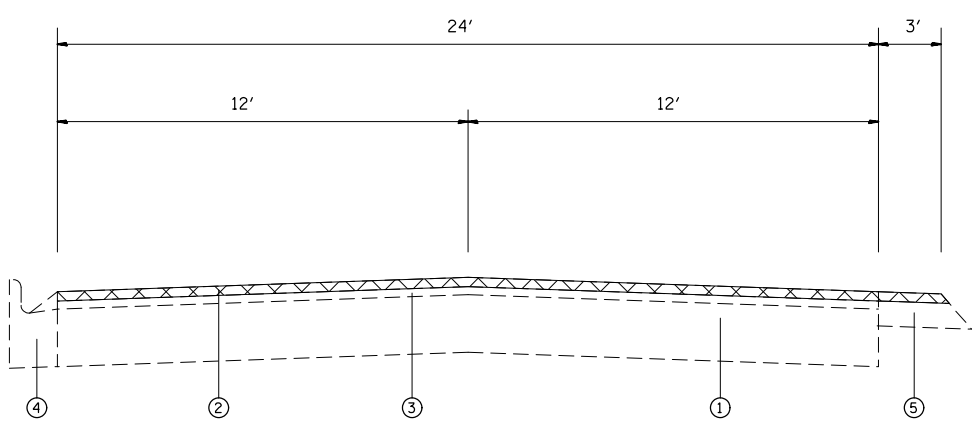

**IL ROUTE 3
EXISTING CROWN SECTION**
 STA. 827+90 TO STA. 839+89

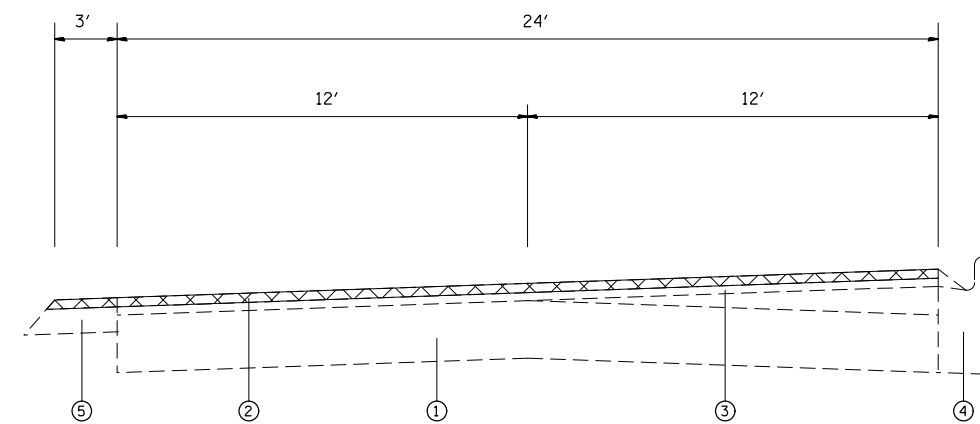

**IL ROUTE 3
EXISTING SUPERELEVATED SECTION**
 STA. 847+60 TO STA. 851+00

LEGEND

- 1. EXISTING PCC PAVEMENT
- 2. EXISTING BITUMINOUS CONCRETE SURFACE COURSE
- 3. EXISTING BITUMINOUS CONCRETE BINDER COURSE
- 4. EXISTING CURB AND GUTTER
- 5. EXISTING HMA SHOULDER
- 6. PROPOSED HMA SURFACE COURSE, 2 1/4"
- 7. PROPOSED BITUMINOUS MATERIAL (PRIME COAT)
- 8. PROPOSED AGGREGATE PRIME COAT
- 9. PROPOSED HMA SHOULDERS 2 1/4"

- HMA SURFACE REMOVAL 2 1/4"

FILE NAME =	USER NAME = millerra	DESIGNED -	REVISED -
et:\pw\work\p\dot\millerra\0338686\d876g36-sht-plan.dgn		DRAWN -	REVISED -
	PLOT SCALE = 100.0000' / 1in.	CHECKED -	REVISED -
	PLOT DATE = 5/10/2013	DATE -	REVISED -

**STATE OF ILLINOIS
DEPARTMENT OF TRANSPORTATION**

EXISTING TYPICALS
 SCALE: NTS SHEET NO. 1 OF 2 SHEETS STA. TO STA.

*ST. CLAIR AND MADISON			
F.A.U. RTE.	SECTION	COUNTY	TOTAL SHEETS
9166	510RS-3, 90RS-1	*	34
			SHEET NO. 6
CONTRACT NO. 76G36			
FED. ROAD DIST. NO.		ILLINOIS FED. AID PROJECT	