

STATE OF ILLINOIS
DEPARTMENT OF TRANSPORTATION

F.A.S. RTE.	SECTION	COUNTY	TOTAL SHEETS	SHEET NO.
1768	(117) OFF STREET PARKING	MONTGOMERY	16	1
		ILLINOIS	CONTRACT: 72L08	

FOR INDEX OF SHEETS, SEE SHEET NO. 2

PROPOSED HIGHWAY PLANS

(NB) FAS 1768, (FR I-55 EAST)
SECTION (117) OFF STREET PARKING
MONTGOMERY COUNTY

C-96-040-19

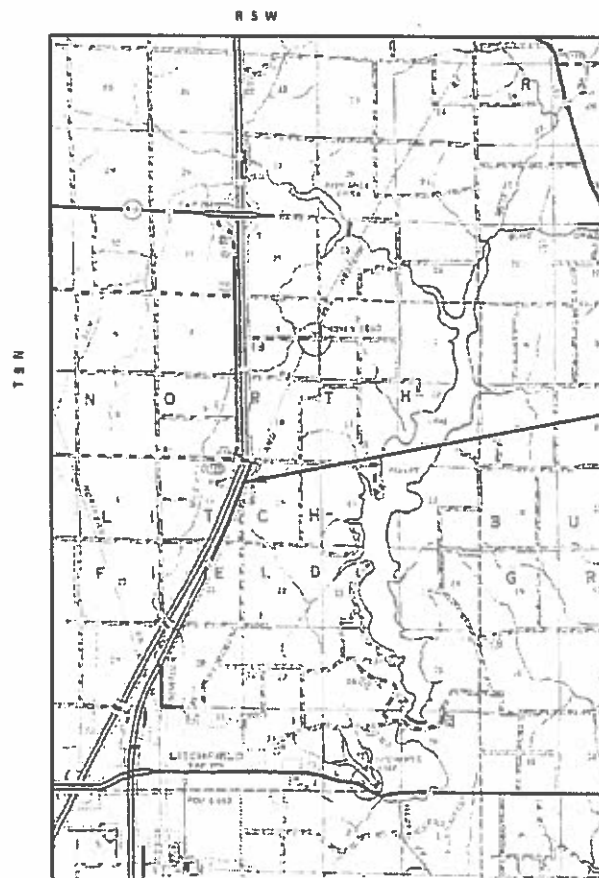

ADT: 950
HCV: 170
SU: 150
MU: 20

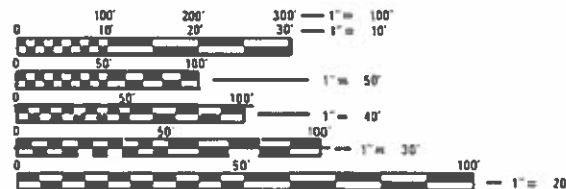

FULL SIZE PLANS HAVE BEEN PREPARED USING STANDARD ENGINEERING SCALES. REDUCED SIZED PLANS WILL NOT CONFORM TO STANDARD SCALES. IN MAKING MEASUREMENTS ON REDUCED PLANS, THE ABOVE SCALES MAY BE USED.

J.U.L.I.E.
JOINT UTILITY LOCATION INFORMATION FOR EXCAVATION
1-800-892-0123
OR 811

PROJECT ENGINEER : MIKE IRWIN - (217)524-7765
PROJECT MANAGER : TIMOTHY SHARP - (217)524-9160

CONTRACT NO. 72L08

GROSS LENGTH = 1,100 FT. = 0.20 MILE
NET LENGTH = 1,100 FT. = 0.20 MILE

STATE OF ILLINOIS
DEPARTMENT OF TRANSPORTATION
DIVISION OF HIGHWAYS

SUBMITTED May 16 2019
John P. Moran
REGION FOUR ENGINEER

June 20 2019
Paul J. Moran
ENGINEER OF DESIGN AND ENVIRONMENT

June 28 2019
Paul J. Moran
DIRECTOR OF HIGHWAYS PROJECT IMPLEMENTATION

PRINTED BY THE AUTHORITY
OF THE STATE OF ILLINOIS

GENERAL NOTES

GENERAL NOTES

- ① THE CONTRACTOR SHALL KEEP PUBLIC STREET PAVEMENTS CLEAN OF DIRT AND DEBRIS.
- ② ADDITIONAL AREAS USED FOR STORAGE MUST BE REVIEWED BY THE ENGINEER PRIOR TO USE. ALL AREAS USED SHALL BE RESTORED TO ORIGINAL CONDITION AND TO THE SATISFACTION OF THE PROPERTY OWNER.
- ③ CONTRACTOR SHALL PROVIDE ADEQUATE DRAINAGE AND EROSION PROTECTION FOR THE DURATION OF THIS PROJECT.
- ④ SEEDING WILL BE BY IDOT.
- ⑤ NO EXCAVATION ANTICIPATED ON THIS PROJECT WHICH WOULD AFFECT UTILITIES. SHOULD ANY EXCAVATION BE REQUIRED, J.U.L.I.E. (800-892-0123) SHALL BE NOTIFIED A MINIMUM OF 48 HOURS IN ADVANCE.
- ⑥ NO EXCAVATED MATERIAL WILL BE ALLOWED TO LEAVE THE SITE.
- ⑦ THE CONTRACTOR SHALL ERECT EROSION BARRIER AROUND THE PARKING LOT, PATH AND OBSERVATION PAD TO KEEP EQUIPMENT AND PEOPLE FROM DISTURBING THE NATIVE PRAIRIE. THE EROSION BARRIER SHALL BE ON BOTH SIDES OF THE PATH 20' FROM CENTER LINE AND 15' FROM THE EDGE OF THE PARKING LOT AND OBSERVATION PAD.
- ⑧ ALL WORK AND EQUIPMENT PARKING SHALL BE COMPLETED WITHIN THE CONSTRUCTION LIMITS. THE LIMITS SHALL BE DEFINED WITH THE INSTALLATION OF THE EROSION BARRIER.
- ⑨ THERE WILL BE A MANDATORY MEETING OF I.D.O.T. PERSONNEL AND ALL CONTRACTORS AT THE CONSTRUCTION SITE PRIOR TO THE BEGINNING OF CONSTRUCTION.

COMMITMENTS



(NONE)

INDEX OF SHEETS

1	COVER SHEET
2	INDEX OF SHEETS, LISTS OF STANDARDS, GENERAL NOTES AND COMMITMENTS
3	SUMMARY OF QUANTITIES
4	SCHEDULE OF QUANTITIES
5	LOCATION
6	TYPICAL SECTIONS
7	PARKING LOT DETAILS AND STAKING PLAN
8	JOINTING PLAN
9-10	PLAN & PROFILE
11-15	CROSS SECTIONS
16	BOLLARD, DETAIL SHEET

STANDARDS

00001-07	STANDARD SYMBOLS, ABBREVIATIONS, AND PATTERNS
001006	DECIMAL OF AN INCH AND OF A FOOT
420001-09	PAVEMENT JOINTS
542301-03	PRECAST REINFORCED CONCRETE END SECTIONS
701006-05	OFF ROAD OP-2L2W-15 FT TO EOP
701201-05	LANE CLOSURE 2L2W-DAY ONLY
701901-08	TRAFFIC CONTROL DEVICES
780001-05	TYPICAL PAVEMENT MARKINGS

STATE OF ILLINOIS DEPARTMENT OF TRANSPORTATION DIVISION OF HIGHWAYS DISTRICT 6	
EXAMINED <u>15 May</u>	20 <u>19</u>
 ENGINEER OF OPERATIONS	
EXAMINED <u>15 May</u>	20 <u>19</u>
 ENGINEER OF PROJECT IMPLEMENTATION	
EXAMINED <u>May 14</u>	20 <u>19</u>
 ENGINEER OF PROGRAM DEVELOPMENT	

REV. - MS

**STATE OF ILLINOIS
DEPARTMENT OF TRANSPORTATION**

INDEX, STANDARDS, SIGNATURES

F.A.I. RTE.	SECTION	COUNTY	TOTAL SHEETS	SHEET NO.
1768	(117) OFF STREET PARKING	MONTGOMERY	16	2
CONTRACT NO. 72L08				
ILLINOIS FED. AID PROJECT				

SCALE: NIS SHEET 1 OF 1 SHEETS STA. _____ TO STA. _____

MODEL: E:\admin\...
 FILE NAME: ...
 USER NAME: ...
 PLOT DATE: 5/16/2019

USER NAME = sharpta	DESIGNED - BSC	REVISED - _____
	DRAWN - BSC	REVISED - _____
PLOT SCALE = 40 0000 / in.	CHECKED - _____	REVISED - _____
PLOT DATE = 5/16/2019	DATE - _____	REVISED - _____

0-02122-6001
100% STATE
MONTGOMERY

CODE NO.	ITEM	UNIT	TOTAL QUANTITY	ROADWAY	
				0044	RURAL
20200100	EARTH EXCAVATION	CU YD	349	349	
28000400	PERIMETER EROSION BARRIER	FOOT	2500	2500	
31101180	SUBBASE GRANULAR MATERIAL, TYPE B 2"	SQ YD	1062	1062	
31101400	SUBBASE GRANULAR MATERIAL, TYPE B 6"	SQ YD	1338	1338	
42000100	PORTLAND CEMENT CONCRETE PAVEMENT 6"	SQ YD	1338	1338	
42400100	PORTLAND CEMENT CONCRETE SIDEWALK 4 INCH	SQ FT	9550	9550	
48102100	AGGREGATE WEDGE SHOULDER, TYPE B	TON	165	165	
542A0223	PIPE CULVERT, CLASS A, TYPE 1 18"	FOOT	44	44	
54213663	PRECAST REINFORCED CONCRETE FLARED END SECTION 18"	EACH	2	2	
67100100	MOBILIZATION	L SUM	1	1	
70100450	TRAFFIC CONTROL AND PROTECTION, STANDARD 701201	L SUM	1	1	
* 78001100	PAINT PAVEMENT MARKING - LETTERS AND SYMBOLS	SQ FT	52	52	
* 78001110	PAINT PAVEMENT MARKING - LINE 4"	FOOT	610	610	
X0301430	PRECAST CONCRETE PARKING BLOCK	EACH	12	12	
X0322135	BOLLARDS, QUICK RELEASE	EACH	1	1	
* X0322330	HANDICAP SIGN	EACH	2	2	
Z0004002	BOLLARDS	EACH	2	2	

* SPECIALTY ITEM

MODEL: D:\work\100\100000\100000.dwg
 FILE NAME: 100000.dwg
 USER: sharptd
 PLOT DATE: 5/17/2019

REV. - MS

USER NAME = sharptd	DESIGNED - _____	REVISED - _____
PLOT SCALE = 100 0000 / in	DRAWN - _____	REVISED - _____
PLOT DATE = 5/17/2019	CHECKED - _____	REVISED - _____
	DATE - _____	REVISED - _____

**STATE OF ILLINOIS
DEPARTMENT OF TRANSPORTATION**

SUMMARY OF QUANTITY	
SCALE _____	SHEET _____ OF _____ SHEETS
STA _____	TO STA _____

F.A. RTE.	SECTION	COUNTY	TOTAL SHEETS	SHEET NO.
1768	(117) OFF STREET PARKING	MONTGOMERY	16	3
CONTRACT NO. 72LOB			ILLINOIS FED. AID PROJECT	

SUBBASE Granular Material, Type B 2"				
LOCATION	START	END	GROSS LENGTH	SQ. FT.
PATH	12+60	21+25	865	8650
PAD	21+25	21+55	30	900
			TOTAL SQ YD	1062

SUBBASE Granular Material, Type B 4"				
LOCATION	START	END	GROSS LENGTH	SQ. FT.
PARKING	1132+85	1131+17	198	12042
			TOTAL SQ YD	1338

PORTLAND CEMENT CONCRETE PAVEMENT, 6"				
LOCATION	START	END	GROSS LENGTH	SQ. FT.
PARKING	1132+85	1131+17	198	12042
			TOTAL SQ YD	1338

PORTLAND CEMENT CONCRETE SIDEWALK, 4"				
LOCATION	START	END	GROSS LENGTH	SQ. FT.
PATH	12+60	21+25	865	8650
PAD	21+25	21+55	30	900
			TOTAL SQ FT	9550

AGGREGATE WEDGE SHOULDER, TYPE B 2'				
LOCATION	START	END	CU. YD	TONS
VAR.	1132+85	21+57	80.3	166
			TOTAL TONS	166

OTHER ITEMS				
LOCATION		UNIT		TOTAL
MOBILIZ.		L SUM		1
BOLLARDS		EA		2

EARTHWORK			
		EARTHWORK VOL. CU. YD	
LOCATION	STATION	CUT	FILL
PARKING LOT	1131+17		
PARKING LOT		21.50	43.90
PARKING LOT	1131+50		
PARKING LOT		16.60	12.50
PARKING LOT	1132+00		
PARKING LOT		26.60	45.60
PARKING LOT	1132+50		
PARKING LOT		67.40	39.40
PARKING LOT	1132+85		
PATH	12+60		
PATH		12.00	20.10
PATH	13+30		
PATH		11.20	0.00
PATH	13+65		
PATH		9.10	0.00
PATH	14+00		
PATH		12.80	0.00
PATH	14+50		
PATH		14.30	0.80
PATH	15+00		
PATH		9.90	1.70
PATH	15+50		
PATH		3.30	3.40
PATH	16+00		
PATH		1.00	4.90
PATH	16+50		
PATH		3.60	3.50
PATH	17+00		
PATH		7.80	2.20
PATH	17+50		
PATH		9.30	1.60
PATH	18+00		
PATH		11.90	0.60
PATH	18+50		
PATH		14.10	0.00
PATH	19+00		
PATH		14.40	0.00
PATH	19+50		
PATH		17.40	0.00
PATH	20+00		
PATH		21.00	0.00
PATH	20+50		
PATH		21.50	0.00
PATH	21+00		
PAD	21+30		
PAD		22.40	0.00
PAD	21+50		
		TOT. CU. YD.	349 180

I:\0621 Drawn
 FILE NAME: p:\p2\2010\Documents\1001 Office\Drawings\6106\CAD\Drawings\72L08 SHI SCHEDULE OF QUANTITY.dwg

USER NAME = nosalherenk	DESIGNED - _____	REVISED - _____
PLOT SCALE = 100 0000 / ft	DRAWN - _____	REVISED - _____
PLOT DATE = 5/2/2019	CHECKED - _____	REVISED - _____
	DATE - _____	REVISED - _____

**STATE OF ILLINOIS
DEPARTMENT OF TRANSPORTATION**

SCHEDULE OF QUANTITY

SCALE _____ SHEET ____ OF ____ SHEETS STA _____ TO STA _____

F.A. RTE.	SECTION	COUNTY	TOTAL SHEETS	SHEET NO.
1768	(117) OFF STREET PARKING	MONTGOMERY	16	4
				CONTRACT NO. 72L08
ILLINOIS FED AID PROJECT				



PROJECT LOCATION

FILE NAME =	USER NAME = sharptd	DESIGNED - DMS	REVISED - _____
pw\planroom\dot.illinois.gov\PIW100T\Documents\DOT Offices\District 6\Projects\0672L\DRAN\to\CA0\sheet\MSL08-shr-5-location		CHECKED - _____	REVISED - _____
Default	PLOT DATE = 5/15/2019	DATE - 5-13-2013	REVISED - _____

**STATE OF ILLINOIS
DEPARTMENT OF TRANSPORTATION**

PROJECT LOCATION

SCALE: _____ SHEET _____ OF _____ SHEETS STA. _____ TO STA. _____

F.A.S. RTE.	SECTION	COUNTY	TOTAL SHEETS	SHEET NO.
1768	(117) OFF STREET PARKING	MONTGOMERY	16	5
CONTRACT NO. T2L08				
ILLINOIS FED. AID PROJECT				

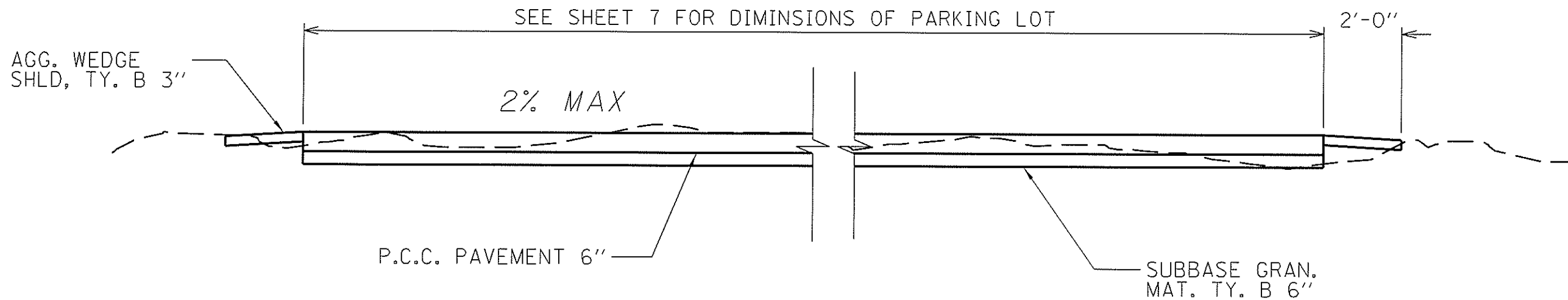

TYPICAL CROSS SECTION OF PARKING LOT

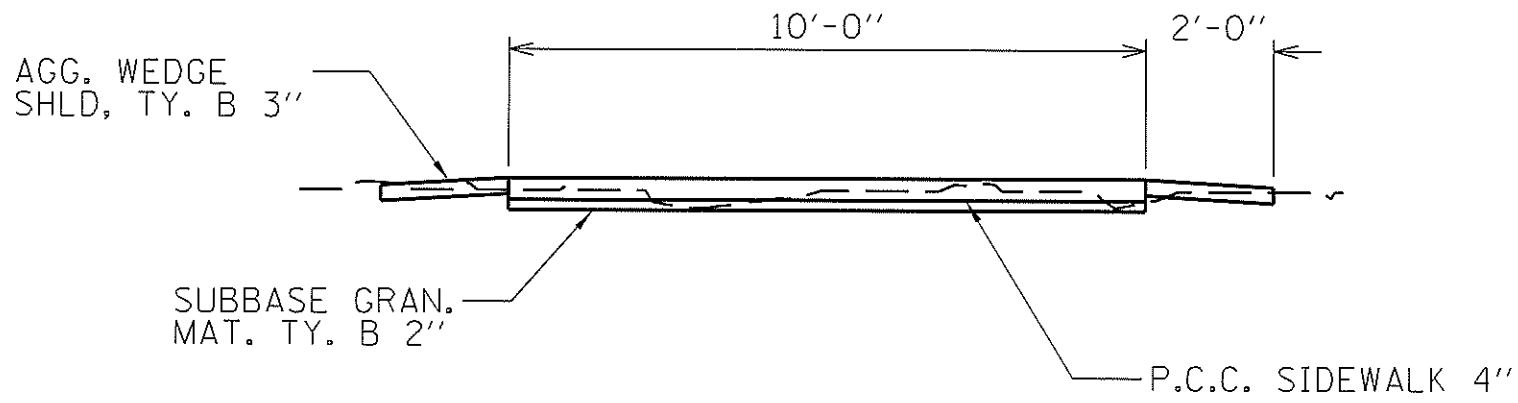

TYPICAL CROSS SECTION OF SIDEWALK
STA 12+60 TO 21+23.82

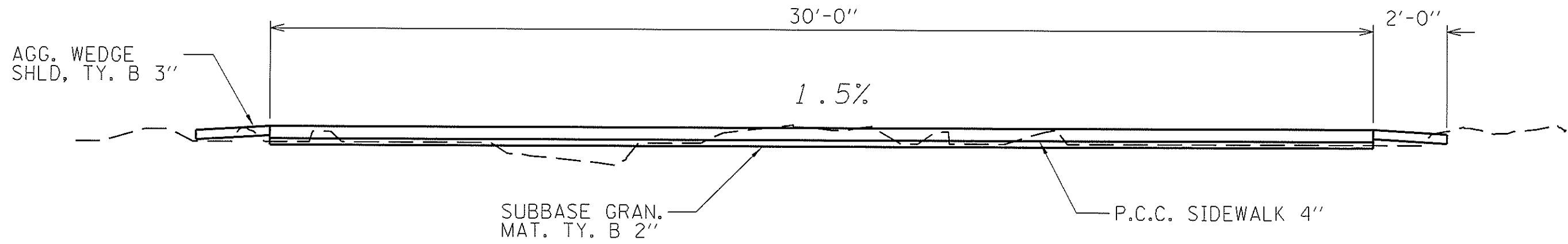

TYPICAL CROSS SECTION OBSERVATION PAD
STA. 21+23.82 TO 21+53.96

FILE NAME	USER NAME = sharptd	DESIGNED - OMS	REVISED -	STATE OF ILLINOIS DEPARTMENT OF TRANSPORTATION	TYPICAL	F.A.S. RTE.	SECTION	COUNTY	TOTAL SHEETS	SHEET NO.
1768	1171 OFF STREET PARKING	MONTGOMERY	16			6				
CONTRACT NO. 72L08										
SCALE:	SHEET	OF	SHEETS	STA.	TO STA.	ILLINOIS FED. AID PROJECT				

PARKING LOT

AGG SHOULDERS, 2'

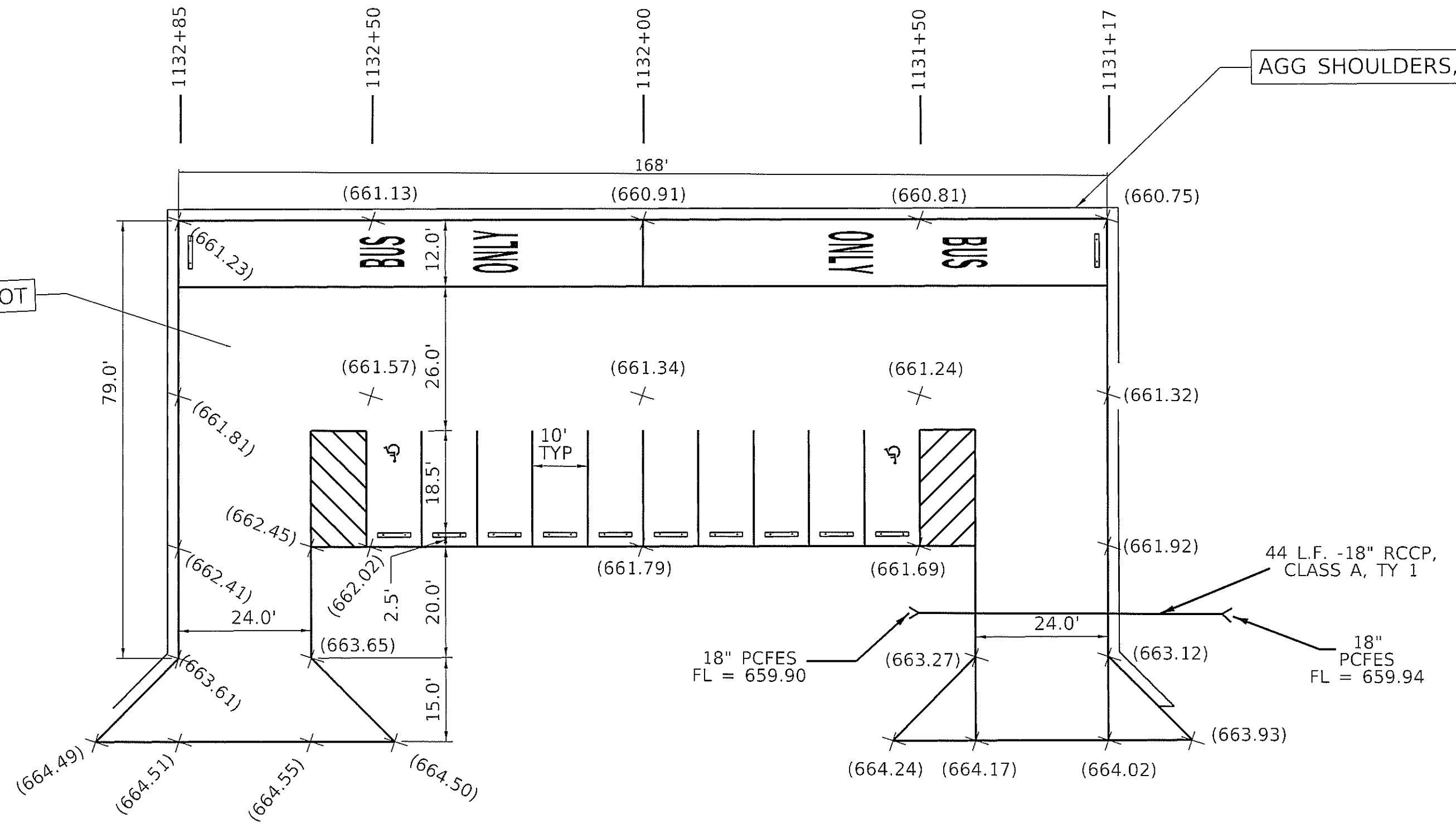

H:\CADD\2019\117\117-001\117-001-001\117-001-001-001.dwg
 USER: sharpid
 PLOT DATE: 5/15/2019

USER NAME = sharpid	DESIGNED - _____	REVISED - _____
PLOT SCALE = 100 0000 / in	DRAWN - _____	REVISED - _____
PLOT DATE = 5/15/2019	CHECKED - _____	REVISED - _____
	DATE - _____	REVISED - _____

**STATE OF ILLINOIS
DEPARTMENT OF TRANSPORTATION**

PARKING LOT DETAILS AND STAKING PLAN

SCALE _____ SHEET ____ OF ____ SHEETS STA _____ TO STA _____

F.A.S. RTE.	SECTION	COUNTY	TOTAL SHEETS	SHEET NO.
176B	(117) OFF STREET PARKING	MONTGOMERY	16	7
CONTRACT NO. 72L08				
ILLINOIS FED AID PROJECT				

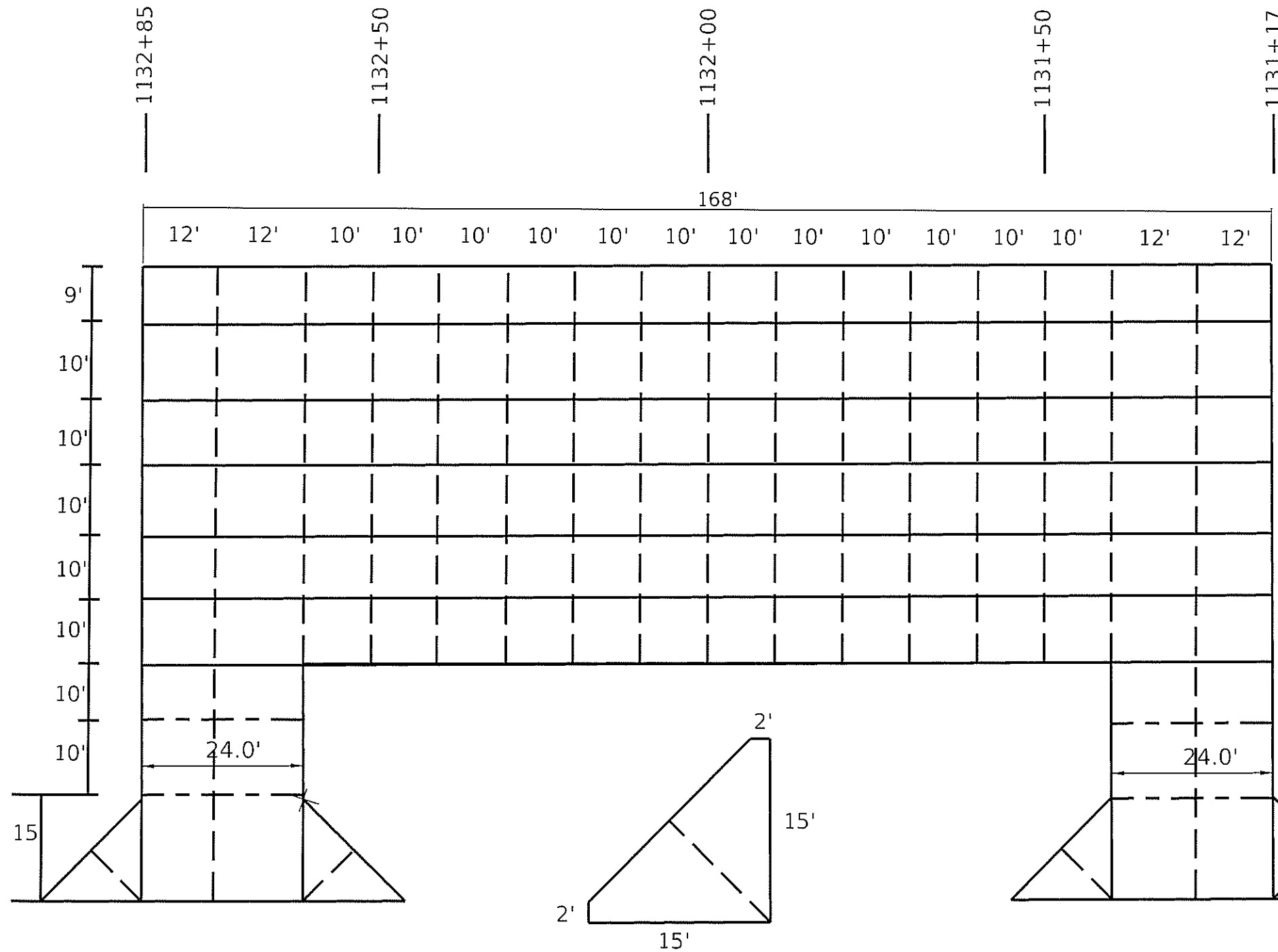

JOINTING PLAN
LEGEND

- LONGITUDINAL KEYED JOINT
- - - LONGITUDINAL SAWED JOINT
- - - - TRANSVERSE CONTRACTION JOINT

FLARED ENTRANCE APRON
DETAIL

N:\GDEL Option 3
 FILE NAME: \\saw\p17001\Documents\DOT Office\Bids\1616\1616172108\1616172108_101_8_JOINTING_PLAN.dwg

USER NAME = sharpjd	DESIGNED - _____	REVISED - _____
PLOT SCALE = 1/8" = 100'-0"	DRAWN - _____	REVISED - _____
PLOT DATE = 5/15/2019	CHECKED - _____	REVISED - _____
	DATE - _____	REVISED - _____

STATE OF ILLINOIS
DEPARTMENT OF TRANSPORTATION

PARKING LOT DETAILS AND JOINTING PLAN
SCALE _____ SHEET ____ OF ____ SHEETS STA _____ TO STA _____

F.A.S. RTE.	SECTION	COUNTY	TOTAL SHEETS	SHEET NO.
1768	(117) OFF STREET PARKING	MONTGOMERY	16	8
CONTRACT NO. 72L08				
ILLINOIS FED. AID PROJECT				

PLAN	SURVEYED	BY	DATE
	ADJUSTMENT CHECKED		
	FIELD BOOK		
	NO. 101		
	NO. 102		
	NO. 103		
	NO. 104		
	NO. 105		
	NO. 106		
	NO. 107		
	NO. 108		
	NO. 109		
	NO. 110		

PROFILE	SURVEYED	BY	DATE
	GRADES CHECKED		
	NOTE BOOK		
	NO. 101		
	NO. 102		
	NO. 103		
	NO. 104		
	NO. 105		
	NO. 106		
	NO. 107		
	NO. 108		
	NO. 109		
	NO. 110		

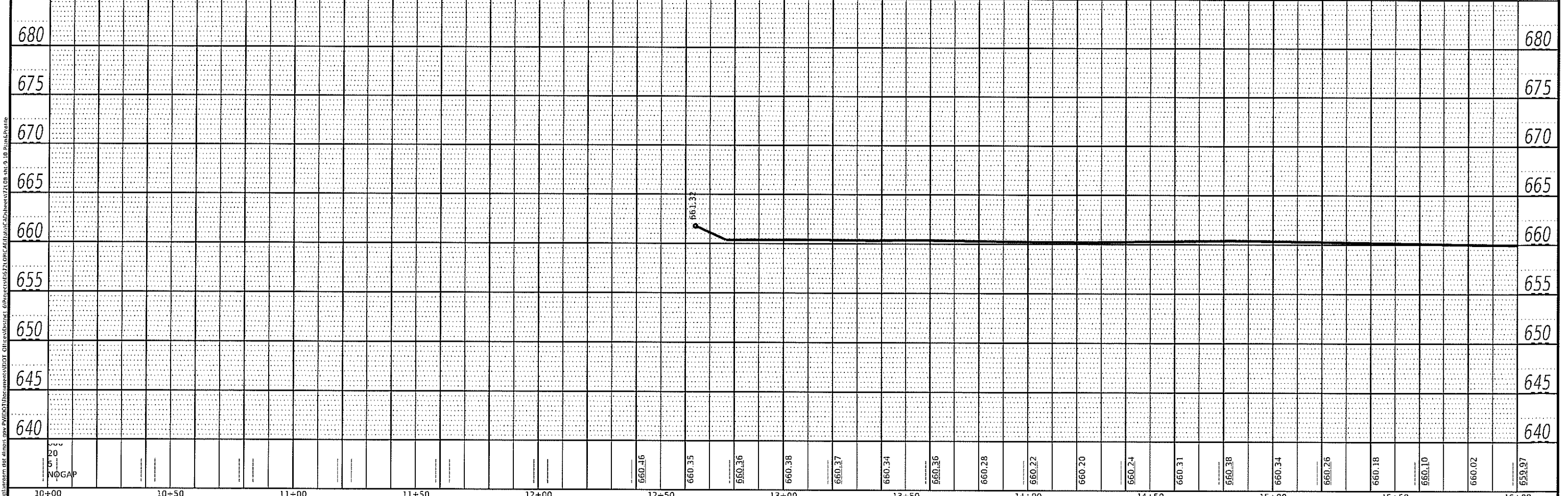
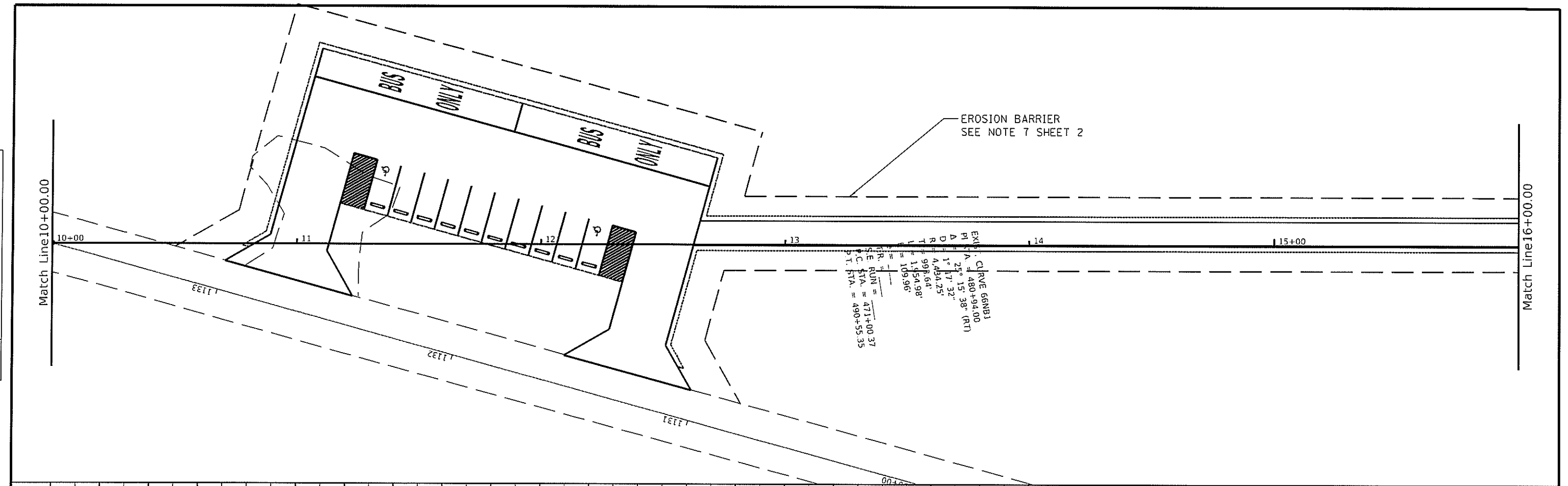

MODEL: Default
 FILE NAME: \\server\projects\1672\1672.dwg
 USER: sharprd
 DATE: 5/15/2019 10:10:10 AM
 PLOT DATE: 5/15/2019

USER NAME = sharprd	DESIGNED -	REVISED -
PLOT SCALE = 40 0000 / 1 in.	DRAWN -	REVISED -
PLOT DATE = 5/15/2019	CHECKED -	REVISED -
	DATE -	REVISED -

STATE OF ILLINOIS
DEPARTMENT OF TRANSPORTATION

PLAN AND PROFILE
 SCALE _____ SHEET _____ OF _____ SHEETS
 STA. _____ TO STA. _____

F.A. RTE. 1768	SECTION (117) OFF STREET PARKING	COUNTY MONTGOMERY	TOTAL SHEETS 16	SHEET NO. 9
CONTRACT NO. 72L08				
ILLINOIS FED. AID PROJECT				

PLAN	SURVEYED	BY	DATE
	ADJUSTED		
	NOTED		
	REVISIONS		
	FILE NAME		

PROFILE	SURVEYED	BY	DATE
	ADJUSTED		
	NOTED		
	REVISIONS		
	FILE NAME		

I:\Projects\1768\1768.dwg
 USER: shajprtd
 DATE: 5/15/2019
 PLOT SCALE: 40' = 1"

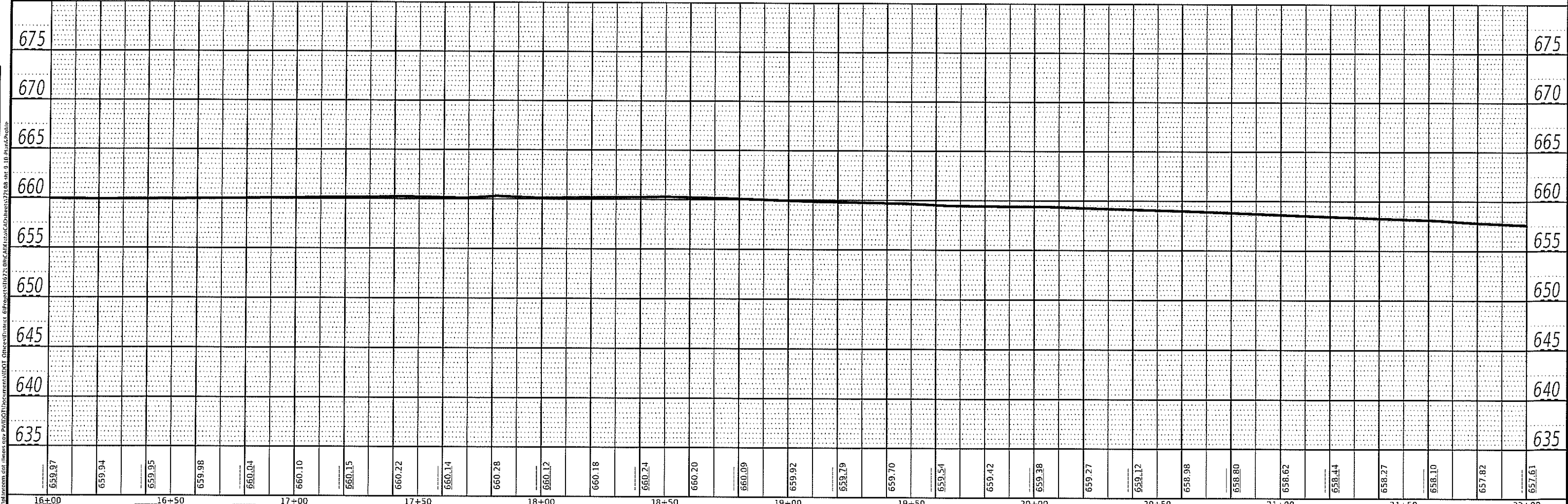
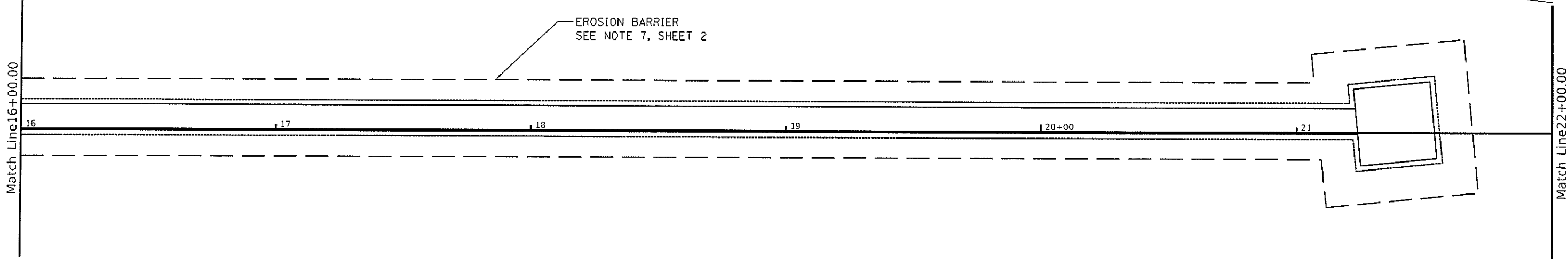

USER NAME = shajprtd PLOT SCALE = 40' = 1" PLOT DATE = 5/15/2019	DESIGNED - _____ DRAWN - _____ CHECKED - _____ DATE - _____	REVISED - _____ REVISED - _____ REVISED - _____ REVISED - _____	STATE OF ILLINOIS DEPARTMENT OF TRANSPORTATION	PLAN AND PROFILE SCALE _____ SHEET _____ OF _____ SHEETS STA _____ TO STA _____	F.A. RTE. 1768 SECTION (117) OFF STREET PARKING COUNTY MONTGOMERY TOTAL SHEETS 16 SHEET NO. 10 CONTRACT NO. 72L08 ILLINOIS FED AID PROJECT
--	--	--	---	---	--

DATE	
BY	
DESIGNED	
DRAWN	
CHECKED	
REVISIONS	
AREA	
PERCENT	
AREA	
CHECKED	

DATE	
BY	
DESIGNED	
DRAWN	
CHECKED	
REVISIONS	
AREA	
PERCENT	
AREA	
CHECKED	

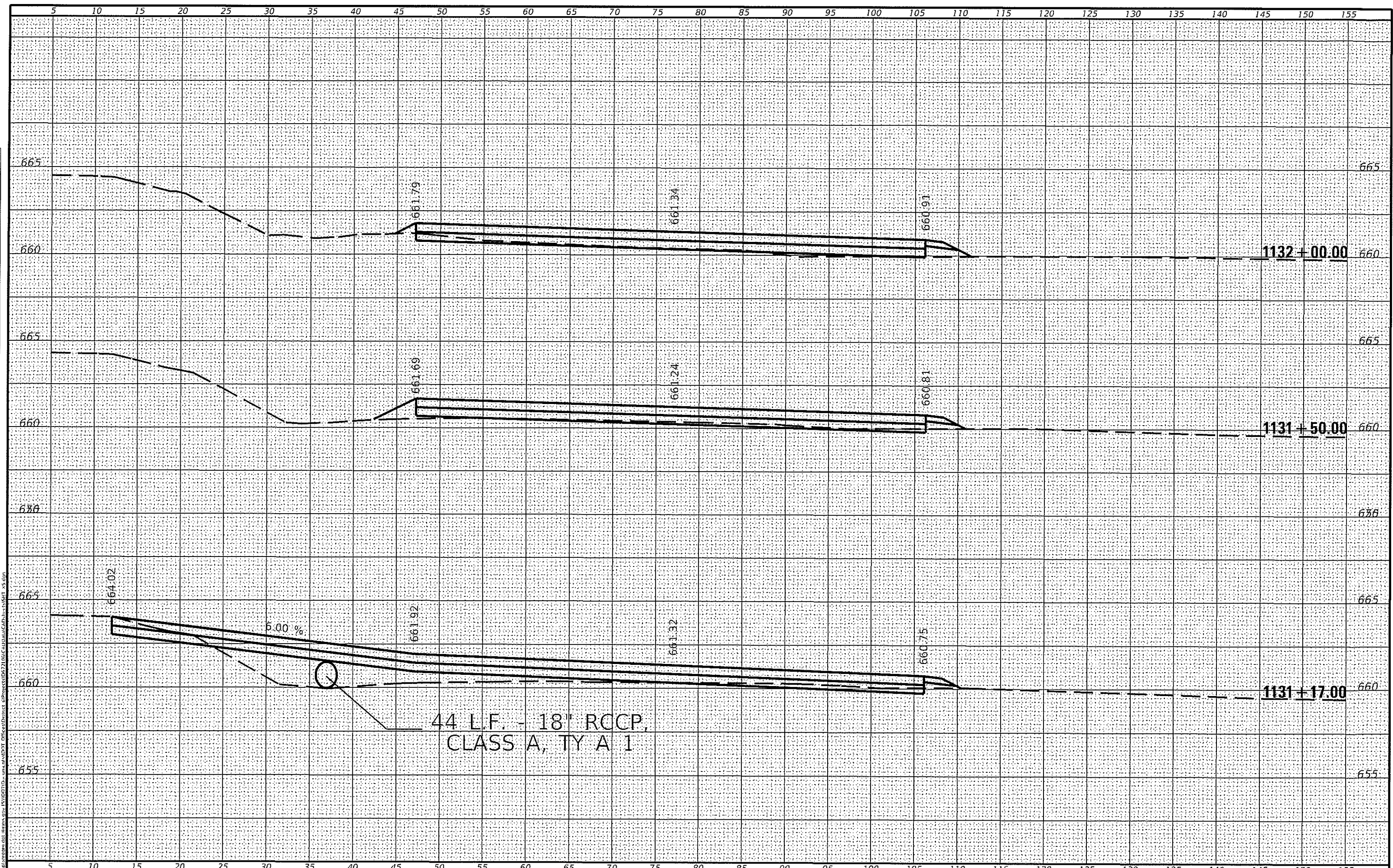

44 L.F. - 18" RCCP,
CLASS A, TY A 1

5.00 %

1132+00.00

1131+50.00

1131+17.00

MODEL: D:\rail

USFR NAME = sharptd	DESIGNED - _____	REVISIONS - _____
PLOT SCALE = 10.0000' / in	DRAWN - _____	REVISIONS - _____
PLOT DATE = 5/2/2019	CHECKED - _____	REVISIONS - _____
	DATE - _____	REVISIONS - _____

STATE OF ILLINOIS
DEPARTMENT OF TRANSPORTATION

PARKING LOT - CROSS SECTIONS
SCALE _____ SHEET _____ OF _____ SHEETS STA 1131+17.00 TO STA. 1132+00.00

F.A. RTE.	SECTION	COUNTY	TOTAL SHEETS	SHEET NO
1768	(177) OFF STREET PARKING	MONTGOMERY	16	11
CONTRACT NO. 72L08			ILLINOIS FED. AID PROJECT	

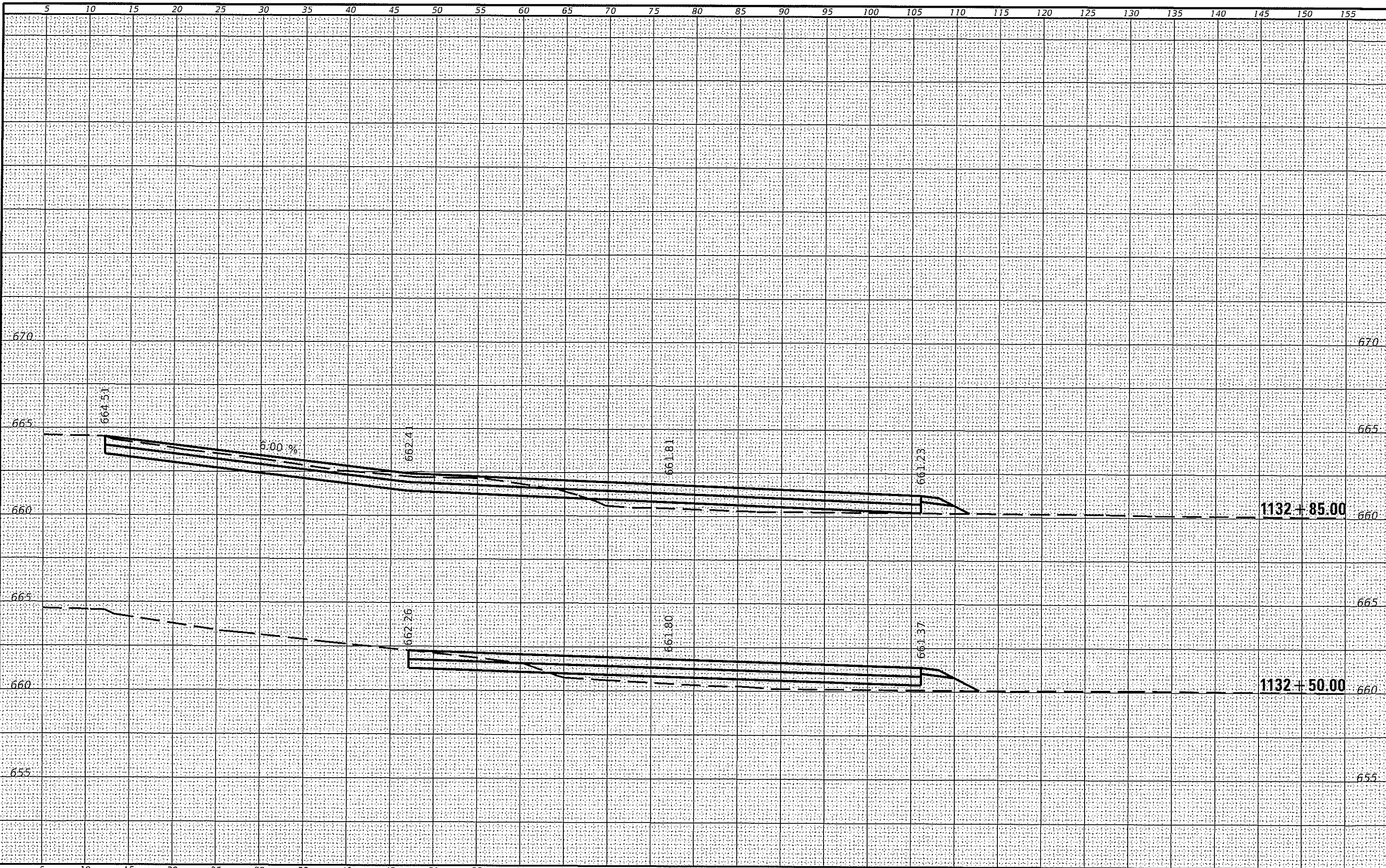

DATE	
BY	
PROJECT NO.	
PROJECT NAME	
DATE PLOTTED	
SCALE	
AREA CHECKED	
BY	
DATE	

DATE	
BY	
PROJECT NO.	
PROJECT NAME	
DATE PLOTTED	
SCALE	
AREA CHECKED	
BY	
DATE	

USPR NAME = sharots	DESIGNED - _____	REVISED - _____
	DRAWN - _____	REVISED - _____
PLOT SCALE = 10 0000 / in	CHECKED - _____	REVISED - _____
PLOT DATE = 5/2/2019	DATE - _____	REVISED - _____

**STATE OF ILLINOIS
DEPARTMENT OF TRANSPORTATION**

PARKING LOT - CROSS SECTIONS

SCALE _____ SHEET ___ OF ___ SHEETS STA 1132+50.00 TO STA. 1132+85.00

F.A. RTE.	SECTION	COUNTY	TOTAL SHEETS	SHEET NO.
178	(117) OFF STREET PARKING	MONTGOMERY	16	12
CONTRACT NO. 72L08				
ILLINOIS FED. AID PROJECT				

FINAL SURVEY	SURVAYED	DATE
NOTE BOOK	PLOTTED	
NO.	TEMPERATURE	
	AREA	
	ANGLS	
	ERRORS	

ORIGINAL SURVEY	SURVAYED	DATE
NOTE BOOK	PLOTTED	
NO.	TEMPERATURE	
	AREA	
	ANGLS	
	ERRORS	

MODEL: D:\csh\l...
 FILE NAME: p:\1768\1768.dwg
 USER: j...
 DATE: 5/2/2019

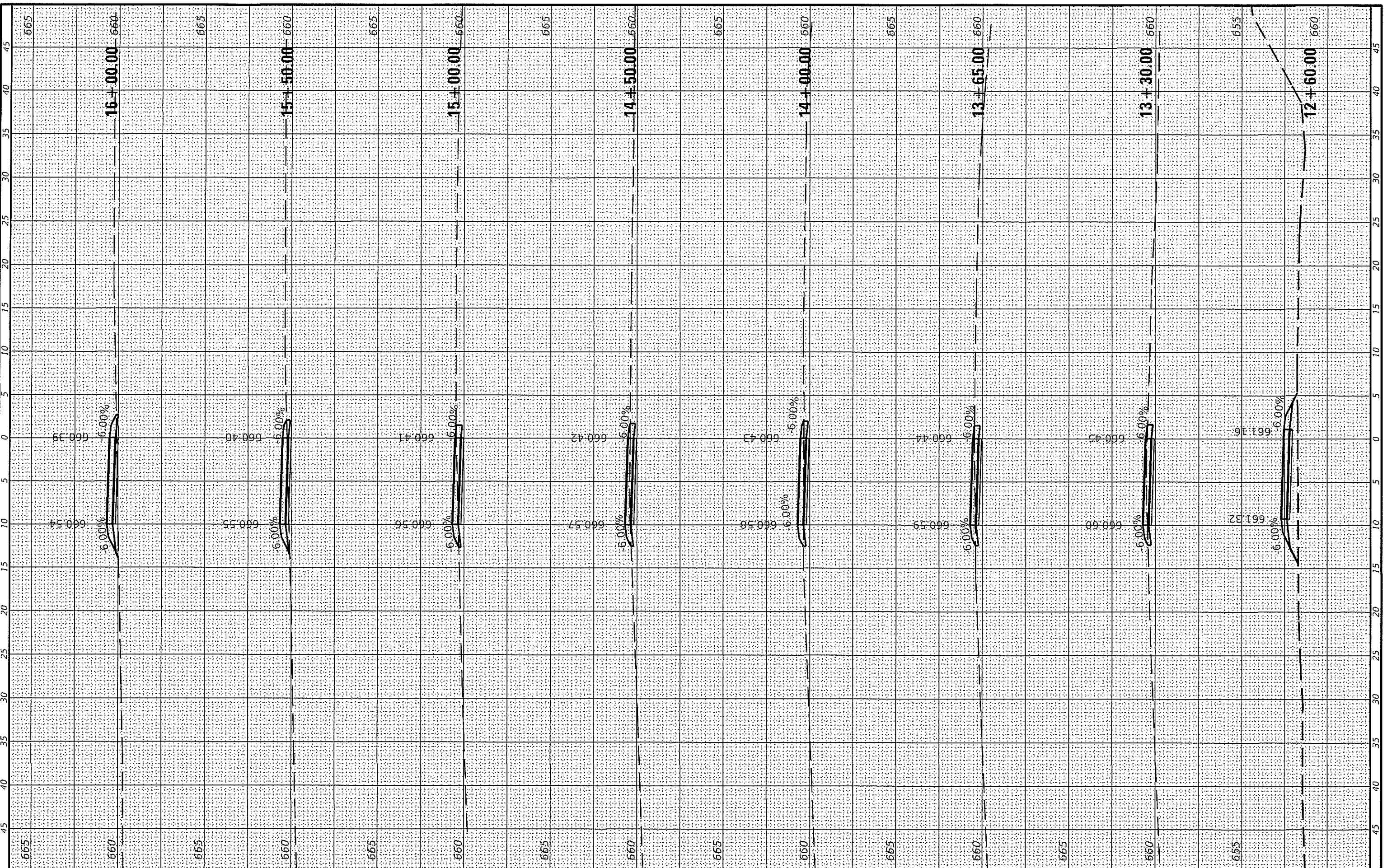

USER NAME = j...	DESIGNED -	REVISED -
PLOT SCALE = 10 0000 / 1 in	DRAWN -	REVISED -
PLOT DATE = 5/2/2019	CHECKED -	REVISED -
	DATE -	REVISED -

**STATE OF ILLINOIS
DEPARTMENT OF TRANSPORTATION**

CROSS SECTIONS - PATH

SCALE: _____ SHEET _____ OF _____ SHEETS STA. 13+30.00 TO STA. 16+00.00

F.A. RTE.	SECTION	COUNTY	TOTAL SHEETS	SHEET NO.
1768	(117) OFF STREET PARKING	MONTGOMERY	16	13
CONTRACT NO. 72L08			ILLINOIS FED AID PROJECT	

ORIGINAL SURVEY	NUMBERED	BY	DATE
NOTE BOOK	PLOTTED		
AREAS	TEMPLATE		
CREATED	AREAS		
SELECTED			

ORIGINAL SURVEY	NUMBERED	BY	DATE
NOTE BOOK	PLOTTED		
AREAS	TEMPLATE		
CREATED	AREAS		
SELECTED			

MODEL Default
 FILE NAME: I:\Information\GIS\Illnesses\proj\AVI\AVI0101.dwg
 USER: sharptd
 PROJECT: 1768 (117) OFF STREET PARKING
 SHEET: 16 OF 14
 CONTRACT NO. 72108

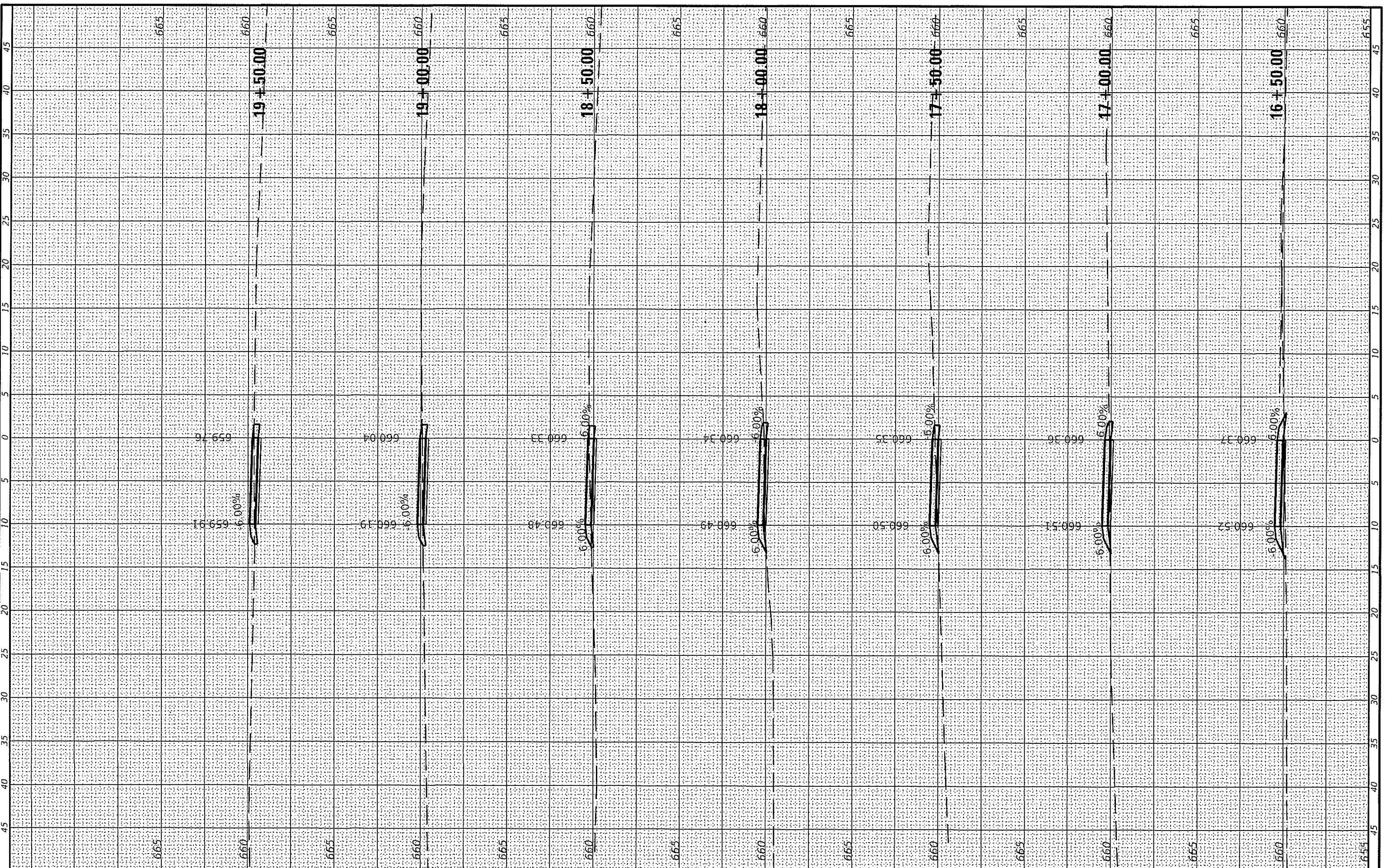

USER NAME = sharptd	DESIGNED -	REVISD -
PLOT SCALE = 10.0116 / in.	DRAWN -	REVISD -
PLOT DATE = 5/2/2019	CHECKED -	REVISD -
	DATE -	REVISD -

STATE OF ILLINOIS
 DEPARTMENT OF TRANSPORTATION

CROSS SECTIONS - PATH
 SCALE: _____ SHEET _____ OF _____ SHEETS STA. 16+50.00 TO STA. 19+50.00

F.A. RTE.	SECTION	COUNTY	TOTAL SHEETS	SHEET NO.
1768	(117) OFF STREET PARKING	MONTGOMERY	16	14
CONTRACT NO. 72108				
ILLINOIS FED AID PROJECT				

FINAL	SURVEYED	BY	DATE
SHEET	PLOTTED		
NOTE BOOK	TEMPLATE		
NO.	AREA'S CHECKED		

ORIGINAL	DATE
SHEET	
NOTE BOOK	
NO.	

MODEL D:\root\mcs\1768\1768.dwg PLOT DATE: 5/2/2019
1768\1768.dwg PLOT DATE: 5/2/2019

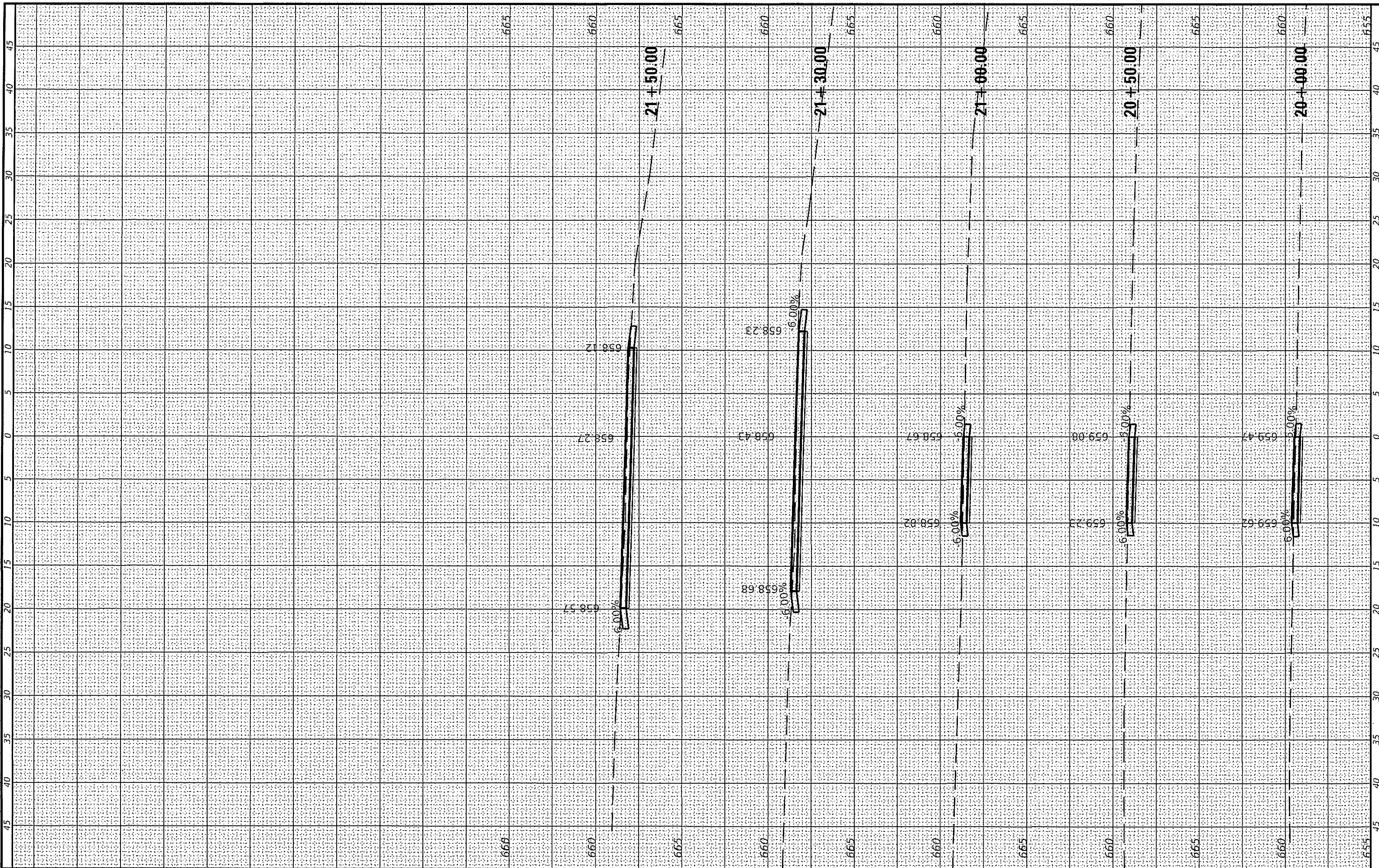

USER NAME = sharpid	DESIGNED - _____	REVISED - _____
PLOT SCALE = 10 0116 / in.	DRAWN - _____	REVISED - _____
PLOT DATE = 5/2/2019	CHECKED - _____	REVISED - _____
	DATE - _____	REVISED - _____

STATE OF ILLINOIS
DEPARTMENT OF TRANSPORTATION

CROSS SECTIONS - PAD, PATH

SCALE: _____ SHEET _____ OF _____ SHEETS STA. 20+00.00 TO STA. 22+00.00

F.A.	SECTION	COUNTY	TOTAL	SHEET
RTE. 1768	(117) OFF STREET PARKING	MONTGOMERY	SHEETS 16	NO. 15
CONTRACT NO. 72108				
ILLINOIS FED. AID PROJECT				

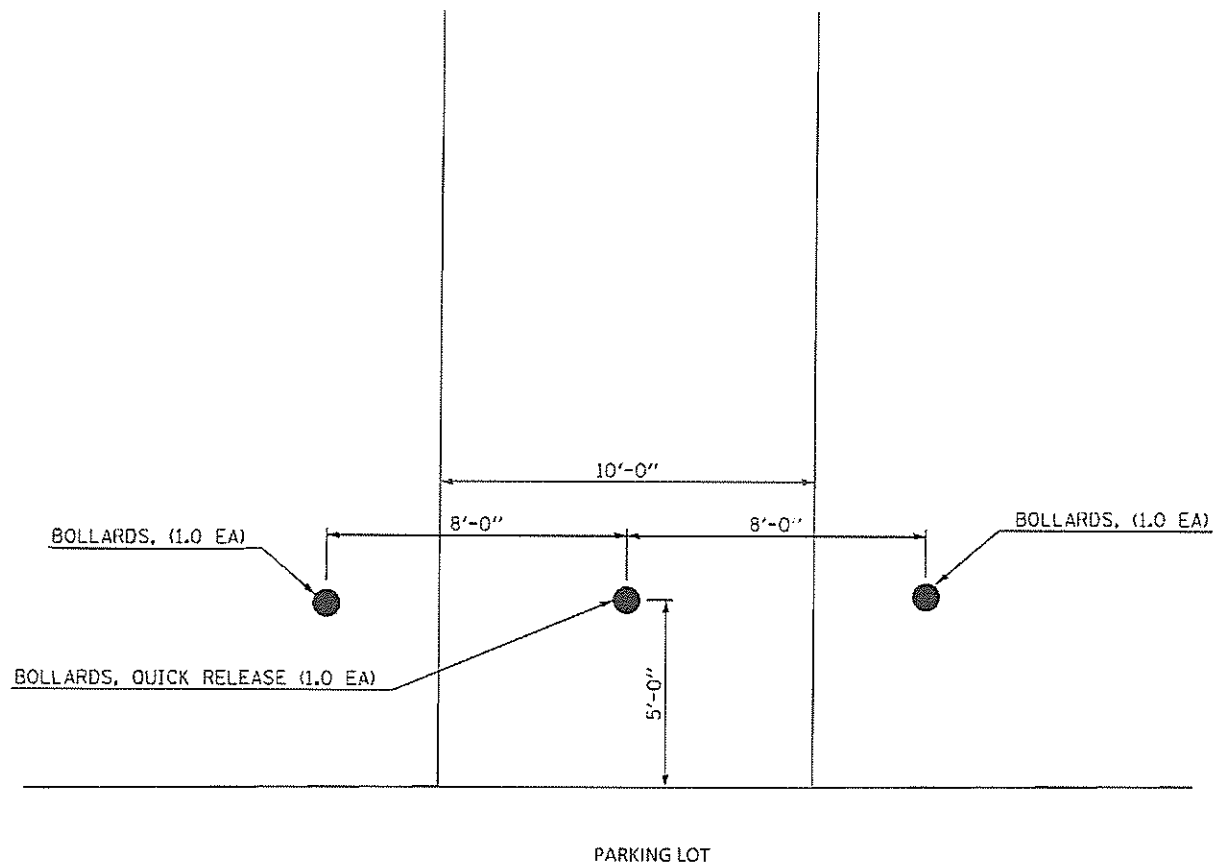

BOLLARD LAYOUT DETAIL

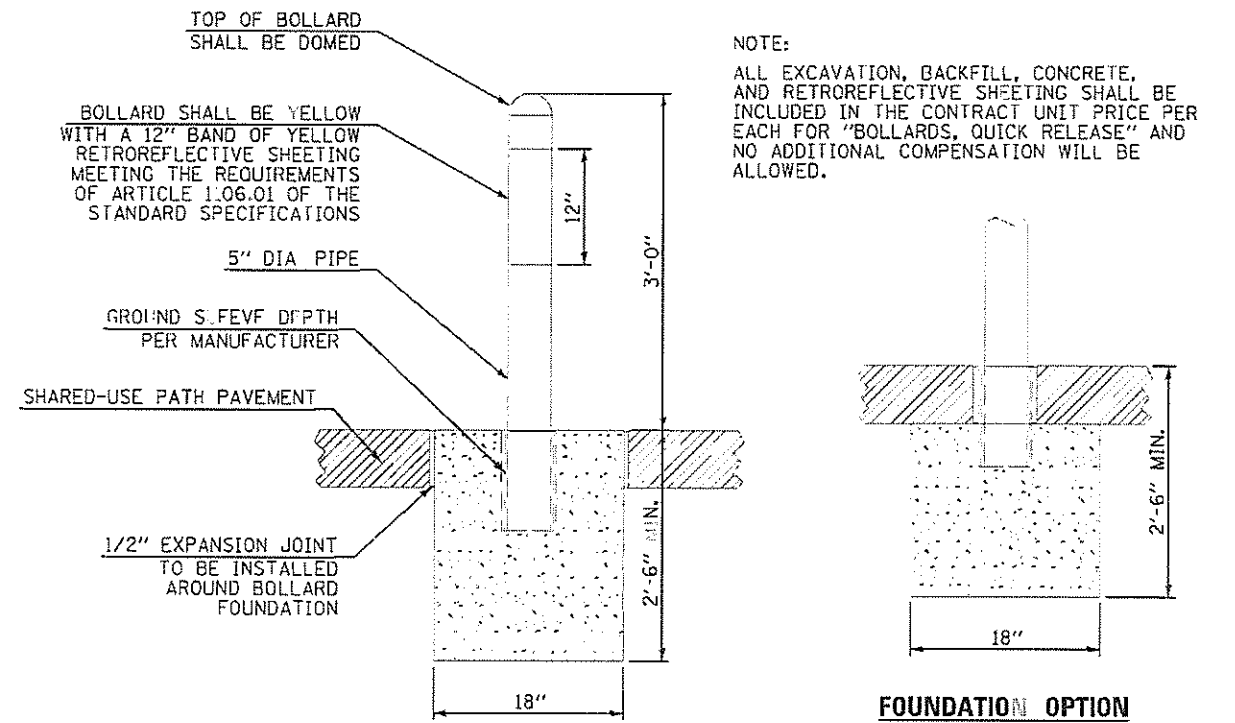

BOLLARD, QUICK RELEASE

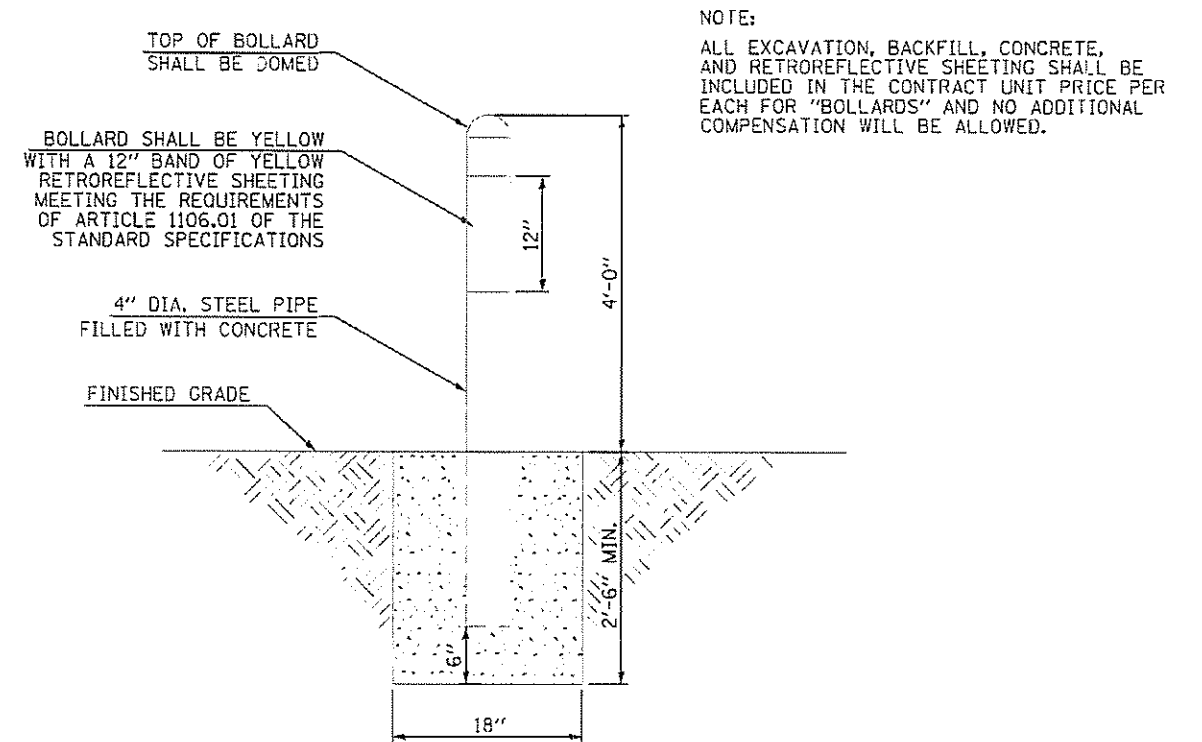

BOLLARD

MODEL: D:\BQA\Bollard.dwg; FILE NAME: P:\A\Bollard.dwg; PLOT DATE: 5/15/2019; USER: sharpjd; PROJECT: 1768 (117) OFF STREET PARKING; CONTRACT NO. 72L08

USER NAME = sharpjd	DESIGNED - _____	REVISED - _____
PLOT SCALE = 2 0000 ' / in	DRAWN - _____	REVISED - _____
PLOT DATE = 5/15/2019	CHECKED - _____	REVISED - _____
	DATE - _____	REVISED - _____

**STATE OF ILLINOIS
DEPARTMENT OF TRANSPORTATION**

BOLLARD DETAILS			
SCALE _____	SHEET _____	OF _____	SHEETS
STA _____	TO STA _____		

F.A. RTE.	SECTION	COUNTY	TOTAL SHEETS	SHEET NO.
1768	(117) OFF STREET PARKING	MONTGOMERY	16	16
CONTRACT NO. 72L08			ILLINOIS FED. AID PROJECT	