

F.A.I. RTE.	SECTION	COUNTY	TOTAL SHEETS	SHEET NO.
55	2007-003 I	WILL.	44	12
STA.		TO STA.		
FED. ROAD DIST. NO.		ILLINOIS FED. AID PROJECT		



I-55 N.B. EXIT RAMP TO U.S. ROUTE 6

U.S. ROUTE 6

FRONTAGE ROAD

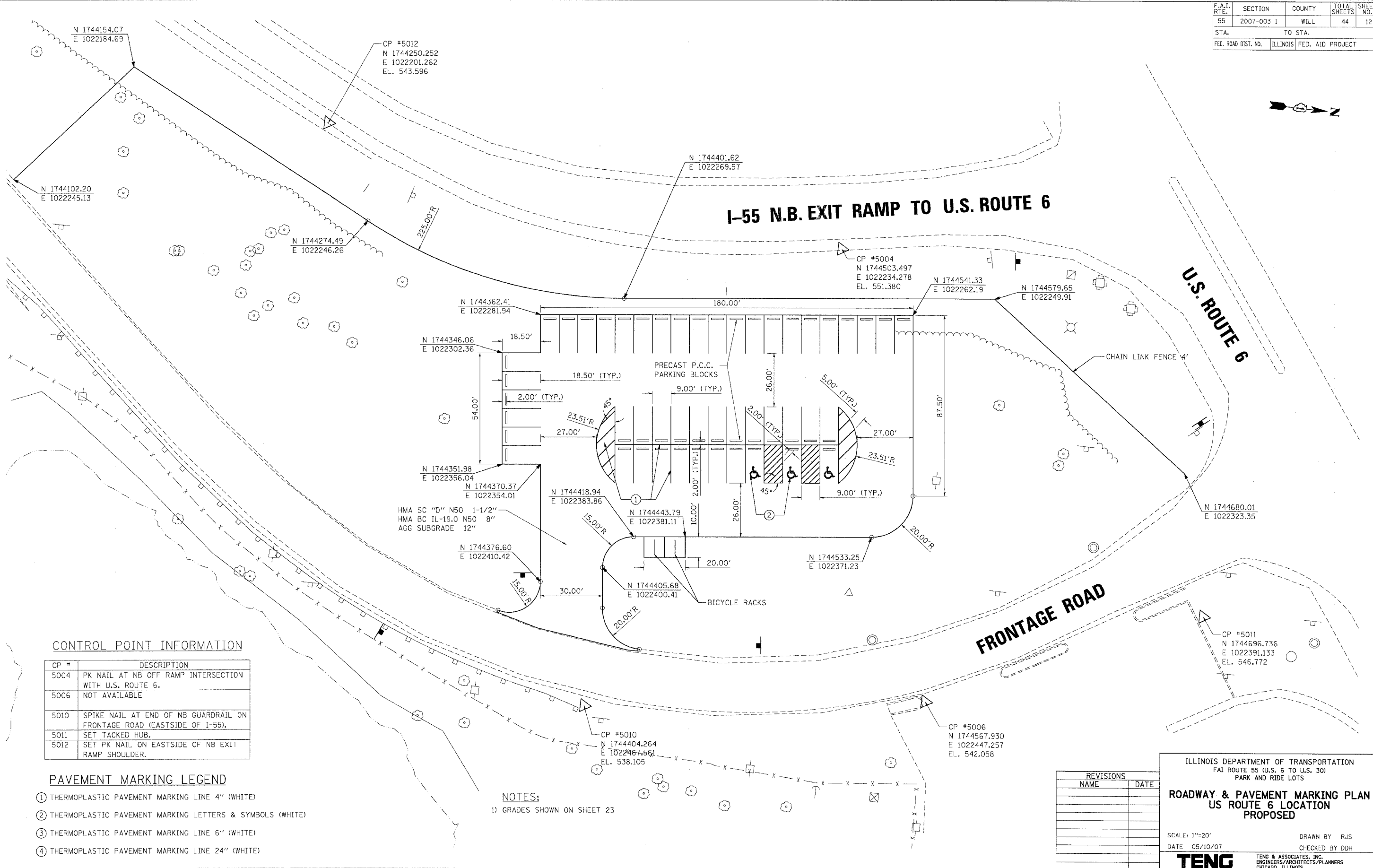

CONTROL POINT INFORMATION

CP #	DESCRIPTION
5004	PK NAIL AT NB OFF RAMP INTERSECTION WITH U.S. ROUTE 6.
5006	NOT AVAILABLE
5010	SPIKE NAIL AT END OF NB GUARDRAIL ON FRONTAGE ROAD (EASTSIDE OF I-55).
5011	SET TACKED HUB.
5012	SET PK NAIL ON EASTSIDE OF NB EXIT RAMP SHOULDER.

PAVEMENT MARKING LEGEND

- ① THERMOPLASTIC PAVEMENT MARKING LINE 4" (WHITE)
- ② THERMOPLASTIC PAVEMENT MARKING LETTERS & SYMBOLS (WHITE)
- ③ THERMOPLASTIC PAVEMENT MARKING LINE 6" (WHITE)
- ④ THERMOPLASTIC PAVEMENT MARKING LINE 24" (WHITE)

NOTES:
1) GRADES SHOWN ON SHEET 23

PLOT DATE = 04/07/07
 FILE NAME = 04LE12
 PLOT SCALE = 1/4"=1'-0"
 USER NAME = RJS

REVISIONS	
NAME	DATE

ILLINOIS DEPARTMENT OF TRANSPORTATION
 FAI ROUTE 55 (U.S. 6 TO U.S. 30)
 PARK AND RIDE LOTS

**ROADWAY & PAVEMENT MARKING PLAN
 US ROUTE 6 LOCATION
 PROPOSED**

SCALE: 1"=20'
 DATE 05/10/07

DRAWN BY RJS
 CHECKED BY DDH

TENG
 TENG & ASSOCIATES, INC.
 ENGINEERS/ARCHITECTS/PLANNERS
 CHICAGO, ILLINOIS