

EXIST. CURVE 7
 PI STA. = 1529+38.93
 $\Delta = 63^\circ 38' 30''$ (LT)
 $D = 1^\circ 39' 00''$
 $R = 3,472.59'$
 $T = 2,154.85'$
 $L = 3,857.07'$
 $E = 614.25'$
 $e = \text{-----}$
 $T.R. = \text{-----}$
 $S.E. \text{ RUN} = \text{-----}$
 $P.C. \text{ STA.} = 1507+84.08$
 $P.T. \text{ STA.} = 1546+41.15$

NOT DRAWN TO SCALE

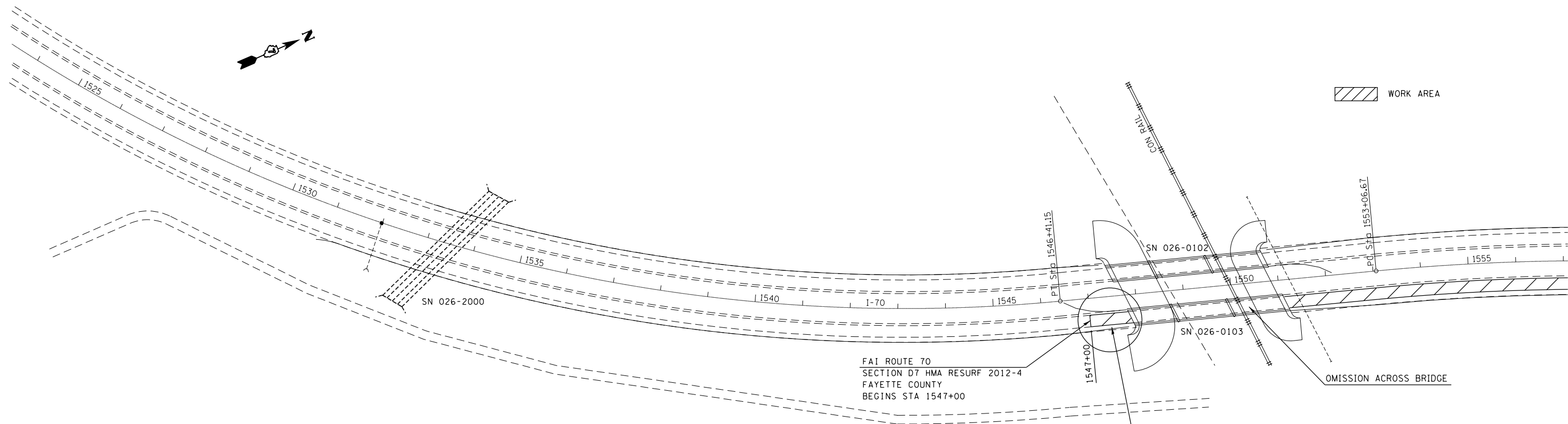

FAI ROUTE 70
 SECTION D7 HMA RESURF 2012-4
 FAYETTE COUNTY
 BEGINS STA 1547+00

NOT DRAWN TO SCALE

FILE NAME =	USER NAME = steffenmk	DESIGNED -	REVISED -
c:\pw\work\p\dot\stef\enmk\d0298200\074570-sht-plan.dgn		DRAWN -	REVISED -
	PLOT SCALE = 200.0000' / in.	CHECKED -	REVISED -
	PLOT DATE = 3/20/2012	DATE -	REVISED -

**STATE OF ILLINOIS
 DEPARTMENT OF TRANSPORTATION**

PLAN	
SCALE: NA	SHEET NO. 1 OF 10 SHEETS
STA. 3033+80	TO STA. 1557+00

F.A.I. RTE.	SECTION	COUNTY	TOTAL SHEETS	SHEET NO.
70	D7 HMA RESURF 2012-4	Fayette	21	10
CONTRACT NO. 74570			ILLINOIS FED. AID PROJECT	