

LIGHT FIXTURE SCHEDULE					
TYPE	MANUFACTURER & CATALOG No.	VOLTAGE	LAMPS	MOUNTING	DESCRIPTION & REMARKS
SA	KING LUMINAIRE K823-HGFL-III-250(MOG)-MH-240 (MT)-KPL10-BK WITH KPL-10 BK LEVELING DEVICE, KA32-T-1-6"-BK ARM AND VALMONT CQAB-BS6LT 250 P2 BK/BCAF-RH8 BK WITH BANNER ARMS, FLAG POLE HOLDER, GFI RECEPTACLES AND IN USE COVERPLATES	240	(1) 250W PSMH	POLE	SEE DETAIL ON SHEET 20 FOR INSTALLATION. PROVIDE (1) GFCI RECEPTACLE AT 1'-6" FROM TOP OF POLE AND (1) GFCI RECEPTACLE AT 4'-0" FROM BUTT OF POLE WITH A CAST ALUMINUM "IN-USE" WP RECEPTACLE COVER, BANNER ARMS AND FLAGPOLE HOLDER. PROVIDE FUSING IN BASE. PAY CODE: DECOR LT/POLE TYPE - SA.
SB	KING LUMINAIRE K823-HGFL-III-250(MOG)-MH-240 (MT)-KPL10-BK WITH KPL-10 BK LEVELING DEVICE, KA32-T-1-6"-BK ARM AND VALMONT CQAB-BS6LT 250 P2 BK/BCAF-RH8 BK WITH BANNER ARMS, FLAG POLE HOLDER, GFI RECEPTACLE AND IN USE COVERPLATE	240	(1) 250W PSMH	POLE	SEE DETAIL ON SHEET 20 FOR INSTALLATION. PROVIDE (1) GFCI RECEPTACLE AT 1'-6" FROM TOP OF POLE WITH A CAST ALUMINUM "IN-USE" WP RECEPTACLE COVER, BANNER ARMS AND FLAGPOLE HOLDER. PROVIDE FUSING IN BASE. PAY CODE: DECOR LT/POLE TYPE - SB.
SC	STERNBERG A850ASR/5PPT/4410FP4/150MH MT MEDIUM/RE5G/ALZAK/1-GFI/UC/BK	120	(1) 150W PSMH	POLE	SEE DETAIL ON SHEET 19 FOR INSTALLATION. PROVIDE (1) GFCI RECEPTACLE INTEGRAL IN POLE WITH A CAST ALUMINUM "IN-USE" WP RECEPTACLE COVER. PROVIDE FUSING IN BASE. PAY CODE: DEC POLES - 10FT.
SD	STERNBERG A850ASR/5PPT/4410FP4/150MH MT MEDIUM/RE5G/ALZAK/BK	120	(1) 150W PSMH	POLE	SEE DETAIL ON SHEET 19 FOR INSTALLATION. PROVIDE FUSING IN BASE. PAY CODE: LT POLE SPL DEC ORN.

LUMINAIRE SCHEDULE								
STATION (TO CENTER OF STRUCT.)	OFFSET	LIGHT POLE FDN SPL (FOOT)	DECOR LT/POLE TYPE SA (EACH)	DECOR LT/POLE TYPE SB (EACH)	LIGHT POLE FDN SPL (EACH)	DEC POLES - 10FT (EACH)	LT POLE SPL DEC ORN (EACH)	ELEC SERV INSTALL SP(EACH)
22+32	22' LT	10		1				
22+62	23' RT	10	1					
23+18	18' RT	10		1				
23+25	22' LT	10	1					
23+29	44' RT				1	1		
23+38	81' RT				1		1	
23+50	69' RT				1	1		
23+84	69' RT				1	1		
23+96	81' RT				1		1	
24+05	44' RT				1	1		
24+11	18' RT	10	1					
24+22	18' LT	10		1				
24+23	84' RT							1
24+66	24' RT	10	1					
24+90	22' LT	10		1				
TOTALS		80	4	4	6	4	2	1

**LIGHT FIXTURE SCHEDULE GENERAL NOTE**

1. ALL METAL PRODUCTS SHALL BE MANUFACTURED OR PRODUCED AND FABRICATED IN THE UNITED STATES OF AMERICA. THE APPLICATION OF ALL COATINGS, EPOXY, GALVANIZING, PAINTING, ETC., TO METAL PRODUCTS SHALL BE APPLIED IN THE UNITED STATES OF AMERICA.

SUMMARY OF RACEWAY, CONDUCTORS, TRENCHING AND BACKFILL											
LOCATION		CONDUCTORS (FEET)				CONDUIT (FEET)			TRENCH AND BACKFILL FOR ELECTRICAL WORK (FEET)	PUSHED CONDUIT (FEET)	
FROM	TO	#4	#6	#8	#10	1"	1 1/2"	2"		1 1/2"	2"
22+30	22+32								2		
22+32	22' LT							5			
22+32	23+25	218	265	141	282			77		22	
22+32	22' LT							81		25	
23+25	24+22	348	279	148	296			81			
23+25	22' LT							6		106	
24+22	24+23	372	295	156	312			6			
24+22	18' LT							35		32	
22+32	22+62							6		57	
22+62	23' RT	146	193	105	210			99		93	
23+18	24+11	218	265	141	282			6		73	
23+18	18' RT							5		2	
24+11	24+23	282	235	126	252			6		154	
24+11	18' RT							43		40	
24+92	24+90							6		98	
24+92	21' LT	525		604	414			288		314	
24+90	24+23							264		242	
25+06	24+66							6		310	
25+06	25' RT							6		262	
24+66	24+23	357		436	302						
24+66	24' RT										
22+30	24+23										
22+30	22' LT										
22+32	24+23										
22+32	26' RT										
24+92	24+23										
24+92	21' LT										
25+06	24+23										
25+06	25' RT										
23+29	23+50										
23+29	44' RT										
23+38	23+50										
23+38	81' RT										
23+50	23+84										
23+50	69' RT										
24+05	23+84										
24+05	44' RT										
23+84	23+96										
23+84	69' RT										
23+96	24+23										
23+96	81' RT										
TOTALS		2466	1632	1857	3992	221	375	564	770	535	1128

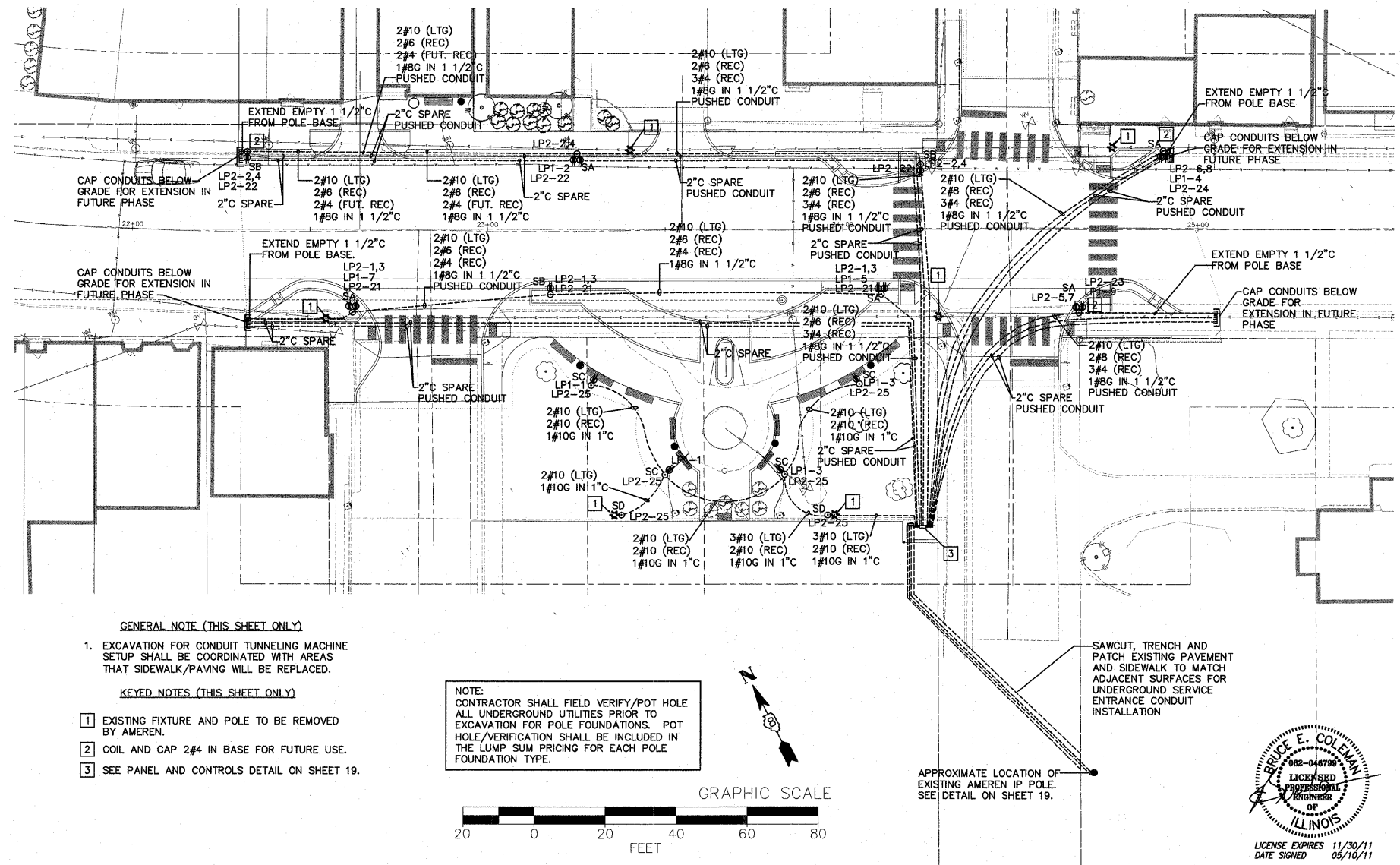

**GENERAL NOTE (THIS SHEET ONLY)**

1. EXCAVATION FOR CONDUIT TUNNELING MACHINE SETUP SHALL BE COORDINATED WITH ARENEN THAT SIDEWALK/PAVING WILL BE REPLACED.

**KEYED NOTES (THIS SHEET ONLY)**

1 EXISTING FIXTURE AND POLE TO BE REMOVED BY AMEREN.

2 COIL AND CAP 2#4 IN BASE FOR FUTURE USE.

3 SEE PANEL AND CONTROLS DETAIL ON SHEET 19.

**NOTE:** CONTRACTOR SHALL FIELD VERIFY/POT HOLE ALL UNDERGROUND UTILITIES PRIOR TO EXCAVATION FOR POLE FOUNDATIONS. POT HOLE/VERIFICATION SHALL BE INCLUDED IN THE LUMP SUM PRICING FOR EACH POLE FOUNDATION TYPE.

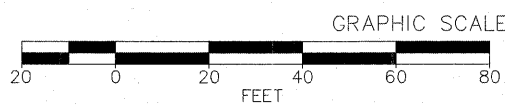

APPROXIMATE LOCATION OF EXISTING AMEREN IP POLE. SEE DETAIL ON SHEET 19.

