

STAGE 2A TYPICAL CROSS SECTION

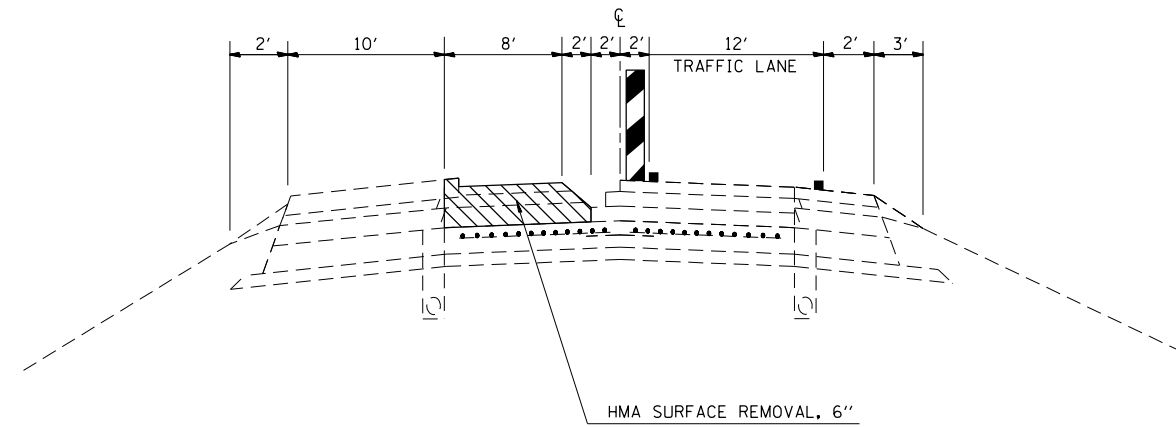

STAGE 2B TYPICAL CROSS SECTION

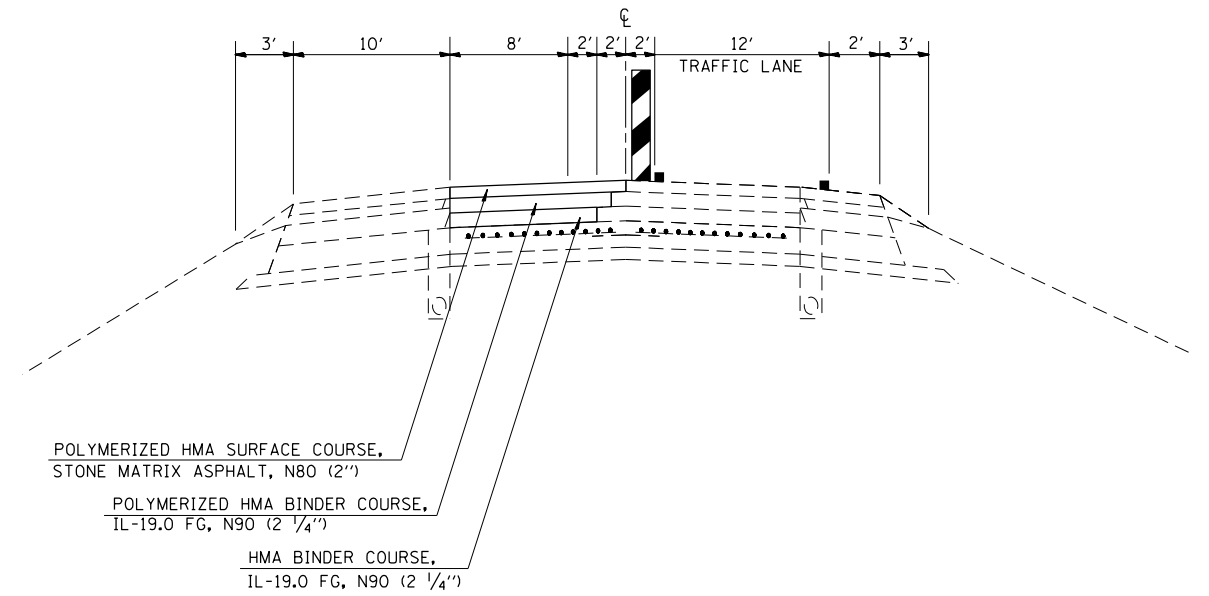

NOTE:
 THE 6" WIDE BY 1/2" THICK BLOCK OF PAVEMENT CONSTRUCTED DURING PRE-STAGE SHALL BE MILLED WITH THE EXISTING DRIVING LANE PAVEMENT. THIS WORK SHALL NOT BE PAID FOR SEPARATELY BUT SHALL BE INCLUDED IN THE COST FOR HMA SURFACE REMOVAL, 6"

NOTE: NOT TO DRAWN TO SCALE

FILE NAME =	USER NAME = steffenmk	DESIGNED -	REVISED -
c:\pw\work\p\dot\steffenmk\d0338930\074255-sht-stgtypicals.dgn		DRAWN -	REVISED -
Default	PLOT SCALE = 100.0000' / in.	CHECKED -	REVISED -
	PLOT DATE = 6/12/2014	DATE -	REVISED -

STATE OF ILLINOIS
 DEPARTMENT OF TRANSPORTATION

STAGING TYPICAL CROSS SECTIONS

SCALE: N/A SHEET 2 OF 2 SHEETS STA. TO STA.

F.A.I. RTE.	SECTION	COUNTY	TOTAL SHEETS	SHEET NO.
70	(26-3,4)RS-3	FAYETTE	31	14
			CONTRACT NO. 74255	
ILLINOIS FED. AID PROJECT				