

STATE OF ILLINOIS
DEPARTMENT OF TRANSPORTATION

F.A. RTE.	SECTION	COUNTY	TOTAL SHEETS	SHEET NO.
VAR.	DIST 8 SCR 2017-1	RANDOLPH & ST. CLAIR	8	1
	ILLINOIS	CONTRACT NO. 76J65		

FOR INDEX OF SHEETS, SEE SHEET NO. 2

PROPOSED HIGHWAY PLANS

VARIOUS ROUTES
SECTION DIST 8 SCR 2017-1
SCOUR MITIGATION
RANDOLPH & ST. CLAIR COUNTIES

C-98-042-16

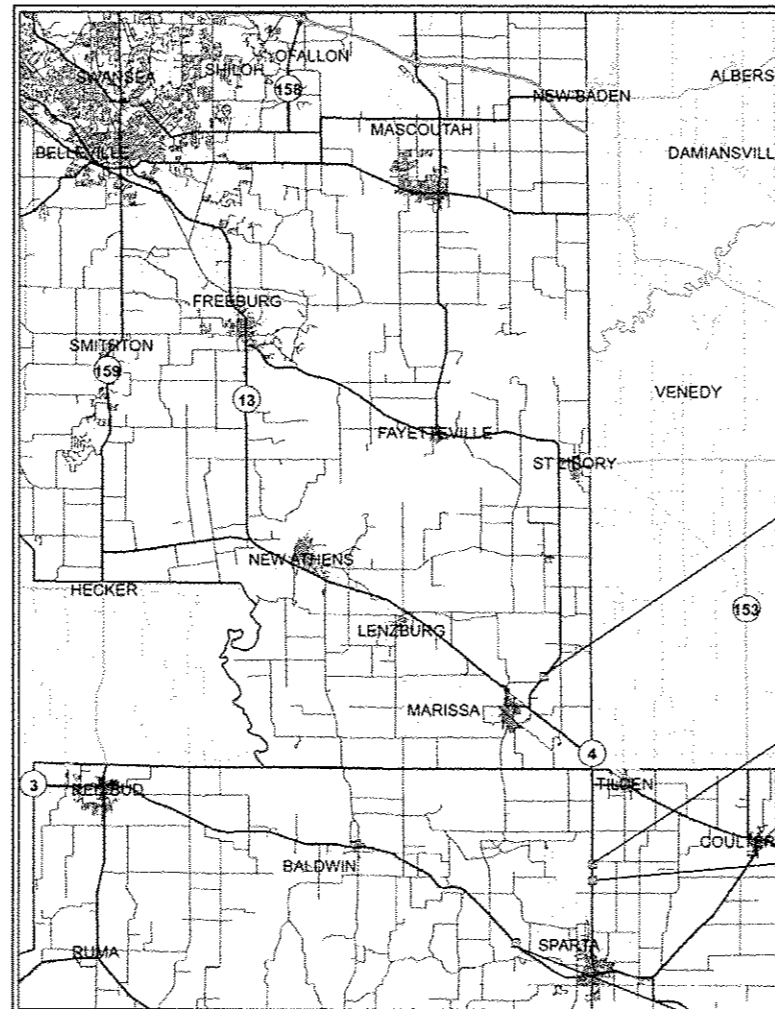
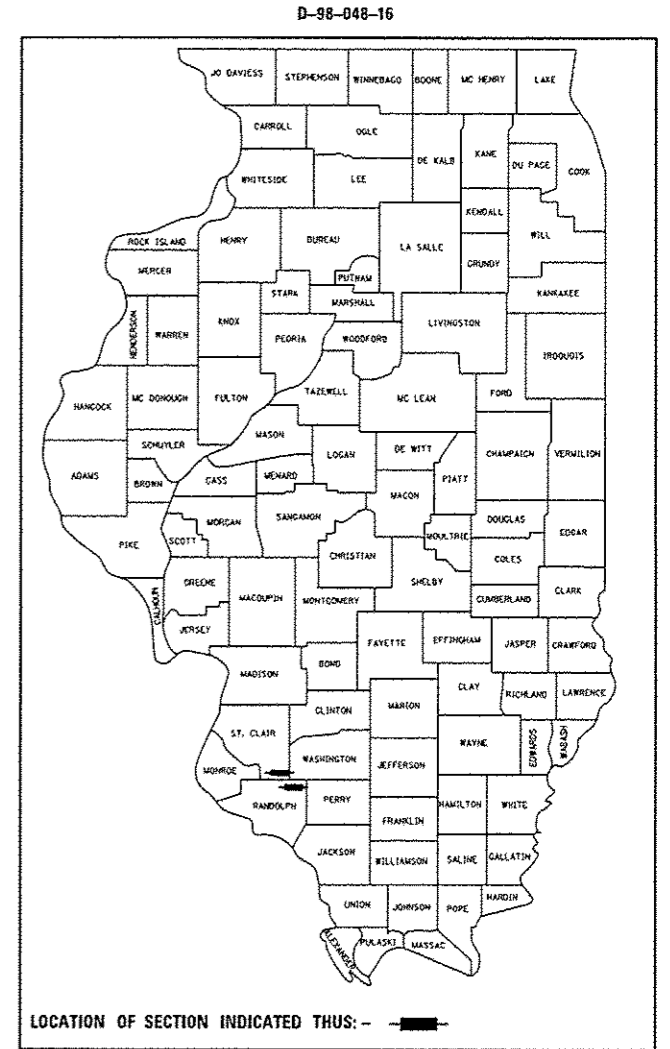

SN 082-0293
LAT: 38.2629
LONG: -89.7321

SN 079-0400
LAT: 38.1744
LONG: -89.7034

SN 079-0401
LAT: 38-1668
LONG: -89.7035

SN 079-0017
LAT: 38.1378
LONG: -89.7492

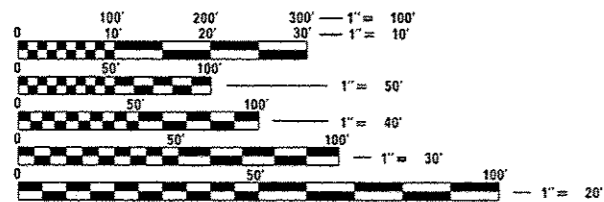

FULL SIZE PLANS HAVE BEEN PREPARED USING STANDARD ENGINEERING SCALES. REDUCED SIZED PLANS WILL NOT CONFORM TO STANDARD SCALES. IN MAKING MEASUREMENTS ON REDUCED PLANS, THE ABOVE SCALES MAY BE USED.

J.U.L.I.E.
JOINT UTILITY LOCATION INFORMATION FOR EXCAVATION
1-800-892-0123
OR 811

PROJECT ENGINEER: HERVE GELIN (618) 346-3179
SQUAD LEADER: BILLIE OWEN (618) 346-3329

CONTRACT NO. 76J65

GROSS AND NET LENGTH = 0.04 MILES (4 SPOT IMPROVEMENTS)

STATE OF ILLINOIS
DEPARTMENT OF TRANSPORTATION

SUBMITTED June 16 20 16
Jeffrey Z. Kan REGIONAL ENGINEER

Aug 12 20 16
Mawson M. Addis, P.E. ENGINEER OF DESIGN AND ENVIRONMENT

Aug 12 20 16
Travis DIRECTOR OF PROGRAM DEVELOPMENT

PRINTED BY THE AUTHORITY
OF THE STATE OF ILLINOIS

INDEX OF SHEETS

- 1 COVER SHEET
- 2 INDEX OF SHEETS, HIGHWAY STANDARDS, GENERAL NOTES, COMMITMENTS AND ADT
- 3 SUMMARY OF QUANTITIES
- 4 LOCATION MAPS
- 5-8 PLAN SHEETS

HIGHWAY STANDARDS

- 000001-06
- 701001-02
- 701006-05
- 701201-04
- 701301-04
- 701901-05

GENERAL NOTES

1. ILLINOIS STATE LAW REQUIRES A 48-HOUR NOTICE BE GIVEN TO ALL UTILITIES WITHIN THE PROJECT AREA BEFORE DIGGING. FIELD MARKING OF FACILITIES MAY BE OBTAINED BY CONTACTING J.U.L.I.E. OR FOR NON-MEMBERS, THE UTILITY COMPANY DIRECTLY. AGENCIES KNOWN TO HAVE FACILITIES WITHIN THE PROJECT AREA ARE AS FOLLOWS:

082-0293

- AMEREN ILLINOIS
- EGYPTIAN TELEPHONE COOP. ASSOC.
- FRONTIER COMMUNICATIONS (SOUTH)
- PRAIRIE STATE GENERATING CO. LLC

079-0400 & 079-0401

- AMEREN ILLINOIS
- CLEARWAVE COMMUNICATIONS
- EGYPTIAN ELECTRIC COOPERATIVE ASSOC.
- FRONTIER COMMUNICATIONS (SOUTH)
- NEW WAVE COMMUNICATIONS
- WASHINGTON COUNTY WATER CO.

079-0017

- AMEREN ILLINOIS
- CITY OF SPARTA
- CLEARWAVE COMMUNICATIONS
- EGYPTIAN ELECTRIC COOPERATIVE ASSOC.
- EGYPTIAN WATER COMPANY
- FRONTIER COMMUNICATIONS (SOUTH)

MEMBERS OF J.U.L.I.E. CALL TOLL FREE (800) 892-0123 OR 811 AND ARE INDICATED BY *. NON- J.U.L.I.E. MEMBERS MUST BE NOTIFIED INDIVIDUALLY.

2. THE CONTRACTOR AND THE ENGINEER SHALL BE AWARE THAT NO SURVEY WAS PERFORMED FOR THIS PROJECT. THE STATIONING, TOPOGRAPHY, AND QUANTITIES SHOWN IN THE PLANS WERE CREATED USING MICROFILM AND FIELD MEASUREMENTS. ALL SHALL BE ASSUMED TO BE APPROXIMATE. THE CONTRACTOR SHALL VERIFY DIMENSIONS AND CONDITIONS IN THE FIELD PRIOR TO CONSTRUCTION AND ORDERING OF MATERIALS.
3. ONLY SHORT TERM LANE CLOSURES SHALL BE ALLOWED FOR MOVEMENT OF EQUIPMENT AND DELIVERY OF MATERIALS AS DIRECTED BY THE ENGINEER.
4. FLAGGERS SHALL BE PRESENT DURING LANE CLOSURES AND NO ADDITIONAL COMPENSATION SHALL BE ALLOWED.
5. THE CONTRACTOR SHALL BE AWARE OF THE CONDITIONS OF THE 404 PERMIT REGARDING EROSION CONTROL MEASURES AND BE IN COMPLIANCE WITH THEM.
6. IN ORDER TO AVOID EROSION OF THE EXCAVATED AREAS, THE CONTRACTOR SHALL HAVE RIPRAP PLACED WITHIN 24 HOURS OF EXCAVATION UNLESS OTHERWISE DIRECTED BY THE ENGINEER DUE TO ADVERSE WEATHER CONDITIONS.
7. "TRUCKS ENTERING AND LEAVING" SIGNS SHALL BE REQUIRED AND PLACED ACCORDING TO THE ENGINEER'S DISCRETION. NO ADDITIONAL COMPENSATION WILL BE ALLOWED.
8. THE CONTRACTOR IS RESPONSIBLE FOR PROVIDING AND MAINTAINING ACCESS TO WORK AREAS. NO ADDITIONAL COMPENSATION WILL BE ALLOWED.
9. ALL AREAS DISTURBED FOR ANY REASON SHALL BE TEMPORARILY AND PERMANENTLY SEEDED AS DIRECTED BY THE ENGINEER AT THE CONTRACTOR'S EXPENSE.
10. IF THE CONTRACTOR, FOR HIS CONSTRUCTION ACTIVITY, REMOVES TREES WITHIN THE RIGHT-OF-WAY LIMITS WHICH ARE NOT DESIGNATED ON THE PLANS FOR REMOVAL, I.E. IN ORDER TO GAIN ACCESS TO THE PROJECT SITE; IT WILL BE HIS RESPONSIBILITY TO REPLACE THE TREES AT A 1:1 RATIO. THE TREES WILL BE REPLACED WITH A 1 GALLON NATIVE ILLINOIS TREE SPECIES AND SHALL BE APPROVED BY THE ENGINEER. THE TREE REMOVAL AND TREE REPLACEMENT WILL BE AT THE CONTRACTOR'S EXPENSE, AND NO ADDITIONAL COMPENSATION WILL BE ALLOWED.

COMMITMENTS

NONE

ADT

082-0293
 2015 ADT = 2050 (ACTUAL)
 2016 ADT = 2100 (ESTIMATED)
 SU=10.0% MU=12.2%

079-0400 & 079-0401
 2015 ADT = 5100 (ACTUAL)
 2016 ADT = 5150 (ESTIMATED)
 SU=10.8% MU=3.9%

079-0017
 2015 ADT = 2700 (ACTUAL)
 2016 ADT = 2750 (ESTIMATED)
 SU=16.9% MU=8.0%

FILE NAME =	USER NAME = ohollandeshe	DESIGNED -	REVISED -	STATE OF ILLINOIS DEPARTMENT OF TRANSPORTATION	INDEX OF SHEETS, HIGHWAY STANDARDS GENERAL NOTES, COMMITMENTS AND ADT	F.A. RTE.	SECTION	COUNTY	TOTAL SHEETS	SHEET NO.
pu\11884EBIDINTEG\Illinois.gov\FWIDT\De	umante\1007 Offices\District B\Proje\eta\087	DESIGNED -	REVISED -			VAR	DIST 8 SCR 2017-1	.	8	2
	PLOT SCALE = 100.0000' / 1" =	CHECKED -	REVISED -			• RANDOLPH/ST. CLAIR		CONTRACT NO. 76J65		
Default	PLOT DATE = 8/14/2016	DATE -	REVISED -			SCALE:	SHEET OF	SHEETS STA.	TO STA.	ILLINOIS FED. AID PROJECT

CODE NO.	ITEM	UNIT	TOTAL QUANTITY	St. Clair County	Randolph County		
					01	02	03
					100% STATE		
				RURAL BRIDGE 0020 082-0293	RURAL BRIDGE 0020 079-0400	RURAL BRIDGE 0020 079-0401	RURAL BRIDGE 0020 079-0017
20300100	CHANNEL EXCAVATION	CU YD	60	20	20	20	
28100109	STONE RIPRAP, CLASS A5	SQ YD	210				210
28100209	STONE RIPRAP, CLASS A5	TON	90	90			
28200200	FILTER FABRIC	SQ YD	470		140	120	210
28400100	GABIONS	CU YD	55		30	25	
28401000	SLOPE MATRESS 12"	SQ YD	170		90	80	
67100100	MOBILIZATION	LSUM	1	0.25	0.25	0.25	0.25
70100450	TRAFFIC CONTROL AND PROTECTION, STANDARD 701201	LSUM	1	0.25	0.25	0.25	0.25

7

FILE NAME =	USER NAME = challandeake	DESIGNED -	REVISED -
p:\NL684EBID\INTEG\Illinois.gov\PI001\Doc	uments\DOT Offices\District 8\Projects\087	REVISOR	REVISED -
	5\DATA\CD\State\0876J65-sh1-500.dwg	CHECKED -	REVISED -
Default	PLOT SCALE = 100.0000' / 1" / 1" / 1"	DATE -	REVISED -
	PLOT DATE = 6/14/2016		

**STATE OF ILLINOIS
DEPARTMENT OF TRANSPORTATION**

SUMMARY OF QUANTITIES

SCALE: SHEET OF SHEETS STA. TO STA.

F.A. RTE.	SECTION	COUNTY	TOTAL SHEETS	SHEET NO.
VAR	DIST 8 SCR 2017-1	*	8	3
* RANDOLPH/ST. CLAIR			CONTRACT NO. 76J65	
ILLINOIS FED. AID PROJECT				

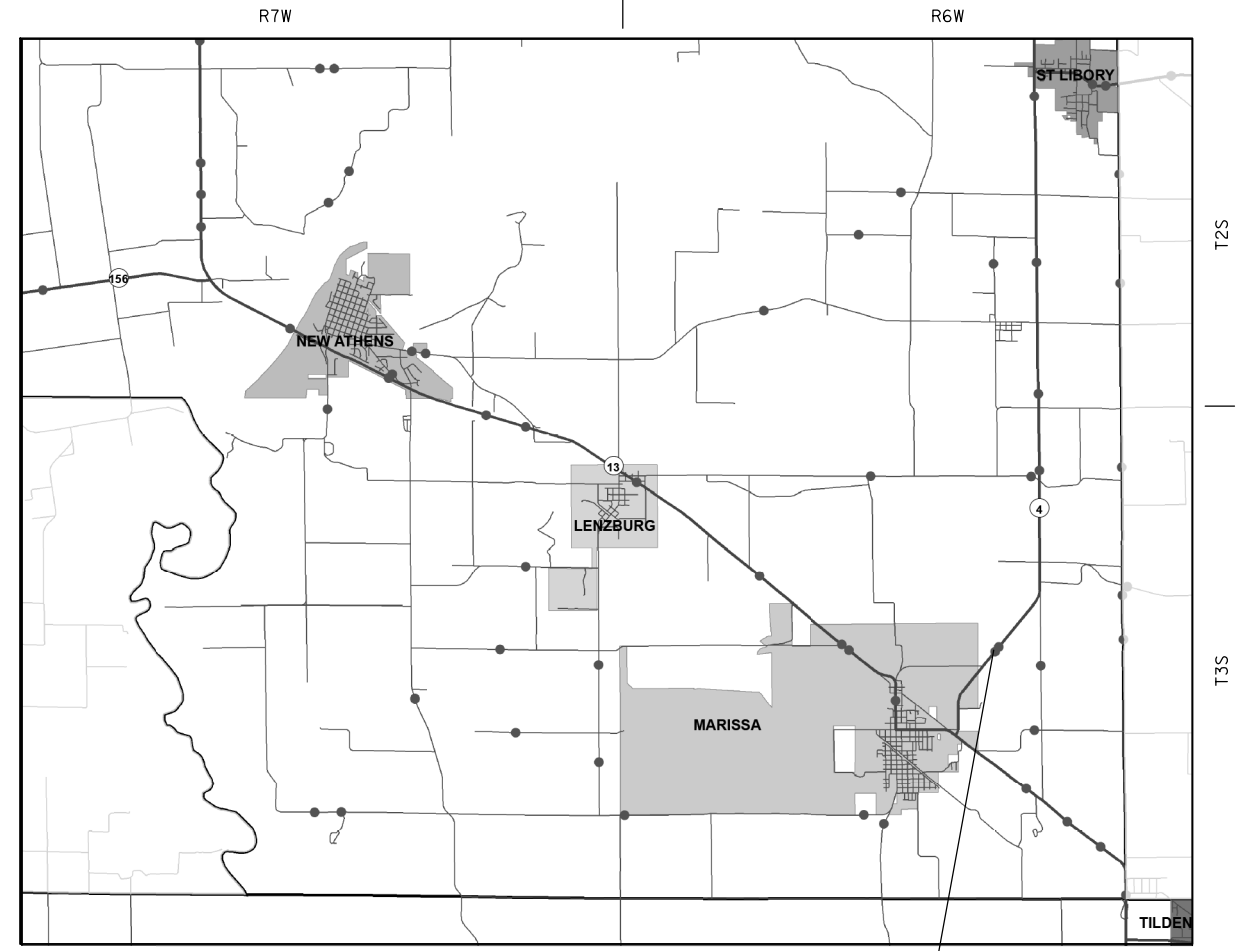
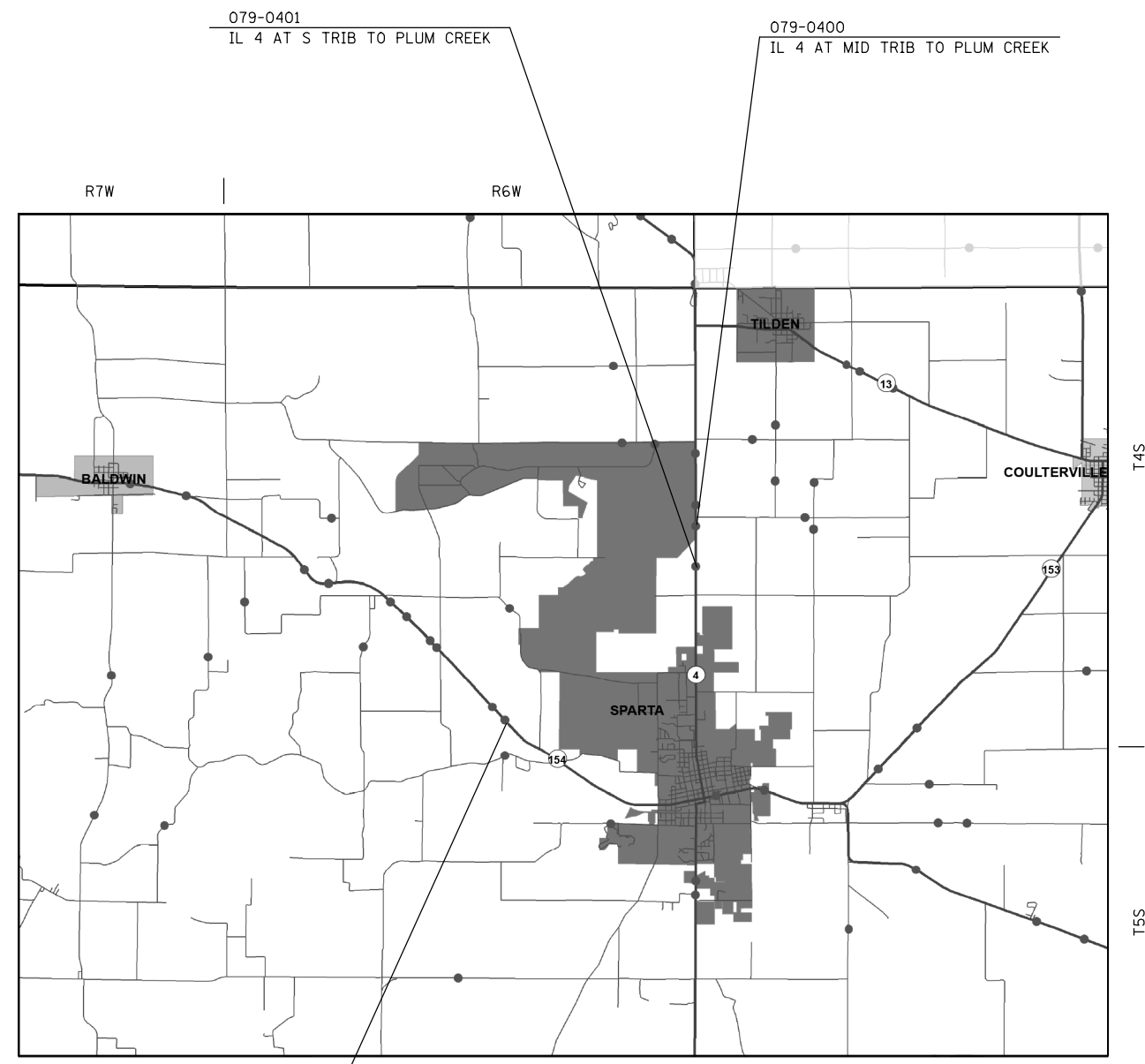

079-0017
IL 154 AT E TRIB TO PLUM CREEK

082-0293
IL 4 AT MUD CREEK

FILE NAME =	USER NAME = chollandeske	DESIGNED -	REVISED -
pw:\IL\084EBIDINTEG\illinois.gov\PWIDOT\Documents\IDOT Offices\District 8\Projects\0876\DRAWING\DATA\CADsheets\0876\0876-sht-100.mxd		DRAWN -	REVISED -
Default	PLOT SCALE = 100.0000' / 1in.	CHECKED -	REVISED -
	PLOT DATE = 6/14/2016	DATE -	REVISED -

**STATE OF ILLINOIS
DEPARTMENT OF TRANSPORTATION**

LOCATION MAPS

SCALE: SHEET OF SHEETS STA. TO STA.

F.A. RTE.	SECTION	COUNTY	TOTAL SHEETS	SHEET NO.
VAR	DIST 8 SCR 2017-1	*	8	4
	* RANDOLPH/ST. CLAIR		CONTRACT NO. 76J65	
ILLINOIS FED. AID PROJECT				

Existing Structure: S.N. 079-0017 consists of a single span reinforced concrete tee-beam superstructure with precast prestressed concrete deck beams utilized for bridge widening supported on closed abutments with spread footings founded on timber piles.

Notes:

- ① The Contractor shall field verify existing dimensions, details, and conditions affecting new construction and make necessary approved adjustments prior to construction or ordering of materials. Such variations shall not be cause for additional compensation for a change in scope of the work, however, the Contractor will be paid for the quantity actually furnished based upon the unit price bid for the work.
- ② Layout of the scour mitigation system may be varied to suit ground conditions in the field as directed by the Engineer.
- ③ Grade channel bank to a slope that will provide a stable base for riprap as directed by the Engineer. Cost included in Stone Riprap, Class A5.
- ④ Grade streambed so that the top of the Stone Riprap approximately matches the existing stream profile as directed by the Engineer. The cost of removing and disposing of existing riprap, brick, block, rubble, soil, or other materials to meet this requirement is included in the cost of Stone Riprap, Class A5.
- ⑤ At the abutments, no excavation shall be allowed below the top of the footing.
- ⑥ Contractor to locate existing underground utilities. Where existing underground utilities conflict with riprap placement, the Contractor shall adjust the layout as directed by the Engineer.
- ⑦ Elevation view shown as of February 8, 2016. Actual conditions may vary.
- ⑧ Estimated quantities. Actual quantities to be determined in the field.

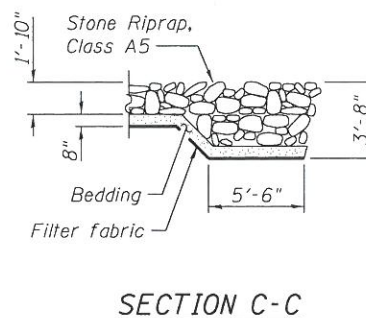
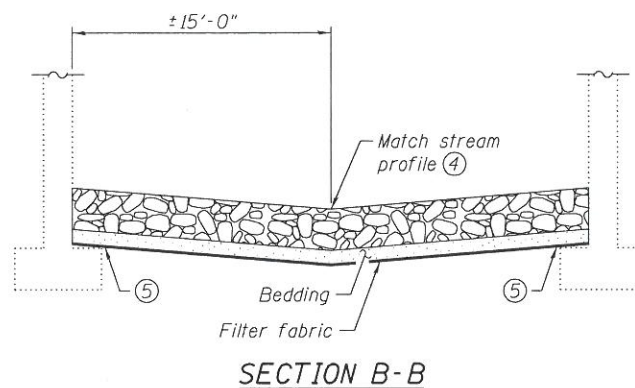
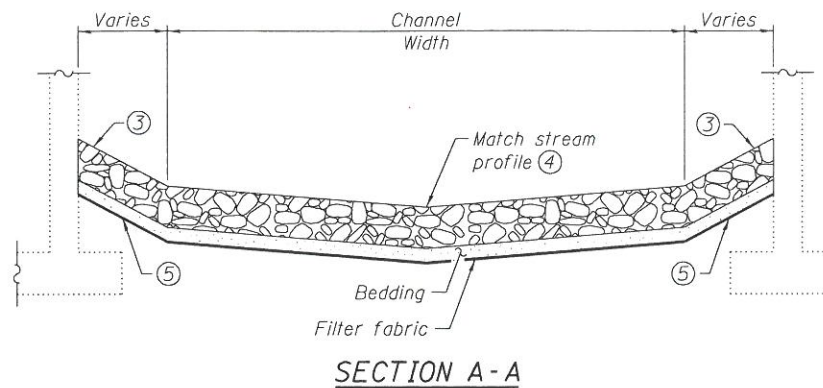

ELEVATION VIEW (7)
(Looking Southwest)

TOTAL BILL OF MATERIAL (8)

CODE NO.	ITEM	UNIT	TOTAL
28100109	Stone Riprap, Class A5	Sq. Yd.	210
28200200	Filter Fabric	Sq. Yd.	210

IL ROUTE 154
OVER EAST TRIBUTARY TO PLUM CREEK
STRUCTURE NO. 079-0017

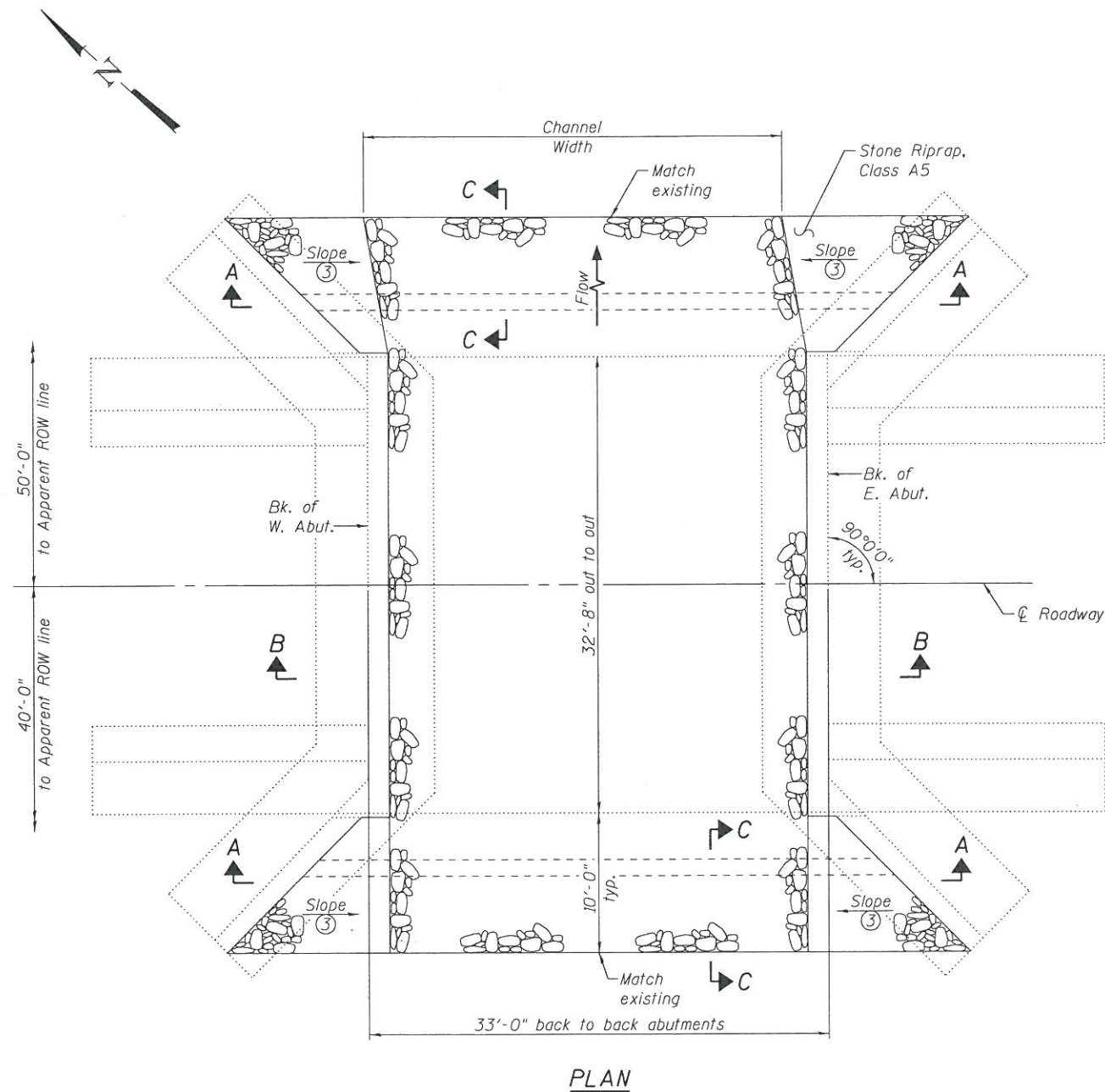

PLAN

DANIEL GEORGE LUIZ
062-060383
LICENSED PROFESSIONAL ENGINEER OF ILLINOIS

D. G. Luiz

DATE: 6/13/2016
EXPIRATION: 11/30/2017

FILE NAME = H:\P\11041\1041.01 - Scour Mitigation Plans\Plans and Calculations\079-0017 - IL 154 over Branch of Plum Creek\0790017-General Plan and Elevation.dgn

OATES ASSOCIATES
Engineering + Architecture
ILLINOIS DESIGN FIRM LICENSE NO: 184.001115

USER NAME =	DESIGNED - SJN	REVISED -
PLOT SCALE =	CHECKED - JAD	REVISED -
PLOT DATE = 6/8/2016	DRAWN - SJN	REVISED -
	CHECKED - JAD	REVISED -

STATE OF ILLINOIS
DEPARTMENT OF TRANSPORTATION

GENERAL PLAN AND ELEVATION
LOCATION 1

SHEET NO. 1 OF 1 SHEETS

F.A.P. RTE.	SECTION	COUNTY	TOTAL SHEETS	SHEET NO.
329	DIST B SCR 2017-1	RANDOLPH	8	5
				CONTRACT NO. 76J65
ILLINOIS FED. AID PROJECT				

Existing Structure: S.N. 079-0400 consists of a single span reinforced concrete channel beam superstructure supported on closed abutments founded on spread footings.

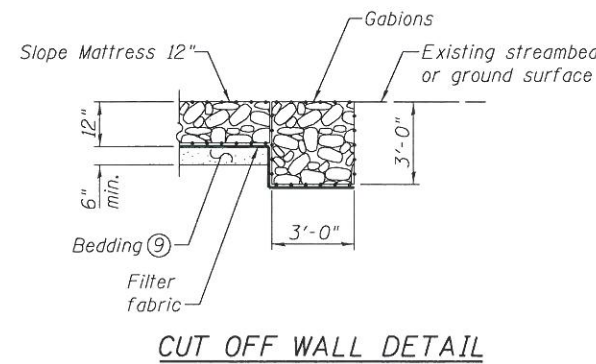
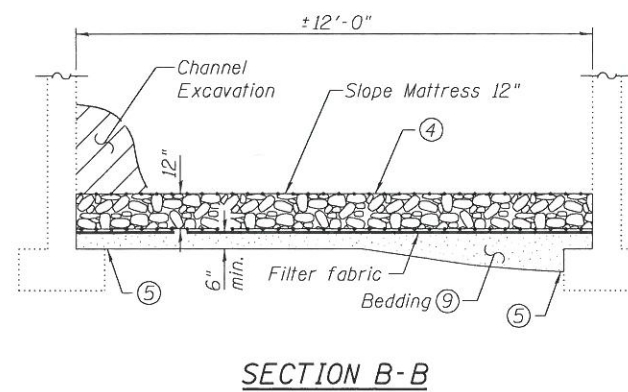
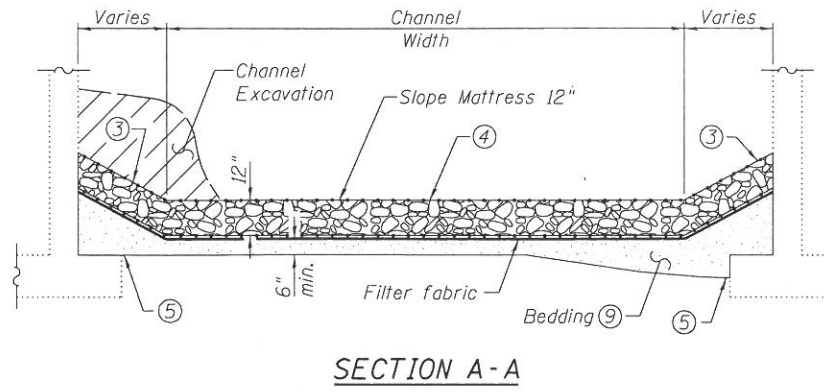
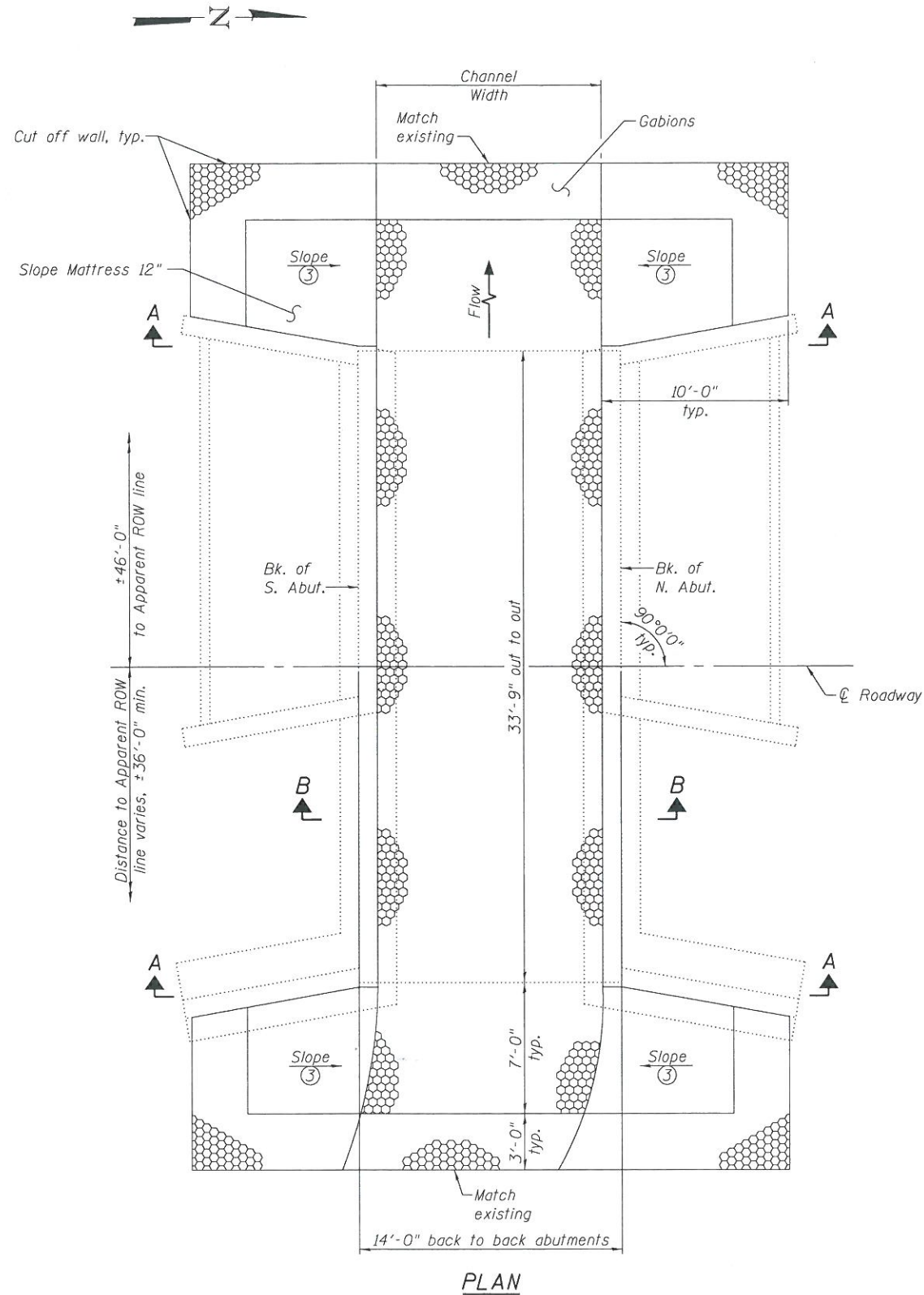

- Notes:
- ① The Contractor shall field verify existing dimensions, details, and conditions affecting new construction and make necessary approved adjustments prior to construction or ordering of materials. Such variations shall not be cause for additional compensation for a change in scope of the work, however, the Contractor will be paid for the quantity actually furnished based upon the unit price bid for the work.
 - ② Layout of the scour mitigation system may be varied to suit ground conditions in the field as directed by the Engineer.
 - ③ Grade channel bank to a slope that will provide a stable base for slope mattress as directed by the Engineer. Cost included in Slope Mattress 12".
 - ④ Grade streambed so that the top of the slope mattress and gabions are approximately 18" above the top of the footing. The cost of removing and disposing of existing riprap, brick, block, rubble, soil, or other materials to meet this requirement is included in the cost of Slope Mattress 12".
 - ⑤ At the abutments, no excavation shall be allowed below the top of the footing.
 - ⑥ Contractor to locate existing underground utilities. Where existing underground utilities conflict with slope mattress or gabion placement, the Contractor shall adjust the layout as directed by the Engineer.
 - ⑦ Elevation view shown as of February 8, 2016. Actual conditions may vary. Vertical clearance from existing streambed to bottom of superstructure is approximately 9'-6".
 - ⑧ Estimated quantities. Actual quantities to be determined in the field.
 - ⑨ Bedding shall be provided under the Slope Mattress and Filter Fabric for a minimum thickness of 6" above the top of footing elevation. Additional bedding shall be provided in areas where the existing streambed is below the top of footing. The bedding material shall conform to the requirements of Article 1004.05 of the Standard Specifications and shall be gradation CA 7. Cost included in Slope Mattress 12".



ELEVATION VIEW ⑦
(Looking West)

TOTAL BILL OF MATERIAL ⑧

CODE NO.	ITEM	UNIT	TOTAL
20300100	Channel Excavation	Cu. Yd.	20
28200200	Filter Fabric	Sq. Yd.	140
28400100	Gabions	Cu. Yd.	30
28401000	Slope Mattress 12"	Sq. Yd.	90

DANIEL GEORGE LUTZ
062-060383
LICENSED PROFESSIONAL ENGINEER
OF ILLINOIS
DATE: 6/13/2016
EXPIRATION: 11/30/2017

IL ROUTE 4
OVER MIDDLE TRIBUTARY TO PLUM CREEK
STRUCTURE NO. 079-0400

USER NAME =	DESIGNED - SJN	REVISED -
PLDT SCALE =	CHECKED - JAD	REVISED -
PLOT DATE = 6/13/2016	DRAWN - SJN	REVISED -
	CHECKED - JAD	REVISED -

F.A.P. RTE.	SECTION	COUNTY	TOTAL SHEETS	SHEET NO.
682	DIST 8 SCR 2017-1	RANDOLPH	8	6
CONTRACT NO. 76J65			ILLINOIS FED. AID PROJECT	

Existing Structure: S.N. 079-0401 consists of a single span reinforced concrete channel beam superstructure supported on closed abutments founded on spread footings.

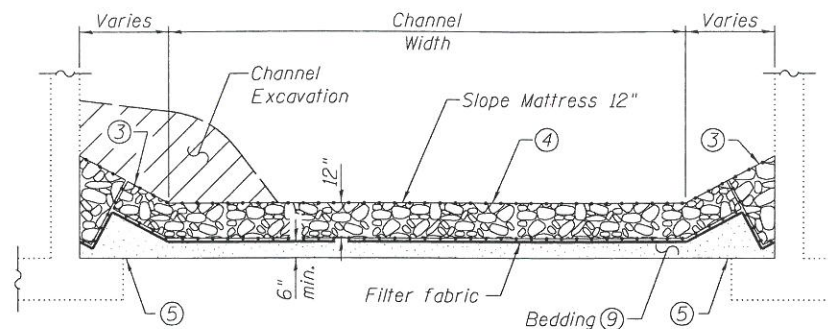
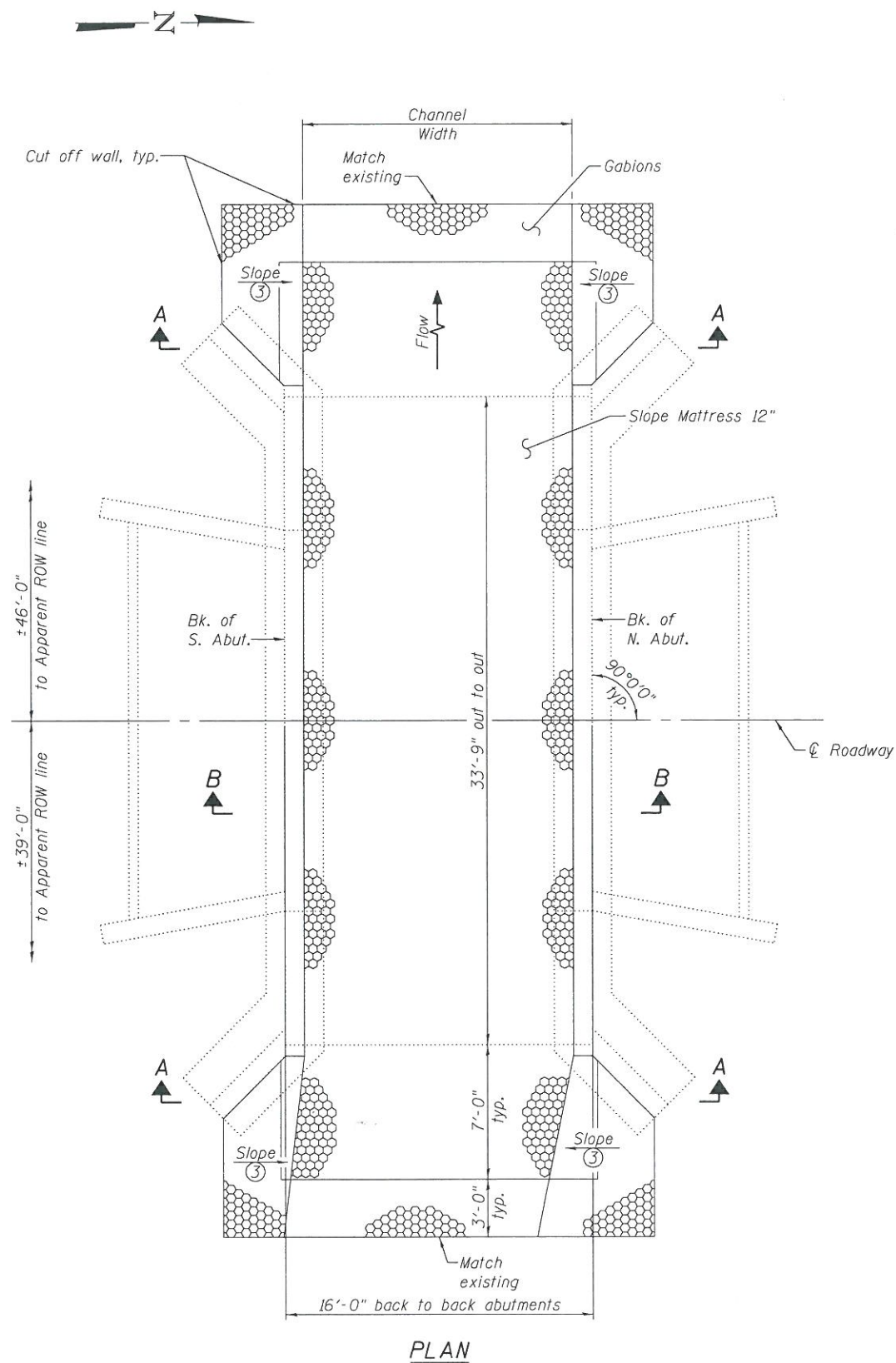

SECTION A-A

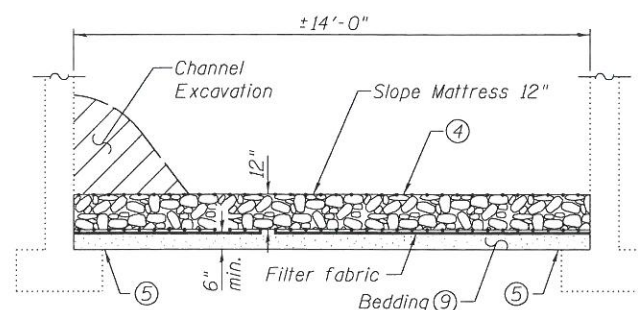

SECTION B-B

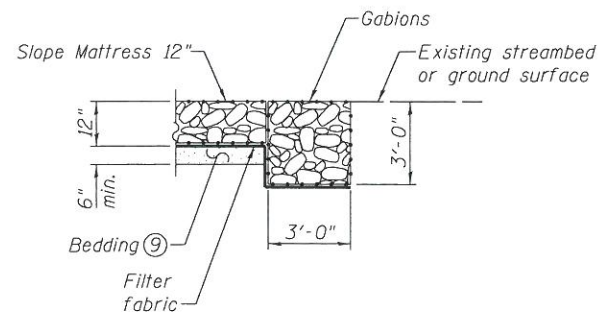

CUT OFF WALL DETAIL

Notes:

- ① The Contractor shall field verify existing dimensions, details, and conditions affecting new construction and make necessary approved adjustments prior to construction or ordering of materials. Such variations shall not be cause for additional compensation for a change in scope of the work, however, the Contractor will be paid for the quantity actually furnished based upon the unit price bid for the work.
- ② Layout of the scour mitigation system may be varied to suit ground conditions in the field as directed by the Engineer.
- ③ Grade channel bank to a slope that will provide a stable base for slope mattress as directed by the Engineer. Cost included in Slope Mattress 12".
- ④ Grade streambed so that the top of the slope mattress and gabions are approximately 18" above the top of the footing. The cost of removing and disposing of existing riprap, brick, block, rubble, soil, or other materials to meet this requirement is included in the cost of Slope Mattress 12".
- ⑤ At the abutments, no excavation shall be allowed below the top of the footing.
- ⑥ Contractor to locate existing underground utilities. Where existing underground utilities conflict with slope mattress or gabion placement, the Contractor shall adjust the layout as directed by the Engineer.
- ⑦ Elevation view shown as of February 8, 2016. Actual conditions may vary. Vertical clearance from existing streambed to bottom of superstructure is approximately 6'.
- ⑧ Estimated quantities. Actual quantities to be determined in the field.
- ⑨ Bedding shall be provided under the Slope Mattress and Filter Fabric for a minimum thickness of 6" above the top of footing elevation. Additional bedding shall be provided in areas where the existing streambed is below the top of footing. The bedding material shall conform to the requirements of Article 1004.005 of the Standard Specifications and shall be gradation CA 7. Cost included in Slope Mattress 12".



ELEVATION VIEW ⑦
(Looking East)

TOTAL BILL OF MATERIAL ⑧

CODE NO.	ITEM	UNIT	TOTAL
20300100	Channel Excavation	Cu. Yd.	20
28800200	Filter Fabric	Sq. Yd.	120
28400100	Gabions	Cu. Yd.	25
28401000	Slope Mattress 12"	Sq. Yd.	80

DANIEL GEORGE LUTZ
062-060383
LICENSED PROFESSIONAL ENGINEER OF ILLINOIS
DATE: 6/13/2016
EXPIRATION: 11/30/2017

IL ROUTE 4
OVER SOUTH TRIBUTARY TO PLUM CREEK
STRUCTURE NO. 079-0401

FILE NAME = H:\N\1081\1081.B01 - Scour Mitigation Plans\Plans and Calcs\76J65\079-0401 - IL 4 over South Tributary to Plum Creek\0790401-General Plan and Elevation.dgn

OATES ASSOCIATES
Engineering + Architecture
ILLINOIS DESIGN FIRM LICENSE NO: 184.001115

USER NAME =	DESIGNED - SJN	REVISED -
PLOT SCALE =	CHECKED - JAD	REVISED -
PLOT DATE = 6/13/2016	DRAWN - SJN	REVISED -
	CHECKED - JAD	REVISED -

STATE OF ILLINOIS
DEPARTMENT OF TRANSPORTATION

GENERAL PLAN AND ELEVATION
LOCATION 3

SHEET NO. 1 OF 1 SHEETS

F.A.P. RTE.	SECTION	COUNTY	TOTAL SHEETS	SHEET NO.
682	DIST B SCR 2017-1	RANDOLPH	8	7
				CONTRACT NO. 76J65
ILLINOIS FED. AID PROJECT				

Existing Structure: S.N. 082-0293 consists of a three span reinforced concrete slab superstructure on open abutments founded on steel H-piles and solid wall pile bent piers founded on steel H-piles.

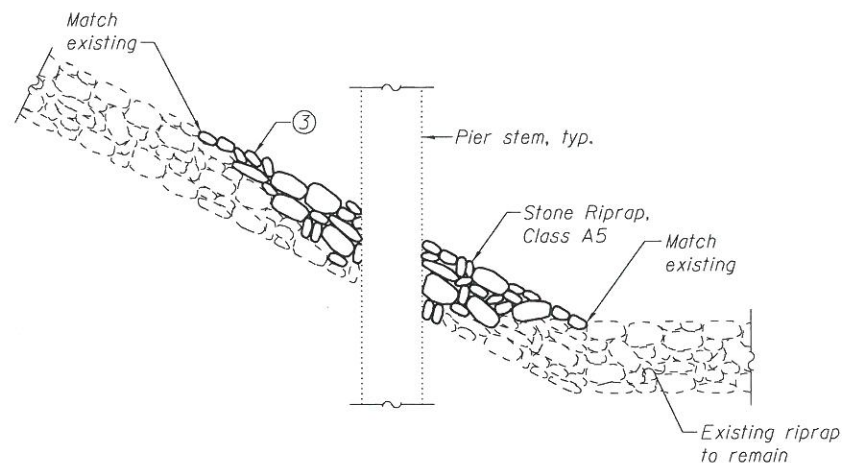

SECTION A-A

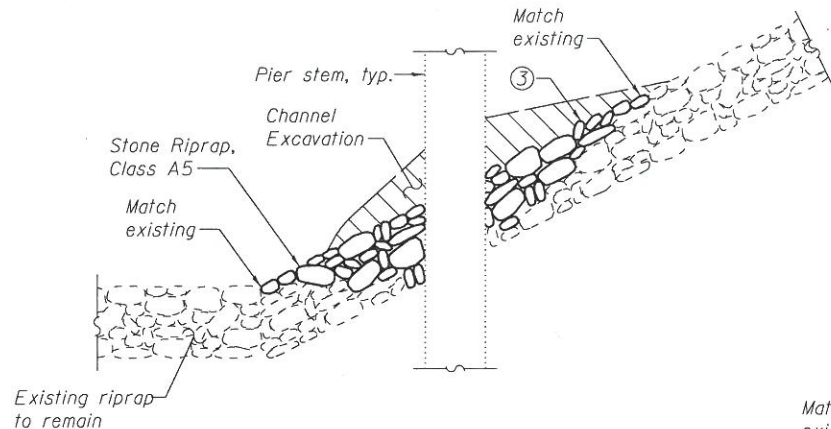

SECTION B-B

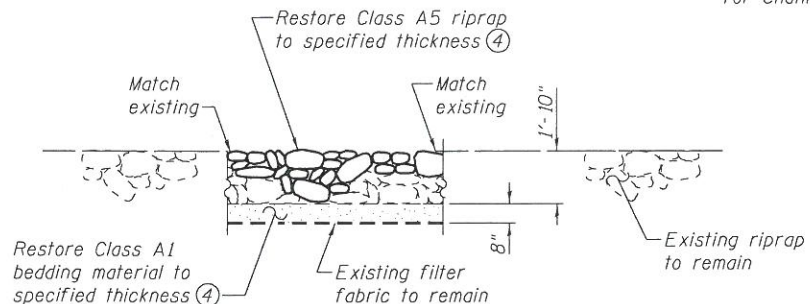

SECTION C-C

- Notes:
- The Contractor shall field verify existing dimensions, details, and conditions affecting new construction and make necessary approved adjustments prior to construction or ordering of materials. Such variations shall not be cause for additional compensation for a change in scope of the work, however, the Contractor will be paid for the quantity actually furnished based upon the unit price bid for the work.
 - Layout of the scour mitigation system may be varied to suit ground conditions in the field as directed by the Engineer.
 - Place additional Stone Riprap, Class A5 to an approximate finished slope of 2:1 (H:V) at right angles to the pier face and as directed by the Engineer.
 - Cost included in Stone Riprap, Class A5.
 - Elevation view shown as of February 8, 2016. Actual conditions may vary.
 - Estimated quantities. Actual quantities to be determined in the field.
 - Remove excess silt deposits around Pier 2 as directed by the Engineer. This work shall be paid for at the contract unit price for Channel Excavation.

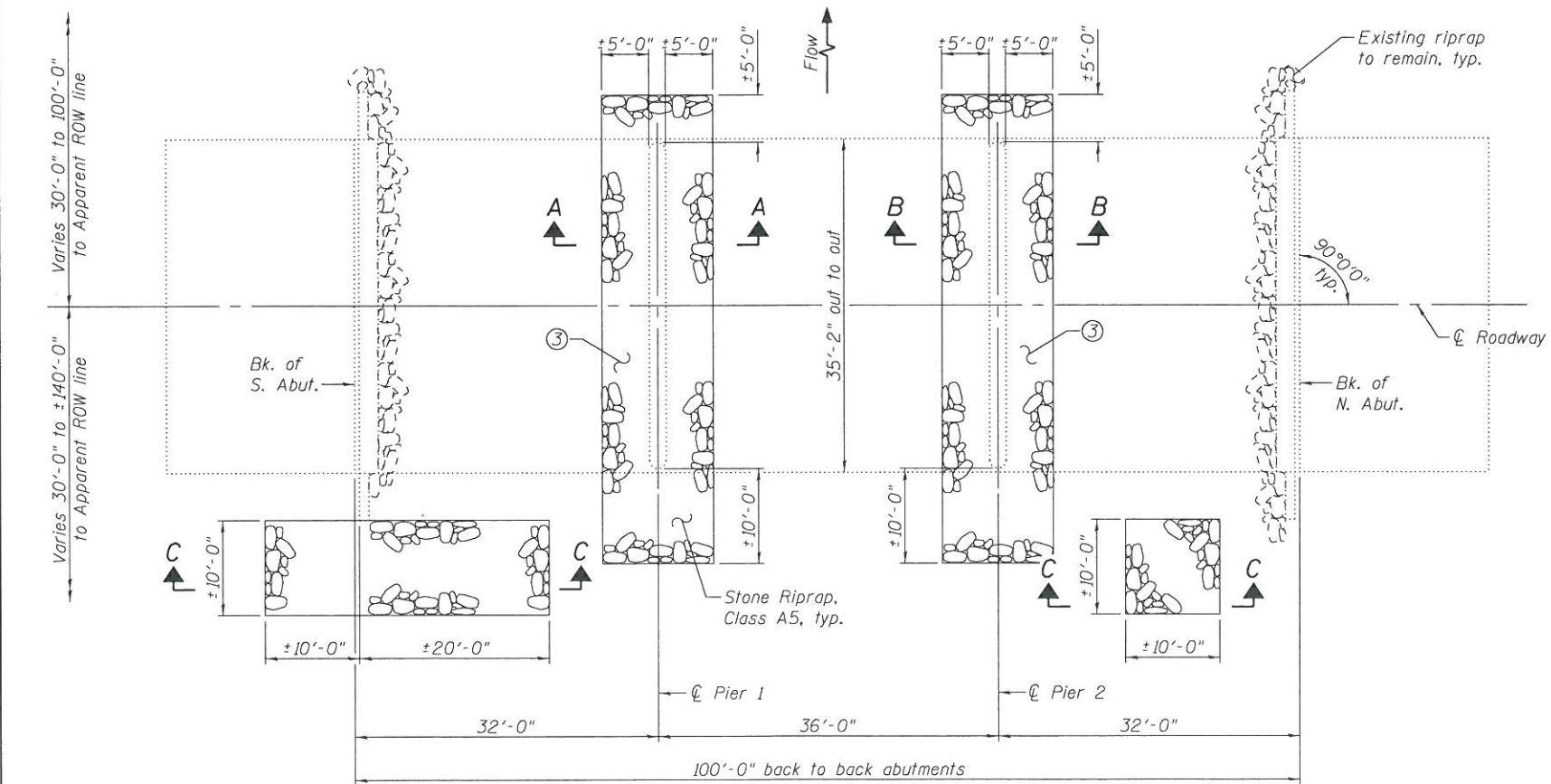

PLAN

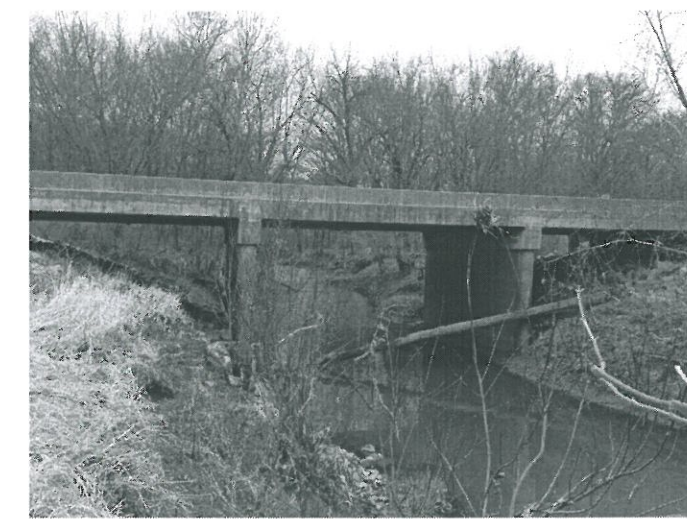

ELEVATION VIEW
(Looking Northwest)

TOTAL BILL OF MATERIAL

CODE NO.	ITEM	UNIT	TOTAL
20300100	Channel Excavation	Cu. Yd.	20
28100209	Stone Riprap, Class A5	Ton	90

Daniel George Lutz
062-060383
LICENSED PROFESSIONAL ENGINEER OF ILLINOIS

DATE: 6/13/2016
EXPIRATION: 11/30/2017

IL ROUTE 4 OVER MUD CREEK
STRUCTURE NO. 082-0293

FILE NAME: H:\N\1041\1041.B11 - Scour Mitigation Plans\Plans and Calcs\76J65\082-0293 - IL - 4 over Mud Creek\0820293-General Plan and Elevation.dgn

OATES ASSOCIATES
Engineering + Architecture
ILLINOIS DESIGN FIRM LICENSE NO: 184.001115

USER NAME =	DESIGNED - SJN	REVISED -
PLDT SCALE =	CHECKED - JAD	REVISED -
PLDT DATE = 6/8/2016	DRAWN - SJN	REVISED -
	CHECKED - JAD	REVISED -

STATE OF ILLINOIS
DEPARTMENT OF TRANSPORTATION

GENERAL PLAN AND ELEVATION
LOCATION 4
SHEET NO. 1 OF 1 SHEETS

F.A.P. RTE.	SECTION	COUNTY	TOTAL SHEETS	SHEET NO.
680	DIST 8 SCR 2017-1	ST. CLAIR	8	8
CONTRACT NO. 76J65				
ILLINOIS FED. AID PROJECT				