

F.A.U. RTE.	SECTION	COUNTY	TOTAL SHEETS	SHEET NO.
2907	1Y (5,6 & 7) RS	COOK	17	1
FED. ROAD DIST. NO. 1		ILLINOIS	CONTRACT NO. 62404	

STATE OF ILLINOIS  
DEPARTMENT OF TRANSPORTATION

DIVISION OF HIGHWAYS

**PROPOSED  
HIGHWAY PLANS**

F.A.U. 2907 (STATE STREET)  
SECTION: 1Y (5,6 & 7) RS  
69TH STREET TO 60TH STREET  
RESURFACING (3P)

PROJECT: *ESP-2907(002)*  
COOK COUNTY  
C-91-086-02

FOR INDEX OF SHEETS, SEE SHEET NO. 2

THESE IMPROVEMENTS ARE LOCATED  
WITHIN THE CITY OF CHICAGO

**TRAFFIC DATA**

2004 ADT - 15,100  
POSTED SPEED LIMIT - 30 MPH

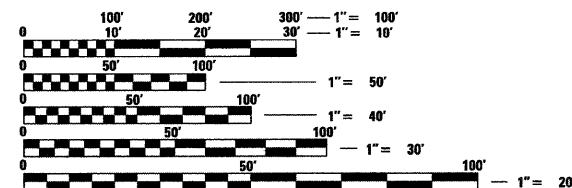

FULL SIZE PLANS HAVE BEEN PREPARED USING STANDARD ENGINEERING SCALES. REDUCED SIZED PLANS WILL NOT CONFORM TO STANDARD SCALES. IN MAKING MEASUREMENTS ON REDUCED PLANS, THE ABOVE SCALES MAY BE USED.

J.U.L.I.E.  
JOINT UTILITY LOCATION INFORMATION FOR EXCAVATION  
1-800-892-0123  
OR 811

Giorba Group, Inc.

DESIGN FIRM  
REGISTRATION NUMBER

184-001016

CONSULTING ENGINEERS  
SUITE 402, 5507 NORTH CUMBERLAND AVE  
CHICAGO, ILLINOIS 60656 ☎ (773) 775-4009

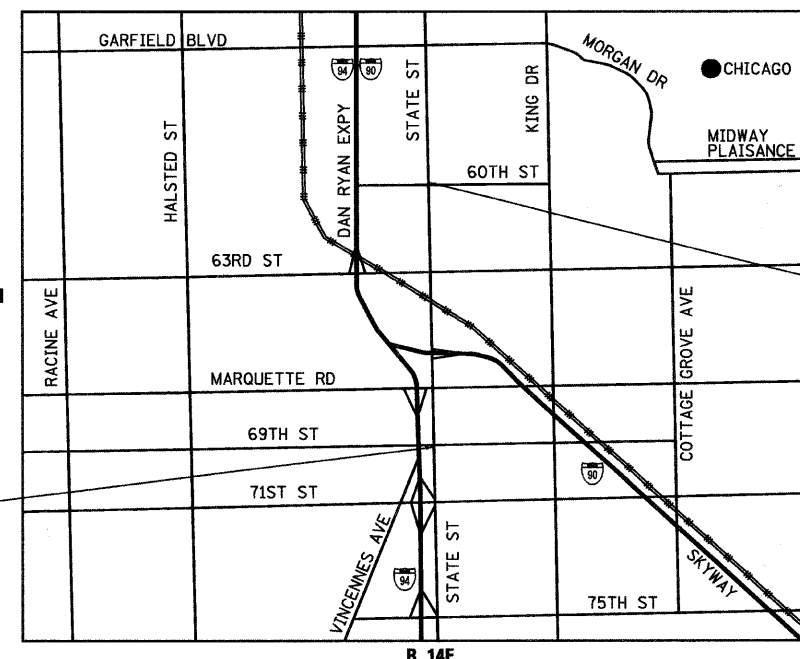

BEGIN PROJECT  
STA. 11+43

END PROJECT  
STA. 72+04

LOCATION MAP  
1" = 2,000'

GROSS & NET LENGTH OF PROJECT = 6,061 FT = 1.15 MI.

D-91-086-02

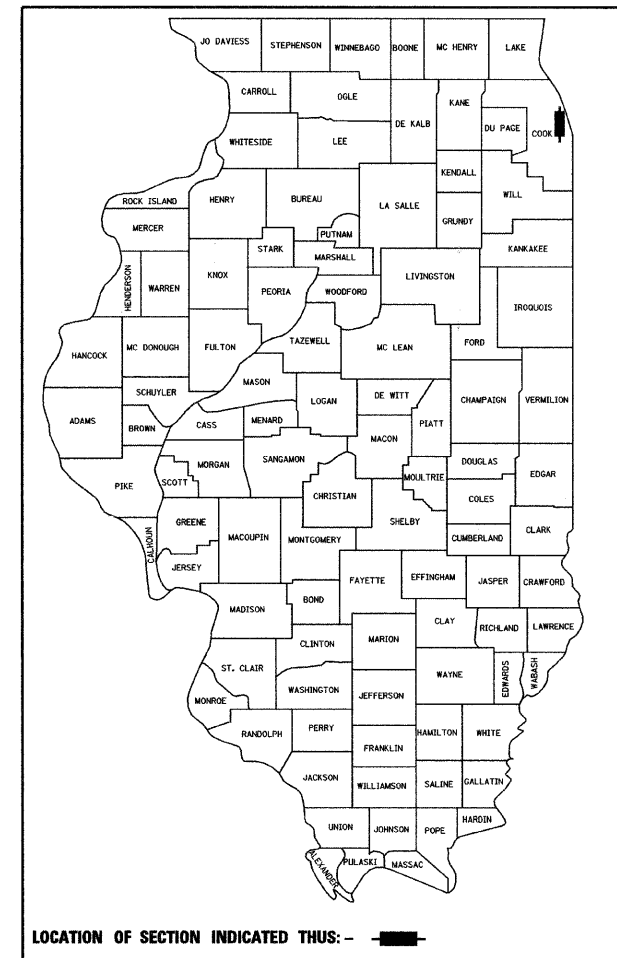

LOCATION OF SECTION INDICATED THUS: - [black rectangle] -

STATE OF ILLINOIS  
DEPARTMENT OF TRANSPORTATION  
DIVISION OF HIGHWAYS

SUBMITTED *June 24, 2009*  
*Dir O'Neil*  
DEPUTY DIRECTOR OF HIGHWAYS, REGION ENGINEER  
*August 14, 2009*  
*Charles J. Ingersoll*  
ENGINEER OF DESIGN AND ENVIRONMENT  
*August 14, 2009*  
*Christie M. Reed*  
DIRECTOR OF HIGHWAYS, CHIEF ENGINEER

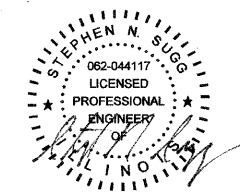

DATE: 6/23/2009  
SEAL EXPIRES: 11/30/2009

PRINTED BY THE AUTHORITY  
OF THE STATE OF ILLINOIS

DISTRICT 1 DESIGN PLAN PREPARATION ENGINEER: K. ENG (847)705-4247

CONTRACT NO. 62404