

F.A.U. R.T.E.	SECTION	COUNTY	TOTAL SHEETS	SHEET NO.
2903	00-00047-00-FP	LAKE	180	60
TRI-STATE STA. 315+50 TO 322+00				
CONTRACT NO. 83845		ILLINOIS		

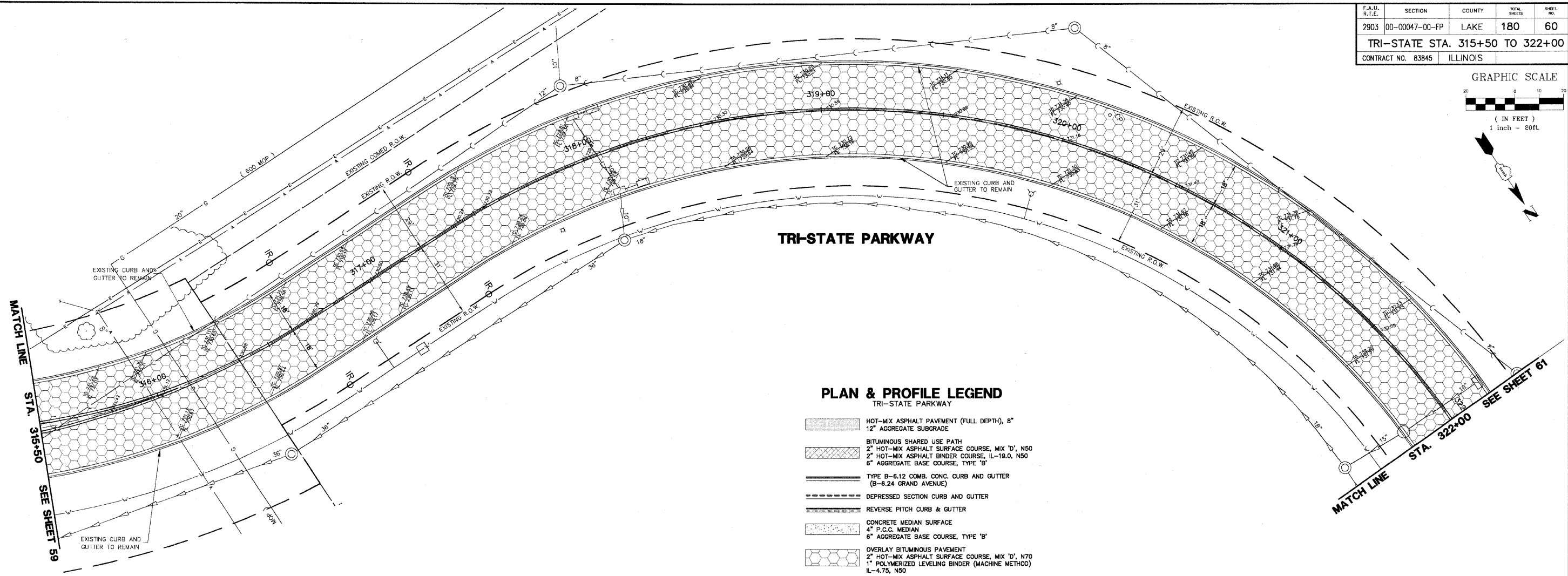

- PLAN & PROFILE LEGEND**
TRI-STATE PARKWAY
- HOT-MIX ASPHALT PAVEMENT (FULL DEPTH), 8" 12" AGGREGATE SUBGRADE
 - BITUMINOUS SHARED USE PATH
 - 2" HOT-MIX ASPHALT SURFACE COURSE, MIX 'D', N50
 - 2" HOT-MIX ASPHALT BINDER COURSE, IL-19.0, N50
 - 6" AGGREGATE BASE COURSE, TYPE 'B'
 - TYPE B-6.12 COMB. CONC. CURB AND GUTTER (B-6.24 GRAND AVENUE)
 - DEPRESSED SECTION CURB AND GUTTER
 - REVERSE PITCH CURB & GUTTER
 - CONCRETE MEDIAN SURFACE
 - 4" P.C.C. MEDIAN
 - 6" AGGREGATE BASE COURSE, TYPE 'B'
 - OVERLAY BITUMINOUS PAVEMENT
 - 2" HOT-MIX ASPHALT SURFACE COURSE, MIX 'D', N70
 - 1" POLYMERIZED LEVELING BINDER (MACHINE METHOD) IL-4.75, N50

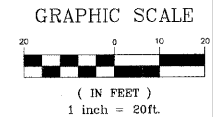
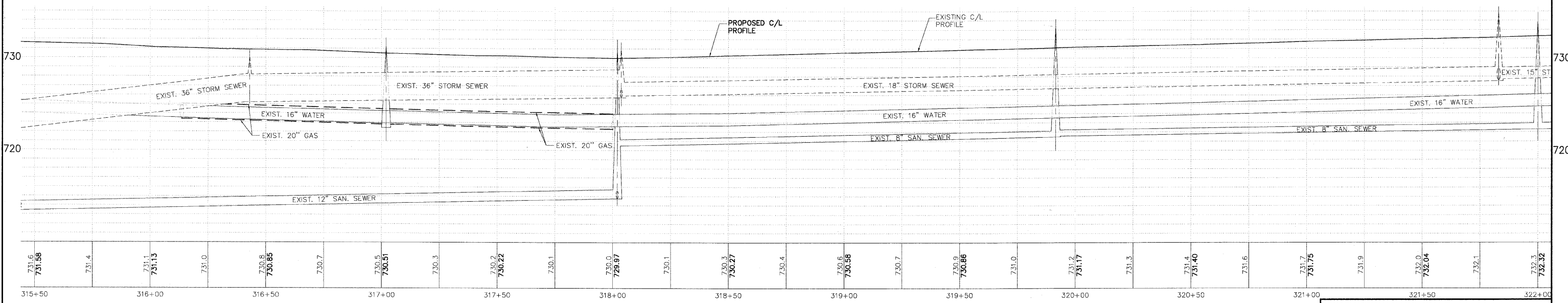

PLANS PREPARED BY:
GEWALT HAMILTON
ASSOCIATES, INC.
Consulting Engineers & Surveyors
850 Forest Edge Drive
Vernon Hills, IL 60061
(847) 478-9700
(847) 478-9701 Fax

REVISIONS	
NAME	DATE
REV.-1 IDOT COMMENTS	02-05-06
REV.-2 PLANS STAGED	06-02-06
REV.-5 PRE-FINAL SUB	02-20-09
PS&S SUBMITTAL	04-10-09

ILLINOIS DEPARTMENT OF TRANSPORTATION

PLAN AND PROFILE
PROPOSED ROADWAY WIDENING
AND INTERSECTION IMPROVEMENTS
TRI-STATE PARKWAY

SCALE: H: 1"=20' V: 1"=5'
DATE: 10-05-04

DRAWN BY: CGP
DESIGNED BY: TPG
CHECKED BY: BLS