

CONTRACTOR SHALL PROVIDE TEMPORARY DRAINAGE, SPECIFICALLY AT THE PROFILE LOW POINTS AT STATIONS 107+50 AND 137+20. RIP RAP SEDIMENT BASINS, TEMPORARY DITCHING, TEMPORARY UNDERDRAINS SHALL BE USED TO FACILITATE POSITIVE DRAINAGE AWAY FROM THE PROPOSED AGGREGATE SUBGRADE. IT IS RECOMMENDED THAT THE PROPOSED CULVERT EXTENSION WORK IS COMPLETED IN DRY CONDITIONS.

GRAPHIC SCALE

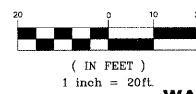

F.A.U. R.T.E.	SECTION	COUNTY	TOTAL SHEETS	SHEET NO.
1223	00-00047-00-FP	LAKE	180	70
DRAINAGE - STA. 500+00 TO 506+00				
CONTRACT NO. 83845		ILLINOIS		

OLD FARM LANE

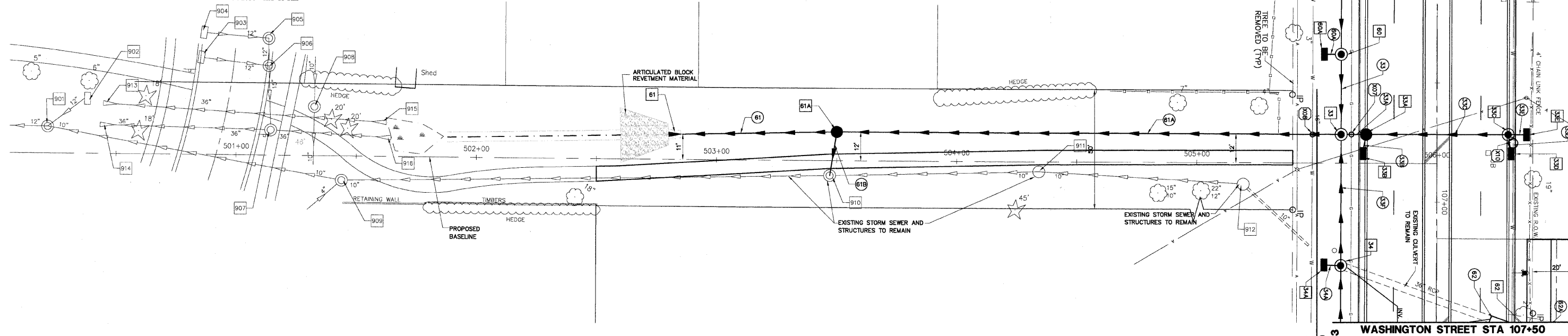

901	EX. STORM MANHOLE RIM: 730.08 INV: 727.40 12" NE & NW INV: 727.48 STA: 500+22 O/S: 11'L	905	EX. STORM MANHOLE RIM: 733.21 INV: 730.16 STA: 501+14 O/S: 49'L	909	EX. STORM MANHOLE RIM: 733.93 INV: 727.93 10" N INV: 727.95 4" SE INV: 728.83 STA: 501+43 O/S: 10'R	913	EX. STORM MANHOLE RIM: 733.96 INV: 729.07 ADJUST RIM TO 733.25 10" N INV: 729.15 STA: 503+47 O/S: 6'R
902	EX. STORM INLET RIM: 728.97 INV: 727.47 STA: 500+39 O/S: 23'L	906	EX. STORM MANHOLE RIM: 733.15 INV: 729.60 12" S INV: 729.65 STA: 501+14 O/S: 38'L	915	EX. FLARED END SECTION 36" INV: 729.02 STA: 501+61 O/S: 14'L	911	EX. STORM MANHOLE RIM: 732.63 INV: 729.83 ADJUST RIM TO 733.00 10" N INV: 730.03 STA: 504+34 O/S: 4'R
913	EX. FLARED END SECTION 36" INV: 728.65 STA: 500+47 O/S: 21'L	907	EX. STORM MANHOLE RIM: 733.97 INV: 728.78 15" W INV: 729.47 36" W INV: 729.07 36" S INV: 728.82 STA: 501+14 O/S: 10'L	916	EX. FLARED END SECTION 36" INV: 728.68 STAI 501+62 O/S: 8'L	912	EX. STORM MANHOLE RIM: 734.13 INV: 730.38 STA: 505+19 O/S: 9'R
914	EX. FLARED END SECTION 36" INV: 728.68 STA: 500+46 O/S: 12'L	908	EX. STORM MANHOLE RIM: 734.26 INV: 726.10 10" E INV: 726.13 STA: 501+33 O/S: 21'L	61	FLARED END SECTION 36" RCP INV: 730.10 STA: 502+82 O/S: 3'L	33	STORM SEWER MANHOLE TY 'A' 72" TY 1 FR & CL RIM 736.51 INV: 731.00 E&W INV: 731.58 16" N INV: 732.40 STA: 505+60 O/S: 12'L
903	EX. STORM INLET RIM: 733.21 INV: 730.61 STA: 500+86 O/S: 40'L			61A	STORM SEWER CATCHBASIN TY 'A' 60" TY 1 FR & CL RIM: 734.30 INV: 730.33 10" E INV: 729.21 STA: 503+50 O/S 12'L		
904	EX. STORM INLET RIM: 733.15 INV: 730.25 STA: 500+87 O/S: 51'L						

NOTE:  
OFFSETS PROVIDED ARE FROM CENTER LINE  
TO CENTER LINE OF STRUCTURE.

- 61 68 LF 36" SS, CL A, TY 1, @ 0.34% TBF 0.0 CY
- 61B 18 LF 10" SS, CL A, TY 1, @ 0.33% TBF 6.0 CY
- 61A 210 LF 36" SS, CL A, TY 1, @ 0.32% TBF 0.0 CY

- DRAINAGE & UTILITY PLAN LEGEND**
- 5 EXISTING SANITARY STRUCTURE
  - 9 EXISTING SANITARY SEWER
  - W EXISTING WATERMAIN STRUCTURE
  - W EXISTING WATERMAIN
  - 23 EXISTING STORM SEWER STRUCTURE
  - EX EXISTING STORM SEWER
  - 37 PROPOSED STORM SEWER STRUCTURE
  - PROPOSED STORM SEWER
  - 61A PROPOSED STORM SEWER PIPE
  - 61B PROPOSED STORM SEWER MANHOLE
  - 61C PROPOSED STORM SEWER CATCHBASIN
  - 61D PROPOSED STORM SEWER INLET
  - X05 PROPOSED UTILITY CROSSING

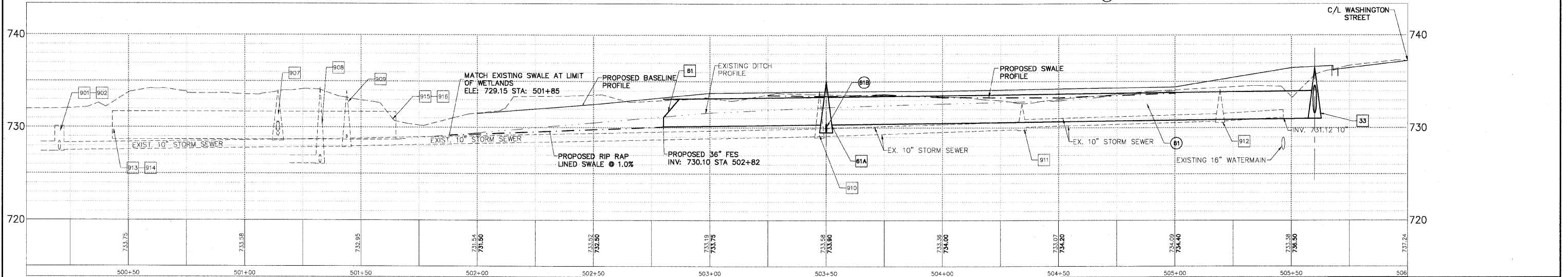

WATER OVER STORM  
B/STORM = 730.04  
T/WATER = 729.97

PLANS PREPARED BY:  
**GEWALT HAMILTON ASSOCIATES, INC.**  
Consulting Engineers & Surveyors  
650 Forest Edge Drive  
Vernon Hills, IL 60061  
(847) 478-9700  
(847) 478-9700 Fax

REVISIONS	
NAME	DATE
REV.-1 IDOT COMMENTS	02-03-06
REV.-2 PLANS STAGED	06-02-06
REV.-5 PRE-FINAL SUB	02-20-09
PS&S SUBMITTAL	04-10-09

ILLINOIS DEPARTMENT OF TRANSPORTATION  
**DRAINAGE AND UTILITY PLAN**  
STA. 500+00 TO 506+00

**PROPOSED ROADWAY RECONSTRUCTION**  
WASHINGTON STREET - OUTLOT

SCALE: H: 1"=20' V: 1"=5'  
DATE: 10-05-04

DRAWN BY: CGP  
DESIGNED BY: TPG  
CHECKED BY: BLS