

TRAFFIC SIGNAL LEGEND

	PROPOSED	EXISTING
CONTROLLER		
SERVICE INSTALLATION		
SIGNAL HEAD AND POST		
SIGNAL HEAD AND BACKPLATE		
SIGNAL HEAD, PEDESTRIAN		
SIGNAL POST		
MAST ARM ASSEMBLY AND POLE, STEEL		
MAST ARM ASSEMBLY AND POLE, ALUMINUM		
COMMON TRENCH		
UNIT DUCT		
HANDHOLE		
HEAVY DUTY HANDHOLE		
DOUBLE HANDHOLE		
GALVANIZED STEEL CONDUIT IN GROUND		
PEDESTRIAN PUSHBUTTON DETECTOR		
DETECTOR LOOP		
CONCRETE JUNCTION BOX		
CAST IRON JUNCTION BOX		
EMERGENCY VEHICLE SYSTEM DETECTOR		

F.A.U. R.T.E.	SECTION	COUNTY	TOTAL SHEETS	SHEET NO.
1223	00-00047-00-FP	LAKE	180	162
TRAFFIC SIGNAL INSTALLATION PLAN				
CONTRACT NO. 83845		ILLINOIS		

TRAFFIC SIGNAL NOTES

1. ALL STATIONS AND OFFSETS ARE DIMENSIONED FROM THE CENTERLINE OF WASHINGTON STREET.
2. THE VIDEO VEHICLE DETECTION SYSTEM'S MANUFACTURER'S REPRESENTATIVE SHALL PROVIDE ASSISTANCE IN COAXIAL AND POWER CABLE TERMINATIONS.
3. ALL DETECTION ZONES ARE APPROXIMATE. THE EXACT LOCATIONS SHALL BE DETERMINED AND LAID OUT BY LAKE COUNTY DIVISION OF TRANSPORTATION PERSONNEL.
4. THE VIDEO VEHICLE DETECTION SYSTEM, (COMPLETE INTERSECTION) AND LAYER 2 SWITCH SHALL BE RELOCATED TO THE PERMANENT TRAFFIC SIGNAL INSTALLATION FROM THE TEMPORARY SIGNAL INSTALLATION. THE RELOCATION OF THE EQUIPMENT, COMPLETE, SHALL BE CONSIDERED INCIDENTAL TO THE PAY ITEM "VIDEO DETECTION SYSTEM, (COMPLETE INTERSECTION)" AND SHALL INCLUDE ALL NECESSARY HARDWARE AND CONNECTIONS FOR PROPER INSTALLATION AND OPERATION.
5. ALL SIGNAL HEADS SHALL BE L.E.D. (LIGHT-EMITTING DIODE).

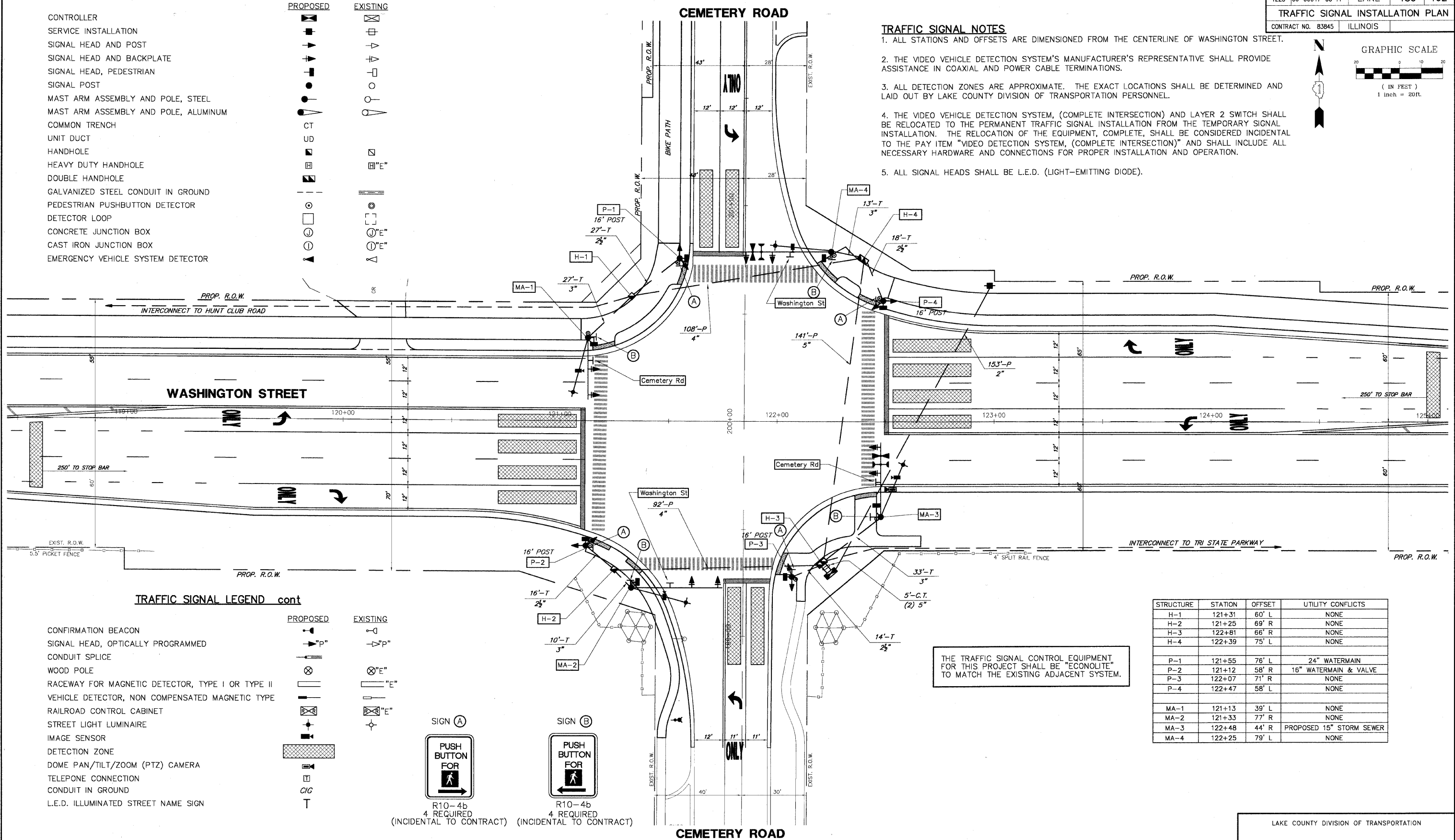
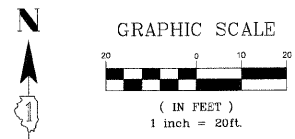

TRAFFIC SIGNAL LEGEND cont

	PROPOSED	EXISTING
CONFIRMATION BEACON		
SIGNAL HEAD, OPTICALLY PROGRAMMED		
CONDUIT SPLICE		
WOOD POLE		
RACEWAY FOR MAGNETIC DETECTOR, TYPE I OR TYPE II		
VEHICLE DETECTOR, NON COMPENSATED MAGNETIC TYPE		
RAILROAD CONTROL CABINET		
STREET LIGHT LUMINAIRE		
IMAGE SENSOR		
DETECTION ZONE		
DOMI PAN/TILT/ZOOM (PTZ) CAMERA		
TELEPHONE CONNECTION		
CONDUIT IN GROUND		
L.E.D. ILLUMINATED STREET NAME SIGN		

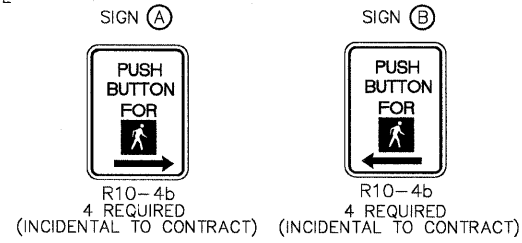

THE TRAFFIC SIGNAL CONTROL EQUIPMENT FOR THIS PROJECT SHALL BE "ECONOLITE" TO MATCH THE EXISTING ADJACENT SYSTEM.

STRUCTURE	STATION	OFFSET	UTILITY CONFLICTS
H-1	121+31	60' L	NONE
H-2	121+25	69' R	NONE
H-3	122+81	66' R	NONE
H-4	122+39	75' L	NONE
P-1	121+55	76' L	24" WATERMAIN
P-2	121+12	58' R	16" WATERMAIN & VALVE
P-3	122+07	71' R	NONE
P-4	122+47	58' L	NONE
MA-1	121+13	39' L	NONE
MA-2	121+33	77' R	NONE
MA-3	122+48	44' R	PROPOSED 15" STORM SEWER
MA-4	122+25	79' L	NONE

SCHEDULE OF COMBINATION MAST ARM ASSEMBLY AND POLES	
MA-1	30' MAST ARM - 20' LUMINAIRE ARM - 45' AUTOSCOPE MOUNTING HEIGHT
MA-2	42' MAST ARM - 20' LUMINAIRE ARM - 45' AUTOSCOPE MOUNTING HEIGHT
MA-3	34' MAST ARM - 20' LUMINAIRE ARM - 45' AUTOSCOPE MOUNTING HEIGHT
MA-4	40' MAST ARM - 20' LUMINAIRE ARM - 45' AUTOSCOPE MOUNTING HEIGHT

PLANS PREPARED BY:
GEWALT HAMILTON ASSOCIATES, INC.
 Consulting Engineers & Surveyors
 850 Forest Edge Drive
 Vernon Hills, IL 60061
 (847) 478-9700
 (847) 478-9701 Fax

REVISIONS	
NAME	DATE
PER IDOT/LCDDOT REVIEW	02-15-05
PER LCDDOT REVIEW	09-01-05
R-2 PLANS STAGED	06-02-06
REV.-5 PRE-FINAL SUB	02-20-09
PS&E SUBMITTAL	04-10-09

LAKE COUNTY DIVISION OF TRANSPORTATION

TRAFFIC SIGNAL INSTALLATION PLAN

WASHINGTON STREET AT CEMETERY ROAD

SCALE: 1"=20'
DATE: 11-15-04

DRAWN BY: CGP
DESIGNED BY: JRD
CHECKED BY: BLS