

F.A.U. R.T.E.	SECTION	COUNTY	TOTAL SHEETS	SHEET NO.
1223	00-00047-00-FP	LAKE	180	165
WASHINGTON STREET INTERCONNECT PLAN				
CONTRACT NO. 83845		ILLINOIS		

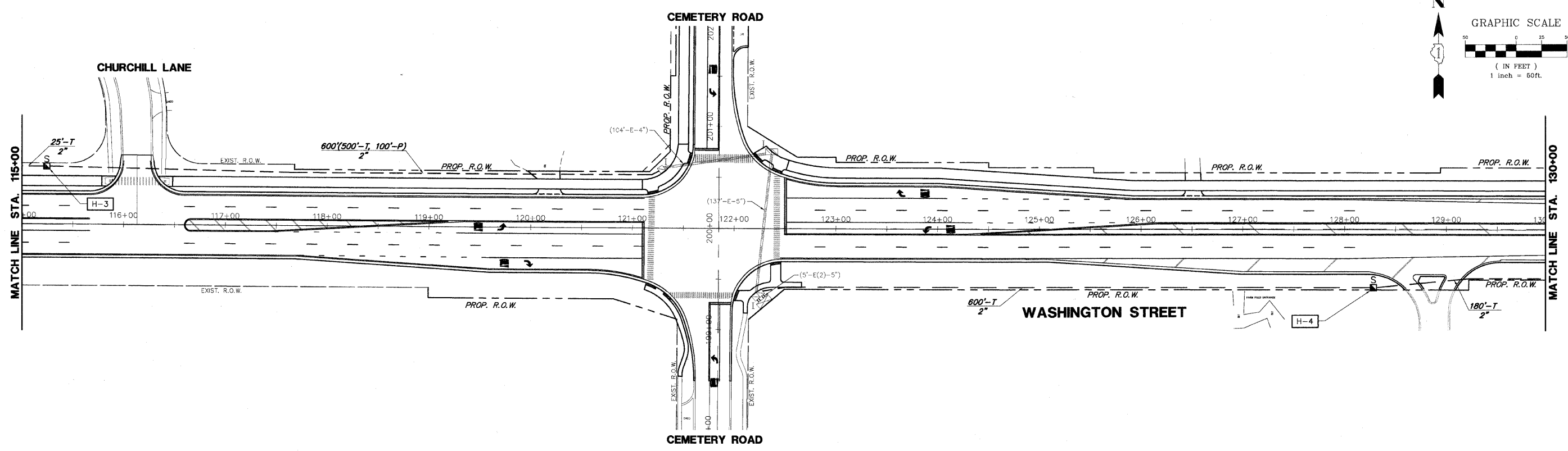

THE TRAFFIC SIGNAL CONTRACTOR SHALL COORDINATE THE PROPOSED INTERCONNECT WITH LAKE COUNTY DIVISION OF TRANSPORTATION CONTRACT NO. 83845. THIS COORDINATION WILL BE NECESSARY ONLY IF CONTRACT NO. _____ HAS BEEN INITIATED. NO ADDITIONAL COMPENSATION FOR THIS IMPORTANT COORDINATION.

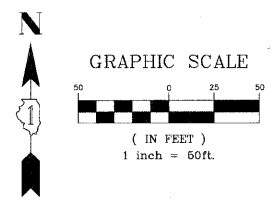
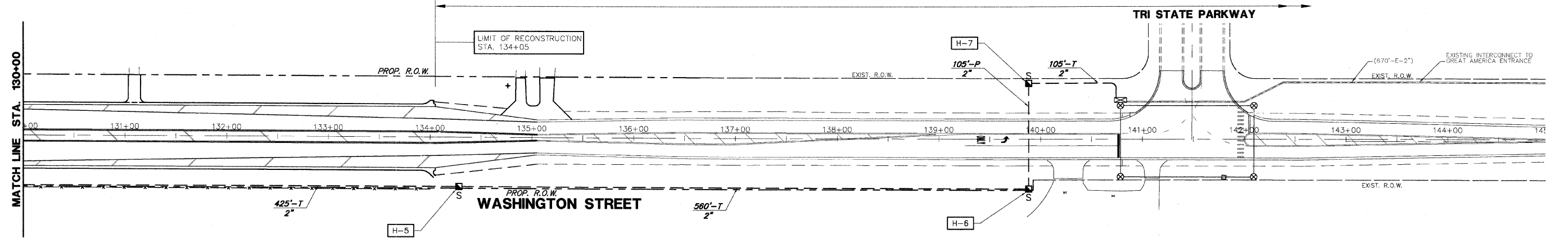

INTERCONNECT PLAN LEGEND

	PROPOSED	EXISTING
CONTROLLER	☒	☒
HANDHOLE	■	■
DOUBLE HANDHOLE	▣	▣
HEAVY-DUTY HANDHOLE	⊠	⊠
G.S. CONDUIT IN TRENCH (T) OR PUSHED (P)	---	===
DETECTOR LOOP	□	□
UNIT DUCT	U.D.	
SYSTEM	S	
INTERSECTION	IP	I

STRUCTURE	STATION	OFFSET	UTILITY CONFLICTS
H-3	115+24	57' L	NONE
H-4	128+28	57' R	NONE
H-5	134+28	47' R	NONE
H-6	139+88	47' R	NONE
H-7	139+88	47' L	24" WATERMAIN, VILLAGE OF GURNEE

PLANS PREPARED BY:
GEWALT HAMILTON ASSOCIATES, INC.
 Consulting Engineers & Surveyors
 850 Forest Edge Drive
 Vernon Hills, IL 60061
 (847) 476-9700
 (847) 476-9701 Fax

REVISIONS	
NAME	DATE
PER IDOT/LCDDOT REVIEW	02-15-05
PER LCDDOT REVIEW	09-01-05
R-2 PLANS STAGED	06-02-06
REV.-5 PRE-FINAL SUB	02-20-09
PS&E SUBMITTAL	04-10-09

LAKE COUNTY DIVISION OF TRANSPORTATION
INTERCONNECT PLAN
SHEET 2 OF 2
 WASHINGTON STREET
 STA 115+00 TO 145+00
 SCALE: 1"=50'
 DATE: 10-25-04
 DRAWN BY: CGP
 DESIGNED BY: JRD
 CHECKED BY: BLS