

| | | | | |
|-----------------------|---------|----------|------------------|-----------|
| ROUTE NO. | SECTION | COUNTY | TOTAL SHEETS | SHEET NO. |
| VAR | * | VAR | 66 | 52 |
| FED. ROAD DIST. NO. 4 | | ILLINOIS | FED. AID PROJECT | |

*** D4 SCOUR MITIGATION 2006**

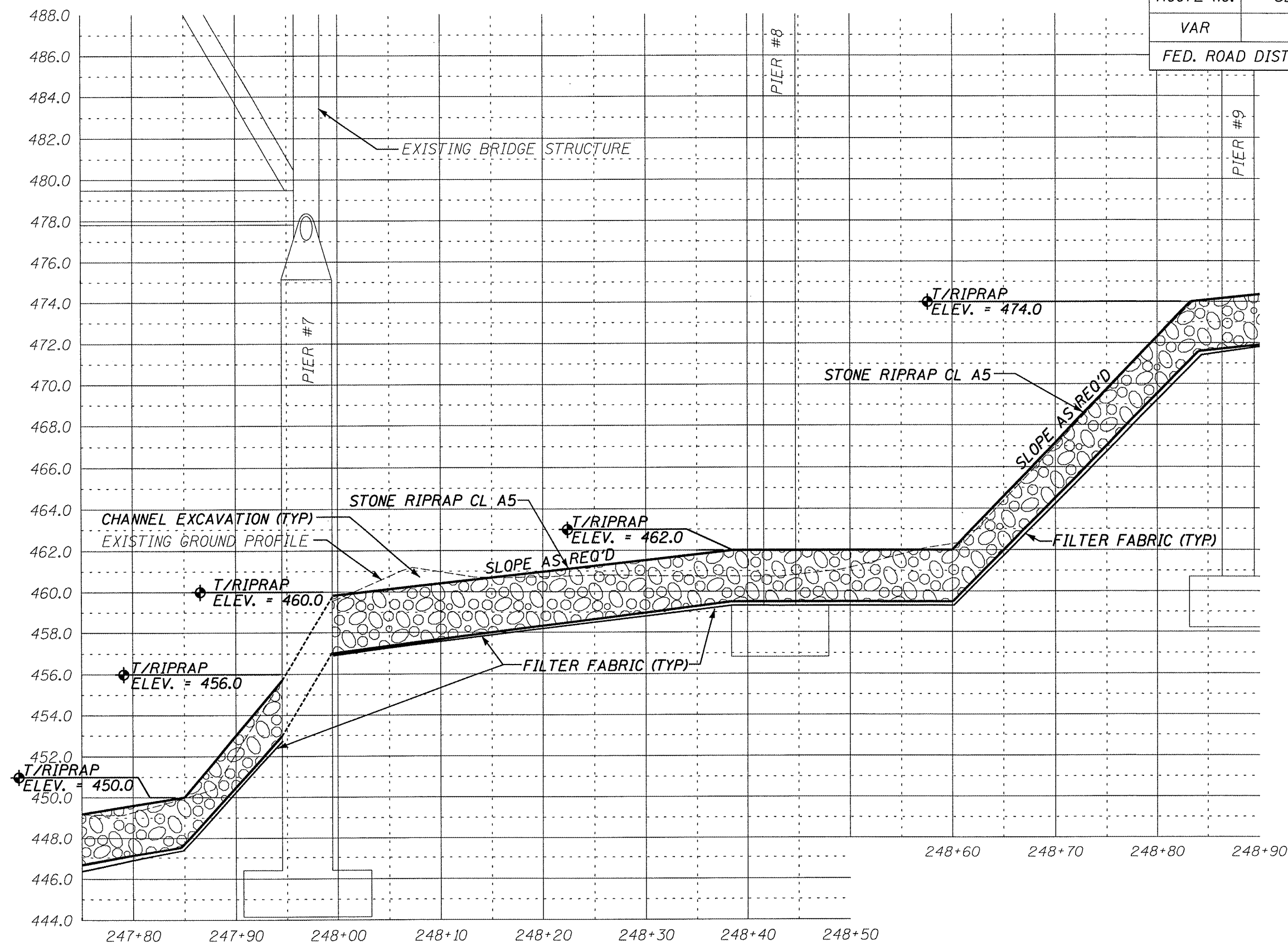

ILLINOIS DEPARTMENT OF TRANSPORTATION
 SITE CROSS SECTION
 S.N. 072-0037
 F.A.P. 669 (IL RTE. 116) OVER
 BN & CNW R.R., KICKAPOO CREEK
 & CH 77 F.A. RTE. 669
 PEORIA COUNTY
 SCALE: VERT. 1" = 5' HORIZ. 1" = 10' SHEET 11 OF 15