

LEGEND

- R.O.W.
- PROPOSED R.O.W. LINE
- CONSTRUCTION LIMITS
- CONCRETE ABUTMENT
- STREAM CENTERLINE
- RIPRAP
- AERIAL ELECTRIC

ROUTE NO.	SECTION	COUNTY	TOTAL SHEETS	SHEET NO.
VAR	*	VAR	66	58
FED. ROAD DIST. NO. 4		ILLINOIS	FED. AID PROJECT	

* D4 SCOUR MITIGATION 2006

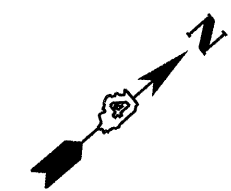
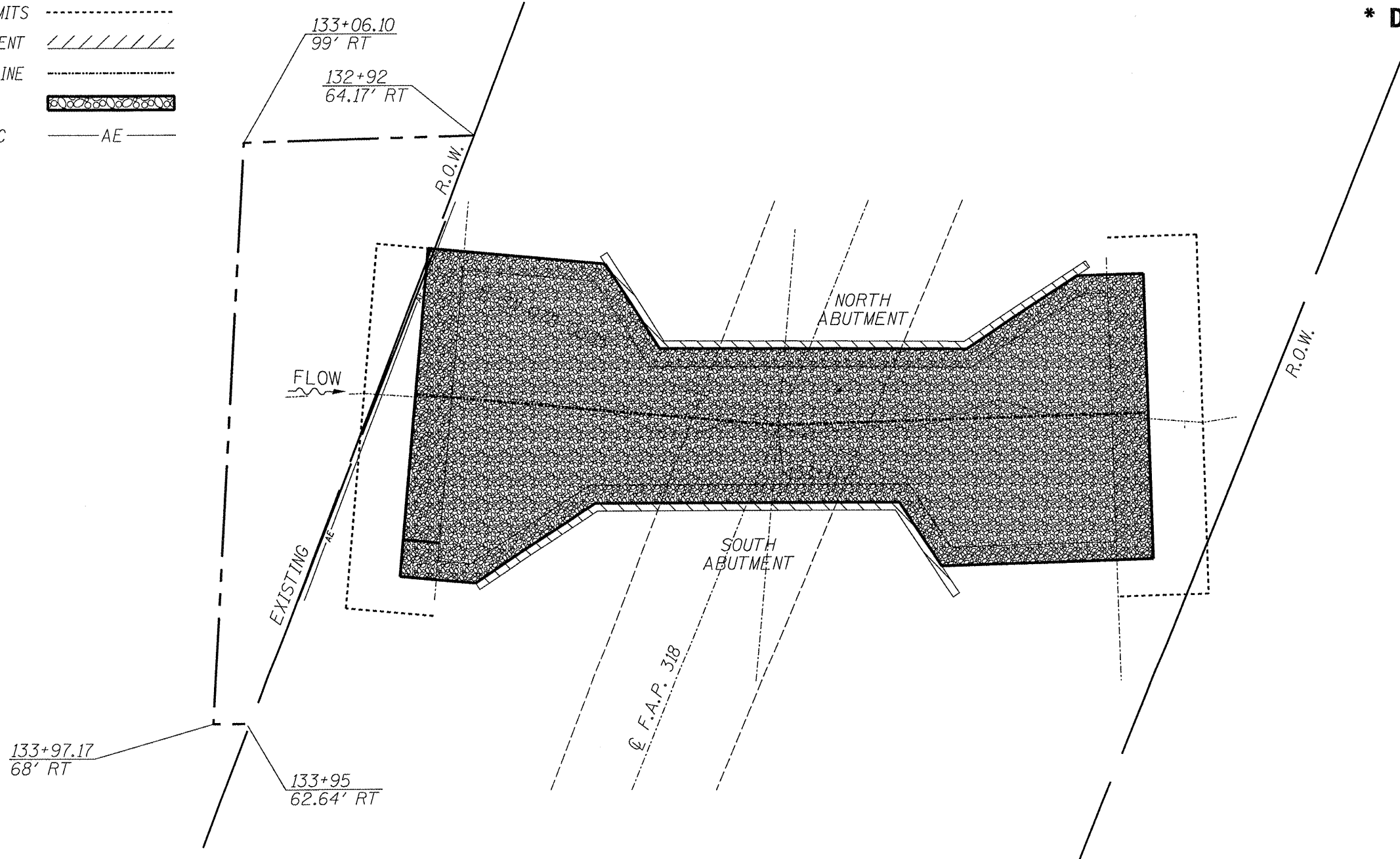

ILLINOIS DEPARTMENT OF TRANSPORTATION
 R.O.W. PLAN
 S.N. 078-0005
 F.A.P. 318 (IL 29)
 OVER ILL. RIVER TRIBUTARY
 PUTNAM COUNTY
 SHEET 2 OF 7

SCALE: 1" = 20'