

PLAN	DATE
BY	
REVIEWED	
PLOTTED	
ALIGNMENT CHECKED	
NOTE BOOK	
CADD FILE NAME	
NO.	

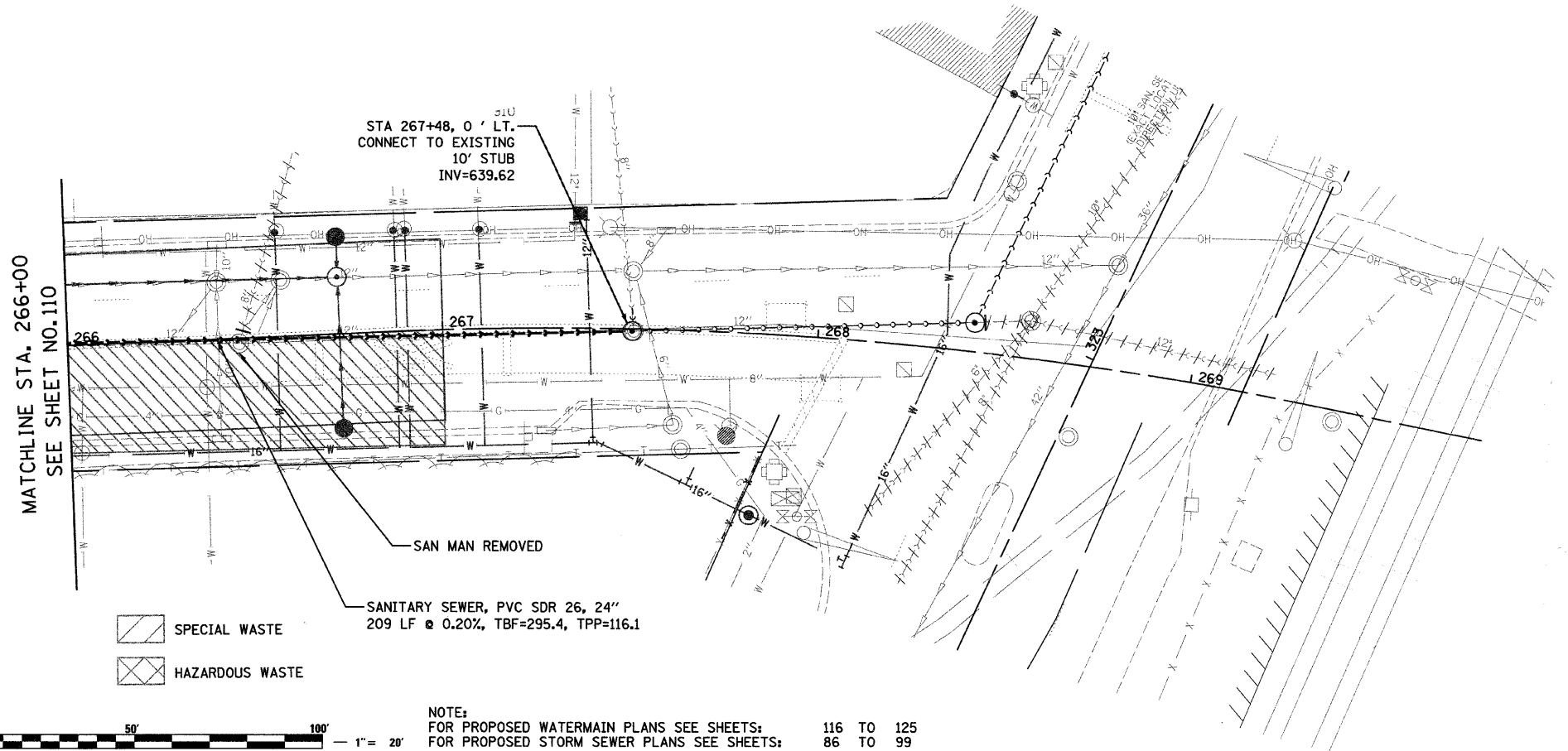

NOTE:
 FOR PROPOSED WATERMAIN PLANS SEE SHEETS: 116 TO 125
 FOR PROPOSED STORM SEWER PLANS SEE SHEETS: 86 TO 99

PROFILE	DATE
BY	
REVIEWED	
PLOTTED	
GRADES CHECKED	
STRUCTURE NOTATION CHECKED	
NOTE BOOK	
NO.	

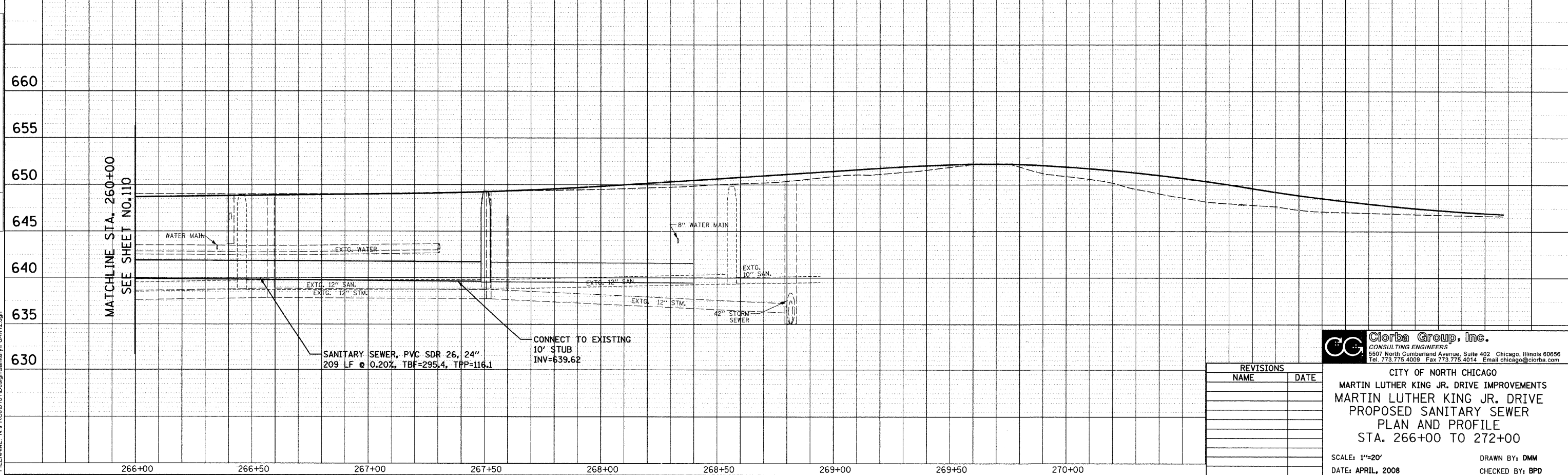

SANITARY SEWER, PVC SDR 26, 24"
 209 LF @ 0.20%, TBF=295.4, TPP=116.1

CONNECT TO EXISTING
 10' STUB
 INV=639.62

REVISIONS	
NAME	DATE

Clorba Group, Inc.
 CONSULTING ENGINEERS
 5507 North Cumberland Avenue, Suite 402 Chicago, Illinois 60656
 Tel. 773.775.4009 Fax 773.775.4014 Email: chicago@clorba.com

CITY OF NORTH CHICAGO
 MARTIN LUTHER KING JR. DRIVE IMPROVEMENTS
 MARTIN LUTHER KING JR. DRIVE
 PROPOSED SANITARY SEWER
 PLAN AND PROFILE
 STA. 266+00 TO 272+00

SCALE: 1"=20'
 DATE: APRIL, 2008

DRAWN BY: DMM
 CHECKED BY: BPD

DATE: 7/1/2008
 TIME: 11:41 AM
 FILENAME: N:\PROJ\0516\Design\sanitary\PSAN12.dgn