

**EXISTING EQUIPMENT TO BE REMOVED LEGEND**

- EXISTING SIGNAL HEAD TO BE REMOVED
- EXISTING SIGNAL POST AND FOUNDATION TO BE REMOVED
- EXISTING ALUMINUM MAST ARM POLE AND FOUNDATION TO BE REMOVED
- EXISTING CONTROLLER AND FOUNDATION TO BE RELOCATED
- EXISTING HANDHOLE TO BE REMOVED
- EXISTING PEDESTRIAN SIGNAL HEAD TO BE REMOVED
- EXISTING PEDESTRIAN PUSH-BUTTON TO BE REMOVED
- EXISTING EMERGENCY VEHICLE SYSTEM DETECTOR TO BE RELOCATED
- EXISTING CONFIRMATION BEACON TO BE REMOVED
- EXISTING HEAVY DUTY HANDHOLE TO BE REMOVED

**TEMPORARY TRAFFIC SIGNAL LEGEND**

- TEMPORARY TRAFFIC SIGNAL HEAD
- SPAN WIRE MOUNTED ORIGINAL LOCATION
- TEMPORARY TRAFFIC SIGNAL HEAD
- SPAN WIRE MOUNTED SECONDARY LOCATION
- TEMPORARY WOOD POLE (CLASS 5 OR BETTER) 55 FOOT (13.7m) MINIMUM
- EXISTING CONTROLLER CABINET
- TEMPORARY SPANE WIRE, TETHER WIRE, AND CABLE
- EXISTING AND PROPOSED TEMPORARY SERVICE INSTALLATION
- TEMPORARY PEDESTRIAN SIGNAL HEAD, BRACKET MOUNTED
- TEMPORARY PEDESTRIAN PUSH-BUTTON DETECTOR
- IMAGE SENSOR
- EMERGENCY VEHICLE LIGHT DETECTOR
- CONFIRMATION BEACON
- CONSTRUCTION BARREL

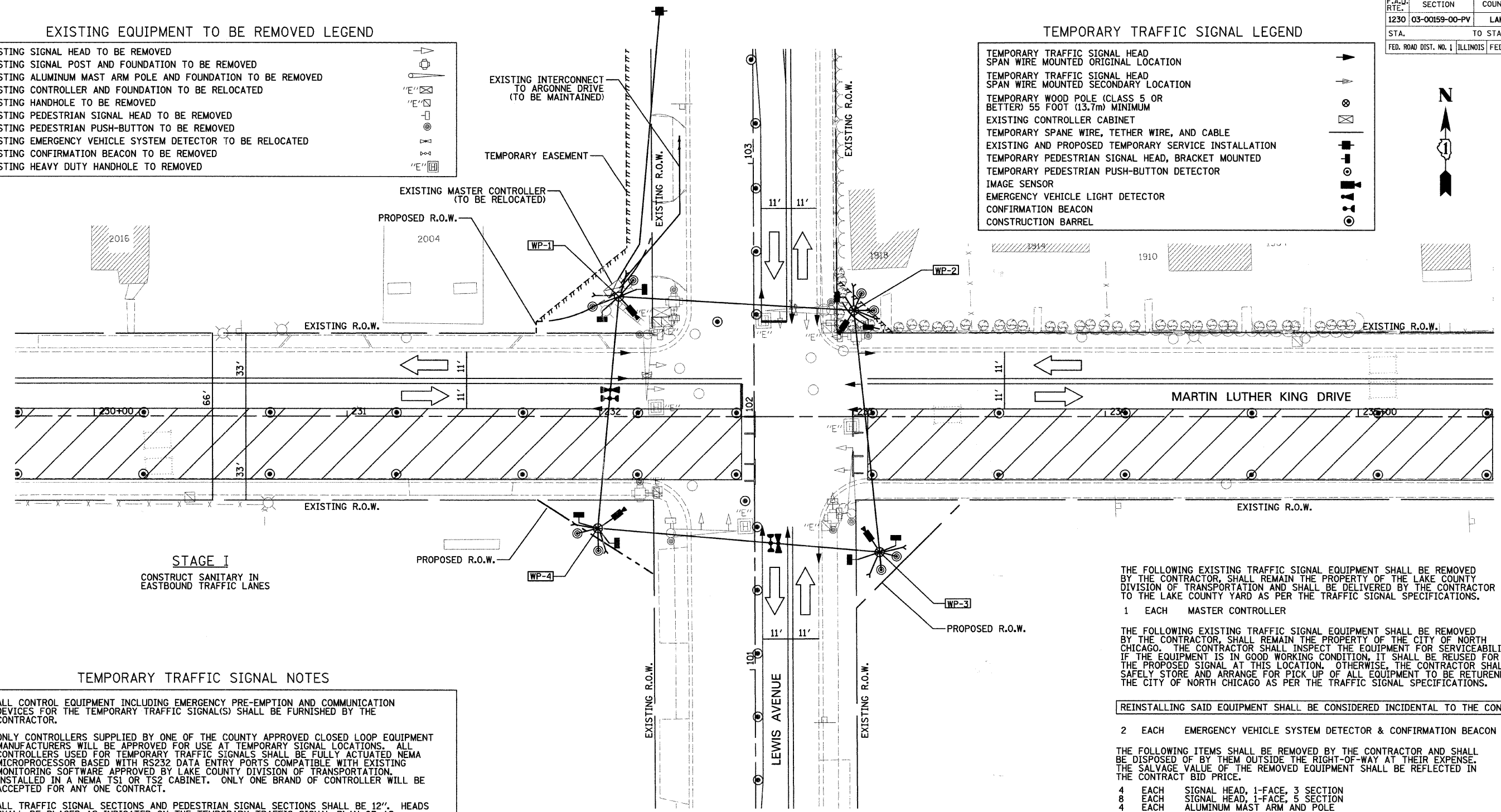

**STAGE I**  
CONSTRUCT SANITARY IN EASTBOUND TRAFFIC LANES

**TEMPORARY TRAFFIC SIGNAL NOTES**

1. ALL CONTROL EQUIPMENT INCLUDING EMERGENCY PRE-EMPTION AND COMMUNICATION DEVICES FOR THE TEMPORARY TRAFFIC SIGNAL(S) SHALL BE FURNISHED BY THE CONTRACTOR.
2. ONLY CONTROLLERS SUPPLIED BY ONE OF THE COUNTY APPROVED CLOSED LOOP EQUIPMENT MANUFACTURERS WILL BE APPROVED FOR USE AT TEMPORARY SIGNAL LOCATIONS. ALL CONTROLLERS USED FOR TEMPORARY TRAFFIC SIGNALS SHALL BE FULLY ACTUATED NEMA MICROPROCESSOR BASED WITH RS232 DATA ENTRY PORTS COMPATIBLE WITH EXISTING MONITORING SOFTWARE APPROVED BY LAKE COUNTY DIVISION OF TRANSPORTATION. INSTALLED IN A NEMA TS1 OR TS2 CABINET. ONLY ONE BRAND OF CONTROLLER WILL BE ACCEPTED FOR ANY ONE CONTRACT.
3. ALL TRAFFIC SIGNAL SECTIONS AND PEDESTRIAN SIGNAL SECTIONS SHALL BE 12". HEADS SHALL BE PLACED AS INDICATED ON THE TEMPORARY TRAFFIC SIGNAL PLAN OR AS DIRECTED BY THE ENGINEER. THE CONTRACTOR SHALL FURNISH ENOUGH CABLE SLACK TO RELOCATE HEADS TO ANY POSITION ON THE SPAN WIRE OR AT LOCATIONS ILLUSTRATED ON THE PLANS FOR CONSTRUCTION STAGING. THE TEMPORARY TRAFFIC SIGNAL SHALL REMAIN IN OPERATION DURING ALL SIGNAL HEAD RELOCATIONS. EACH TEMPORARY TRAFFIC SIGNAL HEAD SHALL HAVE ITS OWN CABLE FROM THE CONTROLLER CABINET TO THE SIGNAL HEAD.
4. ALL EXISTING STREET NAME AND INTERSECTION REGULATORY SIGNS SHALL BE REMOVED FROM EXISTING POLES, RELOCATED AND SECURELY FASTENED TO THE SIGNAL SPAN WIRE OR WOOD POLE AS DIRECTED BY THE ENGINEER.
5. ANY TEMPORARY SIGNAL WITHIN AN EXISTING CLOSED LOOP TRAFFIC SIGNAL SYSTEM SHALL BE INTERCONNECTED TO THAT SYSTEM USING SIMILAR BRAND CONTROL EQUIPMENT.
6. THE VIDEO VEHICLE DETECTION CAMERAS SHALL BE MOUNTED ON THE TEMPORARY WOOD POLES AT A NOMINAL MOUNTING HEIGHT OF FORTY (40) FEET.
7. UPON COMPLETION OF THE PERMANENT TRAFFIC SIGNAL INSTALLATION THE VIDEO VEHICLE DETECTION SYSTEM, COMPLETE, SHALL BE RELOCATED FROM THE TEMPORARY TRAFFIC SIGNAL INSTALLATION TO THE PERMANENT TRAFFIC SIGNAL INSTALLATION. THE VIDEO VEHICLE DETECTION SYSTEM AND THE RELOCATION OF THIS EQUIPMENT SHALL BE PAID FOR EACH AS "VIDEO DETECTION SYSTEM COMPLETE INTERSECTION".

**NOTE:**  
THE TRAFFIC SIGNAL CONTROLLER EQUIPMENT FOR THIS PROJECT SHALL BE "ECONOLITE" TO MATCH THE EXISTING ADJACENT SYSTEM.

THE FOLLOWING EXISTING TRAFFIC SIGNAL EQUIPMENT SHALL BE REMOVED BY THE CONTRACTOR, SHALL REMAIN THE PROPERTY OF THE LAKE COUNTY DIVISION OF TRANSPORTATION AND SHALL BE DELIVERED BY THE CONTRACTOR TO THE LAKE COUNTY YARD AS PER THE TRAFFIC SIGNAL SPECIFICATIONS.

- 1 EACH MASTER CONTROLLER

THE FOLLOWING EXISTING TRAFFIC SIGNAL EQUIPMENT SHALL BE REMOVED BY THE CONTRACTOR, SHALL REMAIN THE PROPERTY OF THE CITY OF NORTH CHICAGO. THE CONTRACTOR SHALL INSPECT THE EQUIPMENT FOR SERVICEABILITY. IF THE EQUIPMENT IS IN GOOD WORKING CONDITION, IT SHALL BE REUSED FOR THE PROPOSED SIGNAL AT THIS LOCATION. OTHERWISE, THE CONTRACTOR SHALL SAFELY STORE AND ARRANGE FOR PICK UP OF ALL EQUIPMENT TO BE RETURNED TO THE CITY OF NORTH CHICAGO AS PER THE TRAFFIC SIGNAL SPECIFICATIONS.

REINSTALLING SAID EQUIPMENT SHALL BE CONSIDERED INCIDENTAL TO THE CONTRACT

- 2 EACH EMERGENCY VEHICLE SYSTEM DETECTOR & CONFIRMATION BEACON

THE FOLLOWING ITEMS SHALL BE REMOVED BY THE CONTRACTOR AND SHALL BE DISPOSED OF BY THEM OUTSIDE THE RIGHT-OF-WAY AT THEIR EXPENSE. THE SALVAGE VALUE OF THE REMOVED EQUIPMENT SHALL BE REFLECTED IN THE CONTRACT BID PRICE.

- 4 EACH SIGNAL HEAD, 1-FACE, 3 SECTION
- 8 EACH SIGNAL HEAD, 1-FACE, 5 SECTION
- 4 EACH ALUMINUM MAST ARM AND POLE
- 4 EACH SIGNAL POST
- 8 EACH PEDESTRIAN SIGNAL HEAD, 1-FACE
- 8 EACH PEDESTRIAN PUSHBUTTON
- 1 EACH SERVICE INSTALLATION
- 1 EACH CONTROLLER CABINET

**STRUCTURE STATION OFFSET POSSIBLE UTILITY CONFLICTS**

STRUCTURE	STATION	OFFSET	POSSIBLE UTILITY CONFLICTS
WP-1	232+08	47' LT	NONE
WP-2	232+95	40' LT	EXISTING WATER MAIN
WP-3	233+11	54' RT	NONE
WP-4	232+99	44' RT	NONE



**Clorba Group, Inc.**  
CONSULTING ENGINEERS  
5507 North Cumberland Avenue, Suite 402 Chicago, Illinois 60656  
Tel. 773.775.4009 Fax 773.775.4014 Email: chicago@clorba.com

CITY OF NORTH CHICAGO  
MARTIN LUTHER KING JR. DRIVE IMPROVEMENTS  
TEMPORARY TRAFFIC SIGNAL  
INSTALLATION PLAN AND REMOVAL PLAN  
MARTIN LUTHER KING JR. DRIVE  
AND LEWIS AVENUE  
STAGE I

REVISIONS	
NAME	DATE

SCALE: 1"=20'  
DATE: APRIL, 2008  
DRAWN BY: KDM  
CHECKED BY: MJL