

F.A.U. RTE.	SECTION	COUNTY	TOTAL SHEETS	SHEET NO.
1230	03-00159-00-PV	LAKE	262	162
STA. 252+00	TO STA. 277+00			
FED. ROAD DIST. NO. 1	ILLINOIS	FED. AID PROJECT		

CONTRACT: 83828

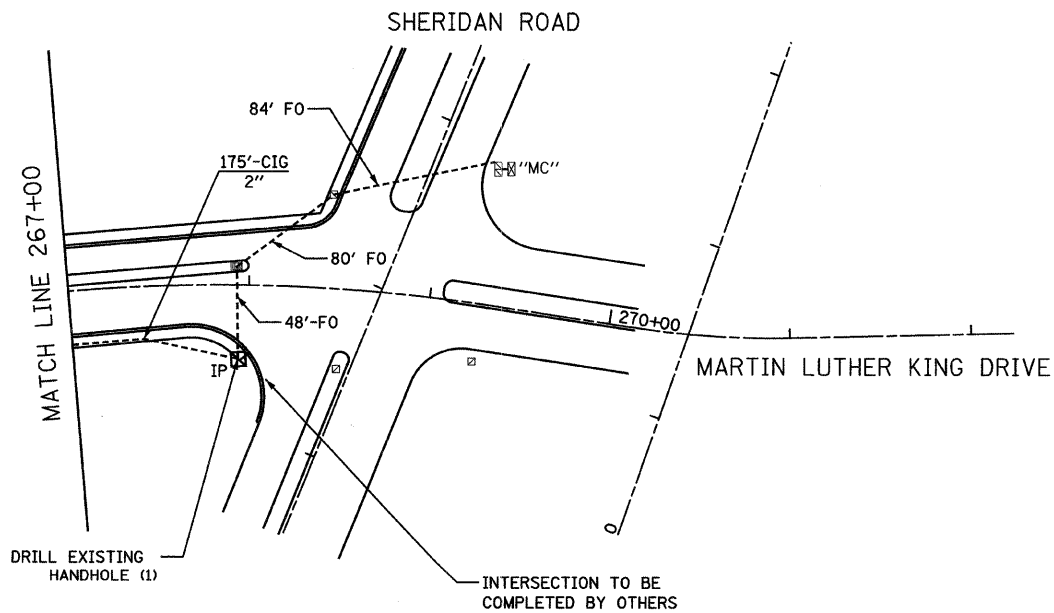
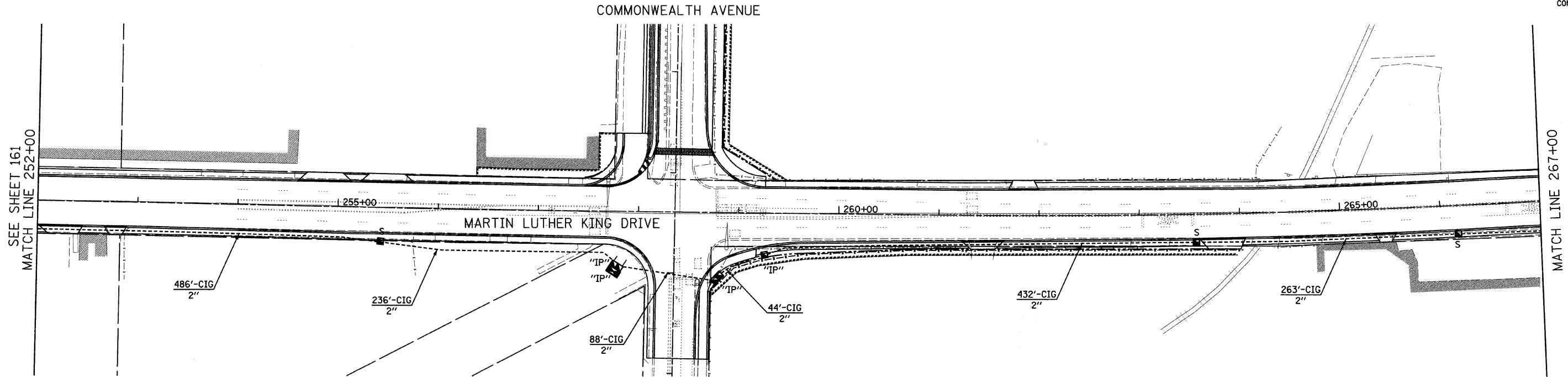

SCHEDULE OF QUANTITIES

CODE NUMBER	DESCRIPTION	UNIT	QUANTITY
81400100	HANDHOLE	EACH	15
85000200	MAINTENANCE OF EXISTING TRAFFIC SIGNAL INSTALLATION	EACH	2
87900200	DRILL EXISTING HANDHOLE	EACH	5
89502210	MODIFY EXISTING CONTROLLER CABINET	EACH	1
89502300	REMOVE ELECTRIC CABLE FROM CONDUIT	FOOT	2040
X0322925	ELECTRIC CABLE IN CONDUIT, TRACER, NO. 14 1C	FOOT	17917
X8710020	FIBER OPTIC CABLE IN CONDUIT, NO. 62.5/125, MM12F SM12F	FOOT	17917
	CONDUIT IN GROUND 2" DIA., GALVANIZED STEEL	FOOT	10304

INTERCONNECT PLAN LEGEND

	PROPOSED	EXISTING
CONTROLLER		
HANDHOLE		
HEAVY DUTY HANDHOLE		
DOUBLE HANDHOLE		
G.S. CONDUIT IN GROUND (CIG)		
DETECTOR LOOP		
SYSTEM	"S"	
INTERSECTION	"IP"	"I"
UNIT DUCT	UD	
COMMON TRENCH	CT	
TELEPHONE CONNECTION		
MASTER CONTROLLER		"MC"

DATE: 7/1/2008
TIME: 8:37:09 AM
FILENAME: N:\PROJ\5161\Design\Signals\Plan Sheets\5161-18-Interconnect-C4.dgn

Clorba Group, Inc.
CONSULTING ENGINEERS
5507 North Cumberland Avenue, Suite 402 Chicago, Illinois 60656
Tel. 773.775.4009 Fax 773.775.4014 Email: chicago@clorba.com

REVISIONS	
NAME	DATE

CITY OF NORTH CHICAGO
MARTIN LUTHER KING JR. DRIVE IMPROVEMENTS
TRAFFIC SIGNAL INTERCONNECT PLAN
MARTIN LUTHER KING JR. DRIVE

SCALE: 1"=50'
DATE: APRIL, 2008
DRAWN BY: KDM
CHECKED BY: MJL