

F.A.U. RTE.	SECTION	COUNTY	TOTAL SHEETS	SHEET NO.
1230	03-00159-00-PV	LAKE	262	172
STA. 192+00		TO STA. 222+00		
FED. ROAD DIST. NO. 1 ILLINOIS FED. AID PROJECT				

CONTRACT: 83828

LIGHTING GENERAL NOTES

- ALL CONSTRUCTION SHALL BE DONE IN ACCORDANCE WITH THE CONTRACT SPECIFICATIONS AS WELL AS:
ILLINOIS DEPARTMENT OF TRANSPORTATION STANDARD SPECIFICATIONS FOR ROAD AND BRIDGE CONSTRUCTION AS ADOPTED JANUARY 1, 2007.
ILLINOIS DEPARTMENT OF TRANSPORTATION SUPPLEMENTAL SPECIFICATIONS AND RECURRING SPECIAL PROVISIONS ADOPTED JANUARY 1, 2008.
ILLINOIS MANUAL ON UNIFORM TRAFFIC CONTROL DEVICES FOR STREETS AND HIGHWAYS (LATEST EDITION IN EFFECT ON THE DATE OF INVITATION FOR BIDS).
NATIONAL ELECTRIC CODE, 2005 EDITION.
 - DISTRICT ONE RECURRING SPECIAL PROVISIONS FOR ROADWAY LIGHTING, LATEST EDITION.
- THE CONTRACTOR SHALL MAINTAIN A SET OF CONSTRUCTION RECORD DRAWINGS NOTING ALL CHANGES TO THE PLANS AND THE LOCATION AND DEPTH OF ALL UNDERGROUND UTILITIES ENCOUNTERED. A MYLAR REPRODUCIBLE AS-BUILT DRAWING AND TWO (2) PAPER SETS MUST BE SUBMITTED TO THE CITY OF NORTH CHICAGO DEPARTMENT OF ENGINEERING FOR REVIEW AND APPROVAL UPON COMPLETION OF THE PROJECT.
- NOMINAL QUANTITIES FOR THE FOLLOWING PAY ITEMS HAVE BEEN INCLUDED IN THE PLANS AND SHALL BE UTILIZED AS DIRECTED BY THE ENGINEER:

LIGHT POLE FOUNDATION, 24" DIA., OFFSET	440 L. F.
TEST HOLE	65 EACH
BOLLARDS	2 EACH
 - WITHIN THIRTY (30) DAYS AFTER THE CONTRACT IS SIGNED AND BEFORE ANY WORK IS AUTHORIZED BY THE ENGINEER, THE CONTRACTOR SHALL SUBMIT MANUFACTURER'S LITERATURE PERTAINING TO LIGHTING WORK FOR THE ELECTRICAL ENGINEER'S REVIEW AND APPROVAL.
 - IT SHALL BE THE CONTRACTOR'S RESPONSIBILITY TO MARK THE PROPOSED LOCATIONS OF ALL LUMINAIRES FOR EXAMINATION AND CONFIRMATION WITH THE ENGINEER AT THE PRE-CONSTRUCTION INSPECTION.
 - THE ENGINEER SHALL APPROVE THE LOCATIONS OF ALL PUSH PITS.
 - NO CONSTRUCTION MATERIALS OR EQUIPMENT SHALL BE STORED IN OR MOVED THROUGH THE DRIPLINE OF ANY PARKWAY TREE.

- THE ATTENTION OF THE CONTRACTOR IS DIRECTED TO ARTICLE 801.04 OF THE STANDARD SPECIFICATIONS REGARDING THE PROPOSED LOCATIONS OF THE LIGHTING SYSTEM. ADDITIONALLY, THE UNIT DUCT ROUTING SHOWN ON THE PLANS IS MAINLY INTENDED TO SHOW ELECTRICAL CIRCUITRY. AN EFFORT HAS BEEN MADE TO AVOID UTILITY CONFLICTS BUT THE EXACT LOCATION OF ELECTRICAL CABLES AND CONDUITS SHOULD BE APPROVED BY THE ENGINEER AFTER THE UNDERGROUND UTILITIES HAVE BEEN LOCATED BY THEIR OWNERS. QUANTITIES SHOWN FOR UNIT DUCT AND CONDUIT SHALL BE CONFIRMED IN THE FIELD. THE ENGINEER SHALL APPROVE THE LOCATIONS OF ALL PUSH PITS.

THE CONTRACTOR SHALL KEEP DEVIATIONS FROM THE UNIT DUCT ROUTING SHOWN ON THE PLANS TO A MINIMUM. MAJOR DEVIATIONS SHALL BE REPORTED TO AND APPROVED BY THE ENGINEER BEFORE INSTALLATION.
- THE CONTRACTOR SHALL MAKE SPECIAL NOTE OF THE REQUIREMENT FOR BURIED WARNING TAPE, SPECIFIED AS PART OF "TRENCH AND BACKFILL FOR ELECTRICAL WORK". THE INSTALLATION OF THE TAPE SHALL BE INSPECTED AND APPROVED BY THE RESIDENT ENGINEER PRIOR TO BACKFILLING OR DURING PLOWING OPERATIONS, AS APPLICABLE.
- THE CONTRACTOR SHALL BE RESPONSIBLE FOR THE ESTABLISHMENT OF FINISHED GRADE. THE RESIDENT MAY ASSIST THE CONTRACTOR, AS APPLICABLE, BUT THE RESPONSIBILITY FOR COORDINATING THE FINISHED GRADE ELEVATION WITH THE TOP OF THE FOUNDATION HEIGHT SHALL REMAIN WITH THE CONTRACTOR.
- NO POLES SHALL BE ERECTED UNTIL THE RESPECTIVE FOUNDATIONS HAVE CURED, AS APPROVED BY THE ENGINEER.
- THE CONTRACTOR SHALL MAKE SPECIAL NOTE OF THE REQUIREMENTS FOR WIRE MARKERS AND SHALL TAG ALL WIRE MARKERS ACCORDINGLY.
- THE CONTRACTOR SHALL MAKE SPECIAL NOTE OF THE REQUIREMENTS FOR SPLICING ELECTRICAL CABLE. SEE "GENERAL ELECTRICAL REQUIREMENTS" AND SPLICING DETAIL ON SHEET 191.
- THE CONTRACTOR SHALL MAKE NOTE OF THE REQUIREMENTS FOR GROUNDING.
A. GROUNDING CONNECTIONS AT THE FOUNDATION STEEL AND AT THE GROUND ROD SHALL BE EXOTHERMICALLY WELDED, AS SPECIFIED, AND SHALL BE INSPECTED AND APPROVED BY THE RESIDENT ENGINEER PRIOR TO POURING CONCRETE OR BACKFILLING, AS APPLICABLE.
- THE CONTRACTOR SHALL DISPOSE OF THE EXISTING ELECTRICAL MATERIAL AS DIRECTED BY THE ENGINEER. THE COST OF THIS WORK SHALL BE INCLUDED IN THE RESPECTIVE PAY ITEM.

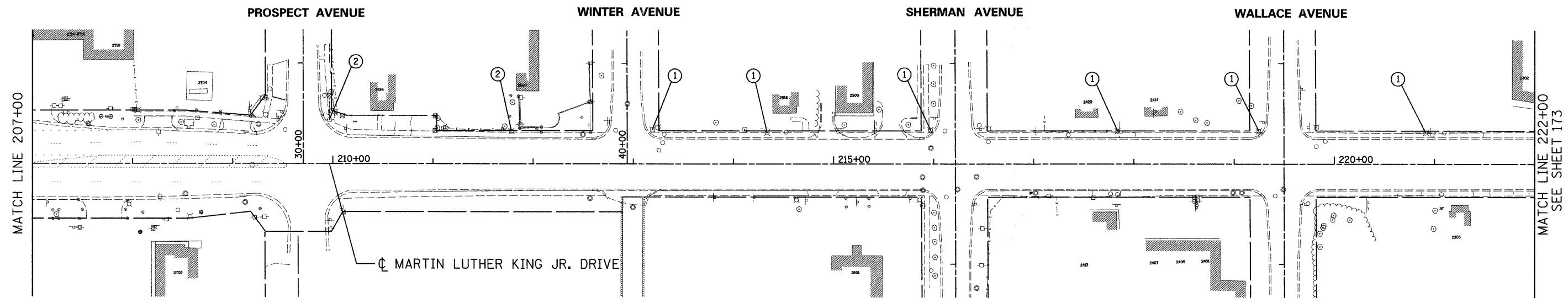
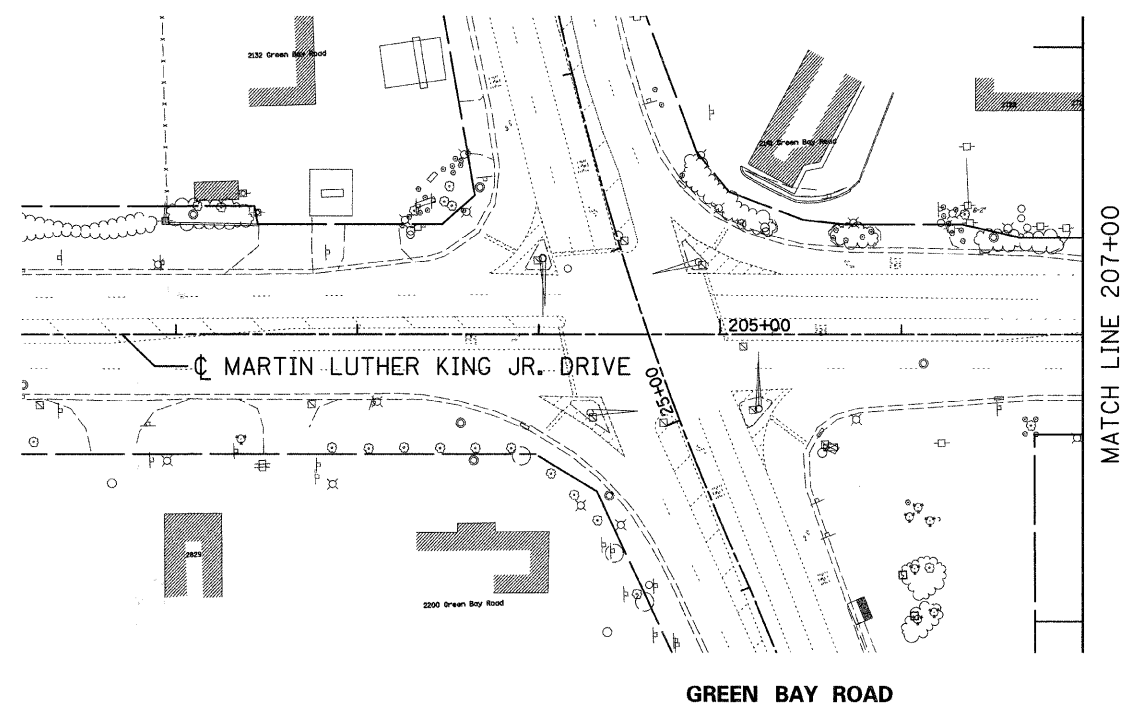

- LEGEND**
- ① REMOVE WOOD POLE, MAST ARM AND LUMINAIRE (BY OTHERS)
 - ② REMOVE MAST ARM AND LUMINAIRE (BY OTHERS)

REVISIONS	
NAME	DATE

Ciorba Group, Inc.
CONSULTING ENGINEERS
5507 North Cumberland Avenue, Suite 402 Chicago, Illinois 60656
Tel. 773.775.4009 Fax 773.775.4014 Email chicago@ciorba.com

CITY OF NORTH CHICAGO
MARTIN LUTHER KING JR. DRIVE IMPROVEMENTS
MARTIN LUTHER KING JR. DRIVE
EXISTING LIGHTING
REMOVAL PLAN

SCALE: 1"=50'
DATE: APRIL, 2008
DRAWN BY: KDM
CHECKED BY: JMW

DATE: 7/1/2008
TIME: 10:33:33 AM
FILENAME: N:\PROJ\5161\Design\Lighting\5161-LightRemoval01.dgn