

TYPICAL RAIL ROAD RELATED PAVEMENT MARKINGS

TYPICAL PLACEMENT OF R.R. WARNING SIGNS AND PAVEMENT MARKINGS ON COUNTY HIGHWAYS

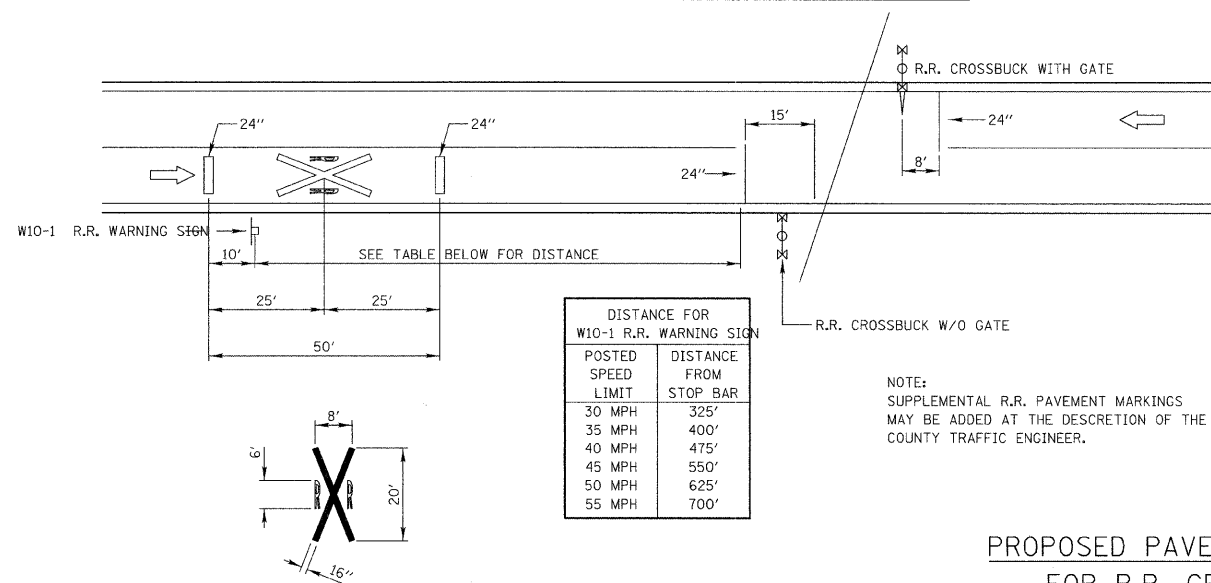

PROPOSED PAVEMENT MARKINGS FOR R.R. CROSSINGS AT SIGNALIZED INTERSECTIONS 81 FEET - 300 FEET

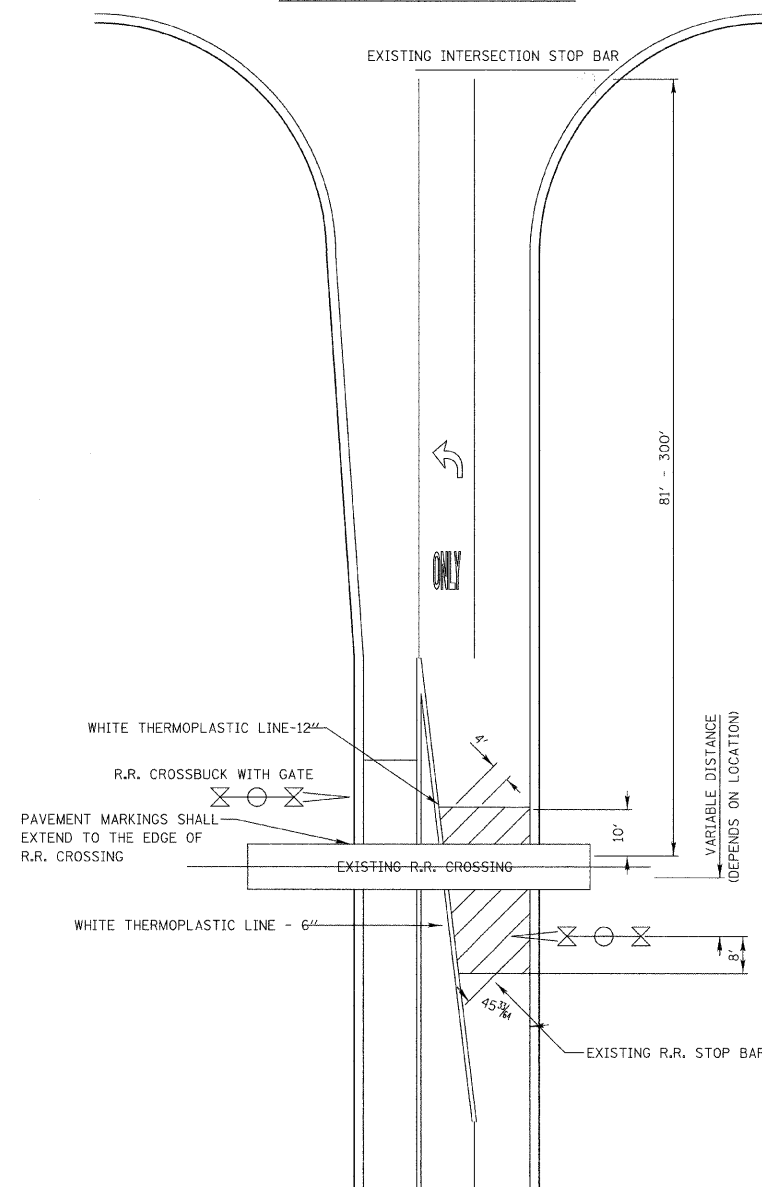

PROPOSED PAVEMENT MARKINGS FOR R.R. CROSSINGS AT SIGNALIZED INTERSECTIONS 81 FEET OR LESS

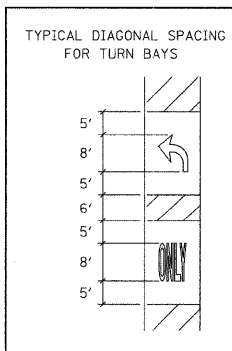
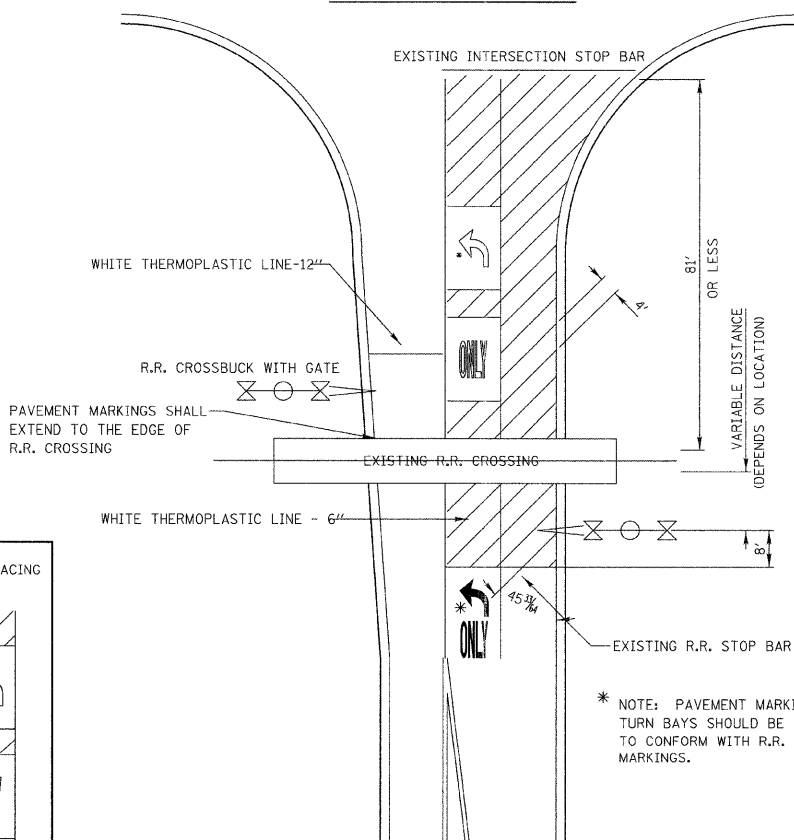

REVISIONS	DATE	APPROVED BY: A. KHAWAJA
		DATE: APRIL 1, 2007
Lake County Division of Transportation TYPICAL PAVEMENT MARKINGS FOR RAILROAD CROSSINGS ON COUNTY HIGHWAYS SHEET 3 OF 3		

REVISIONS / REMARKS				
NO.	DESCRIPTION	DATE	BY	SURVEYOR:



LAKE COUNTY STANDARDS & DETAILS

ROUTE	SECTION	SECTION NUMBER	SHEET	SHEETS
1230		03-00159-00-PV	204	262

FILE NAME: N:\PROJ\5161\Design\Details\PavementMarkingsStandard-LC7800E1J.dgn